

# CARBURETOR PARTS

Homelite Chain Saw

Assembly Number

A-68415

Supersedes

A-65015

&

A-65223

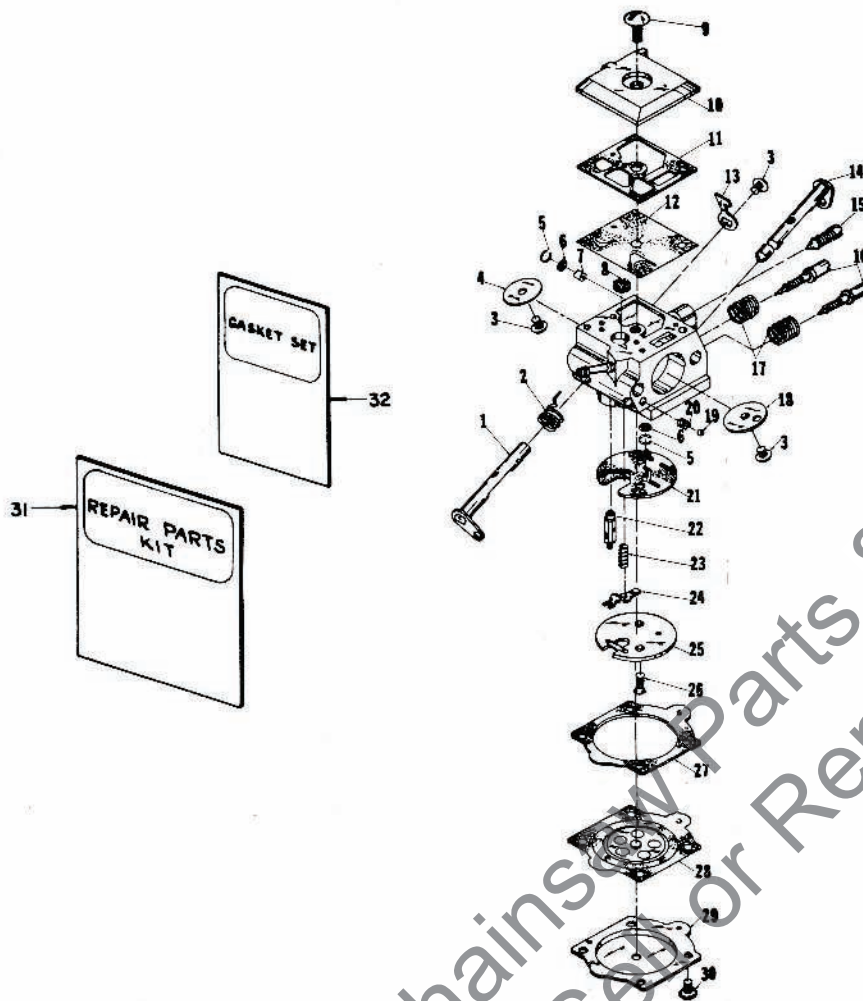

Units:

E-Z

E-Z Automatic

E-Z 250 Automatic

HDC - 1

HDC - 2

HDC - 4

No.	Part No.	Description	Qty.	No.	Part No.	Description	Qty.	
	1	67362	SHAFT-throttle	1	†16	67379	NEEDLE-idle adjustment	2
†	2	67376	SPRING-throttle return	1	†17	67377	SPRING-needle adjusting	2
†	3	67372	SCREW-valve	3	18	67365	VALVE-choke	1
	4	67363	VALVE-throttle	1	†19	60051	BALL-choke friction	1
†	5	67360	RING-screen retaining	2	†20	64238	SPRING-choke friction	1
†	6	67381	SCREEN-check valve	2	‡21	67367	GASKET-circuit	1
*	7	68461	JET-limiting (A-68415 only)	1	†22	64229	VALVE-inlet needle	1
		64690	JET-limiting (A-65015 only)	1	†23	67378	SPRING-metering lever	1
		67487	JET-limiting (A-65223 only)	1	†24	67383	LEVER-metering	1
†	8	64243	SCREEN-fuel inlet	1	25	67382	PLATE-circuit	1
	9	67374	SCREW-fuel pump cover	1	26	67375	SCREW-circuit plate	2
	10	67361	COVER-fuel pump	1	‡27	64231	GASKET-metering diaphragm	1
‡	11	67368	GASKET-fuel pump	1	†28	67371	DIAPHRAGM-metering	1
†	12	67370	DIAPHRAGM-fuel pump	1	29	64224	COVER-metering diaphragm	1
	13	67366	STOP-throttle	1	30	64689	SCREW-metering cover	4
	14	67364	SHAFT-choke	1	31	67384	REPAIR KIT	1
	15	67373	SCREW-idle adjustment	1	†32	67369	GASKET SET	1
						65386	REPAIR KIT-check valve	1

\* Denotes new parts

† Indicates contents of Repair Kit #67384

‡ Indicates contents of Gasket Set

