

CARBURETOR PARTS

Homelite Chain Saw

Assembly Number
A-58767-C

Supersedes A-58767-B, A-58767-A.

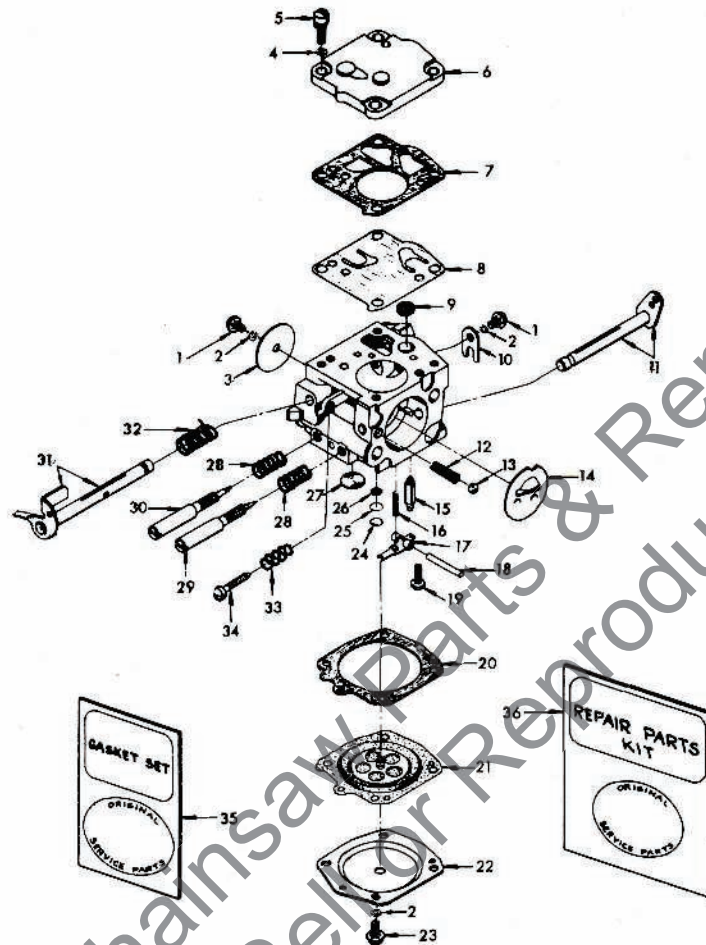

Model — Tillotson IIS-4D

All new parts listed are interchangeable with original parts when installed as noted.

Index No.	Part No.	Description	Qty. Req'd.	Index No.	Part No.	Description	Qty. Req'd.
1	*80264	SCREW - 4-40 x 3/16	2	19	*58992	SCREW - 4-40 x 5/16	1
2	83008-1	WASHER - #4	6	20	58978	GASKET - diaphragm	1
3	25050	THROTTLE SHUTTER	1	21	*58988	DIAPHRAGM - main	1
4	83024	WASHER - #6	4	22	58979	COVER - diaphragm	1
5	80275	SCREW - 6-32 x 3/8	4	23	80591	SCREW - 4-40 x 1/4	4
6	58975	COVER - pump	1	24	*58994	PLUG - Welch 3/16	1
7	58981	GASKET - fuel pump	1	25	57819	RING - retaining	1
8	*58980	DIAPHRAGM - fuel pump	1	26	59500	SCREEN - channel	1
9	*58974	SCREEN	1	27	*58991	PLUG - Welch 11/32	1
10	58982	CLIP - throttle shaft	1	28	*73075	SPRING - adjusting screw	2
11	58990	CHOKE SHAFT & LEVER	1	29	*58986	NEEDLE - main adjusting	1
12	73264	SPRING - choke friction	1	30	*58985	NEEDLE - idle adjusting	1
13	25527	BALL - choke friction	1	31	A-63345	THROTTLE SHAFT & LEVER	1
14	58984	SHUTTER - choke	1	32	*59460	SPRING - throttle return	1
15	*59717	† NEEDLE - inlet (See Note 1)	1	33	*58973	§ SPRING - idle speed (See Note 2)	1
16	*55759	SPRING - inlet tension	1	34	*58993	§ SCREW - idle stop (see Note 2)	1
17	*59716	† LEVER - inlet control (See Note 1)	1	35	*58971	GASKET SET	1
18	*58977	PIN - fulcrum	1	36	58972	REPAIR KIT	1

* Included in Repair Kit

† Note 1: New type (slotted) needle and lever must be installed together when replacing original type.

§ Note 2: Packaged with service replacement carburetor, use if required.