

CARBURETOR PARTS

Homelite Chain Saw

Assembly Number
A-57012

**NO LONGER SUPPLIED
REPLACED BY ASSEMBLY
A57806**

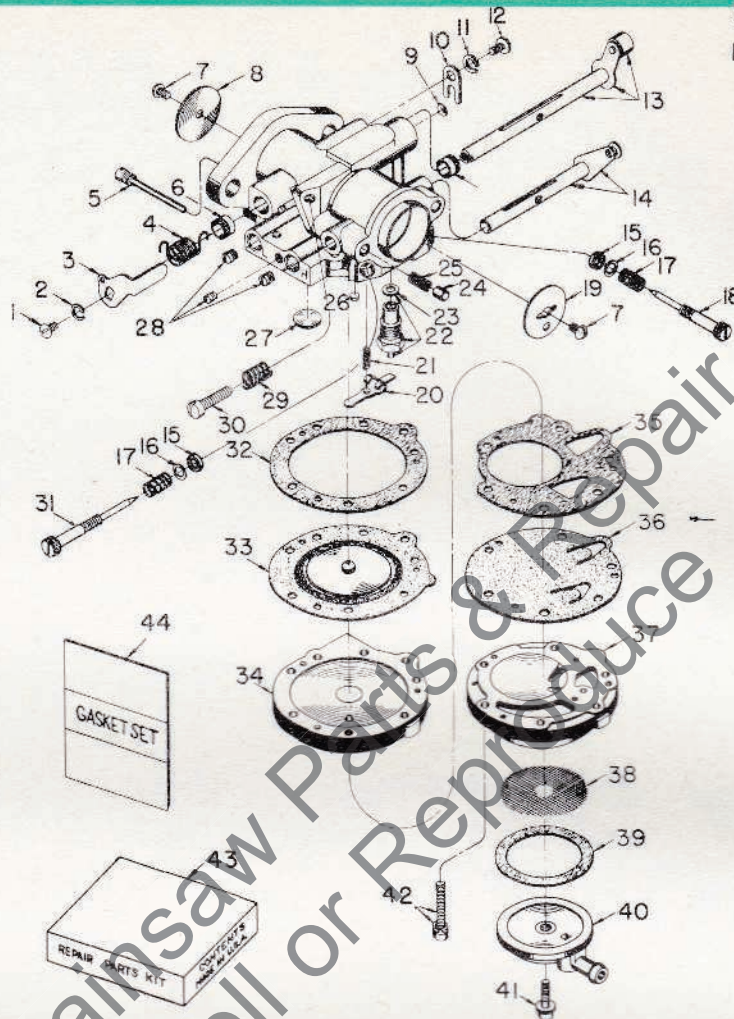

TILLOTSON MODEL HL-62AX

Index No.	Part No.	Description	No. Required	Index No.	Part No.	Description	No. Required
	A-57012	CARBURETOR—Complete Includes		22	*A-57728	INLET NEEDLE AND SEAT	1
1	*80006-1	SCREW—rd. hd., 4-36 x 1/4"	1	23	55344	includes: GASKET—inlet seat	1
2	*83008-1	WASHER—lock, #4	1	24	71494	PIN—choke friction	1
3	56224	LEVER—throttle stop	1	25	73264	SPRING—choke friction	1
4	*58569	SPRING—throttle return	1	26	*55763	PLUG—channel	1
5	*A-55762	PIN—inlet lever fulcrum	1	27	*30818	PLUG—welch, 3/8" dia.	1
6	72812	BUSHING—throttle shaft	2	28	**73067	SCREW—headless plug, 8-32	3
7	*80012	SCREW—shutter	2	29	*28064	SPRING—idle stop screw	1
8	75532	SHUTTER—throttle	1	30	*71509	SCREW—idle stop	1
9	56642	PLUG—welch, 5/16" dia.	1	31	*56627	SCREW—idle adjustment	1
10	73086	CLIP—throttle shaft	1	32	*57824	GASKET—main diaphragm	1
11	83000	WASHER—lock, #8	1	33	*57829	DIAPHRAGM—main	1
12	73088	SCREW—flat hd., 8-32 x 5/16"	1	34	55749	COVER—main diaphragm	1
13	A-56641-1	THROTTLE SHAFT and LEVER	1	35	55881	GASKET—pump diaphragm	1
14	A-56639	CHOKE SHAFT and LEVER	1	36	*58193	DIAPHRAGM—fuel pump	1
15	*75733	PACKING—adjustment screw	2	37	55748	BODY—fuel pump	1
16	*75735	WASHER—adjustment screw	2	38	*55752	SCREEN—fuel strainer	1
17	*73075	SPRING—adjustment screw	2	39	*55751	GASKET—pump strainer	1
18	*56644	SCREW—main adjustment	1	40	55750	COVER—strainer	1
19	73263	SHUTTER—choke	1	41	*55756	SCREW—strainer cover retaining	1
20	*55747	LEVER—inlet control	1	42	55316	SCREW—body, with lockwasher	6
21	*55759	SPRING—inlet control lever	1	43	56649	REPAIR PARTS KIT	1
				44	*57919	GASKET SET	1

* Included in Repair Parts Kit

** Use 55746 Lead Shot in late models

10M-9-63

Printed in U.S.A.

HOMELITE

A **Textron** DIVISION

PORT CHESTER, NEW YORK

Part No. 23536-A

Revised 9-63

Supersedes Part No. 23536