

HOMELITE

AUTOMATIC OILER KIT

For XP 1000 saws, and "C" series saws equipped with drilled oil channel in drivecase.

A-59671 Kit	A-63241 Kit	A-59682 Kit
7 tooth, .404 pitch	6 tooth, 1/2" pitch	7 tooth, 7/16" pitch

INSTALLATION

Remove bar-bolt nuts and washers, drive case cover, outer guide bar plate, guide bar and chain. Lock engine and remove lock nut, small flat washer, large thrust washer, and sprocket and drum. Do not remove inner race of sprocket bearing. Set aside, for use with new kit, the outer guide bar plate, small flat washer, lock nut, bar-bolt nuts, and lockwashers.

CAUTION

Remove screw plug in oil channel of drive case - location shown in illustration (over).

Install new sprocket and drum, insert thrust washer #59529 (in kit) and small flat washer; lock engine and tighten lock nut. Install bar and chain, place outer bar plate on bolts.

Turn chain adjustment screw, in oiler housing, counterclockwise until bar pin stops, check oil pin to be sure "O" ring (#58406) is in groove; turn drive pin (in worm drive shaft) by hand - should turn freely. Mount oiler housing on two bar bolts, line up drive pin with slots in sprocket hub, and dowel pin with mating hole in drive case.

As housing is pushed in, move guide bar back and forth until chain tension pin engages hole in guide bar. If oiler drive pin does not engage sprocket-hub slots, move chain back and forth until they line up and the assembly is pushed up to drive case. Attach guide bar bolt lockwashers and nuts, adjust chain tension and tighten.

Under normal conditions, fill oil reservoir with SAE-30 oil; use SAE-10 during the winter unless temperature drops below 0°F., then use an oil-mix of four parts SAE-10 oil and one part kerosene. USE CLEAN OIL.

ALWAYS FILL AUTOMATIC OILER TANK WHEN FILLING FUEL TANK

Early "C" series models, without the screw plug in drive case, require the new drive case (part number A-59493-1) before the oiler kit can be installed.

CHECK POINTS:

- ✓ When oiler assembly is removed, always check "O" ring on oil outlet pin - it must be in groove and undamaged, to seal oil channel inlet of drive case properly.
- ✓ Use clean oil, check oil level, don't run dry.
- ✓ Clean out oil channels in drive case and guide bar.
- ✓ Check engagement of drive pin and sprocket hub. If drive pin appears worn - could also shear off - install new pin. Be sure plug is pressed into worm gear before you insert new drive pin, plug prevents oil loss through gear. One end of drive pin should extend a maximum of 13/32", minimum of 25/64".
- ✓ Oil filter may plug up, remove cover (10 screws), install new filter or clean carefully. Replace cover.

See Parts List (over)

Part No. 23832-A
(Supersedes No. 23832)

HOMELITE
"C" - SERIES
AUTOMATIC OILER

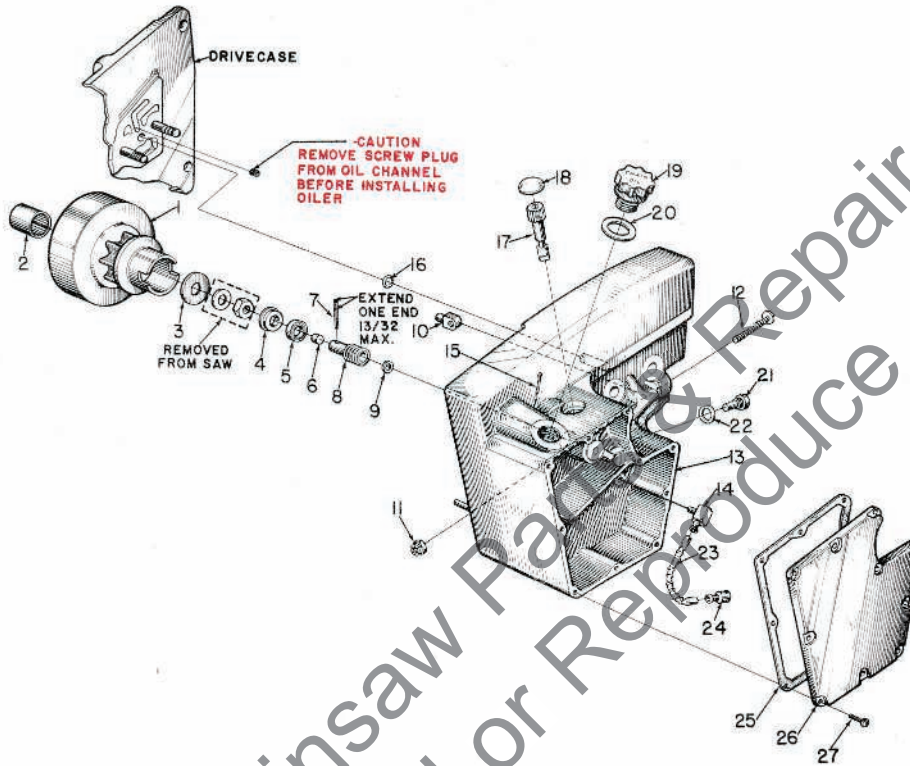

A-59671 Kit
7 tooth, .404 pitch

A-63242 Kit
6 tooth, 1/2" pitch

A-59682 Kit
7 tooth, 7/16" pitch

Parts List

Index No.	Part No.	Description	No. Required	Index No.	Part No.	Description	No. Required
1	A-59166	SPROCKET & DRUM - 7 tooth, .404 pitch	1	13	A-59739	HOUSING - oiler w/pins & plugs	1
	A-59686	SPROCKET & DRUM - 7 tooth, 7/16" pitch	1	14	59532	ELBOW - oil line	1
	A-63242	SPROCKET & DRUM - 6 tooth, 1/2" pitch	1	15	86301	COTTER PIN	1
		Includes		16	58406	"O" RING	1
2	55664	BEARING - needle	1	17	A-59178	PLUNGER - oil pump	1
3	59529	WASHER - thrust	1	18	59533	PLUG - expansion	1
4	59530	SHIELD - oil seal	1	19	A-58390-A	CAP - oil filler	1
5	59187	SEAL - oil	1			Includes	
6	59199	PLUG - worm	1	20	56607	GASKET	1
7	59185	PIN - slotted	1	21	59737	SCREW - cam	1
8	59287	WORM	1	22	59736	GASKET	1
9	59188	WASHER - thrust	1	23	59674	LINE - oil	1
10	55613	PIN - guide bar adjusting	1	24	A-58828	FILTER - oil	1
11	81123	NUT - hex, 5/16 - 18	1	25	59373	GASKET - oil reservoir	1
12	80617	SCREW - rd. hd., 5/16 - 18 x 2	1	26	59228-A	COVER - oil reservoir	1
				27	80513	SCREW - rd. hd., #6 x 1/2	10

See INSTALLATION (over)

HOMELITE

A **Textron** DIVISION
PORT CHESTER, NEW YORK