

# CARBURETOR PARTS

Assembly Number  
A-50676

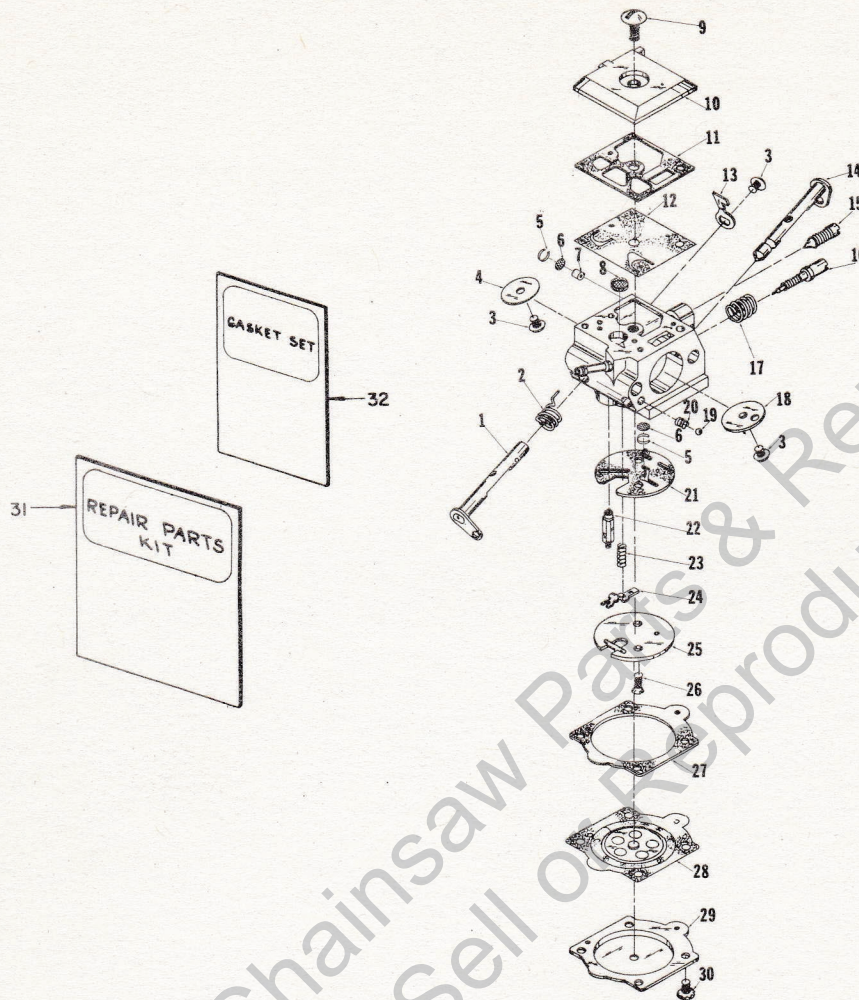

MODEL HDC-7

USED ON:  
EZ-10  
EZ CHIPPER

No.	Description	Part No.	Qty.
1	SHAFT-throttle	67362	1
2	SPRING-throttle return	† 67376	1
3	SCREW-valve	† 67372	3
4	VALVE-throttle	67363	1
5	RING-screen retaining	† 67360	2
6	SCREEN-check valve	† 67381	2
*7	JET-limiting	68461	1
8	SCREEN-fuel inlet	† 64243	1
9	SCREW-fuel pump cover	67374	1
10	COVER-fuel pump	67361	1
11	GASKET-fuel pump	‡ 67368	1
12	DIAPHRAGM-fuel pump	† 67370	1
13	STOP-throttle	67366	1
14	SHAFT-choke	67364	1
15	SCREW-idle adjustment	67373	1
16	NEEDLE-"Lo"	† 67379	1
17	SPRING-needle adjusting	† 67377	1

\* Denotes new parts

No.	Description	Part No.	Qty.
18	VALVE-choke	67365	1
19	BALL-choke friction	† 60051	1
20	SPRING-choke friction	† 64238	1
21	GASKET-circuit	‡ 67367	1
22	VALVE-inlet needle	† 64229	1
23	SPRING-metering lever	† 67378	1
24	LEVER-metering	† 67383	1
25	PLATE-circuit	67382	1
26	SCREW-circuit plate	67375	2
27	GASKET-metering diaphragm	‡ 64231	1
28	DIAPHRAGM-metering	† 67371	1
29	COVER-metering diaphragm	64224	1
30	SCREW-metering cover	64689	4
31	REPAIR KIT	67384	1
32	GASKET SET	† 67369	1
	REPAIR KIT-check valve	65386	1

‡ Indicates contents of Gasket Set

† Indicates contents of Repair Kit #67384