

# CARBURETOR PARTS

Homelite Chain Saw

Assembly Number

A - 68415

Supersedes

A - 65015

&

A - 65223

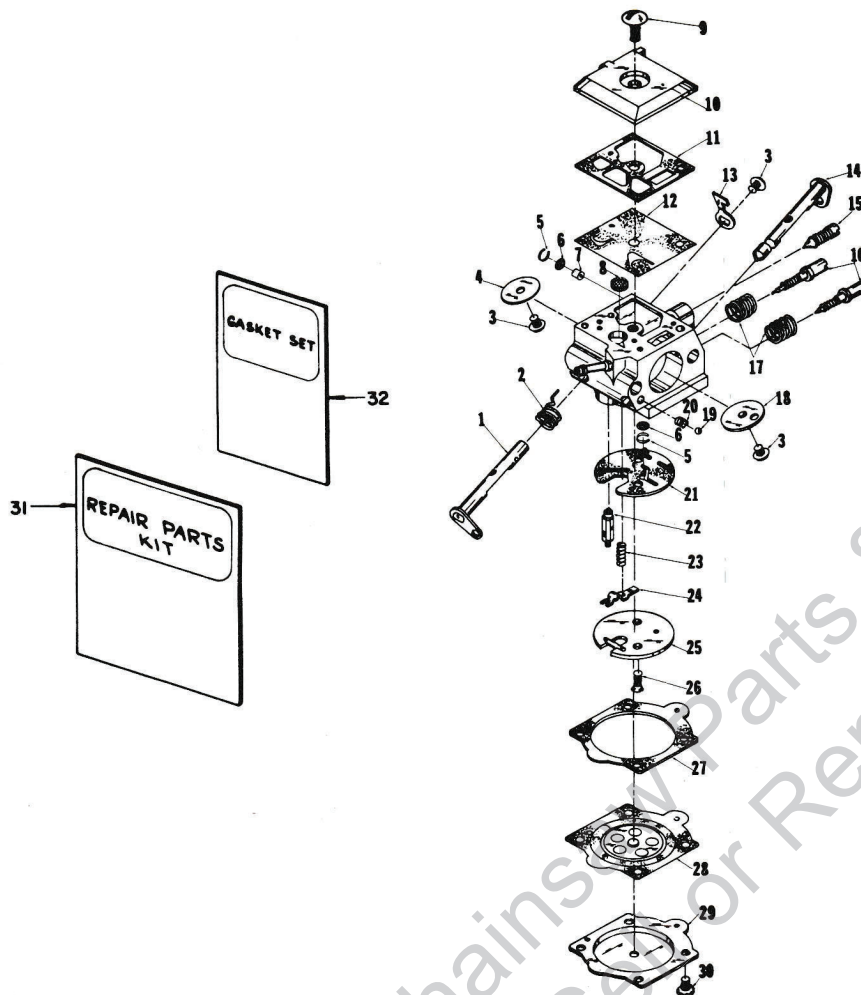

Units :

E - Z

E - Z Automatic

E - Z 250 Automatic

HDC - 1

HDC - 2

HDC - 4

| No. | Part No. | Description | Qty.                        | No. | Part No. | Description | Qty.                      |   |
|-----|----------|-------------|-----------------------------|-----|----------|-------------|---------------------------|---|
|     | 1        | 67362       | SHAFT-throttle              | 1   | †16      | 67379       | NEEDLE-idle adjustment    | 2 |
| †   | 2        | 67376       | SPRING-throttle return      | 1   | †17      | 67377       | SPRING-needle adjusting   | 2 |
| †   | 3        | 67372       | SCREW-valve                 | 3   | 18       | 67365       | VALVE-choke               | 1 |
|     | 4        | 67363       | VALVE-throttle              | 1   | †19      | 60051       | BALL-choke friction       | 1 |
| †   | 5        | 67360       | RING-screen retaining       | 2   | †20      | 64238       | SPRING-choke friction     | 1 |
| †   | 6        | 67381       | SCREEN-check valve          | 2   | ‡21      | 67367       | GASKET-circuit            | 1 |
| *   | 7        | 68461       | JET-limiting (A-68415 only) | 1   | †22      | 64229       | VALVE-inlet needle        | 1 |
|     |          | 64690       | JET-limiting (A-65015 only) | 1   | †23      | 67378       | SPRING-metering lever     | 1 |
|     |          | 67487       | JET-limiting (A-65223 only) | 1   | †24      | 67383       | LEVER-metering            | 1 |
| †   | 8        | 64243       | SCREEN-fuel inlet           | 1   | 25       | 67382       | PLATE-circuit             | 1 |
|     | 9        | 67374       | SCREW-fuel pump cover       | 1   | 26       | 67375       | SCREW-circuit plate       | 2 |
|     | 10       | 67361       | COVER-fuel pump             | 1   | ‡27      | 64231       | GASKET-metering diaphragm | 1 |
| ‡   | 11       | 67368       | GASKET-fuel pump            | 1   | †28      | 67371       | DIAPHRAGM-metering        | 1 |
| †   | 12       | 67370       | DIAPHRAGM-fuel pump         | 1   | 29       | 64224       | COVER-metering diaphragm  | 1 |
|     | 13       | 67366       | STOP-throttle               | 1   | 30       | 64689       | SCREW-metering cover      | 4 |
|     | 14       | 67364       | SHAFT-choke                 | 1   | 31       | 67384       | REPAIR KIT                | 1 |
|     | 15       | 67373       | SCREW-idle adjustment       | 1   | †32      | 67369       | GASKET SET                | 1 |
|     |          |             |                             |     |          | 65386       | REPAIR KIT-check valve    | 1 |

\* Denotes new parts

† Indicates contents of Repair Kit #67384

‡ Indicates contents of Gasket Set