

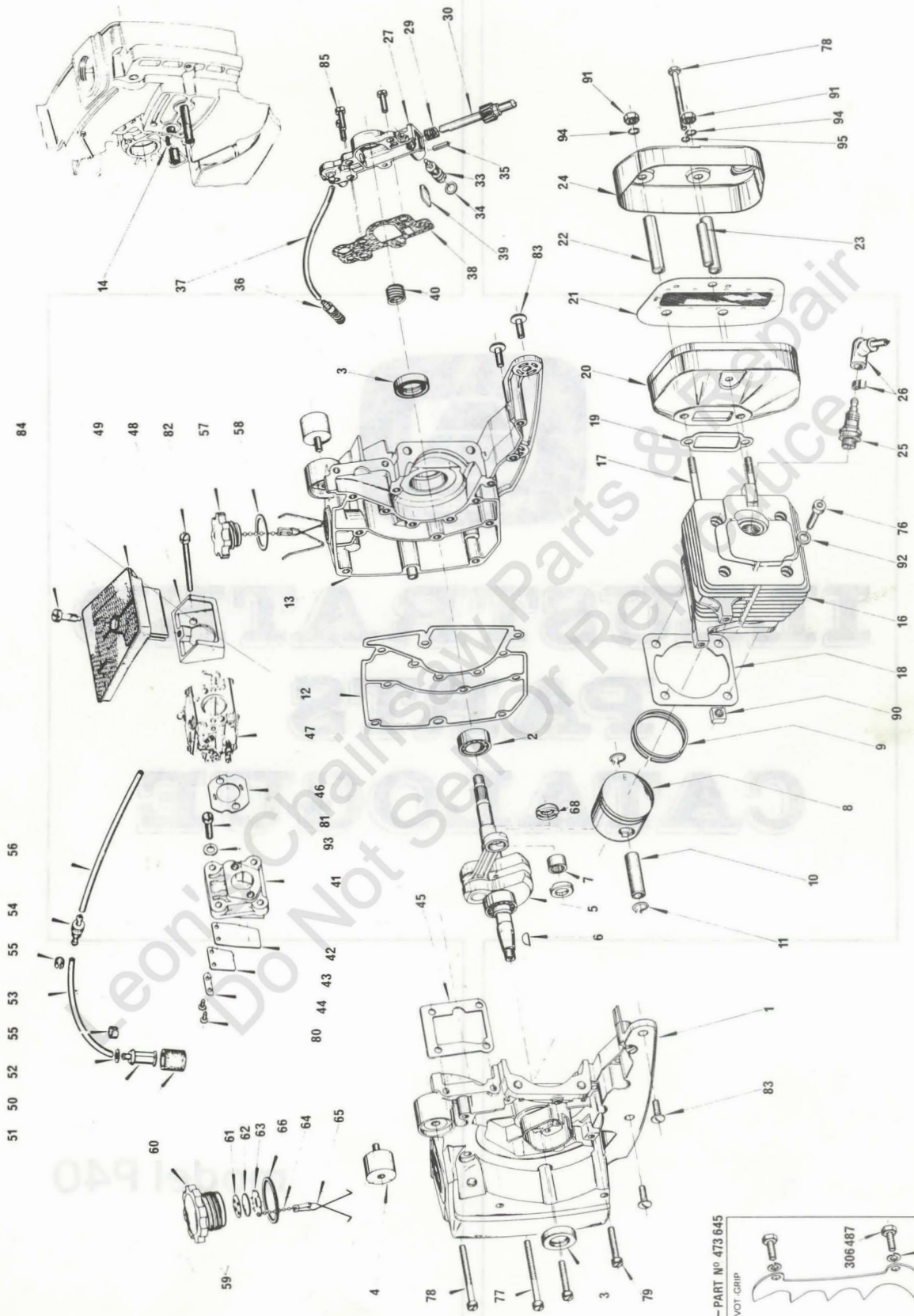

ILLUSTRATED PARTS CATALOGUE

model P40





KIT - PART N° 473 645

PIVOT GRIP

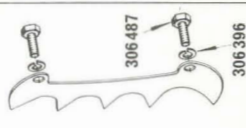

PIONEER MODEL P40

REF. NO.	PART NO.	NAME OF PART	QTY. PER ASSY.	REF. NO.	PART NO.	NAME OF PART	QTY. PER ASSY.
1	430188	Crankcase Half, blower side	1	43	428246	Reed Stiffener	1
2	427849	Main Bearing	1	44	430272	Retainer Plate, reed	1
3	428746	Seal	2	45	430191	Gasket, reed to crankcase	1
4	430197	Shock Absorber	2	46	427888	Gasket, carburetor to reed	1
5	474640	C' Shaft & Con. Rod Ass'y.	1	47	474768	Carburetor Complete	1
6	429481	Key, flywheel	1	48	430192	Elbow, air filter	1
7	429538	Bearing, wrist pin	1	49	474604	Air Filter incl. item No. 84	1
8	473926	Piston & Dow Pin assy.	1	50	474397	Fuel Pickup assy.	1
9	473961	Piston Ring Set	1	51	430436	Filter Felt, fuel pickup	1
10	429546	Wrist Pin	1	52	302474	Washer, fuel pickup	1
11	429548	Retainer, wrist pin	2	53	429677	Fuel Hose, connector to pickup	1
12	430190	Gasket, crankcase	1	54	429975	Fuel Connector Assy.	1
13	473928	Crankcase Half, mag. side	1	55	430545	Speed Clip, fuel pickup	2
14	132970	Groove Pin	1	56	430181	Fuel Hose, carburetor to pickup	1
16	430182	Cylinder	1	57	473933	Oil Cap assy.	1
17	430183	Stud, cylinder	2	58	301967	O-Ring, oil cap	1
18	430184	Gasket, cylinder	1	59	474561	Gas Cap assy.	1
19	429642	Gasket, muffler	1	60	473914	Gas Cap Body assy.	1
20	473949	Muffler Body assy.	1	61	428600	Cover Plate, gas cap	1
21	473950	Baffle Plate assy., muffler	1	62	427994	Filter Disc, gas cap	1
22	430837	Spacer, muffler	2	63	427278	Cover, gas cap	1
23	430835	Spacer, muffler	1	64	427277	Bead Chain, gas cap	1
24	430234	Cover, muffler	1	65	427213	Spring, gas cap	1
25	428006	Spark Plug	1	66	429946	O-Ring, gas cap	1
26	580339	Sparky Cover assy.	1	68	429547	Thrust Washer, wrist pin	2
*	474756	Oil Pump assy. complete	1	76	318935	Screw, cylinder	4
27	474794	Oil Pump Body assy.	1	77	318521	Screw, crankcase	1
29	430031	Spring, plunger	1	78	316125	Screw, crankcase	3
30	473947	Plunger assy.	1	79	307190	Muffler	1
33	430385	Adjusting Screw, oil pump	1	80	428335	Screw, crankcase	10
34	305857	O-Ring - oil pump	1	81	309483	Screw, reed valve	2
35	313495	Spiral Pin, oil pump	1	82	316781	Screw, reed body to crankcase	4
36	474755	Oil Pickup Head assy.	1	83	429776	Screw, reed body to carburetor	2
37	430227	Oil Hose	1	84	430713	Screw, shock absorber	4
38	430228	Gasket, oil pump	1	85	510195	Screw, air filter to elbow	1
39	430229	Seal, oil pump	1	90	315381	Screw, oil pump	3
40	430231	Worm, oil pump	1	91	133175	Nut, muffler	4
41	473932	Reed Valve assy.	1	92	552743	Nut, muffler	2
42	428336	Reed	1	93	306547	Washer, cylinder	4
				94	306396	Lockwasher, muffler	4
				95	120052	Lockwasher, muffler	2

* NOT SHOWN

PRIOR TO SER. NO. 1113801

INDENTED PART NAMES INDICATE THAT THESE PARTS ARE INCLUDED IN PRECEDING ASSEMBLY

ORDER ALL PARTS FROM YOUR LOCAL AUTHORIZED DEALER

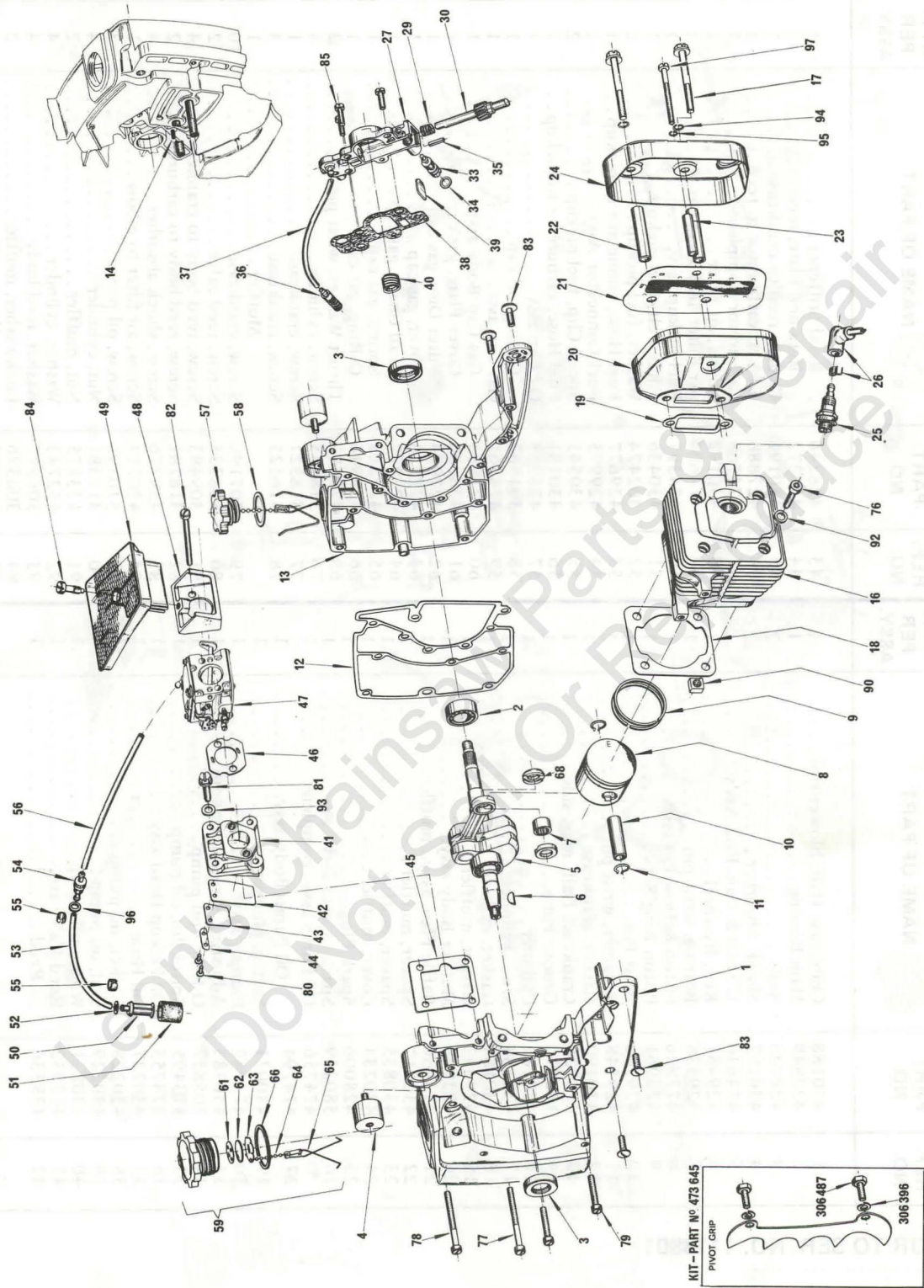

AFTER SER. NO. 1113801

PIONEER MODEL P40

REF. NO.	PART NO.	NAME OF PART	QTY. PER ASSY.	REF. NO.	PART NO.	NAME OF PART	QTY. PER ASSY.
1	430985	Crankcase Half, blower side	1	43	428246	Reed Stiffener	1
2	427849	Main Bearing	1	44	430272	Retainer Plate, reed	1
3	428746	Seal	2	45	430191	Gasket, reed to crankcase	1
4	430197	Shock Absorber	2	46	427888	Gasket, carburetor to reed	1
5	474640	C-Shaft & Con. Rod Ass'y.	1	47	474768	Carburetor Complete	1
6	429481	Key, flywheel	1	48	430192	Elbow, air filter	1
7	429538	Bearing, wrist pin	1	49	474604	Air Filter incl. item No. 84	1
8	473926	Piston & Dowel Pin Assy.	1	50	474397	Fuel Pickup Assy.	1
9	473961	Piston Ring Set	1	51	430885	Filter Felt, fuel pickup	1
10	429546	Wrist Pin	1	52	302474	Washer, fuel pickup	1
11	429548	Retainer, wrist pin	2	53	429677	Fuel Hose, connector to pickup	1
12	430190	Gasket, crankcase	1	54	430883	Fuel Connector	1
13	473928	Crankcase Half, Drive Side	1	55	430545	Speed Clip, fuel pickup	2
14	132970	Groove Pin	1	56	430181	Fuel Hose, carburetor to pickup	1
16	430182	Cylinder	1	57	473933	Oil Cap Assy.	1
17	430992	Bolt, Muffler	2	58	301967	O-Ring, oil cap	1
18	430184	Gasket, cylinder	1	59	474764	Gas Cap Assy.	1
19	430729	Gasket, muffler	1	61	428600	Cover Plate, gas cap	1
20	473949	Muffler Body Assy.	1	62	427994	Filter Disc, gas cap	1
21	473950	Baffle Plate Assy., muffler	1	63	427278	Cover, gas cap	1
22	430837	Spacer, muffler	2	64	427277	Bead Chain, gas cap	1
23	430835	Spacer, muffler	1	65	427213	Spring, gas cap	1
24	430234	Cover, muffler	1	66	429946	O-Ring, gas cap	1
25	428006	Spark Plug	1	68	429547	Thrust Washer, wrist pin	2
26	580339	Sparky Cover Assy.	1	76	318935	Screw, cylinder	4
*	474756	Oil Pump Assy. complete	1	77	318521	Screw, crankcase	1
27	474794	Oil Pump Body Assy.	1	78	316125	Screw, crankcase	3
29	430031	Spring, plunger	1	79	307190	Screw, crankcase	10
30	473947	Plunger Assy.	1	80	428335	Screw, reed valve	2
33	430385	Adjusting Screw, oil pump	1	81	431010	Screw, reed body to crankcase	4
34	305857	O-Ring - oil pump	1	82	316781	Screw, reed body to carburetor	2
35	313495	Spiral Pin, oil pump	1	83	429776	Screw, shock absorber	4
36	474755	Oil Pickup Head Assy.	1	84	430713	Screw, air filter to elbow	1
37	430227	Oil Hose	1	85	510195	Screw, oil pump	3
38	430228	Gasket, oil pump	1	90	315381	Nut, cylinder	4
39	430229	Seal, oil pump	1	92	552743	Washer, cylinder	4
40	430231	Worm, oil pump	1	93	306547	Washer, reed body	4
41	473932	Reed Valve Assy.	1	94	306396	Lockwasher, muffler	2
42	428336	Reed	1	95	120052	Lockwasher, muffler	1
				96	427855	Gasket, Fuel conn.	1
				97	430993	Screw, Muffler	1

AFTER SER. NO. 1113801

INDENTED PART NAMES INDICATE THAT THESE PARTS ARE INCLUDED IN PRECEDING ASSEMBLY

ORDER ALL PARTS FROM YOUR LOCAL AUTHORIZED DEALER

* NOT SHOWN

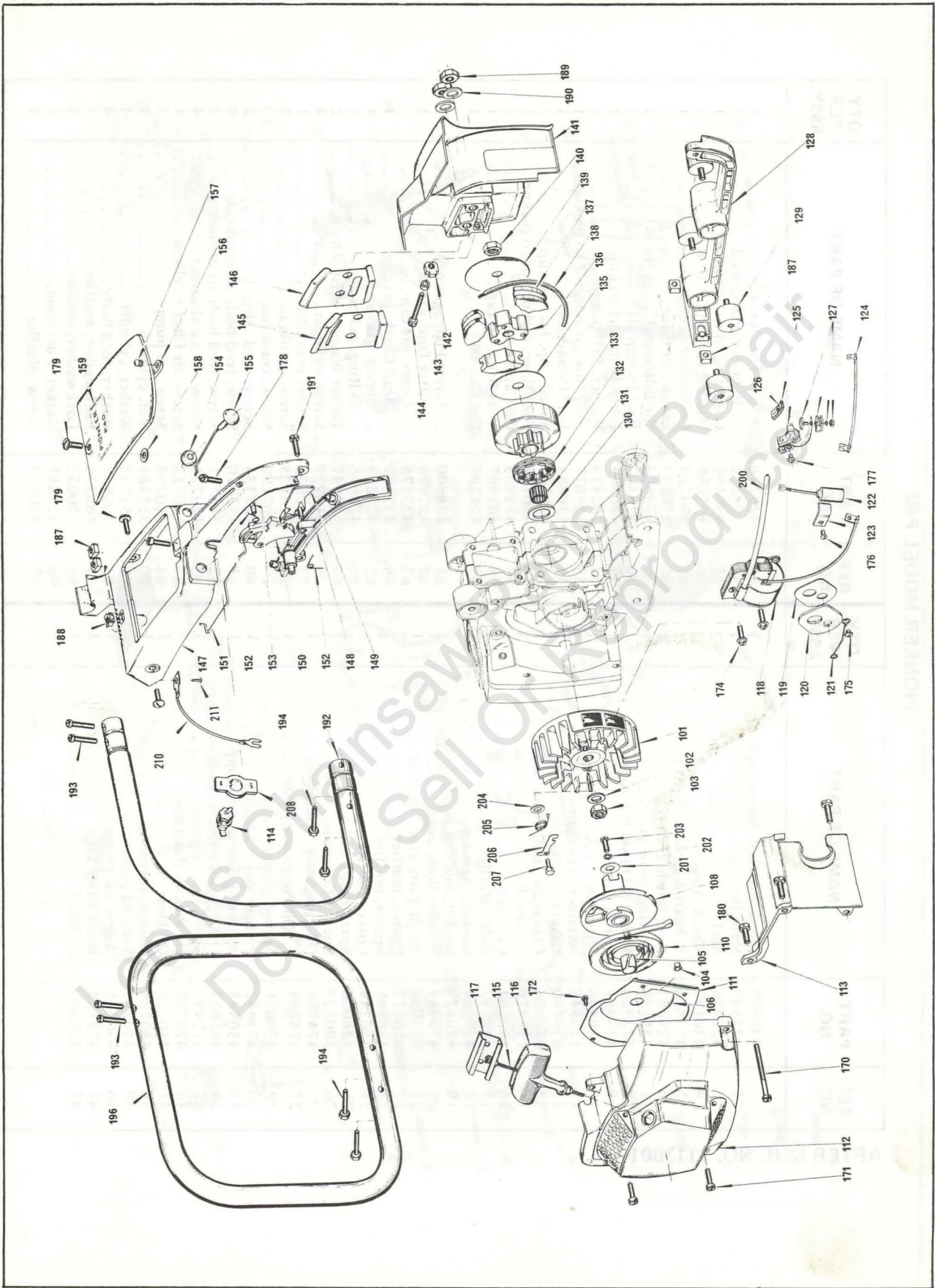

AFTER SER. NO. 1113801

PIONEER MODEL P40

REF. NO.	PART NO.	NAME OF PART	QTY. PER ASSY.	REF. NO.	PART NO.	NAME OF PART	QTY. PER ASSY.
101	474645	Flywheel assy.	1	152	430194	Spring, throttle and safety trigger. .	2
102	429851	Washer, flywheel	1	153	430399	Pin, throttle trigger	1
103	404837	Nut, flywheel	1	154	429650	Grommet, choke knob	1
104	431004	Bushing, starter spring	1	155	430202	Choke knob and wire assy.	1
105	428444	Bearing, nylon	1	156	430884	Top cover	1
106	430312	Washer, rewind spring	1	157	430282	Bumper, top cover	1
108	474655	Pulley, starter	1	158	307566	Washer, top cover	1
110	430863	Spring, starter	1	159	431000	Decal - PIONEER P40	1
111	430216	Baffle plate, starter	1	170	431065	Screw, blower cover to crankcase..	1
112	474859	Blower cover and screen assy. ...	1	171	510195	Screw, blower cover	3
113	430986	Cylinder shroud	1	172	429688	Screw, baffle plate	4
114	473965	Ignition switch kit	1	174	430274	Screw, coil assembly	2
115	429278	Starter cord	1	175	309457	Screw, spring/ignition cover	1
116	430641	Starter handle	1	176	311516	Screw, condensor	1
117	430643	Anchor, starter handle	1	177	430275	Screw, breaker point assy.	1
118	473938	Coil assy. with H.T. head	1	178	550913	Screw, top frame/grip	2
119	431033	Gasket, ignition cover	1	179	429776	Screw, shock absorber	2
120	430211	Ignition cover	1			top cover	1
121	430212	Spring, ignition cover	1	180	307175	Screw, cylinder shroud	3
122	430209	Condensor	1	187	315381	Nut, top/bottom frame	4
123	427754	Clamp, condensor	1	188	430203	Nut, top frame	1
124	430989	Switch wire assy.	1	189	425031	Nut, strut	2
125	473948	Breaker point assy.	1	190	427980	Washer	2
126	430207	Cam wiper	1	191	430887	Screw, top/bottom frame	1
127	473931	Insulator and stud assy.	1			HALF WRAP HANDLE	
128	430196	Bottom frame	1			Front handle assembly	1
129	430197	Shock absorber	4	192	473943	Screw, front handle top	2
130	430848	Thrust washer, inner	1	193	132492	Screw, front handle bottom	2
131	429557	Bearing, sprocket	1	194	304627	Front handle assembly	1
132	429956	Rim sprocket (3/8 pitch)	1			FULL WRAP HANDLE	
133	473753	Clutch drum assy. (3/8 pitch)	1	193	132492	Screw, front handle top	2
135	430599	Inner washer, clutch	1	194	304627	Screw, front handle bottom	2
136	474646	Clutch driver assy.	1	196	474602	Front handle assembly	1
137	427736	Clutch shoe	3			High tension lead	1
138	430746	Spring, clutch	1	200	430213	Washer, starter	1
139	430902	Cover plate, clutch	1	201	428105	Lockwasher	1
140	430800	Nut, clutch	1	202	306398	Screw, starter	1
141	473940	Strut assy.	1	203	551725	Washer, pawl	2
142	425672	Pin, chain tensioner	1	204	430878	Spring, pawl	2
143	429637	Stop, chain tensioner	1	205	427764	Pawl, starter	2
144	429637	Screw, chain tensioner	1	206	430876	Screw, pawl	2
145	429659	Guide plate, inner	1	207	430877	Switch plate	1
146	429660	Guide plate, outer	1	208	430991	Switch wire	1
147	430988	Top frame	1	209	430989	Ground wire	1
148	473935	Lower grip assy.	1	210	430990	Screw	1
149	430840	Safety trigger	1	211	430847		
150	430327	Throttle trigger	1				
151	430830	Throttle link	1				

INDENTED PART NAMES INDICATE THAT THESE PARTS ARE INCLUDED IN PRECEDING ASSEMBLY

ORDER ALL PARTS FROM YOUR LOCAL AUTHORIZED DEALER

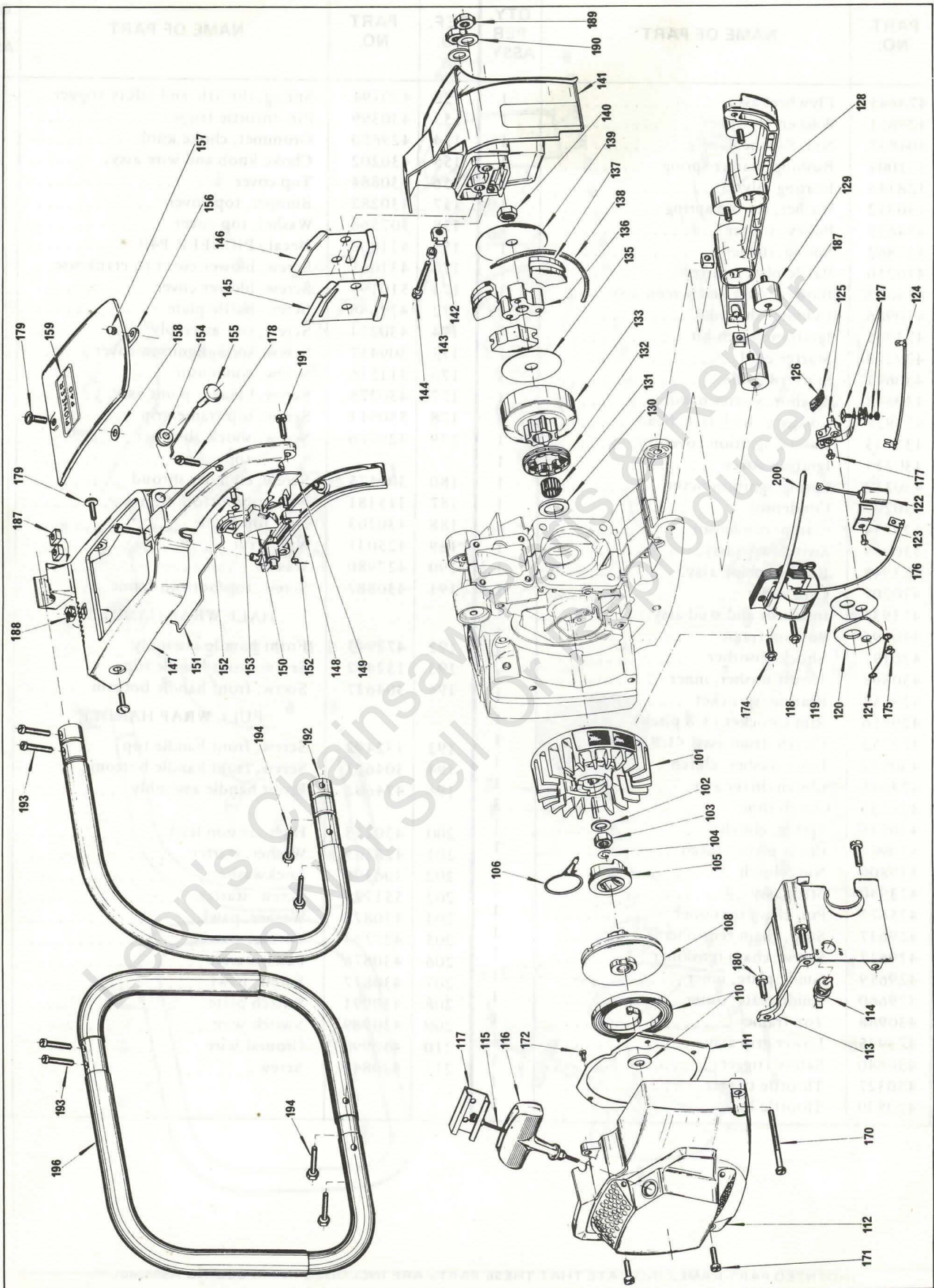

PRIOR TO SER. NO. 1113801

PIONEER MODEL P40

REF. NO.	PART NO.	NAME OF PART	QTY. PER ASSY.	REF. NO.	PART NO.	NAME OF PART	QTY. PER ASSY.
101	474797	Flywheel assy.	1	147	430831	Top Frame	1
102	429851	Washer, flywheel	1	148	473935	Lower grip assy.	1
103	404837	Nut, flywheel	1	149	430840	Safety Trigger	1
104	429246	Retaining Ring, starter	1	150	430327	Throttle Trigger	1
105	429892	Pinion, starter	1	151	430830	Throttle Link	1
106	474754	Friction Yoke & Sleeve assy.	1	152	430194	Spring, throttle & safety trigger	2
108	430609	Pulley, starter	1	153	430399	Pin, throttle trigger	1
110	474828	Starter spring washer & container assy	1	154	429650	Grommet, choke knob	1
111	430216	Baffle Plate, starter	1	155	430202	Choke Knob & Wire assy.	1
112	474572	Blower Cover & Screen Assy.	1	156	430832	Top Cover	1
113	430882	Cylinder Shroud	1	157	430282	Bumper, top cover	1
114	474562	Ignition Switch Kit	1	158	307566	Washer, top cover	1
115	429278	Starter Cord	1	159	430401	Decal - PIONEER P-40	1
116	430641	Starter Handle	1	170	318521	Screw, blower cover to crankcase	1
117	430643	Anchor, starter handle	1	171	510195	Screw, blower cover	3
118	473938	Coil assy. with H.T. head	1	172	429688	Screw, baffle plate	4
119	430210	Gasket, ignition cover	1	174	430274	Screw, coil ass'y.	2
120	430211	Ignition Cover	1	175	309457	Screw, spring/ignition cover	1
121	430212	Spring, ignition cover	1	176	311516	Screw, condenser	1
122	430209	Condensor	1	177	430275	Screw, breaker point assy.	1
123	427754	Clamp, condenser	1	178	550913	Screw, top frame/grip	2
124	473936	Switch Wire assy.	1	179	429776	Screw, shock absorber top cover	2
125	473948	Breaker Point assy.	1	180	307175	Screw, cylinder shroud	1
126	430207	Cam Wiper	1	187	315381	Nut, top/bottom frame	3
127	473931	Insulator & Stud assy.	1	188	430203	Nut, top frame	4
128	430196	Bottom Frame	1	189	425031	Nut, strut	1
129	430197	Shock Absorber	4	190	427980	Washer	2
130	430848	Thrust Washer, Inner	1	191	430887	Screw, top/bottom frame	2
131	429557	Bearing, sprocket	1				1
132	429956	Rim Sprocket (3/8 Pitch)	1				1
133	473753	Clutch Drum assy. (3/8 Pitch)	1				1
135	430599	Inner Washer, clutch	1				1
136	474646	Clutch Driver assy.	1	192	473943	Front Handle assy.	1
137	427736	Clutch Shoe	3	193	132492	Screw, front handle top	2
138	430746	Spring, clutch	1	194	304627	Screw, front handle bottom	2
139	430902	Cover Plate, clutch	1				1
140	430800	Nut, clutch	1				1
141	473940	Strut assy.	1				1
142	425672	Pin, chain tensioner	1	193	132492	Screw Ft. Handle Top	2
143	429637	Stop, chain tensioner	1	194	304627	Screw, front handle bottom	2
144	429638	Screw, chain tensioner	1	196	474602	Front Handle assy.	1
145	429659	Guide Plate, inner	1	200	430213	High Tension Lead	1
146	429660	Guide Plate, outer	1				1

INDENTED PART NAMES INDICATE THAT THESE PARTS ARE INCLUDED IN PRECEDING ASSEMBLY

ORDER ALL PARTS FROM YOUR LOCAL AUTHORIZED DEALER

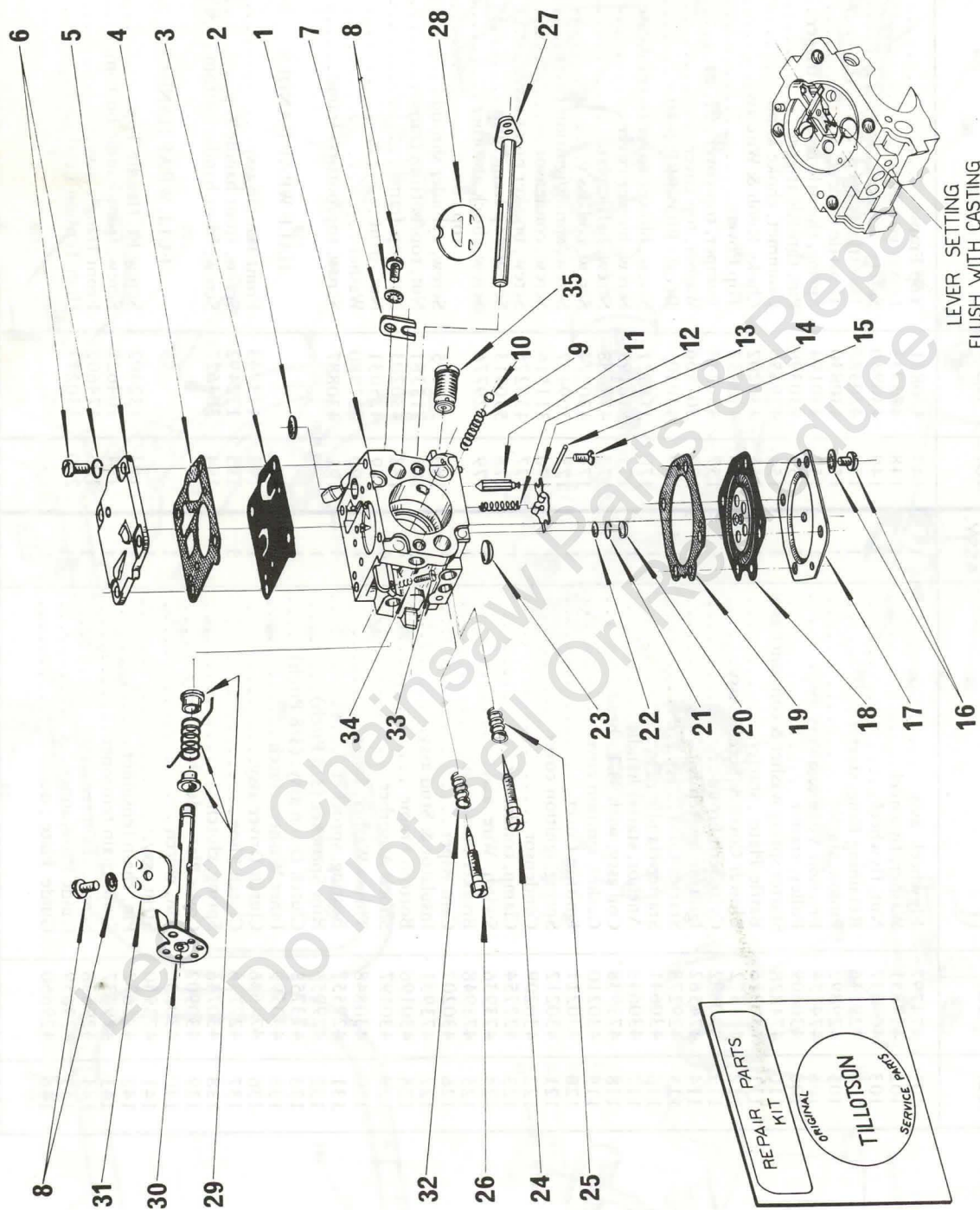

LEVER SETTING
FLUSH WITH CASTING

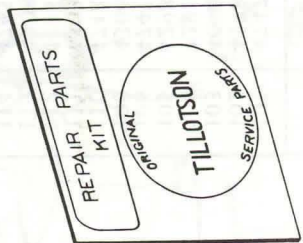

HIGHER MODEL 1-70

PIONEER MODEL P40

REF. NO.	PART NO.	NAME OF PART	QTY. PER ASSY.	REF. NO.	PART NO.	NAME OF PART	QTY. PER ASSY.
1	474768	Carburetor Assy. Complete	1	* 18	471374	Diaphragm assy.	1
* 2	427951	Screen	1	19	427950	Gasket, diaphragm metering	1
* 3	427941	Diaphragm, fuel pump	1	* 20	427944	Plug, 7/32 dia. welch	1
4	427940	Gasket, fuel pump	1	21	427943	Ring, retaining	1
5	427939	Cover, pump	1	22	427942	Screen	1
6	427955	Screw & Lockwasher (6-32 x 3/8)	4	* 23	427948	Plug, 11/32 dia. welch	1
7	427957	Clip	1	* 24	430628	Screw, main adjustment	1
8	427947	Screw & Lockwasher (4-40 x 3/16)	2	* 25	425449	Screw, adjustment screw	1
9	425450	Spring, choke friction	1	26	430629	Screw, idle adjustment	1
10	428452	Ball 5/32 dia. steel	1	27	474634	Shaft & Lever, choke	1
11	427952	Needle, inlet	1	28	430630	Shutter, choke	1
* 12	430650	Spring, tension	1	* 29	474762	Spring & Bushing Assembly	1
* 13	427953	Lever, inlet valve control	1	30	474564	Shaft & Lever, throttle	1
* 14	427954	Pin, fulcrum	1	31	430631	Shutter, throttle	1
* 15	427962	Screw (4-40 x 5/16)	1	32	430636	Spring - Idle adjustment	1
16	426145	Screw & Lockwasher	4	33	430637	Screw - Idle speed regulating	1
17	427956	Cover, diaphragm	1	34	430638	Spring - Idle speed	1
				35	430874	Speed Limiter	1

* NOTE: Parts contained in carburetor repair parts kit part no. 474603.

INDENTED PART NAMES INDICATE THAT THESE PARTS ARE INCLUDED IN PRECEDING ASSEMBLY
ORDER ALL PARTS FROM YOUR LOCAL AUTHORIZED DEALER

PIONEER MODEL P40

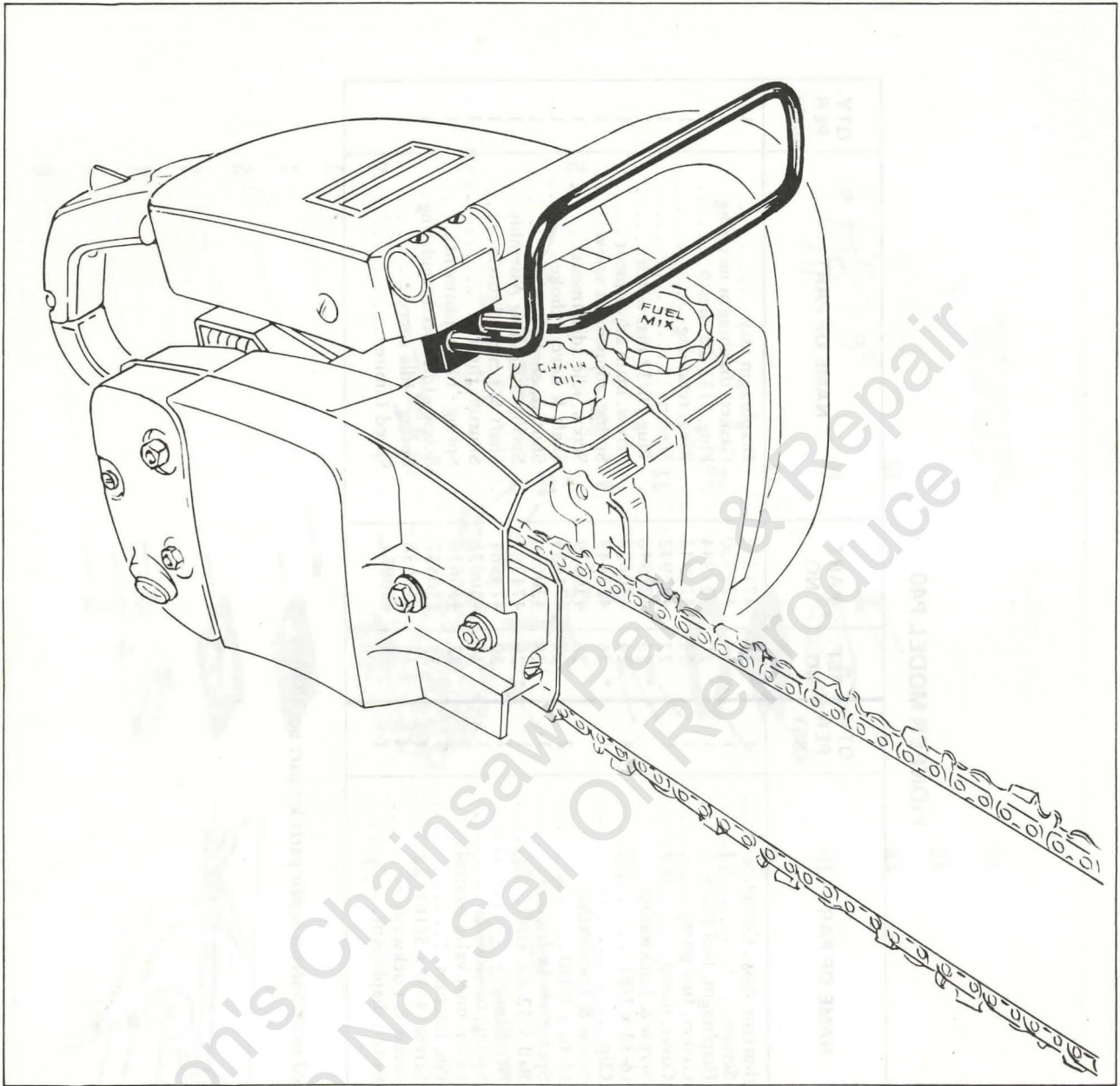

This steel handle guard is now available as an accessory for the Pioneer professional chain saw line (part no. 474614). It is bracketed to the front handle of the P40 to protect the operator if his hand slips off the handle.

ORDER ALL ACCESSORIES FROM YOUR LOCAL AUTHORIZED DEALER