

35 CENTS



ILLUSTRATED PARTS CATALOGUE

model P 10

NO E100178 REPRINTED APRIL 80



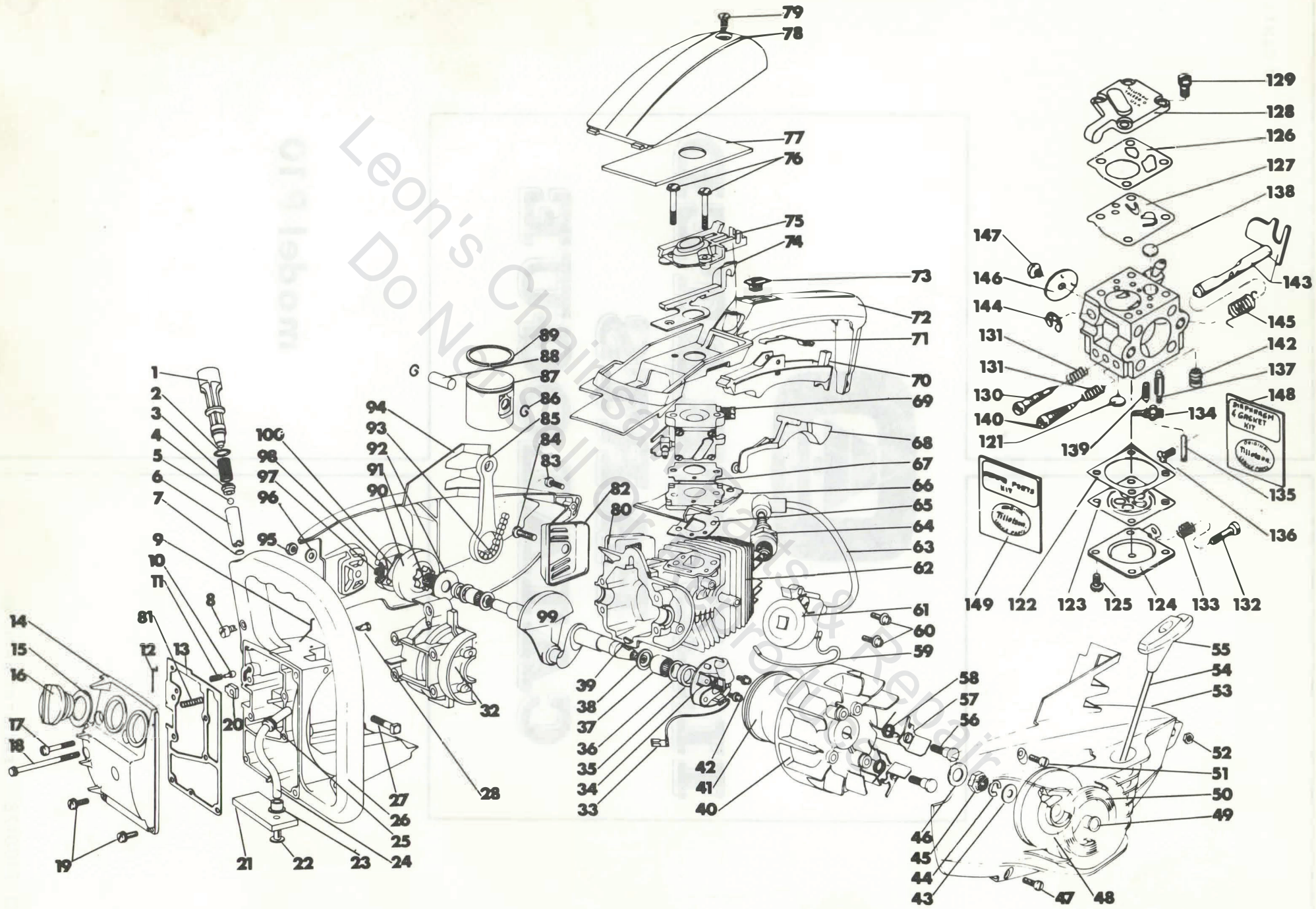

Leon's Do N. Ch...

019 lebon

Item No.	Part No.	NAME	Included in Assembly Coded	No. Used
1	X100032*	Piston	A	1
2	X100132	O Ring	A	1
3	X100039	Spring		1
4	X100036*	Insert	B	1
5	X100038*	Ball	B	1
6	X100031*	Body	B	1
7	X100035*	Screen	B	1
8	X480101	Screw		1
9	X100115	Vent Wire		1
10	X100037	Valve		1
11	X100137	Spring		1
12	X100115	Vent Wire		1
13	X100042	Gasket		1
14	X101040	Cover	P	1
15	X100045	Gasket		2
16	X100041	Filler Cap		2
17	X410622*	Screw	C & P	1
18	X433558	Screw		4
19	X418512	Screw		2
20	X100043*	Nut	C & P	1
21	X100044	Filter	D	1
22	X100034*	Pickup	D	1
23	X100064*	Collar	D	1
24	X100126	Hose		1
25	X100125	Grommet		1
26	X101030	Tank and Handle		1
27	X470820	Bar Bolt		1
28	X100237	D.B. Impulse Valve		1
29				
30				
31				
32	X101020*	Crankcase	F	1
33	X100186	Lead	G	1
34	X100680	Breaker Plate	G	1
35	X100027	Oil Seal		2
36	X100026	Retaining Ring		2
37	X100025	Bearing		2
38	X100023	Thrust Washer		2
39	X100111	Flywheel Key		1
40	X100110*	Flywheel	H	1
41	X100083	Cover		1
42	X418406	Screw		2
43	X100077	Washer	I	1
44	X100078	Retainer	I	1
45	X520900	Nut		1
46	X610902	Washer		1
47	X418512	Screw		1
48	X100072	Pulley	I	1
49	X100076	Bushing	I	1
50	X100073	Spring	I	1

* available only in part of assembly

Item No.	Part No.	NAME	Included in Assembly Coded	No. Used
51	X418512	Screw		1
52	X508500	Nut	I & J	1
53	X101671*	Fan Housing	I & J	1
54	X100075	Rope	I	1
55	X100074	Handle	I	1
56	X100084	Pivot Pin	H	2
57	X100081	Pawl	H	2
58	X100082	Spring	H	2
59	X100196	Switch Lead	Q	1
60	X428412	Screw		2
61	X100690*	Coil and Core	Q	1
62	X100010*	Cylinder and Block	F	1
63	X100590*	High Tension Lead	Q	1
64	X100300	Spark Plug		1
65	X100095	Gasket		1
66	X100093	Insulator Block		1
67	X100094	Gasket		1
68	X100053	Throttle Trigger		1
69	X101090	Carburetor		1
70	X101055	Handle Filler		1
71	X100054	Spring Contact Switch		1
72	X100050	Rear Handle		1
73	X100052	On-Off-Slider-Switch		1
74	X100092	Choke Slide		1
75	X100091	Choke Holder		1
76	X423536	Screw		2
77	X100251	Air Filter		1
78	X100056	Cover		1
79	X423506	Screw		1
80	X100260	Muffler Body		1

Assembly Code	Part No.	Name	Includes
A	X100632	Piston Assy.	1,2
B	X100630	Oil Pick-up Assy.	4,5,6,7
C	X100810	Chain Adjuster Assy.	17,20,81
D	X100534	Fuel Pick-up Assy.	21,22,23
F	X100622	Crankcase & Cyl. Block	32,62
G	X100680	Breaker Plate Assy.	33,34
H	X100510	Flywheel Assy.	40,56,57,58
I	X101672	Fan Housing & Starter Assy.	43,44,48,49,50,52,53,54,55
J	X101671	Fan Housing & Nut Assy.	52,53
N	X100540	Clutch Assy.	97,98,100
O	X100600	Piston Assy.	86,87,88,89
P	X101640	Tank Cover Assy.	14,17,20,12,81
Q	X100690	Coil & Core Assy.	59,61,63

Item No.	Part No.	NAME	Included in Assembly Coded	No. Used
81	X100063	Spring	C & P	1
82	X100262	Muffler Cover		1
83	X410002	Chain Cover Screw		1
84	X428516	Muffler Screw		1
85	X100022	Connecting Rod		1
86	X100103	Wrist Pin Clip	O	2
87	X100100	Piston	O	1
88	X100102	Wrist Pin	O	1
89	X100101	Piston Ring	O	1
90	X100551	Sprocket & Drum		1
91	X100159	Clutch Bearing		1
92	X100151	Side-Plate-Clutch		1
93	X100024	Rollers — Big End		11
94	X101060	Chain Cover		1
95	X520800	Nut-Bar Bolt		1
96	X610801	Washer-Bar Bolt		1
97	X100246	Spring Clutch	N	2
98	X100245	Clutch Shoe	N	2
99	X100021	Crankshaft		1
100	X100545	Clutch Driver	N	1
121	X015083	Body Channel Welch Plug		1
122	X014679	Diaphragm Gasket		1
123	X015094	Diaphragm		1
124	X015819	Diaphragm Cover		1
125	X08942	Diaphragm Cover Ret. Screw & L/Washer		4
126	X014694	Fuel Pump Gasket		1
127	X014693	Fuel Pump Diaphragm		1
128	X015857	Fuel Pump Body		1
129	X015089	Fuel Pump Body Ret. Screw & L/Washer		4
130	X015589	Idle Mixture Screw		1
131	X08793	Mixture Screw Spring		2
132	X013270	Idle Speed Screw		1
133	X011431	Idle Speed Screw Spring		1
134	X015651	Inlet Control Lever		1
135	X015084	Inlet Fulcrum Pin		1
136	X013269	Inlet Fulcrum Pin Ret. Screw		1
137	X013396	Inlet Needle		1
138	X012727	Inlet Screen		1
139	X015673	Inlet Tension Spring		1
140	X015861	High Speed Mixture Screw		1
142	X015658	Nozzle Check Valve		1
143	X017310	Throttle Shaft & Lever		1
144	X012038	Throttle Shaft Ret. Ring		1
145	X015859	Throttle Return Spring		1
146	X014867	Throttle Shutter		1
147	X010280	Throttle Shutter Screw & Lockwasher		1
148	DG-1HU	Dia./Gasket Kit		1
149	RK-1HU	Repair Parts Kit		1

Pioneer P10 Specifications

Dry Weight (less attachments)	6.6 lbs.	Bore	1.4375
Type of Drive	Direct	Stroke	1.281
Front Handle	Diecast with Tank Body	Displacement	2.2 cu. in.
Chain Oil Pump	Automatic with Manual Override	Compression Ratio	7.1 to 1
Choke or Primer	Choke	Compression Pressure	120 P.S.I. Cold
Muffler	Large Capacity	Crankshaft	1 Piece Forged Alloy Steel
Throttle Lock	None	Crankshaft Main Bearings	Anti-Friction Caged Needle Roller
Guide Bar	12" Sprocket Nose Bar	Crankshaft Seals	Closure Type
Sprocket	3/8" Pitch 6 Tooth Star	Connecting Rod	1 Piece Steel
Chain	3/8" Pitch .050 Gauge 44 Drive Links	Piston	Permanent Mold Aluminum Alloy
Optional Cutting Attachments	16" Sprocket Nose Bar, 3/8" Pitch Chain .050 Ga.	Piston Rings	1
Spark Plug & Gap	CJ6 Champion — .030	Cylinder Type	Chrome Plated Aluminum
Point Gap015	Starter	Pawl Type
Fuel Capacity	275 c.c.	Clutch	Centrifugal — 2 Shoe
Oil Capacity	110 c.c.	Ignition	Flywheel Magneto — Breaker Type
Engine Lubrication	Pioneer Special Engine Lubricant	Intake	Piston Ported
Fuel/Oil Mix Ratio	16 to 1	Carburetor	Tillotson HU
Chain Oil	Pioneer Bar & Chain Oil	Air Filter	Feutron
Engine Type	Single Cylinder, 2 Cycle, Air Cooled	Fuel Filter	Felt
		Cylinder Angle	Horizontal
		RPM @ Max. H.P.	8000
		Chain Speed @ Max. H.P.	2700 ft./min.

Leon's Chains & Sprockets
Do Not Sell