

SUPER LG-6 AUTOMATIC Chain Saw

Model Number 600410D

Serial Numbers Prefixed 12-

ILLUSTRATED PARTS LIST

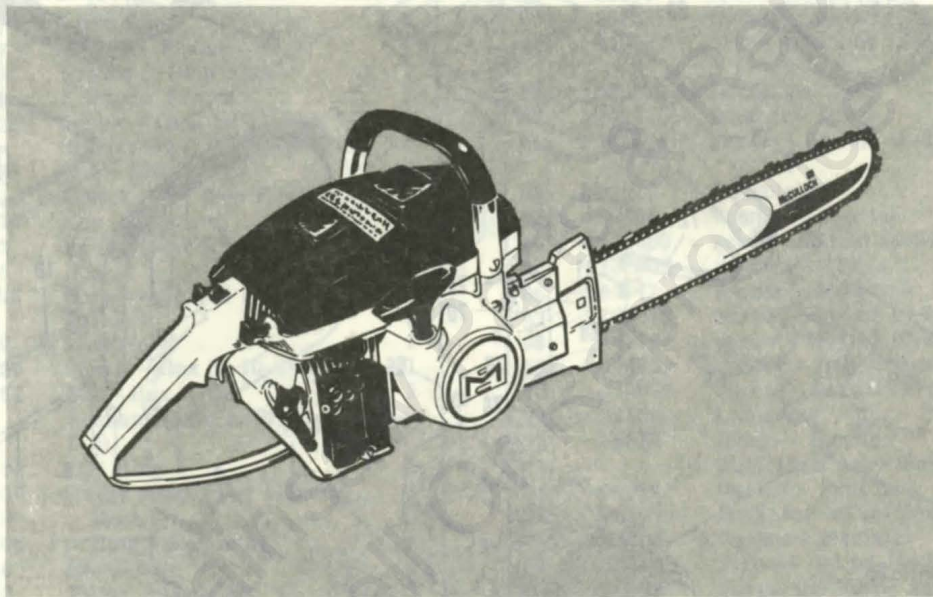

MARCH 1970

The policy of McCulloch Corporation is one of continual improvement in design, manufacturing and engineering advancement wherever possible to assure still finer two-cycle power tools. Hence, specifications, equipment, colors, design and manufacturer's suggested list prices are subject to change without notice and McCulloch Corporation reserves the right to make such changes without prior notification or obligation to backfit or supply backfit components for units previously shipped from the factory.

	Page
Figure 1. Engine Exploded View - General	2
Figure 2. Clutch & Starter Assembly	4
Figure 3. Fuel Tank Assembly	4
Figure 4. Carburetor Assembly	6
Figure 5. Transmission Assembly	8
Figure 6. Powerhead Assembly	10



McCULLOCH

SUPER LG-6 AUTOMATIC

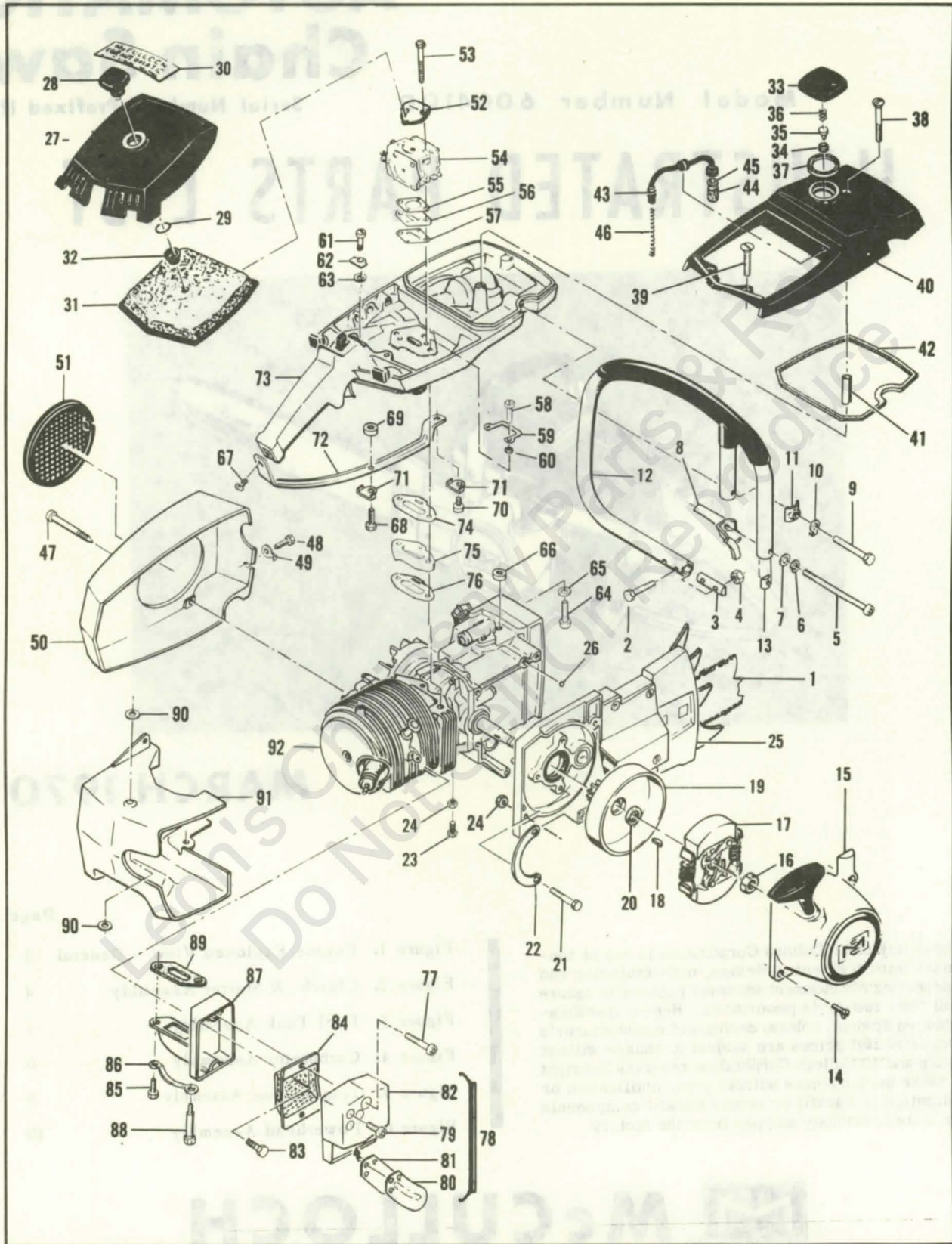

Figure 1. General

FIGURE 1. GENERAL

Item No.	Part Number	Description	Units Per Assy
1		Bar & Chain Assy (See Figure 5)	
2	102761	Screw - Hex hd 10-24 x 7/8	2
3	61678	Plug - Nut retainer	1
4	101326	Nut - Hex 10-24	2
5	110448	Screw - Skt hd 10-24 x 3-1/4	1
6	103174	Lockwasher - #10	1
7	100003	Washer - #10	1
8	68503	Bracket - Frame	1
9	102130	Screw - Hex hd 1/4-20 x 1-1/2	1
10	69947	Lockplate	1
11	63484	Clamp - Frame	1
12	68458	Frame & Grip Assy	1
13	62271	. Plug - Frame	1
14	110622	Screw - Oval hd 10-24 x 7/8	1
15		Starter Assy (See Figure 2)	
16	110594	Nut - Hex 3/8-24	1
17		Clutch Assy (See Figure 2)	
18	103879	Key - Woodruff	1
19	63493	Drum, Gear & Seal Assy	1
20	63476	. Seal	1
21	104243	Screw - Hex hd 1/4-20 x 1-3/4	2
22	68509	Lockplate	1
23	103469	Screw - Hex hd 10-24 x 3/8	1
24	105367	Nut - Hex 10-24	2
25		Transmission Assy (See Figure 5)	
26	106104	"O" Ring	1
27	68530	Cover Assy - Air cleaner	1
28	68529	. Knob	1
29	110565	. Ring - Retaining	1
30	83366	Nameplate	1
31	83230	Filter Assy - Air	1
32	68528	. Grommet	1
33	68531	Fuel Cap Assy	1
34	68533	. Plug	1
35	63041	. Valve	1
36	63040	. Spring	1
37	69767	. Gasket	1
38	110402	Screw - Oval hd 12-24 x 2-3/8	1
39	103579	Screw - Fl hd 10-24 x 1	2
40	69679	Cover - Fuel tank	1
41	69686	Spacer - Cover	1
42	69345	Gasket - Fuel tank	1
43	64848	Hose Assy - Fuel	1
44	63932	. Filter - Fuel	1
45	100440	. Washer	1
46	67944	Spring - Hose	1
47	62978	Screw - Special	3

Item No.	Part Number	Description	Units Per Assy
48	102762	Screw - 10-24 x 1/2	1
49	69890	Lockplate	1
50	83521	Kit - Fan housing	1
51	55615	. Guard - Flywheel	1
52	83204	Kit - Bracket Assy	1
53	103357	. Screw - Hex hd 10-24 x 2-1/4	2
54		Carburetor Assy (See Figure 4)	
55	68132	Gasket - Carburetor	1
56	66678	Spacer - Carburetor	1
57	68131	Gasket - Spacer	1
58	110567	Screw - Hex hd 12-24 x 1-1/4	2
59	68582	Lockplate	1
60	102115	Washer - #12	2
61	110568	Screw - Hex hd 12-24 x 1-1/8	1
62	69516	Lockplate	1
63	64856	Washer - Special	1
64	102660	Screw - Skt hd 10-24 x 7/8	1
65	100003	Washer - #10	1
66	69772	Spacer - Fuel tank	1
67	106078	Screw - Hex hd 10-24 x 7/16	1
68	102761	Screw - Hex hd 10-24 x 7/8	1
69	69830	Spacer - Handle brace	1
70	110566	Screw - Hex hd 12-24 x 5/8	1
71	68508	Lockplate	2
72	69838	Brace - Handle	1
73		Fuel Tank Assy (See Figure 3)	
74	84082	Gasket - Fuel tank	1
75	68579	Insulator - Fuel tank	1
76	68594	Gasket - Insulator	1
77	104560	Screw - Skt hd 10-24 x 1-1/2	2
78	65532	Cover and Valve Assy	1
79	110472	. Screw - Skt hd 8-32 x 5/16	3
80	83069	. Stop - Reed valve	1
81	64785	. Valve - Reed	1
82	65419	. Cover Assy - Spark arrester	1
83	110529	Screw - Hex hd 10-24 x 1/2	1
84	62379B	Baffle	1
85	110529	Screw - Hex hd 10-24 x 1/2	1
86	67922	Lockplate	1
87	83106	Body and Duct Assy	1
88	68187	. Screw - Hex hd 10-24 x 1-3/8 Special	1
89	68149	Gasket - Spark arrester	1
90	68581	Insulator	2
91	67910	Shroud	1
92		Powerhead Assy (See Figure 6)	

SUPER LG-6 AUTOMATIC

FIGURE 1 ORIGINAL

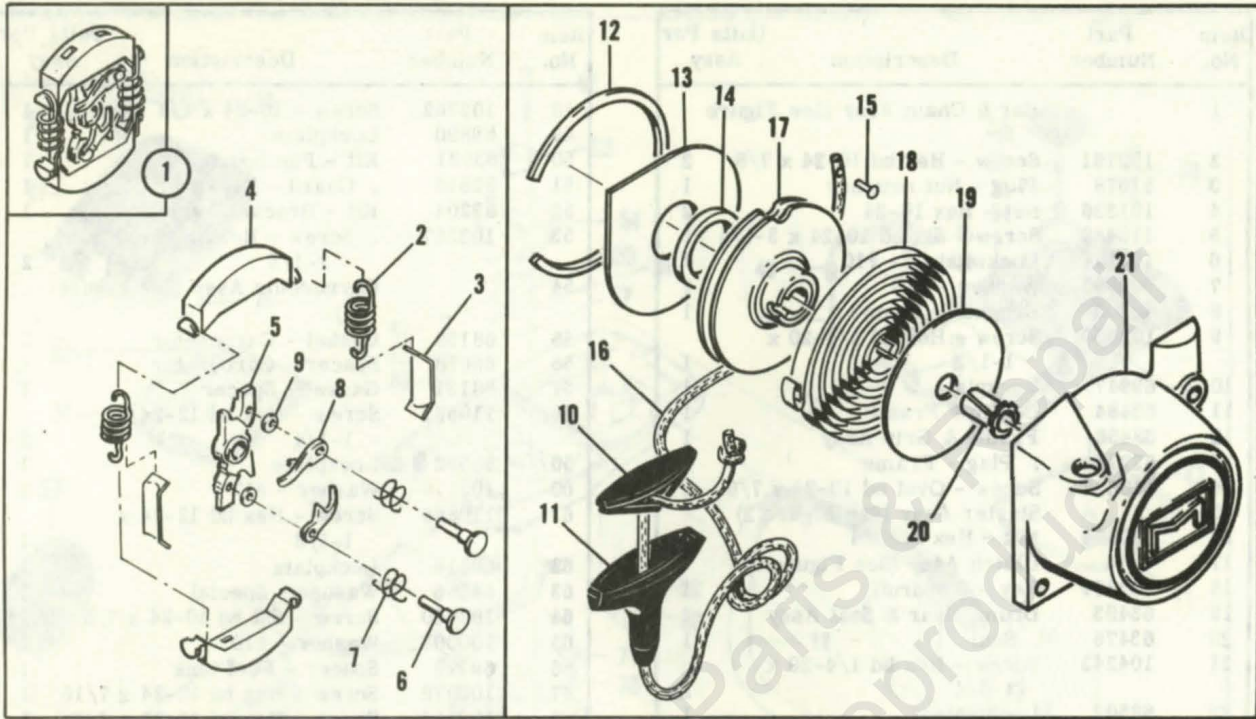

Figure 2. Clutch and Starter Assembly

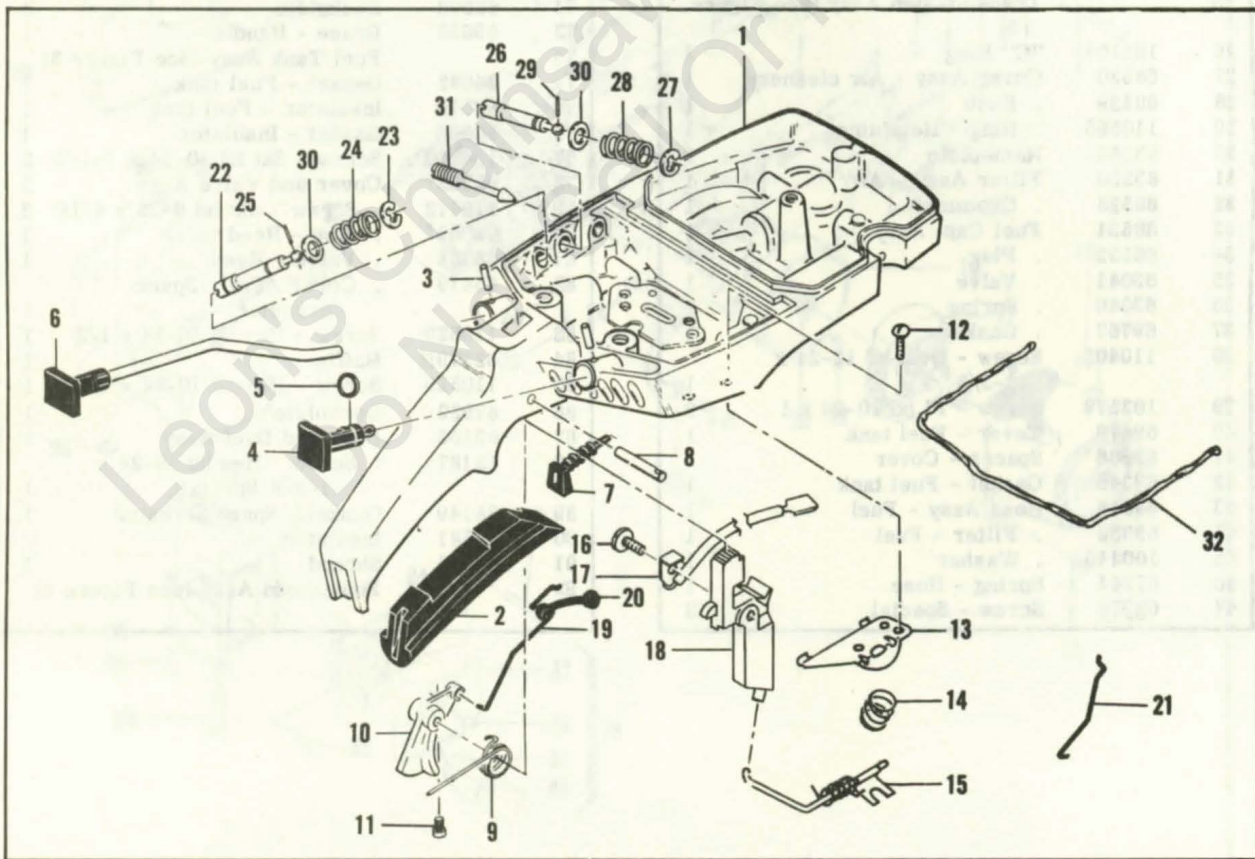

Figure 3. Fuel Tank Assembly

FIGURE 2. CLUTCH AND STARTER ASSEMBLY

Item No.	Part Number	Description	Units Per Assy
1	83656	Clutch Assy	1
2	66384	. Spring - Clutch	2
3	64583	. Retainer - Spring	2
4	67233	. Shoe - Clutch	2
5	83671	. Rotor Assy	1
6	83653	. . Rivet	2
7	83654	. . Spring	2
8	24093	. . Pawl	2
9	65473	. . Washer	2
	83694	Starter Assy	1
10	62191A	. Insert	1

Item No.	Part Number	Description	Units Per Assy
11	62190A	. Handle	1
12	67205	. Retainer - Shield	1
13	63985	. Shield - Dust	1
14	63986	. Washer - Thrust	1
15	110470	. Rivet - Rope	1
16	69964	. Rope - Starter	1
17	83651	. Drum - Starter	1
18	83334	. Spring - Rewind	1
19	63987	. Shield - Spring	1
20	61635A	. Bushing - Nyliner	1
21	67059	. Housing - Starter	1

FIGURE 3. FUEL TANK ASSEMBLY

Item No.	Part Number	Description	Units Per Assy
1	68683	Fuel Tank Assy	1
2	64872	Grip - Handle	1
3	105673	Pin - Roll 3/32 x 9/16	2
4	69041	Button - Choke	1
5	101056	"O" Ring	1
6	64871	Button & Rod Assy	1
7	68522	Seal - Throttle rod	1
8	110378	Pin - Roll 3/16 x 15/16	1
9	65734	Spring - Throttle return	1
10	67224	Trigger	1
11	110537	Screw - Trigger adjustment	1
12	105249	Screw - Rd hd 8-32 x 3/8	2
13	64721	Bracket - Lever Assy	1
14	69687	Spring - Valve	1
15	69811	Lever Assy - Compression release	1

Item No.	Part Number	Description	Units Per Assy
16	110385	Screw - Pan hd 8-32 x 3/8	1
17	65873	Wire Assy - Stop switch	1
18	67209	Button - Control	1
19	68170	Rod - Throttle	1
20	69043	Snubber - Rod	1
21	69042	Rod - Choke	1
22	68102	Extension Assy - High speed	1
23	110512	. Ring - Retaining	1
24	67363	. Spring	1
25	110509	. Pin - Groove	1
26	68101	Extension Assy - Idle	1
27	110512	. Ring - Retaining	1
28	67363	. Spring	1
29	110509	. Pin - Groove	1
30	67292	Washer	2
31	67271	Screw - Idle adjustment	1
32	*69564	Seal - Airbox	AR

*Furnished on a 121/2 inch strip containing 9 beads of sealant (enough for 9 replacements)

SUPER LG-6 AUTOMATIC

FIGURE 3. CLUTCH AND STARTER ASSEMBLY

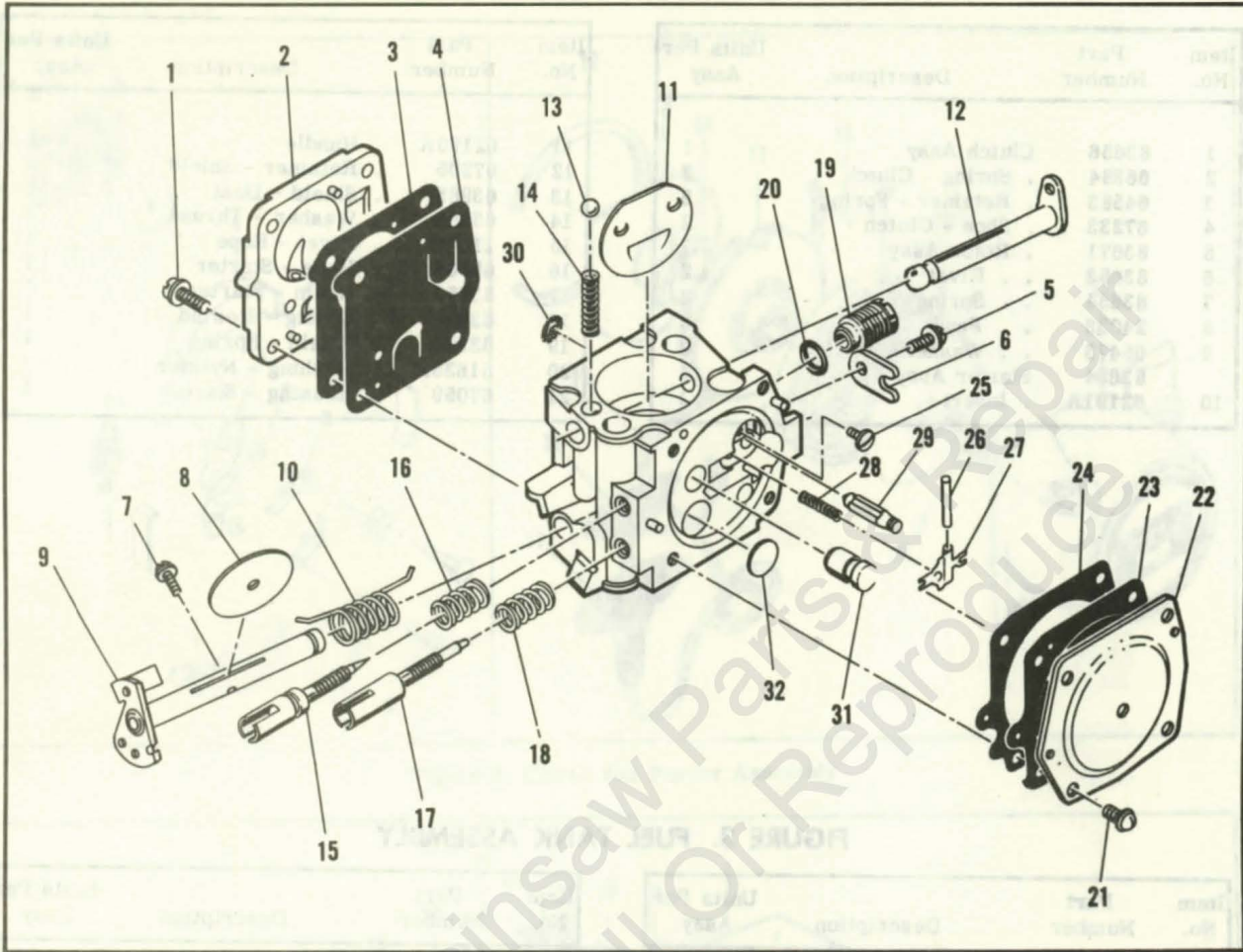
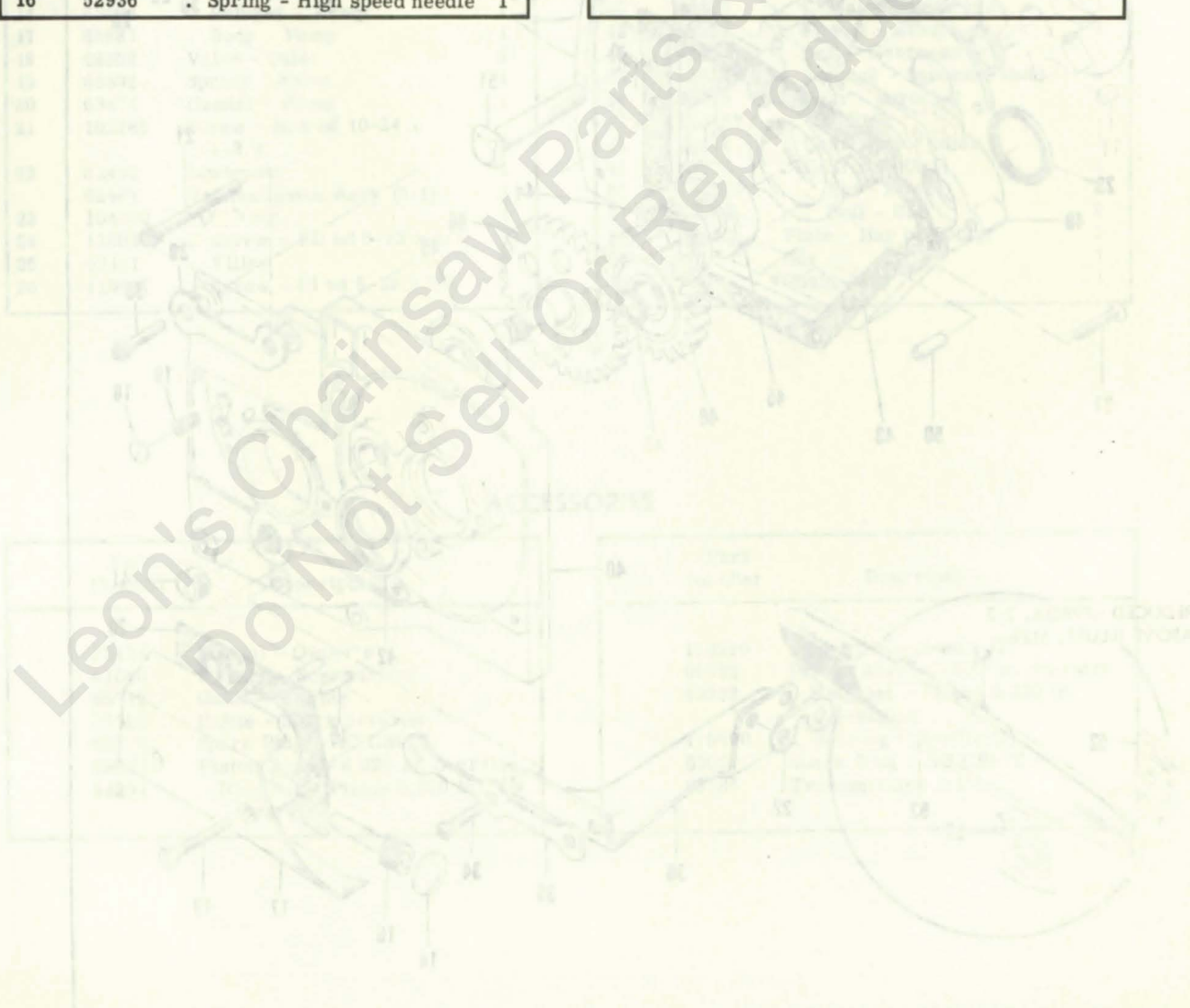

Figure 4. Carburetor Assembly

Leon's Chainsaw Parts & Repair
Do Not Sell Or Reproduce

FIGURE 4. CARBURETOR ASSEMBLY

Item No.	Part Number	Description	Units Per Assy	Item No.	Part Number	Description	Units Per Assy
	69948	Carburetor Assy	1	17	83547	. Needle - Idle	1
1	52933	. Screw - Pump cover	4	18	67133	. Spring - Idle needle	1
2	66628	. Cover - Pump	1	19	83549	. Valve Assy - Governor	1
3	66629	. Gasket - Cover	1	20	83548	. Gasket - Valve	1
4	66630	. Diaphragm - Fuel pump	1	21	51721	. Screw - Diaphragm cover	4
5	48780	. Screw - Clip retainer	1	22	83724	. Cover - Diaphragm	1
6	66646	. Clip - Throttle shaft	1	23	66632	. Diaphragm - Metering	1
7	48780	. Screw - Plate	1	24	66633	. Gasket - Diaphragm	1
8	51720	. Plate - Throttle	1	25	83479	. Screw - Lever pin	1
9	83546	. Shaft Assy - Throttle	1	26	66636	. Pin - Lever	1
10	67136	. Spring - Throttle return	1	27	66638	. Lever - Metering	1
11	65856	. Plate - Choke	1	28	66404	. Spring - Lever	1
12	83725	. Shaft Assy - Choke	1	29	66637	. Valve - Needle	1
13	100071	. Ball - Choke friction	1	30	66623	. Screen - Fuel inlet	1
14	52930	. Spring - Choke friction	1	31	83729	. Check Valve - Nozzle	1
15	83477	. Needle - High speed	1	32	66622	. Plug - Welch	1
16	52936	. Spring - High speed needle	1				



Leon's Chainsaw Parts & Reproduction
Do Not Sell Or Reproduce

SUPER LG-6 AUTOMATIC

FIGURE 4 CALCULATOR ASSEMBLY

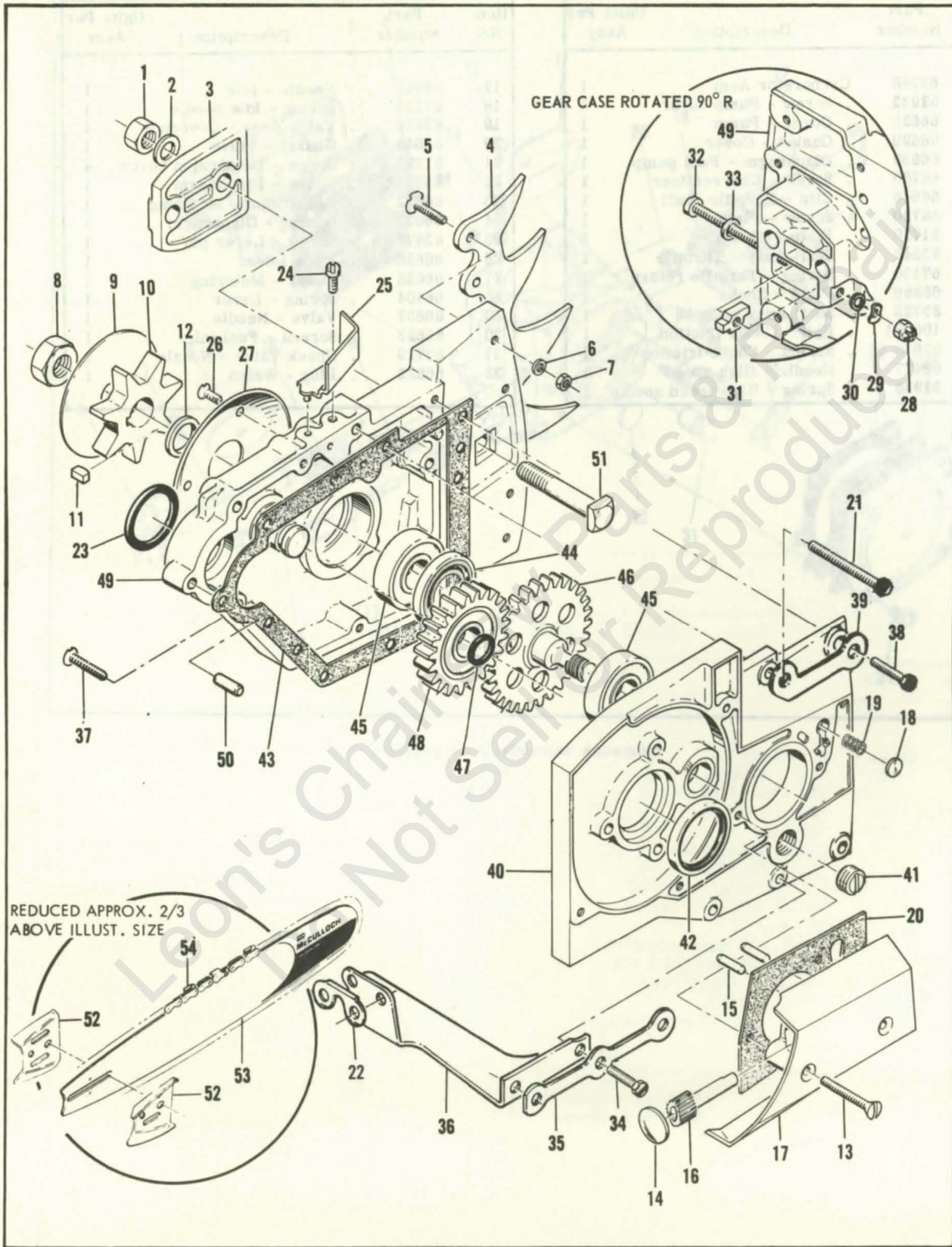

Figure 5. Transmission Assembly

FIGURE 5. TRANSMISSION ASSEMBLY

Item No.	Part Number	Description	Units Per Assy	Item No.	Part Number	Description	Units Per Assy
1	110625	Nut - Hex 3/8-24.	2	27	63416	. Plate - Sprocket	1
2	100006	Washer - 3/8	2	28	102067	. Nut - Hex 10-24	1
3	63417	Plate - Bar clamp	1	29	110387	. Washer - Wave	1
4	63994	Kit - Spike	1	30	100003	. Washer - #10	1
5	110245	. Screw - Fl hd 10-24 x 3/4	4	31	63824A	. Nut - Bar adjustment	1
6	101174	. Washer - #10	4	32	110548	. Screw - Bar adjustment	1
7	101191	. Nut - Hex 10-24	4	33	110264	. Washer - #10	1
8	60972	Nut - Hex 7/16-20	1	34	102290	. Screw - Hex hd 10-24 x 1-1/8	1
9	63997A	Plate - Sprocket	1	35	83457	. Lockplate	1
10	36644A	Sprocket	1	36	67066	. Brace - Gearcase	1
11	63808	Key - Sprocket	1	37	110405	. Screw - Oval hd 8-32 x 7/8	3
12	64754	Spacer - Sprocket	1	38	102760	. Screw - Hex hd 10-24 x 1	2
13	110406	Screw - Oval hd 8-32 x 1-1/4	2	39	83456	. Lockplate	1
	65882	Pump Assy - Oil	1	40	68490	. Cover Assy - Gearcase (3:1)	1
14	105559	. Plug - Welch	1	41	100432	. . Plug - Filler	1
15	110392	. Pin - Plunger	2	42	63477	. . Seal - Pinion gear	1
16	63428	. Plunger - Pump	1	43	68576	. Gasket - Cover	1
17	65881	. Body - Pump	1	44	63478	. Seal - Gearcase	1
18	62909	Valve - Oiler	1	45	110348	. Bearing - Sprocket shaft	2
19	63692	Spring - Valve	1	46	64775	. Gear - Sprocket	1
20	63474	Gasket - Pump	1	47	110452	. "O" Ring	1
21	102765	Screw - Hex hd 10-24 x 1-3/4	2	48	66616	. Gear Assy - Idler	1
22	83455	Lockplate	1	49	68488	. Gearcase (3:1)	1
	68487	Transmission Assy (3:1)	1	50	101770	. . Pin - Dowel	2
23	104360	"O" Ring	1	51	64584	. . Bolt - Bar	2
24	110055	. Screw - Fil hd 8-32 x 3/8	1	52	64935	Plate - Bar protector	2
25	63491	. Filler	1	53		Bar	1
26	110417	. Screw - Fl hd 6-32 x 3/8	3	54		Chain Assy	1

ACCESSORIES

Part Number	Description
83434	Manual - Owner's
61040	Wrench - Screwdriver
65712	Guide - Timing
65325	Baffle - Spark arrester
65778	Spark Plug - AC CS41T
69031	Piston Assy - 0.020 in. oversize
63291	. Ring Set - Piston 0.020 in. oversize

Part Number	Description
110590	. Bearing - Needle (2)
69032	Piston Assy - 0.030 in. oversize
63292	. Ring Set - Piston 0.030 in. oversize
110590	. Bearing - Needle (2)
63097	Spark Plug - AC CS45T
68585	Transmission 2:1

SUPER LG-6 AUTOMATIC

FIGURE 2 TRANSMISSION ASSEMBLY

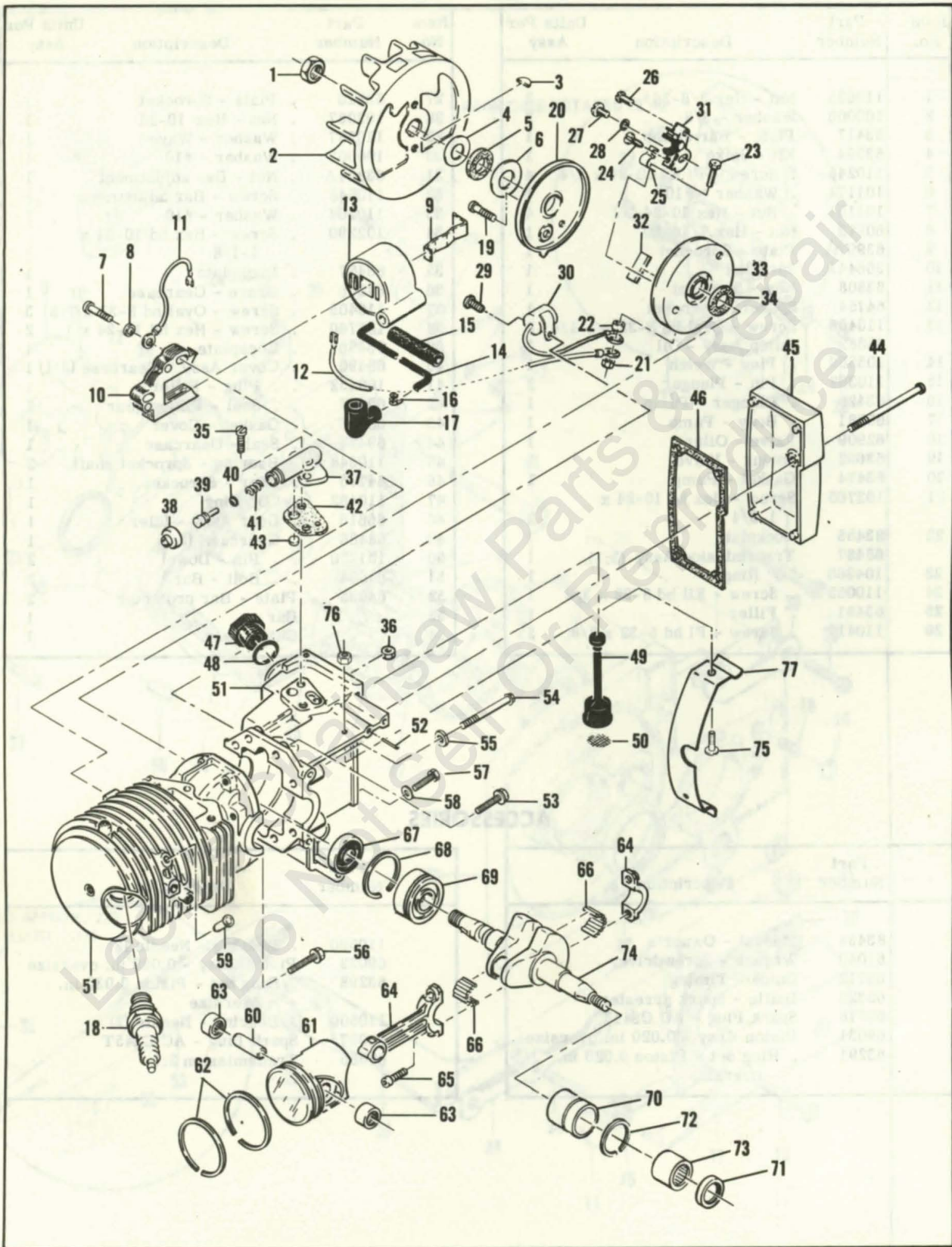

Figure 6. Powerhead Assembly

FIGURE 6. POWERHEAD ASSEMBLY

Item No.	Part Number	Description	Units Per Assy
1	110594	Nut - Hex 3/8-24	1
2	67845	Flywheel Assy	1
3	103879	Key - Woodruff	1
4	67057	Washer - Thrust	1
5	67056	Seal	1
6	67054	Washer - Thrust	1
7	110127	Screw - Fil hd 10-24 x 7/8	2
8	100003	Washer - #10	2
9	51253	Retainer - Coil	1
10	68164	Lamination Assy	1
11	62819	Wire Assy - Ground	1
12	69344	Wire Assy - Primary	1
13	69798	Kit - Coil & Terminal Assy	1
14	69966	. Wire & Sleeve Assy - Spark plug	1
15	67127	. . Sleeve	1
16	62932	. . Connector	1
17	62926	. . Boot	1
18	63432	Spark Plug	1
19	110349	Screw - Rd hd 8-32 x 3/4	1
20	62362	Cover - Breaker box	1
21	100298	Nut - Hex 6-32	1
22	62365	Spacer - Breaker screw	1
23	110346	Screw - Hex hd 6-32 x 3/4	1
24	110489	Screw - Pan hd 6-32 x 7/16	1
25	83126	Strap - Conduction	1
26	100934	Screw - Rd hd 8-32 x 3/8	2
27	110445	Screw - Truss hd 8-32 x 3/8	1
28	105976	Washer - #8	1
29	110544	Screw - Pan hd 8-32 x 3/8	1
30	61650	Condenser	1
31	66231	Breaker Assy	1
32	54184	Wiper - Cam	1
33	83125	Box - Breaker	1
34	67051	Seal - Box	1
35	110623	Screw - Fil hd 8-32 x 1/2	2
36	100955	Nut - Hex 8-32	1
37	62261A	Housing - Pump	1
38	62262	Cap - Housing	1
39	62266	Plunger - Pump	1

Item No.	Part Number	Description	Units Per Assy
40	101056	"O" Ring	1
41	66687	Spring - Plunger	1
42	62230	Gasket - Pump	1
43	62909	Valve - Pump	1
44	110407	Screw - Pan hd 10-24 x 3-1/2	1
45	63974	Cover - Oil tank	1
46	63442	Gasket - Cover	1
47	68809	Cap	1
48	101148	"O" Ring	1
49	62123B	Hose Assy - Oil	1
50	51506	. Screen - Hose	1
51	69846	Crankcase Assy	1
52	105826	. Pin - Roll	1
53	110288	. Screw Assy - 8-32 x 3/4	2
54	62105	Screw Assy - Sealing	4
55	62842	. Washer - Sealing	4
56	110404	Screw Assy - 8-32 x 7/8	1
57	63607	Screw Assy - Sealing	1
58	63606	. Washer - Sealing	1
59	83137	Valve - Compression release	1
60	69020	Pin - Piston	1
61	69030	Piston Assy	1
62	63290	. Ring Set - Piston	1
63	110590	. Bearing - Needle	2
64	83060	Connecting Rod Assy	1
65	61627A	. Screw - Skt hd 8-36 x 1/2	2
66	63225	. Roller - Needle (set of 20)	1
67	65746	Oil Seal	1
68	63464	Ring - Snap	1
69	63429B	Bearing - Ball	1
70	63492	Insert & Bearing Assy	1
71	65747	. Oil Seal	1
72	63699	. Ring - Insert	1
73	104357	. Bearing - Needle	1
74	68505	Crankshaft	1
75	105221	Screw - Rd hd 10-24 x 5/16	2
76	101191	Nut - Hex 10-24	2
77	65363	Guard - Crankcase	1

SERVICE SPECIFICATIONS

Spark Plug Gap -----	0.025 in.
Lamination Gap -----	0.010 to 0.015 in.
Breaker Point Gap -----	0.018 in.
Carburetor Adjustment	
Idle Needle - Preliminary adjustment 1 turn open. Adjust for smooth idle and acceleration.	
Main Needle - Preliminary adjustment 1 turn open. Adjust for maximum power under load.	
Torque Values	
Flywheel Nut -----	240 to 300 inch-pounds.
Clutch Nut -----	160 to 170 inch-pounds.
Connecting Rod Screws -----	65 to 70 inch-pounds.



McCULLOCH



● **MANUFACTURING** ● **SALES** ● **SERVICE** ●

McCULLOCH CORPORATION

6101 WEST CENTURY BLVD., LOS ANGELES, CALIFORNIA 90045

INTERNATIONAL DIVISIONS:

LOS ANGELES, CALIF., P. O. BOX 45466
HONG KONG, B. C. C.: G. P. O. BOX 879

McCULLOCH OF CANADA LTD.

6338 VISCOUNT ROAD, MALTON, ONTARIO, CANADA

McCULLOCH OF EUROPE, N. V.

ANTOON SPINOYSTRAAT, 5, B-2800 MECHELEN, BELGIUM

McCULLOCH OF AUSTRALIA PTY., LTD.

P.O. BOX 223, SEVEN HILLS, N.S.W. 2147, AUSTRALIA

Table listing various product models and their corresponding page numbers, including items like '110000', '110001', '110002', etc.

Table listing 'SERVICE SPECIFICATIONS' with various technical details and page numbers.

Table listing 'SPECIFICATIONS' for various models, including '110000', '110001', '110002', etc.