

ILLUSTRATED PARTS LIST

MODELS	SERIAL NUMBER PREFIX	MODELS	SERIAL NUMBER PREFIX
600072-01	11-, 12-	600072-14	12-
600072-02	11-, 12-	600072-18	12-
600072-03	12-	600072-19	12-
600072-04	11-, 12-	600072-20	12-
600072-05	11-	600072-21	12-
600072-10	11-, 12-		

PRO MAC™ 800 CHAIN SAW



McCulloch Chain Saws are identified by a model number (in this instance 600072) followed by a suffix number (01, 02, 03, etc.). Suffix numbers denote variations in parts or assemblies used in the manufacture of this product.

Part numbers listed in this I.P.L. which have a circled number ① or numbers preceding the description, are used only on the model or models identified by a circled number or numbers ①.

Part numbers which have one or more dots (.) preceding their descriptions may be ordered individually, but they are also included in the kit or assembly whose description begins directly above the dot(s).

Part number(s) in this I.P.L. which were not in the previous I.P.L. covering these saws, are indicated by a dash (-) preceding the new part number(s).

The policy of McCulloch Corporation is one of continual improvement in design, manufacturing and engineering advancement wherever possible to assure still finer power tools. Hence, specifications, equipment, colors, design and manufacturer's suggested list prices are subject to change without notice and McCulloch Corporation reserves the right to make such changes without prior notification or obligation to backfit or supply backfit components for units previously shipped from the factory.

JUNE 1988

CONTENTS

	PAGE
FIGURE 1 General Assembly	2
FIGURE 2 Chain Brake Assembly	4
FIGURE 3 Fan Housing/Starter Assembly	5
FIGURE 4 Carburetor Assembly (SDC 38A)	6
FIGURE 5 Carburetor Assembly (Zama C-2, C-3)	7
FIGURE 6 Powerhead Assembly	8
FIGURE 7 Fuel Tank Assembly	10
FIGURE 8 Specifications	11
FIGURE 9 Tools	11



Figure 1 GENERAL ASSEMBLY

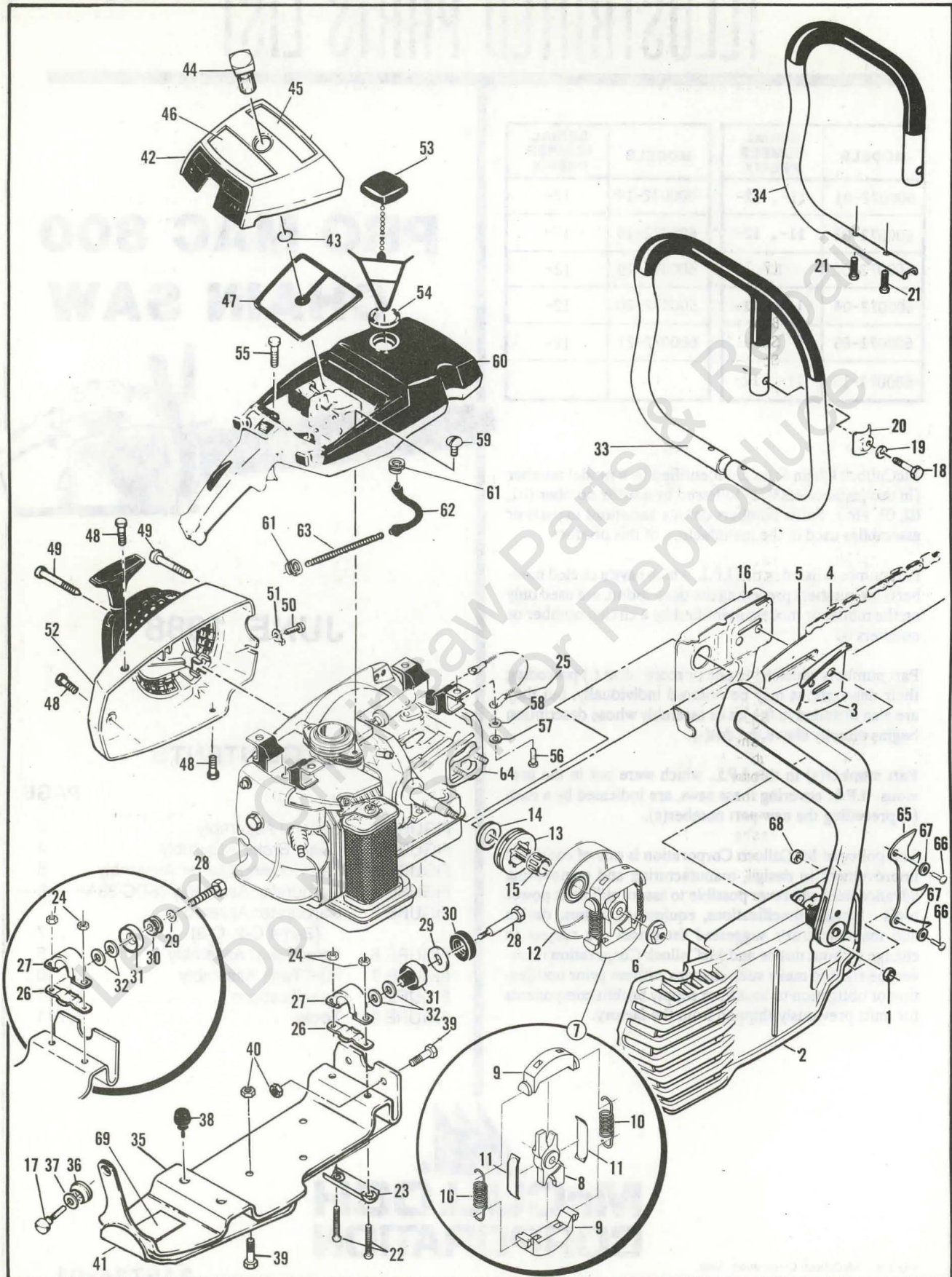

FIGURE 1 GENERAL ASSEMBLY

ITEM NO.	PART NUMBER	DESCRIPTION	UNITS PER ASY.
1	-216645	Nut - M8 Hx Flange	2
2	FIG. 2	CHAIN BRAKE Asy	1
3	64325	Plate - Bar Protector	1
4	-- -- ①	Chain Assembly	1
5	-- -- ①	Bar Assembly	1
6	86113	Nut - Hx 3/8-24 (L.H.) (200-210 in. lb. torque)	1
7	214301	Clutch Assembly	1
8	214300	. Rotor Clutch	1
9	67233	. Kit - Clutch Shoe	1
10	83223	. . Spring - Clutch	2
11	64583	. . Retainer - Clutch Spring	2
12	95166	Kit - Drum & Sprocket (7 T .375P)	1
13	-86344	. Sprocket - 7T .375 Pitch	1
14	86958	. Washer - Sprocket	1
15	110971	Bearing - Needle	1
16	84978-01	Shield - Sawdust	1
17	93037	Screw - Frame Brace (55-60 in. lb. torque)	1
18	103353	Screw - Hx Hd 1/4-20x1.50 (90-100 in. lb. torque)	1
19	100153	Lockwasher - 1/4	1
20	-216639	Clamp - Frame	1
21	104396 ②	Screw - Pn Hd 10-24x3/4 (55-60 in. lb. torque)	2
22	103353 ③	Screw - Hx Hd 10-24x1.50 (55-60 in. lb. torque)	2
23	95679 ③	Clamp - Frame	1
24	-216682	Nut - Hx Lock 10-24 (55-60 in. lb. torque)	2
25	83828-01	Wire Asy - Ground	1
26	92701	Clamp - Bottom	1
27	92700 ④	Clamp - Top	1
	93932	Clamp - Top	1
28	93096 ④	Screw - Shoulder (90-100 in. lb. torque)	1
	-216648	Screw - Hx Hd 1/4-20x2 (90-100 in. lb. torque)	1
29	-216647	Washer - Plain	2
30	92703 ④	Hub - Mount	1
	84661	Grommet	1
31	92704 ④	Mount	1
	85898	Mount	1
32	95636	Washer - 1/4	2
33	95514	Frame & Grip Asy	1
34	214103	Frame & Grip Asy	1

ITEM NO.	PART NUMBER	DESCRIPTION	UNITS PER ASY.
35	216090	Brace - Frame	1
36	93032	Grommet - Frame Brace	1
37	214764	Washer	1
38	89403	Washer - Lower	2
39	-216634 ⑤	Screw - Pn Hd 10-24x.50 (55-60 in. lb. torque)	5
40	-216682 ⑤	Nut - Hx Lock 10-24 (55-60 in. lb. torque)	5
41	216103 ⑤	Shield - Frame Brace	1
42	95418	Cover Asy - Air Cleaner	1
43	110565	. Ring - Retaining	1
44	95420	. Knob - Cover	1
45	-- --	Plate - Name	1
46	95486	Instruction Plate	1
47	215681	Filter - Air	1
48	110741	Screw - Pan Hd 10-24x.50 (40-45 in. lb. torque)	3
49	87871	Screw - Special (35-40 in. lb. torque)	3
50	102762	Screw - Hx Hd 10-24x.50 (40-45 in. lb. torque)	1
51	69890	Lockplate Hsg	1
52	FIG. 3	Fan Hsg/Starter Assemblies	1
53	216053	Cap Asy - Fuel W/Retainer	1
54	69767	. Gasket	1
55	110746	Screw - Hx Hd 10-24x.50 (55-60 in. lb. torque)	2
56	-216644	Screw - Hx Hd 1/4-20x5/8 (110-120 in. lb. torque)	2
57	100153	Lockwasher - 1/4	2
58	-216646	Washer - 1/4	2
59	110807	Screw - Pn Hd 8-32x.312 (15-20 in. lb. torque)	2
60	FIG. 7	Fuel Tank Asy	1
61	87826	Clamp - Hose	2
62	69598	Line - Pulse	1
63	67944	Spring - Hose	1
64	FIG. 6	Powerhead	1
65	93668	Spike	1
66	102388	Screw - Hx Hd 10-24x.625 (55-60 in. lb. torque)	2
67	-216683	Washer - Special 10	2
68	-216682	Nut - Hx Lock 10-24 (55-60 in. lb. torque)	2
69	219058	Label - Safety	1

- ① Refer to Chain, Bar and Accessories Catalog 180119-R1.
- ② Used with Frame and Grip Assembly, P/N 214103.
- ③ Used with Frame and Grip Assembly, P/N 95514.
- ④ Used on models with suffix number 10 only.
- ⑤ Used on 12 level units with suffix numbers 01 and 04.

Figure 2 CHAIN BRAKE® ASSEMBLY

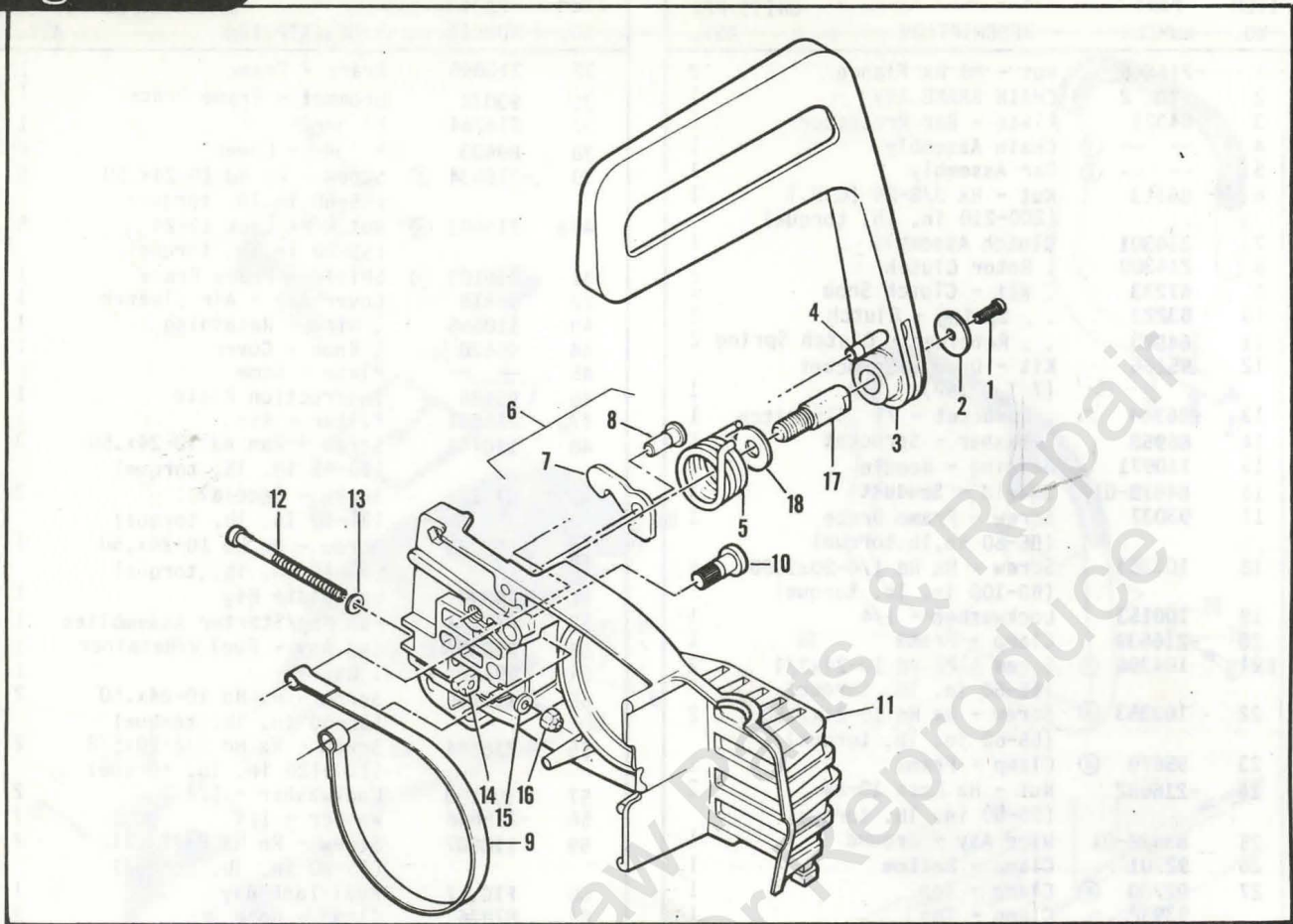

ITEM NO.	PART NUMBER	DESCRIPTION	UNITS PER ASY.
	-217695	BRAKE ASSEMBLY - CHAIN	1
1	-216634	. Screw - Pan Hd 10-24x1/2	1
2	-216633	. Washer - Special	1
3	215911	. Lever Assembly	1
4	214366	. Pin Asy - Roller	1
5	93085	. Spring - Brake	1
6	-222478	ⓐ . Kit - Latch/Pivot	1
7	-- --	ⓑ . Latch	1
8	-- --	ⓒ . Pivot - Latch	1
9	93081	. Band - Brake	1

ITEM NO.	PART NUMBER	DESCRIPTION	UNITS PER ASY.
10	93082	. Pin - Band Anchor	1
11	-215699	. Housing - Brake	1
12	-216636	. Screw - Bar Adjusting	1
13	-216635	. Washer - #10	1
14	61705	. Nut - Hx 10-24	1
15	100002	. Washer - #10	1
16	102067	. Nut - Hx 10-24	1
17	91246	. Pin - Lever Pivot	1
18	91245	. Washer - Thrust	1

ⓐ When replacing either the Latch or Pivot, you must order this Kit, P/N 222478 and replace both the Latch and Pivot simultaneously.

FAN HOUSING & STARTER ASSEMBLY

Figure 3

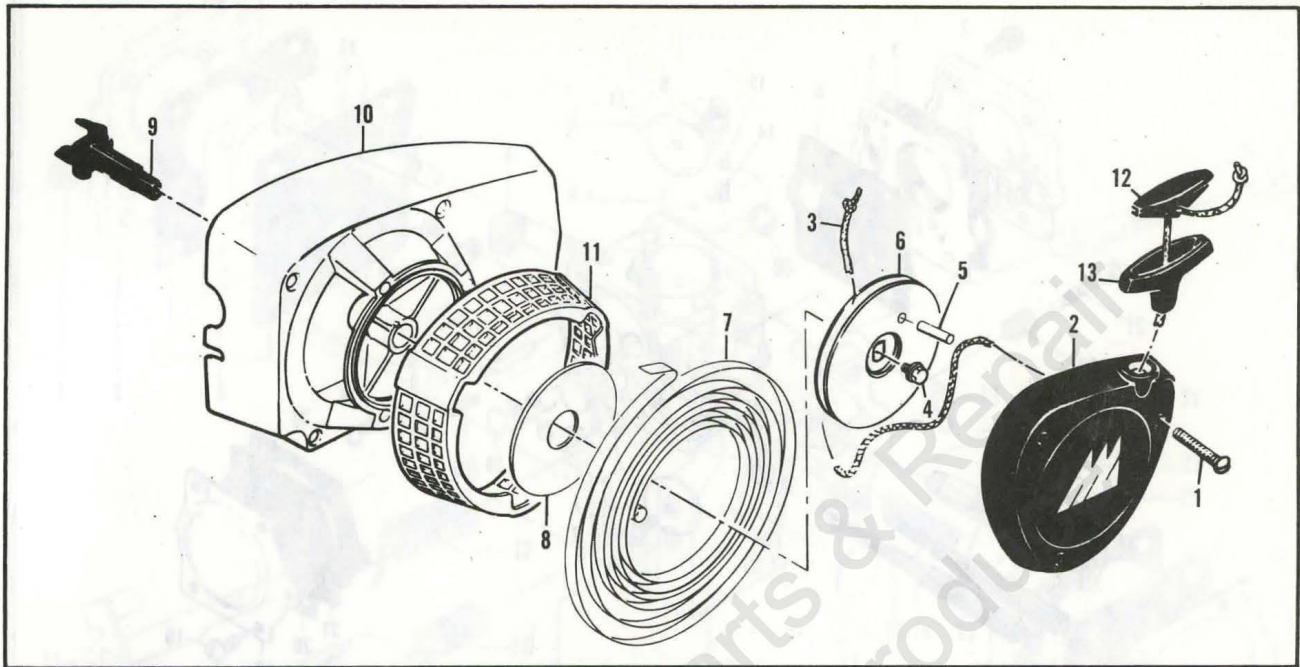

12- LEVEL MODELS

ITEM NO.	PART NUMBER	DESCRIPTION	UNITS PER ASY.
-	215706	Fan Housing/Starter Assembly	1
1	216625	. Screw-Oval HD 10-24x1.25 (35-40 in. lb. torque)	3
2	215707	. Cover-Starter	1
3	87670	. Rope-Starter	1
4	110928	. Screw-Hex HD 10-24x.50 (55-60 in. lb. torque)	1
5	105841	. Pin-Roll	1
6	87689	. Drum-Starter	1

ITEM NO.	PART NUMBER	DESCRIPTION	UNITS PER ASY.
7	87680	. Spring-Rewind	1
8	86053	. Shield-Spring	1
9	95412	. Shaft-Starter	1
10	215777	. Kit-Fan Housing/Guard	1
11	214192	. Guard-Sawdust	1
12	214699	Insert-Starter	1
13	93137	Handle-Starter	1

11- LEVEL MODELS

ITEM NO.	PART NUMBER	DESCRIPTION	UNITS PER ASY.
-	214707	Fan Housing/Starter Assembly	1
1	110646	. Screw-Oval HD 8.32x1.12 (35-40 in. lb. torque)	3
2	91084	. Cover-Starter	1
3	87670	. Rope-Starter	1
4	110928	. Screw-Hex HD 10-24x.50 (55-60 in. lb. torque)	1
5	105841	. Pin-Roll	1
6	87689	. Drum-Starter	1

ITEM NO.	PART NUMBER	DESCRIPTION	UNITS PER ASY.
7	87680	. Spring-Rewind	1
8	86053	. Shield-Spring	1
9	95412	. Shaft-Starter	1
10	214706	. Kit-Fan Housing/Guard	1
11	214192	. Guard-Sawdust	1
12	214699	. Insert-Starter	1
13	93137	. Handle-Starter	1

Figure 4 CARBURETOR ASSEMBLY

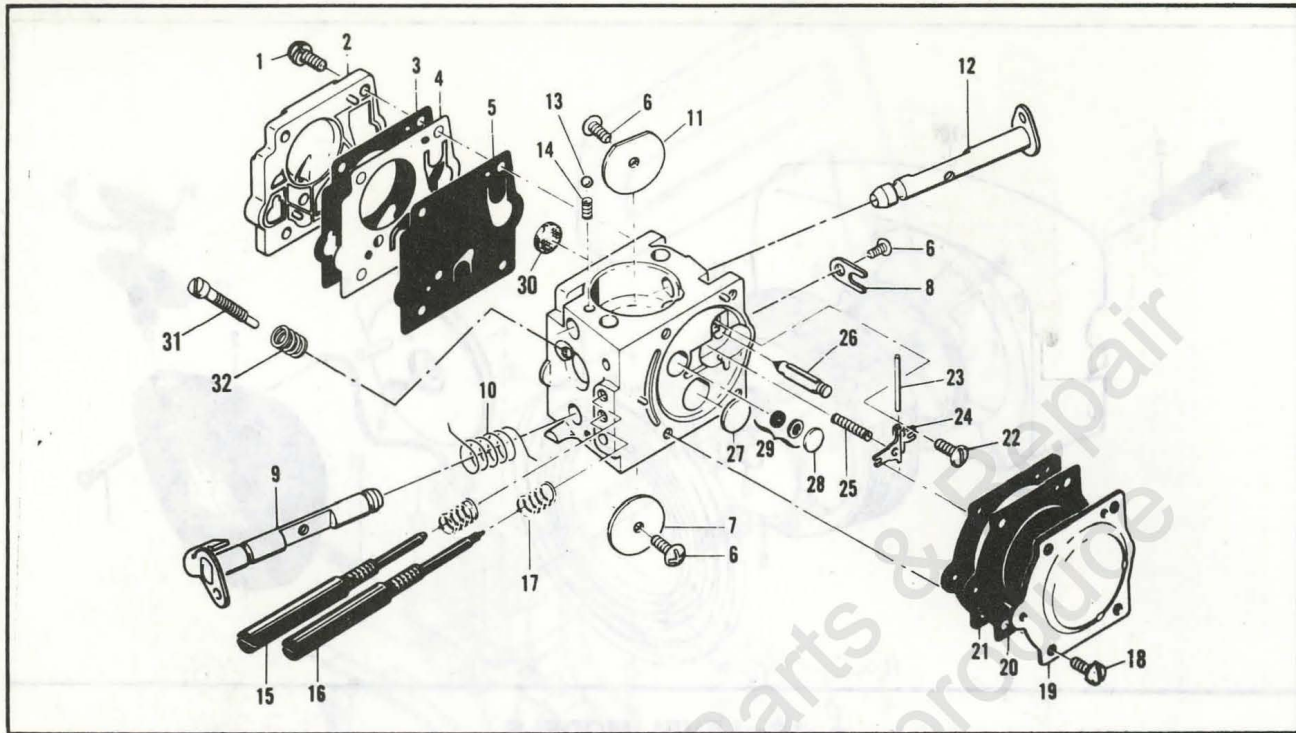

ITEM NO.	PART NUMBER	DESCRIPTION	UNITS PER ASY.
①	-214763-02	Carburetor Asy (SDC 38A)	1
1	67501	. Screw - Pump Cover	4
2	83760	. Cover - Pump	1
3	-- --	②③ . Gasket - Cover	1
4	-- --	② . Diaphragm - Check Valve	1
5	-- --	② . Diaphragm - Fuel Pump	1
6	47690	. Screw - Plate	3
7	83762	. Plate - Throttle	1
8	67489	. Clip - Shaft	1
9	-- --	. Shaft Asy - Throttle	1
10	85981	. Spring - Throttle Return	1
11	-- --	. Plate - Choke	1
12	-- --	. Shaft Asy - Choke	1
13	-- --	. Ball - Choke Friction	1
14	67504	. Spring - Choke Friction	1
15	85979	. Needle - High Speed	1
16	-- --	. Needle - Idle	1

ITEM NO.	PART NUMBER	DESCRIPTION	UNITS PER ASY.
17	-- --	. Spring - Needle	2
18	70798	. Screw - Diaphragm	4
19	-- --	. Cover - Diaphragm	1
20	-- --	② . Diaphragm - Metering	1
21	-- --	②③ . Gasket - Diaphragm	1
22	-- --	② . Screw - Lever Pin	1
23	-- --	② . Pin - Lever	1
24	-- --	② . Lever - Inlet	1
25	-- --	② . Spring - Lever	1
26	-- --	② . Valve - Needle	1
27	-- --	② . Plug - 3/8	1
28	-- --	② . Plug - 5/16	1
29	-- --	② . Kit - Valve & Seal Asy	1
30	-- --	② . Screen - Fuel	1
31	-- --	. Screw - Idle Adj.	1
32	-- --	. Spring - Idle Screw	1

① Used on models with suffix number 10.

② Included in Minor Repair Kit, P/N 217078.

③ Included in Gasket Set, P/N 67482.

CARBURETOR ASSEMBLY

Figure 5

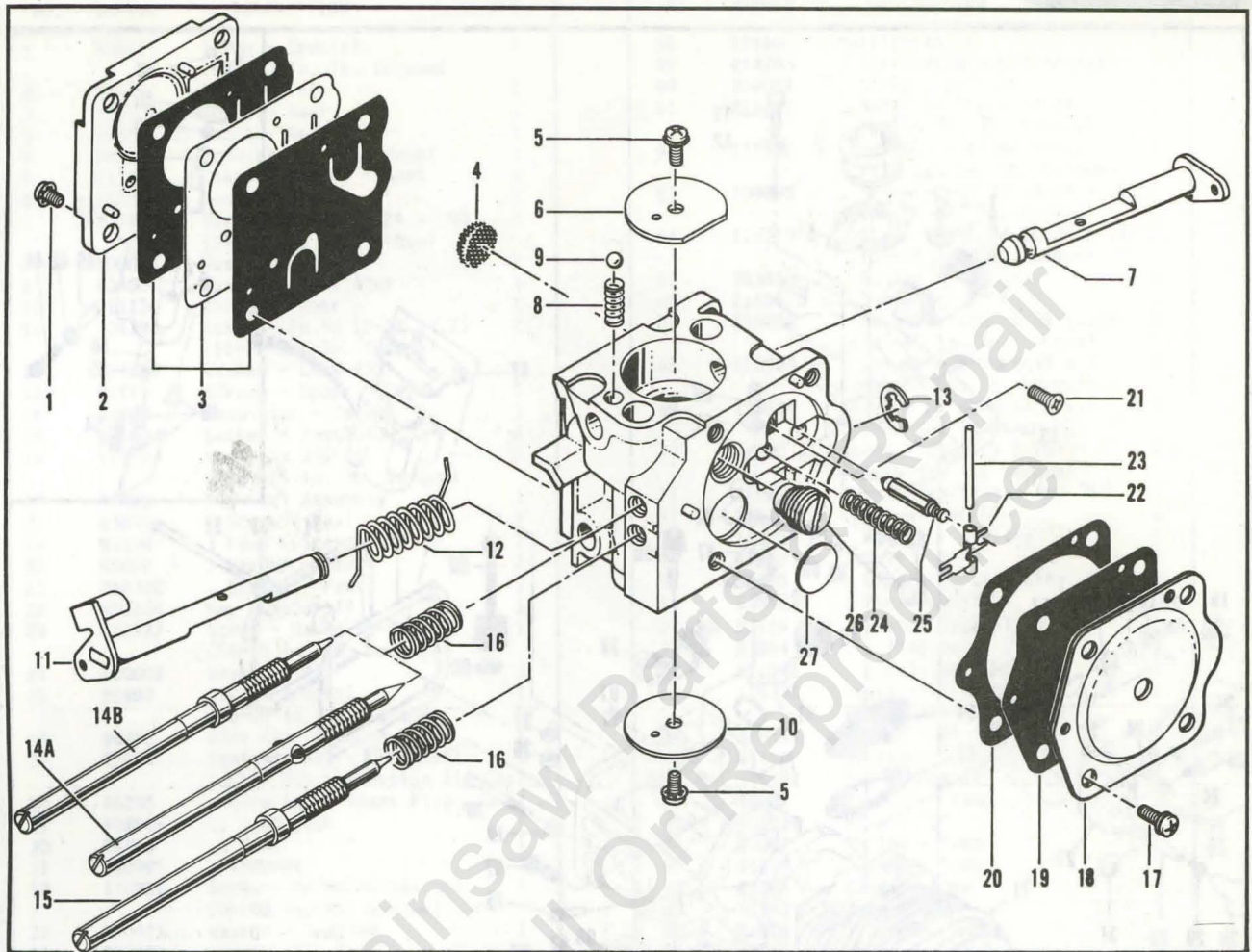

ITEM NO.	PART NUMBER	DESCRIPTION	UNITS PER ASY.
	214763	① Carburetor Asy (Zama C-2)	1
	-- --	① Carburetor Asy (Zama C-3)	1
1	-- --	. Screw - Pump Cover	4
2	-- --	. Cover - Fuel Pump	1
3	-- --	②③ Diaphragm - Fuel Pump	1
4	-- --	② Screen - Filter	1
5	-- --	. Screw - Choke Plate	2
6	-- --	. Plate - Choke	1
7	-- --	. Shaft Asy - Choke	1
8	-- --	. Spring - Choke Shaft	1
9	-- --	. Ball - Friction	1
10	-- --	. Plate - Throttle	1
11	-- --	. Shaft Asy - Throttle	1
12	-- --	. Spring - Throttle Return	1
13	-- --	. Ring - "E"	1
14A	-- --	. Needle - High Speed (For Zama C-3)	1
14B	-- --	④ . Needle - High Speed (For Zama C-2)	1

ITEM NO.	PART NUMBER	DESCRIPTION	UNITS PER ASY.
15	-- --	④ . Needle - Low Speed	1
16	-- --	④ . Spring - Needle	2
17	-- --	. Screw - Diaphragm Cover	4
18	-- --	. Cover - Diaphragm	1
19	-- --	②③ Diaphragm Asy - Metering	1
20	-- --	②③ Gasket - Main	1
21	-- --	② . Screw - Lever	1
22	-- --	② . Lever - Inlet	1
23	-- --	② . Pin - Lever	1
24	-- --	② . Spring - Lever	1
25	-- --	② . Valve - Inlet	1
26	-- --	② . Jet - Main	1
27	-- --	② . Plug - Welch	1

① One of two Carburetors used.

② Contained in Major Repair Kit, P/N 217082.

③ Contained in Gasket Kit, P/N 216724.

④ Contained in Needle Kit, P/N 217088.

Figure 6 POWERHEAD ASSEMBLY

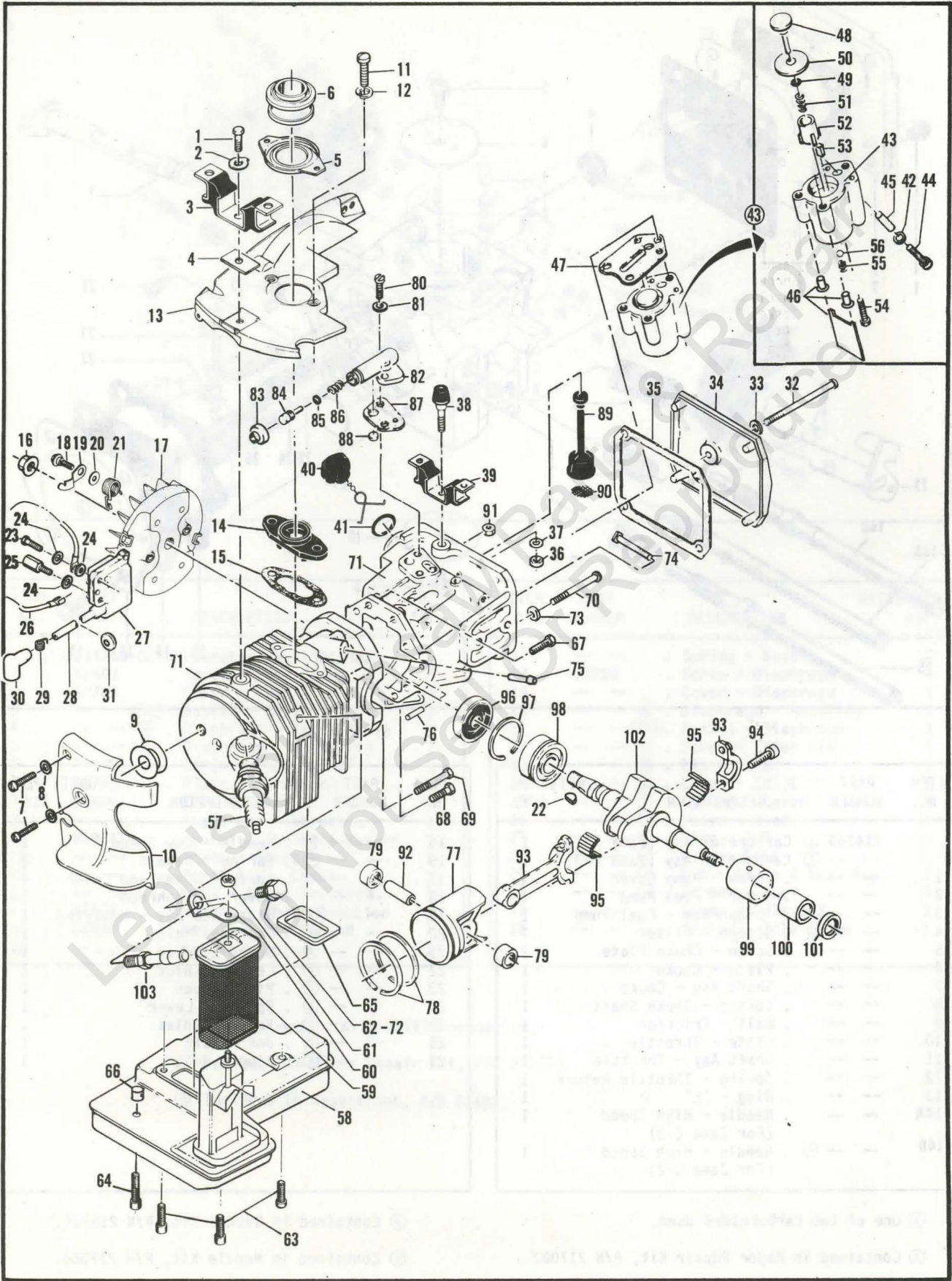

FIGURE 6 POWERHEAD ASSEMBLY

ITEM NO.	PART NUMBER	DESCRIPTION	UNITS PER ASY.
1	83811	Screw - Special (90-100 in. lb. torque)	1
2	69924	Plate - Lock	1
3	216877	Mount - Rear	1
3	93925 ①	Mount - Rear	1
4	84619	Insulator - Rear Mount	1
5	213381	Clamp Assembly - Boot	1
6	215247	Boot - Port	1
7	-216634	Screw - Pn Hd 10-24 x .50 (55-60 in. lb. torque)	2
8	100002	Washer - #10	2
9	93460	Washer - Insulator	1
10	-216136	Shroud - Rear	1
11	104396	Screw - Pn Hd 10-24 x .75 (55-60 in. lb. torque)	2
12	101194	Washer - Lock #10	2
13	95477	Shroud - Upper	1
14	87844	Insulator - Inlet	1
15	88740	Gasket - Insulator	1
16	110703	Nut - Hx 3/8-24 (265-325 in. lb. torque)	1
17	95481	Flywheel Assembly	1
18	93464	. Screw - Pawl	2
19	93198	. Pawl - Starter	2
20	93469	. Washer - Pawl	2
21	214102	. Spring - Pawl	2
22	100106	Key - Woodruff	1
23	110127	Screw - Hx Hd 10-24x.88 (55-60 in. lb. torque)	1
24	100002	Washer - #10	3
25	95603	Stud - Special (55-60 in. lb. torque)	1
26	85798	Wire Asy - Ground	1
27	95553	Ignition Asy - Electronic (.011-.015 Lamination Air Gap)	1
28	95269	. Wire Asy - Spark Plug	1
29	102556	.. Connector	1
30	95266	.. Boot	1
31	110995	. Grommet	1
32	110291	Screw - Pn Hd 10-24x2.62 (35-40 in. lb. torque)	1
33	110921	Washer - Sealing	1
34	-218707	Cover - Oil Tank	1
35	86306	Gasket - Cover	1
36	101143	Nut - Hx 1/4-20 (90-100 in. lb. torque)	1
37	102523	Washer - 1/4	1
38	69832	Bumper - Front	1
39	-216878	Mount - Front	1
39	93926 ①	Mount - Front	1
40	-216052	Cap - Oil Tank	1
41	101148	Ring - "O"	1
42	100003 ②	Washer - #10	1
43	215339	Pump Assembly - Oiler	1
44	110890	. Screw - Fil 10-24 x .88 (25-30 in. lb. torque)	1
45	91774	. Sleeve	1
46	215246	. Kit - Oil Pump Clip	1
47	92818	. Seal - Pulse Pump	1
48	214278	. Piston Assembly - Oiler	1
49	105603	. . Ring - "O"	1
50	86182	. . Ring - Piston	1
51	60259	. Spring - Piston	1
52	62227	. Sleeve - Adjustment	1
53	91259	. Pad - Oil Pump	1
54	110386	. Screw - Hx Hd 8-32 x 1	1
55	-- --	. Spring - Outlet Valve	1
56	-- --	. Ball - Outlet Valve	1
57	- 63432	Plug - Spark CS42T AC (120 in. lb. torque/.025 Gap)	1
	93017	Plug - Spark RDJ6 (120 in. lb. torque/.025 Gap)	1

ITEM NO.	PART NUMBER	DESCRIPTION	UNITS PER ASY.
58	216160	Muffler Asy	1
59	214283	. Screen/Cap Asy-S/Arrestor	1
60	216087	. Strap - Muffler	1
61	-216682	. Nut - Hex Lock 10-24 (40-45 in. lb. torque)	1
62	214100 ③	. Screw - Muffler Strap (110-120 in. lb. torque)	1
63	104895	. Screw - Skt Hd 10-24 x .62 (65-75 in. lb. torque)	3
64	110713	. Screw - Skt Hd 10-24 x .88 (65-75 in. lb. torque)	1
65	95387	. Gasket - Muffler	1
66	216047	. Spacer	1
67	110288	. Screw - Hx Hd 8-32 x 3/4 (35-40 in. lb. torque)	2
68	110963	. Screw - Hx Hd 8-32 x 1 (35-40 in. lb. torque)	1
69	110644	Screw - Hx Hd 8-32 x 1.5 (35-40 in. lb. torque)	1
70	62106	Screw - 12-24 x 1.75 (70-75 in. lb. torque)	4
71	215713 ④	Cyl/C'Case/Piston Asy "B"	1
72	-214100 ③	. Screw-Special	1
73	111025	. Washer - Sealing	4
74	92459	. Bolt - Bar	2
75	69600	. Nipple - Pulse Line	1
76	110851	. Pin - Dowel	1
77	92519 ④	. Piston Assembly "B"	1
78	87854	. . Ring Set - Piston	1
79	111021	. . Bearing - Needle	2
80	110338	Screw - Pn Hd 8-32 x .532 (15-20 in. lb. torque)	2
81	110613	Washer - #8	2
82	84156	Housing - Pump	1
83	215151	Cap - Housing	1
84	92902	Plunger - Pump	1
85	105614	Ring - "O"	1
86	66687	Spring - Pump	1
87	91669	Gasket - Pump	1
88	91668	Valve - Pump	1
89	91672	Hose - Oil	1
90	51506	. Screen - Hose	1
91	100955	Nut - Hex 8-32 (15-20 in. lb. torque)	1
92	69020	Pin - Piston	1
93	215245	Rod Asy - Connecting	1
94	61627-01	. Screw - Special (65-70 in. lb. torque)	2
95	215150	. Roller (set of 22)	1
96	61618	Seal - Oil	1
97	63464	Ring - Snap	1
98	63429-02	Bearing - Ball	1
99	87151	Insert/Bearing Assy	1
100	104357	. Bearing - Needle	1
101	110260	. Seal - Oil	1
102	95386	Crankshaft	1
103	215673	Valve - Compression Release (110-120 in. lbs. torque)	1

① Used on models with suffix number 10.

② Use of washer may or may not be required. Identify components before ordering replacement parts.

③ This screw must be installed on units not equipped with the DSP valve shown as Item 103.

④ Cylinder/Crankcase and Piston Assembly Kits are furnished in matched sets and are identified by a matching letter marking "A", "B", or "C" on both cylinder and piston. Order replacement pistons identified with the letter identification on the cylinder. For piston replacement in an unmarked cylinder, use Piston Assembly, P/N 92519, identified as "B". For Cylinder and piston marked with letter "A" order Piston Assembly, part number 92518. For Cylinder and Piston marked with the letter "C" order part number 92520.

Figure 7 FUEL TANK ASSEMBLY

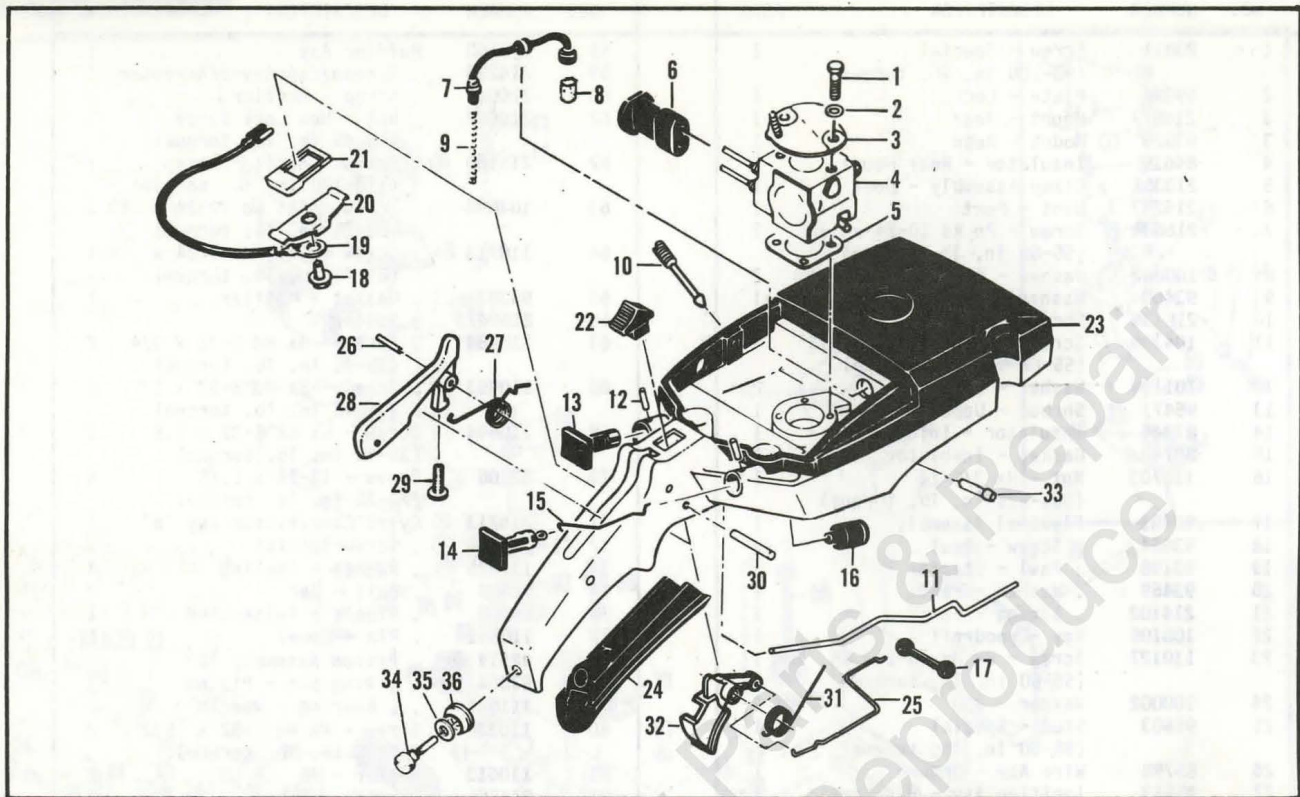

ITEM NO.	PART NUMBER	DESCRIPTION	UNITS PER ASY.
1	103357	Screw - Hx Hd 10-24x2-2.25 (55-60 in. lb. torque)	2
2	110964	Washer	2
3	95414	Bracket - Air Cleaner	1
4	Fig 4,5	Carburetor Asy	1
5	86189	Gasket - Carburetor	1
6	214762	Boot - Carburetor Needles	1
	① 214762-01	Boot - Carburetor Needles	1
7	215708	Hose Assembly - Fuel	1
8	215714	. Pickup Asy - Fuel	1
9	67944	Spring - Fuel Hose	1
10	86273	Screw - Idle Adjustment	1
11	92903	Rod - Oiler	1
12	105673	Pin - Roll 3/32x9/16	2
13	95480	Button - Oiler	1
14	95614	Button- Choke	1
15	69631	Rod - Choke	1
16	69597	Boot - Control Rod	2
17	69043	Snubber - Rod	1

ITEM NO.	PART NUMBER	DESCRIPTION	UNITS PER ASY.
18	110706	Screw - Fil Hd 8-18x.50	1
19	83661	Wire Asy - Stop Switch	1
20	62451	Contact - Switch	1
21	214691	Base - Switch	1
22	68846	Button - Switch	1
23	-215612	Kit - Fuel Tank	1
24	-89400	. Insert - Handle Grip	1
25	92155	. Rod - Throttle	1
26	105654	. Pin - Roll 1/8x7/8	1
27	92154	. Spring - Trigger Release	1
28	94275	. Release Asy - Trigger	1
29	111012	.. Screw - Pan Hd 4-40x.313	1
30	110378	. Pin - Roll 3/16x15/16	1
31	92152	. Spring - Trigger	1
32	214679	. Trigger - Throttle	1
33	69600	② . Nipple-Pulse Line	1
34	93037	② . Screw-Frame Brace	1
35	214764	② . Washer	1
36	93032	② . Grommet-Frame Brace	1

① Used on units with suffix number 10 only.

② Components are included as part of the Kit to back-fit older model units having a tapped hole for an 8/32 screw.

SPECIFICATIONS

Figure 8

Displacement	5.0 Cubic Inches (82cc)	Oil Capacity	9.6 Fluid Ounces
Bore/Stroke	2.062 x 1.500	Oiler Type	Automatic/Manual
Dry Weight	17.2 Pounds (Power Unit Only)	Ignition	Electronic
Bar Lengths	16 inches to 33 inches	Cylinder Type	Hard Chrome
Sprocket	7-Tooth .375 Pitch	Clutch:	
	Floating Rim	Engagement Speed ...	2800 - 3000 RPM
Bearings:		Idle Speed	2200 - 2500 RPM
Main	Ball - Needle	Carburetor	All Position, Two Needle
Conn Rod	Needle		External Adjustment
Fuel Capacity	25.6 Fluid Ounces	Intake System	3rd Port Piston Timed
Fuel/Oil Ratio	32:1 Fuel Mix with McCulloch Custom Lubricant		

TOOLS

Figure 9

86177	Adaptor-Exhaust	214221	Scrench
91226	Tool-Clutch Holding	216147	Key-Socket 1/8"
69191	Kit-Pressure Test	216335	Key-Socket 3/32"
215033	Coupling-Hose	216063	Key-Socket 5/32"
84223	Kit-Piston Tool		

Leon's Chainsaw Parts & Repair
Do Not Sell Or Reproduce

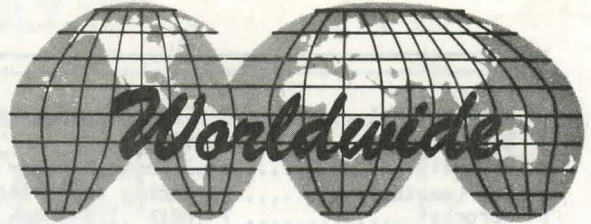

● MANUFACTURING ● SALES ● SERVICE ●

**McCULLOCH
CORPORATION**

900 Lake Havasu Ave.,
Lake Havasu City, AZ 86403-2891

**FOR SERVICE-RELATED PROBLEMS,
REPAIR OR MAINTENANCE
TAKE YOUR UNIT TO THE NEAREST
AUTHORIZED McCULLOCH SERVICING
DEALER LISTED UNDER SAWS IN YOUR
TELEPHONE DIRECTORY YELLOW PAGES.**

If additional assistance is required, call this toll-free hot-line:
(800) 423-6302

Arizona residents call collect (602) 453-3681