

ILLUSTRATED PARTS LIST

MODELS	SERIAL NUMBER PREFIX	MODELS	SERIAL NUMBER PREFIX
600034A	11-,12	600034E	11-,12
600034B	11-,12	600034J	11-,12

PRO MAC 570 Chain Saw

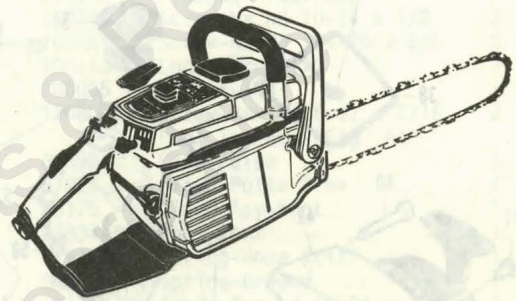

McCulloch Chain Saws are identified by a model number (600034) followed by a suffix letter (A, B, C, etc.) stamped on the identification plate attached to the saw. Suffix letters denote variations in parts or assemblies in the manufacture of the saw.

Part numbers listed in this IPL which have a suffix letter or letters following the description, indicate the part is used only on the model(s) identified by the letter or letters.

Part numbers and descriptions without suffix letter or letters apply to all models of the PRO MAC 570 chain saw.

Part numbers which have one or more dots (.) preceding their description may be ordered individually but they are also included in the kit or assembly whose description begins directly above the dot(s).

Part numbers which have changed since the previous printing of the IPL covering these saws, are indicated by a dash (-) preceding the new part number.

The policy of McCulloch Corporation is one of continual improvement in design, manufacturing and engineering advancement wherever possible to assure still finer two-cycle power tools. Hence, specifications, equipment, colors, design and manufacturer's suggested list prices are subject to change without notice and McCulloch Corporation reserves the right to make such changes without prior notification or obligation to backfit or supply backfit components for units previously shipped from the factory.

July 1978

- CONTENTS -

	<u>Page</u>
Figure 1. General	2
Figure 2. CHAIN BRAKE Assembly	4
Figure 3. Fan Housing & Starter Asy ...	4
Figure 4. Carburetor Assembly	6
Figure 5. Carburetor Assembly	6
Figure 6. Fuel Tank Assembly	8
Figure 7. Flywheel & Ignition System ...	8
Figure 8. Powerhead & Oiler Asys	10
Service Specifications	3
Accessories	5



RO MAC 570

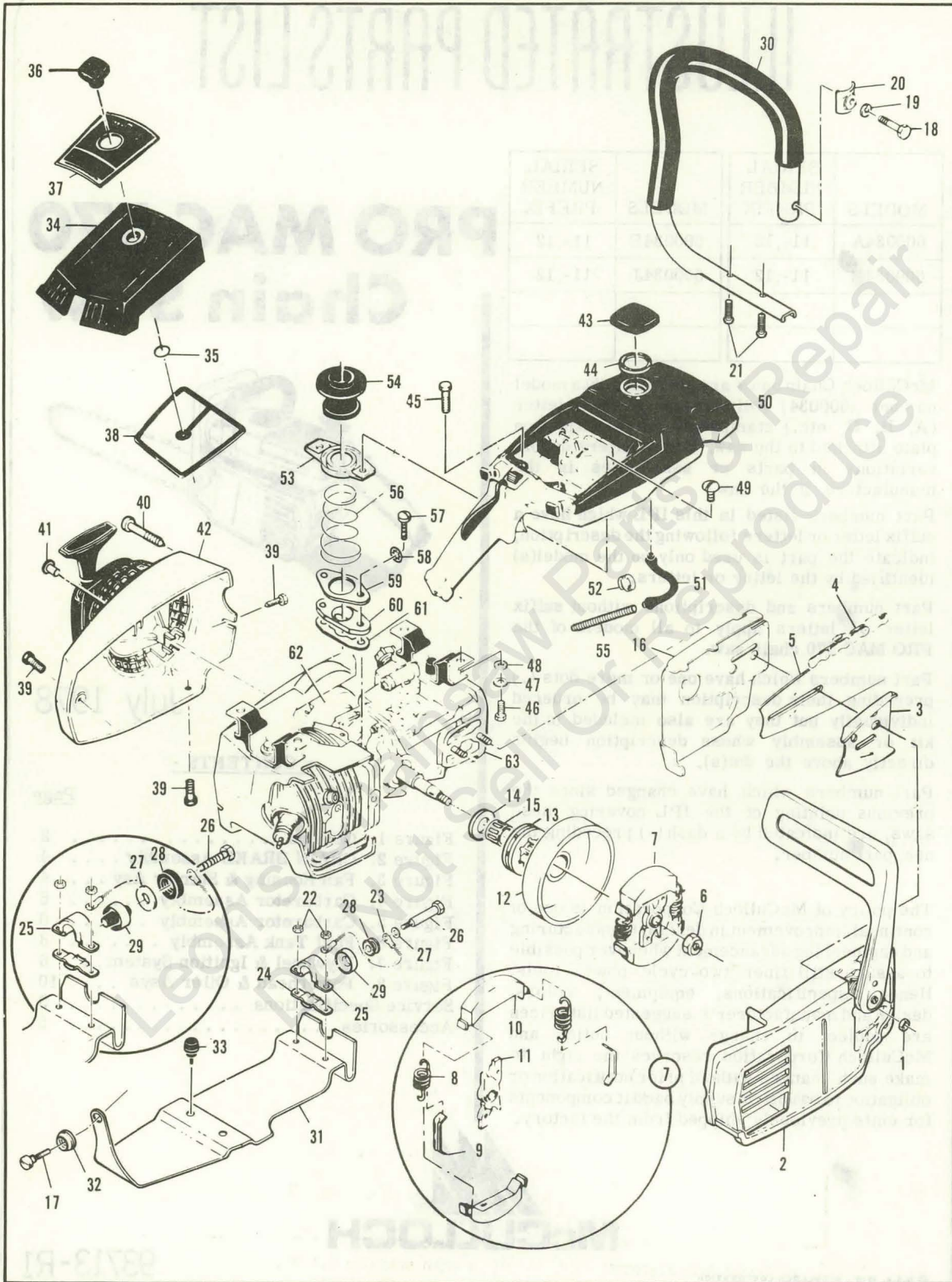

Figure 1. General

Figure 1. General

PRO MAC 570

ITEM NO.	PART NUMBER	DESCRIPTION	UNITS PER ASY.	ITEM NO.	PART NUMBER	DESCRIPTION	UNITS PER ASY.
1	110961	Nut-Hx hd 5/16-24	2	30	92698	Frame & Grip Asy	1
2		CHAIN BRAKE Asy (Fig. 2)		31	92696	Brace-Frame	1
3	64325	Plate-Bar protector	1	32	93032	Grommet-Frame brace	1
4		Chain Asy	1	33	89403	Bumper-Lower	2
5		Bar Asy	1	34	85850A	Cover Asy-Air	1
6	86113	Nut-Hx 3/8-24 L.H.	1	35	110565	. Ring-Retaining	1
7	87675	Clutch Asy	1	36	68529	. Knob-Cover	1
8	83223	. Spring-Clutch	2	37	92705	Nameplate	1
9	64583	. Retainer-Spring	2	38	85387	Filter Asy-Air	1
10	67233	. Shoe-Clutch	2	39	110741	Screw-Pan hd 10-24 x 1/2	3
11	89438	. Rotor-Clutch	1	40	87871	Screw-Special	2
12	86946	Drum-Clutch (B,E,J)	1	41	110667	Rivet	1
12	86942	Drum-Clutch .375P (A)	1	42		Fan Housing & Starter Asy (Fig. 3)	
13	86951	Sprocket-7T .375P (B,E,J)	1	43	89322	Cap-Fuel	1
13	86344	Sprocket-7T .375P (A)	1	44	69767	. Gasket-Fuel cap	1
14	86958	Washer-Shim (B,E,J)	1	45	110746	Screw-Hx hd 10-24 x 1/2	2
14	86958	Washer-Shim (A)	1	46	102861	Screw-Hx hd 1/4-20 x 5/8	2
15	110971	Bearing-Sprocket	1	47	100153	Lockwasher-1/4	2
16	84978A	Guard-Sawdust	1	48	100005	Washer-1/4	2
17	93037	Screw-Frame brace	1	49	110807	Screw-Pan hd 8-32 x 5/16	2
18	102130	Screw-Hx 1/4-20 x 1-1/2	1	50		Fuel Tank Asy (Fig. 6)	
19	100153	Lockwasher-1/4	1	51	69598	Line-Pulse	1
20	63484	Clamp-Frame	1	52	87826	Clamp-Pulse line	1
21	104395	Screw-Pan 10-24 x 5/8	2	53	86175	Clamp Asy-Boot	1
22	101191	Nut-Hx Lock 10-24	2	54	88834A	Boot-Port	1
23	-83828A	① Wire Asy-Ground	1	55	67944	Spring-Hose stiff	1
24	92701	Clamp-Bottom	1	56	86190	④ Spring-Ground	1
25	92700	② Clamp-Top	1	57	-104398	Screw-Pan hd 10-24 x 1	2
26	93096	② Screw-Shoulder	1	58	101194	Lockwasher-#10	2
27	-94114	② Washer-1/4	1	59	69759A	Clamp-Boot	1
28	92703	② Hub-Mount	1	60	87842	Insulator-Inlet	1
29	92704	② Mount	1	61	88740	Gasket-Insulator	1
25	-93932	③ Clamp-Top	1	62		Flywheel & Ignition system (Fig. 7)	
26	-110679	③ Screw-Hx hd 1/4-20 x 2	1	63		Powerhead & Oiler Asy (Fig. 8)	
27	-110845	③ Washer-Plain	1				
28	-84661	③ Grommet	1				
29	-85898	③ Mount	1				

① Used on models with serial number prefix 12-.

② Used on models with serial number prefix 11-; also 12- with suffix letters A, B and J.

③ Used on models with serial number prefix 12- with suffix letter E.

④ Used on models with serial number prefix 11-.

Service Specifications

Spark Plug Gap	.025 inch (.63 mm)
*Lamination Gap	.010 to .012 inch (.25 to .30 mm)
**Lamination Gap	.011 to .015 inch (.30 to .40 mm)
*Breaker Point Gap	.019 to .020 inch (.48 to .51 mm)
Timing	26° BTDC
Clutch Engagement Speed	2800 to 3000 R.P.M.
Torques	Connecting Rod Screws: 65 to 70 pound x inches (8.5 to 9.2 N.m)
	Clutch Nut: 160 to 170 pound x inches (18 to 19 N.m)
	Flywheel Nut: 265 to 325 pound x inches (30 to 37 N.m)

*These specifications for models with serial number prefix 11-.

**These specifications for models with serial number prefix 12-.

PRO MAC 570

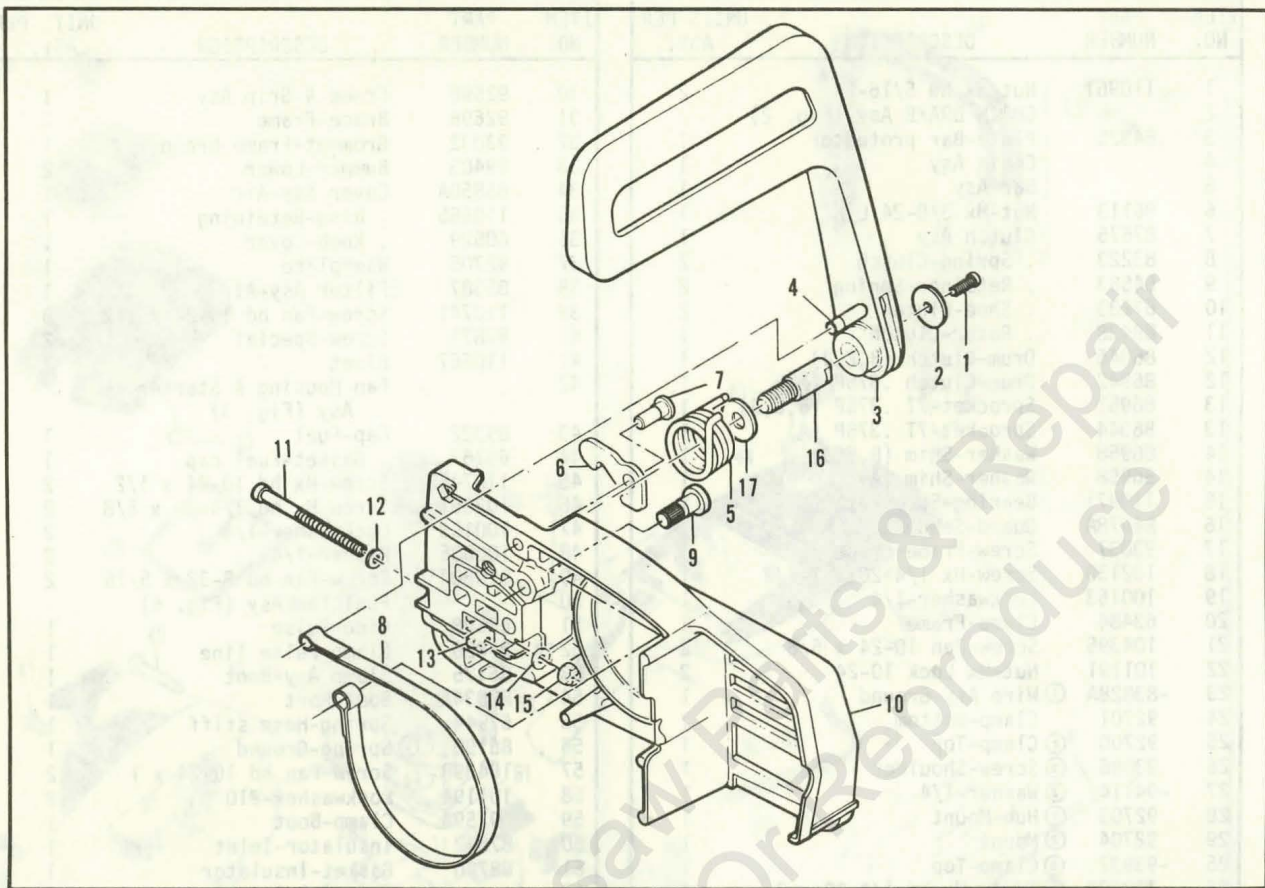

Figure 2. CHAIN BRAKE Assembly

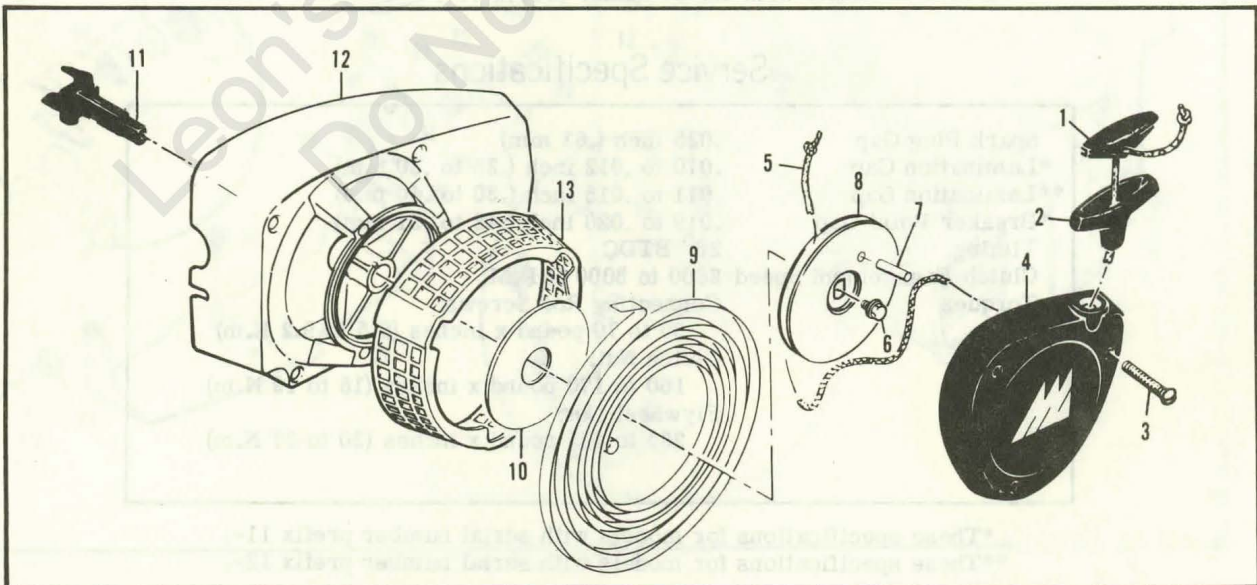

Figure 3. Fan Housing & Starter Assembly

Figure 2. CHAIN BRAKE Assembly

Item No.	Part Number	Description	Units Per Asy.
	93049	CHAIN BRAKE Asy (B,J)	
	92988	CHAIN BRAKE Asy (A,E)	
1	102500	. Screw-Pan hd 10-24 x 1/2	1
2	91273	. Washer-Special	1
3	93076	. Lever Asy	1
4	93077	. . Pin Asy-Roller	1
5	93085	. Spring-Brake	1
6	93083	. Latch	1
7	93669	. Pivot-Latch	1
8	93081	. Band-Brake	1

Item No.	Part Number	Description	Units Per Asy.
9	93082	. Pin-Band Anchor	1
10	93050	. Housing Asy-Brake (B,J)	1
(10)	92987	. Housing Asy-Brake (A,E)	1
11	110527	. . Screw-Fil hd 10-24 x 2-3/4	1
12	110264	. . Washer-#10	1
13	61705	. . Nut-Bar adjusting	1
14	100002	. . Washer-#10	1
15	102067	. . Nut-Hx 10-24	1
16	91246	. . Pin-Lever pivot	1
17	91245	. . Washer-Thrust	1

Accessories

Item No.	Part Number	Description	Units Per Asy.
	84453	Kit-Piston tool	
	69191	Kit-Pressure test adaptor	
	63097	Spark Plug (standard)	
	63432	Spark Plug (cooler)	
	62827	Wrench/Screwdriver	
	63746	Scrench	

Item No.	Part Number	Description	Units Per Asy.
	*86419	Guide-Timing	
	91967	Kit-Spike	
	102388	. Screw-Hx hd 10-24 x 5/8	
	24236	. Washer-Special	
	101191	. Nut-Hx 10-24	

*Used on models with serial number prefix 11-.

Figure 3. Fan Housing & Starter Assembly

Item No.	Part Number	Description	Units Per Asy.
	90921A	Fan Housing & Starter Asy	1
1	62191A	. Insert-Starter	1
2	93137	. Handle-Starter	1
3	110646	. Screw-Oval hd 8-32 x 1-1/8	3
4	87672	. Cover Asy-Starter	1
5	87670	. Rope-Starter	1

Item No.	Part Number	Description	Units Per Asy.
6	110341	. Screw-Hex hd 10-24 x 1/2	1
7	105841	. Pin-Roll	1
8	87689	. Drum-Starter	1
9	87680	. Spring-Rewind	1
10	86053	. Shield-Spring	1
11	83748	. Shaft-Starter	1
12	87693	. Kit-Fan housing	1
13	87674	. . Guard-Sawdust	1

PRO MAC 570

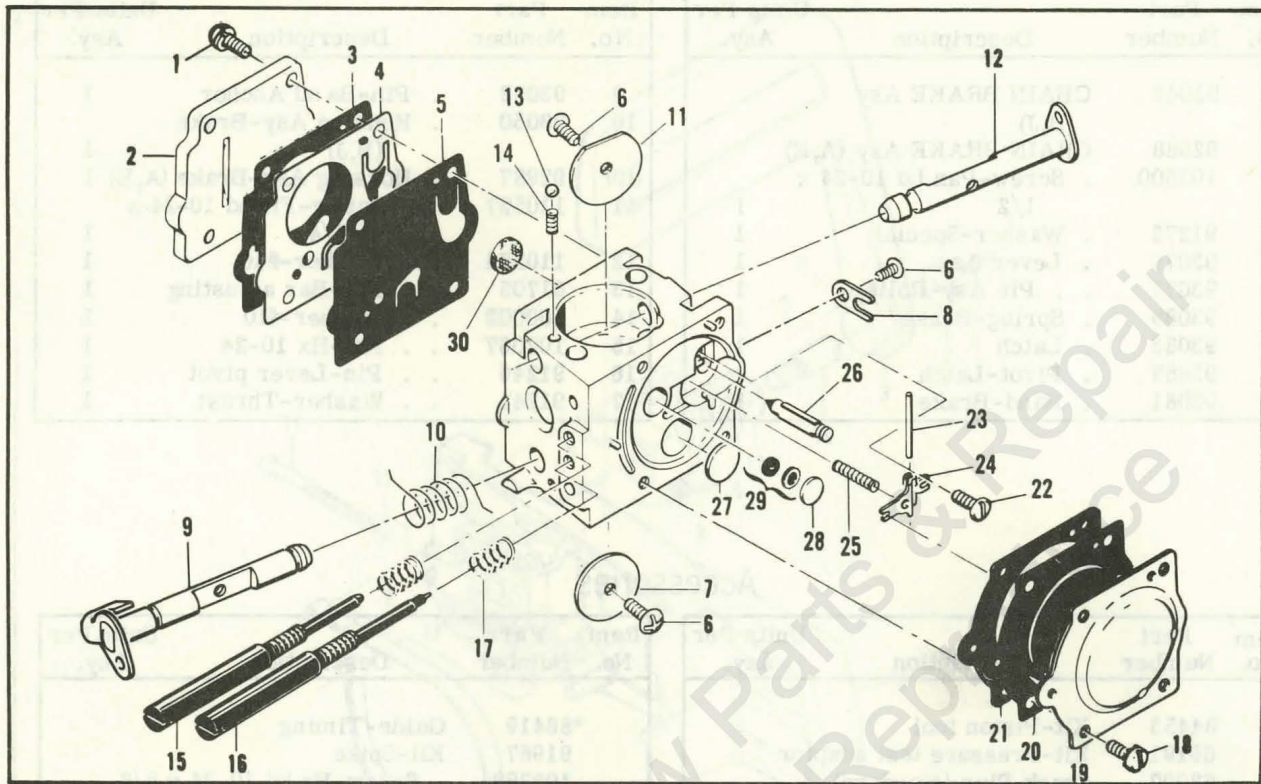

Figure 4. Carburetor Assembly

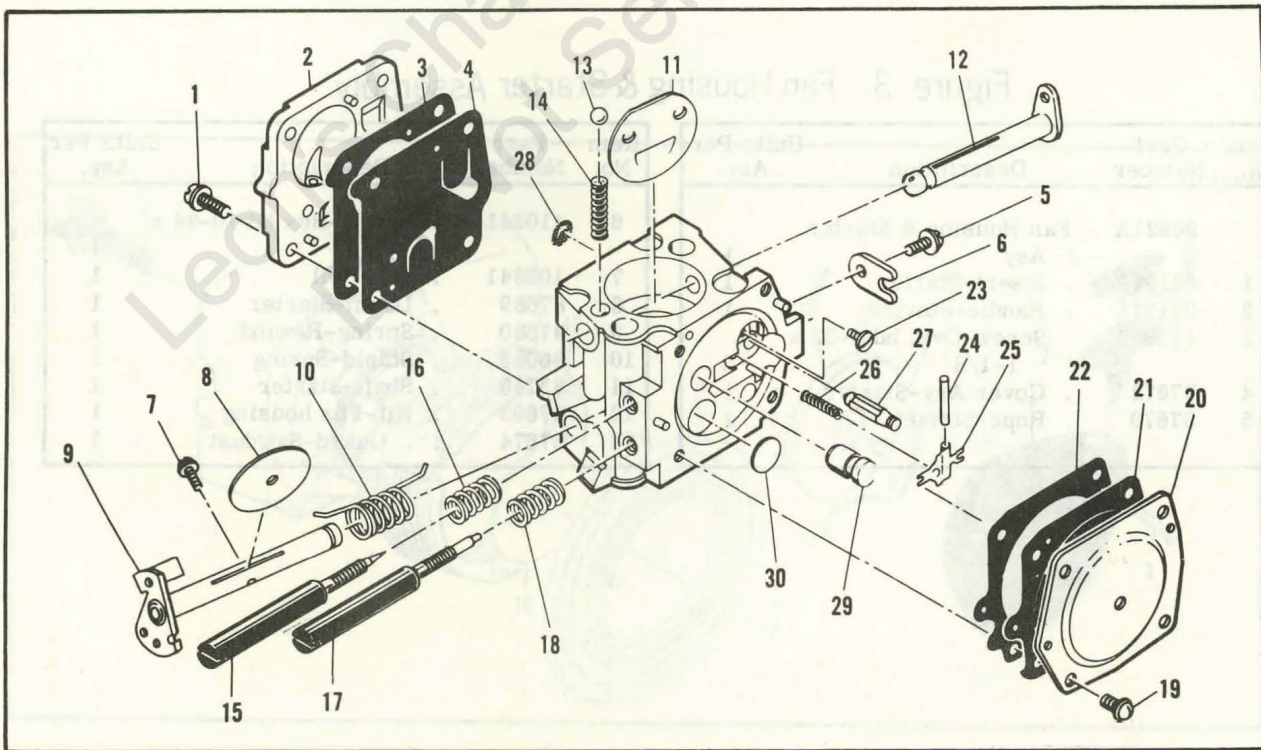

Figure 5. Carburetor Assembly

Figure 4. Carburetor Assembly

Item No.	Part Number	Description	Units Per Asy	Item No.	Part Number	Description	Units Per Asy
**87821		Carburetor Asy - SDC 38A	1	17	*67502	. Spring - Needle	2
1	67501	. Screw - Pump cover	4	18	70798	. Screw - Diaphragm	4
2	88731	. Kit - Pump cover	1	19	83761	. Cover - Diaphragm	1
3	*88617	. . Gasket - Cover	1	20	*67499	. Diaphragm - Metering	1
4	*67498	. Diaphragm - Check valve	1	21	*67496	. Gasket - Diaphragm	1
5	*83114	. Diaphragm - Fuel pump	1	22	*67500	. Screw - Lever pin	1
6	*47690	. Screw - Plate	3	23	*67508	. Pin - Lever	1
7	83762	. Plate - Throttle	1	24	*67509	. Lever - Inlet	1
8	67489	. Clip - Shaft	1	25	*67503	. Spring - Lever	1
9	85980	. Shaft Asy - Throttle	1	26	*67491	. Valve - Needle	1
10	85981	. Spring - Throttle return	1	27	*71690	. Plug - 3/8	1
11	67490	. Plate - Choke	1	28	*69506	. Plug - 5/16	1
12	67488	. Shaft Asy - Choke	1	29	83758	. Kit - Valve & Seat Asy	1
13	*100302	. Ball - Choke friction	1	30	*67507	. Screen - Fuel	1
14	*67504	. Spring - Choke friction	1		*67482	Gasket Kit	
15	*85979	. Needle - High Speed	1		85987	Repair Kit	
16	*85982	. Needle - Idle	1				

NOTE: Before ordering parts, identify carburetor on saw.

** This is one of two carburetors used alternately on models with serial number prefix 11-, and 12-.

* Indicates parts included in Repair Kit, P/N 85987.

Figure 5. Carburetor Assembly

Item No.	Part Number	Description	Units Per Asy	Item No.	Part Number	Description	Units Per Asy
*85916		Carburetor Asy - HS 111A	1	16	52936	. Spring - High Speed needle	1
1	52933	. Screw - Pump cover	4	17	86170	. Needle - Idle	1
2	66628	. Cover - Pump	1	18	67133	. Spring - Idle needle	1
3	66629	. Gasket - Cover	1	19	51721	. Screw - Diaphragm cover	4
4	66630	. Diaphragm - Fuel pump	1	20	83724	. Cover - Diaphragm	1
5	48780	. Screw - Clip retainer	1	21	66632	. Diaphragm - Metering	1
6	66646	. Clip - Throttle shaft	1	22	66633	. Gasket - Diaphragm	1
7	48780	. Screw - Plate	1	23	83479	. Screw - Lever pin	1
8	51720	. Plate - Throttle	1	24	66636	. Pin - Lever	1
9	83546	. Shaft Asy - Throttle	1	25	66638	. Lever - Metering	1
10	67136	. Spring - Throttle return	1	26	66404	. Spring - Lever	1
11	65856	. Plate - Choke	1	27	66637	. Valve - Needle	1
12	83725	. Shaft Asy - Choke	1	28	66623	. Screen - Fuel inlet	1
13	100071	. Ball - Choke friction	1	29	83729	. Check Valve - Nozzle	1
14	52930	. Spring - Choke friction	1	30	66622	. Plug - Welch	1
15	86169	. Needle - High speed	1				

NOTE: Before ordering parts, identify carburetor on saw.

* This is one of two carburetors used alternately on models with serial number prefix 11-, and 12-.

PRO MAC 570

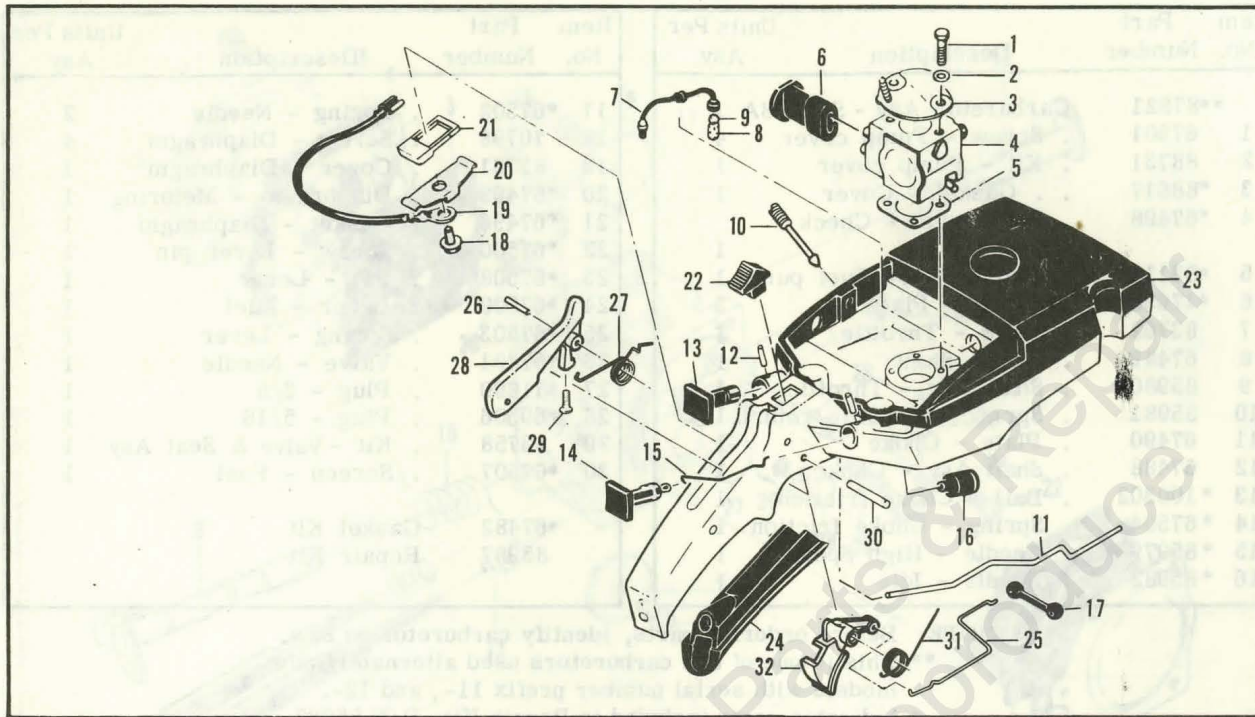

Figure 6. Fuel Tank Assembly

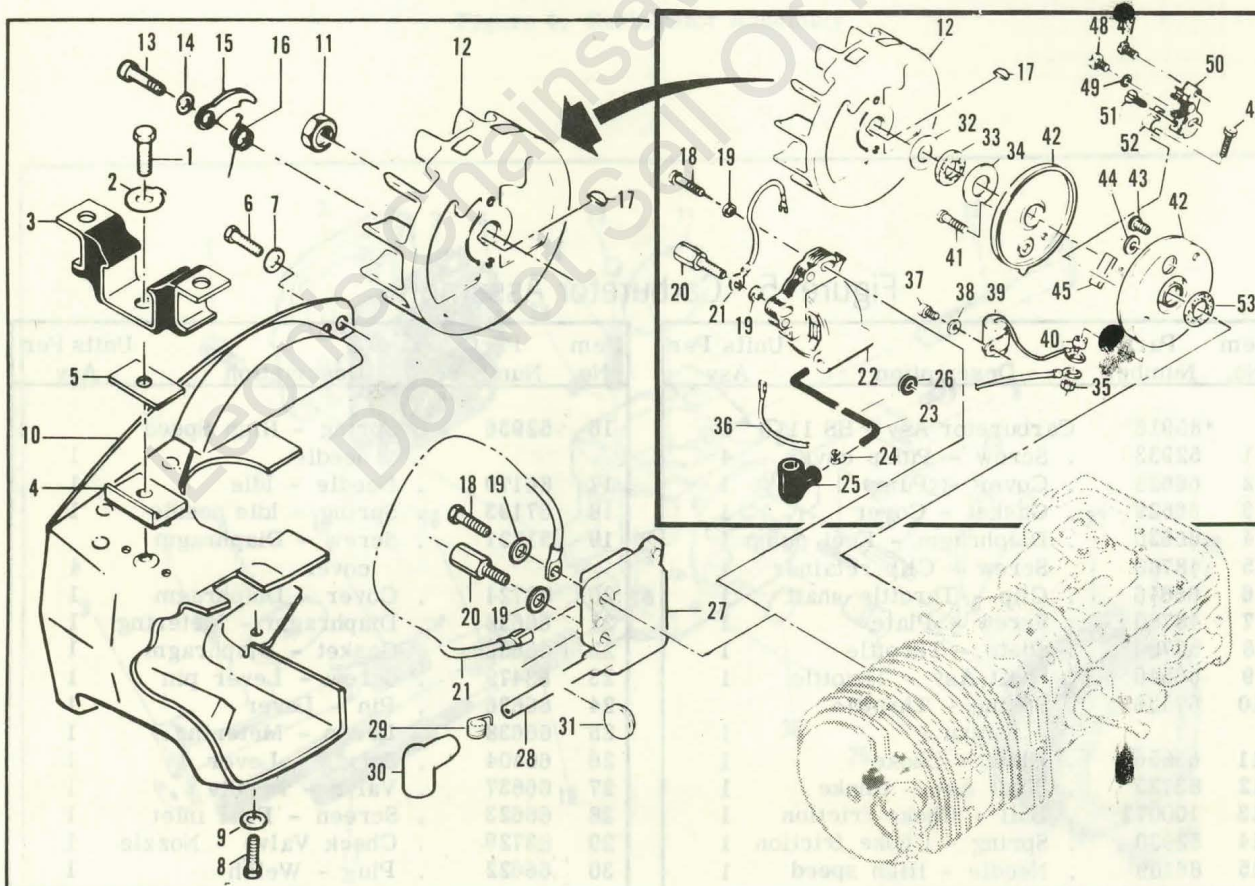

Figure 7. Flywheel & Ignition System

Figure 6. Fuel Tank Assembly

ITEM NO.	PART NUMBER	DESCRIPTION	UNITS PER ASY.
1	110894	Screw-Hx hd 10-24 x 2-1/8	2
2	110964	Washer	2
3	69952	Bracket-Air cleaner	1
4		Carburetor Asy (Fig. 4,5)	
5	86189	Gasket-Carburetor	1
6	69629	① Boot-Carburetor controls	1
6	85901	② Boot-Carburetor controls	1
7	64848	Hose Assembly-Fuel	1
8	63932	. Filter - Fuel	1
9	100440	. Washer	1
10	86273	Screw-Idle speed	1
11	92903	Rod-Oiler	1
12	105673	Pin-Roll 3/32 x 9/16	2
13	63044	Button-Oiler	1
14	69630	Button-Choke	1
15	69631	Rod-Choke	1
16	69597	Boot-Control rod	2

ITEM NO.	PART NUMBER	DESCRIPTION	UNITS PER ASY.
17	69043	Snubber-Rod	1
18	110706	Screw-Fil hd 8-18 x 1/2 (SEMS)	1
19	83661	Wire Asy-Stop switch	1
20	62451	Contact-Switch	1
21	62950A	Base-Switch	1
22	68846	Button-Switch	1
23	-94025	Tank/Control Asy	1
24	89320	. Insert-Handle grip	1
25	92155	. Rod-Throttle	1
26	105654	. Pin-Roll 1/8 x 7/8	1
27	92154	. Spring-Trigger release	1
28	-94275	. Release Asy-Trigger	1
29	-111012	. . Screw-Pan hd 4-40x5/16	1
30	110378	. Pin-Roll 3/16 x 15/16	1
31	92152	. Spring-Trigger	1
32	-92151A	. Trigger-Throttle	1

- ① Used on models with Carburetor Asy, P/N 87821 (Figure 4).
- ② Used on models with Carburetor Asy, P/N 85916 (Figure 5).

Figure 7. Flywheel & Ignition System

ITEM NO.	PART NUMBER	DESCRIPTION	UNITS PER ASY.
1	83811	Screw-Special	1
2	69924	Plate-Lock	1
3	91578A	① Mount-Rear	1
3	-93925	② Mount-Rear	1
4	83693	Kit-Rear mount adaptor	1
5	84619	. Insulator-Rear mount	1
6	110776	Screw-Fil hd 8-32 x 3/8	1
7	100057	Washer-Lock #8	1
8	110566	Screw-Hx hd 12-24 x 5/8	1
9	110106	Washer-#12	1
10	85747A	Shroud Asy	1
11	110703	Nut-Hx 3/8-24	1
12	86068	Flywheel Asy	1
13	88804	. Screw-Pawl pivot	2
14	83241	. Washer-Special	2
15	67546	. Pawl-Starter	2
16	67545	. Spring-Pawl	2
17	100106	Key-Woodruff	1
18	110127	Screw-Hx hd 10-24 x 7/8 (SEMS)	1
19	100002	Washer-#10	2
20	83512	Stud-Special	1
21	85798	Wire Asy-Ground	1
22*	87246A	Coil & Lamination Asy	1
23*	50120	. Wire Asy-Spark plug	1
24*	55061	. . Connector	1
25*	85758	. . Boot	1
26*	100268	. Grommet	1

ITEM NO.	PART NUMBER	DESCRIPTION	UNITS PER ASY.
27	-92785	③ Electronic Ignition Asy	1
28	-92796	③ . Wire Asy-Spark plug	1
29	-102556	③ . . Connector	1
30	-85758	③ . . Boot	1
31	-110995	③ . Grommet	1
32*	67057	Washer-Thrust	1
33*	67056	Seal-Breaker box cover	1
34*	67054	Washer-Thrust	1
35*	100298	Nut-Hx 6-32	1
36*	85796	Wire Asy-Primary	1
37*	110338	Screw-Fil hd 8-32 x 9/16	1
38*	100080	Washer-#8	1
39*	85358	Condenser	1
40*	62365	Spacer-Breaker box	1
41*	110584	Screw-Pan hd 8-32 x 3/4	1
42*	91852	Kit-Breaker box & cover	1
43*	110489	. Screw-Pan hd 6-32 x 7/16	1
44*	91838	. Washer	1
45*	54184	Wiper-Cam	1
46*	110346	Screw-Hx hd 6-32 x 3/4	1
47*	110811	Screw-Pan hd 8-32 x 3/8	1
48*	110969	Screw-Hx hd 8-32 x 1/2	1
49*	105976	Washer-#8	1
50*	88808	Breaker Asy	1
51*	110706	Screw-Pan hd 6-32 x 7/16 s/t	1
52*	83126	Strap-Conduction	1
53*	67051	Seal-Breaker box	1

- *Used on models with serial number prefix 11-.
- ① Used on models with serial number prefix 11-; also 12- with suffix letters A, B and J.
- ② Used on models with serial number prefix 12- with suffix letter E.
- ③ Used on models with serial number prefix 12-.

PRO MAC 570

Figure 6 Fuel Tank Assembly

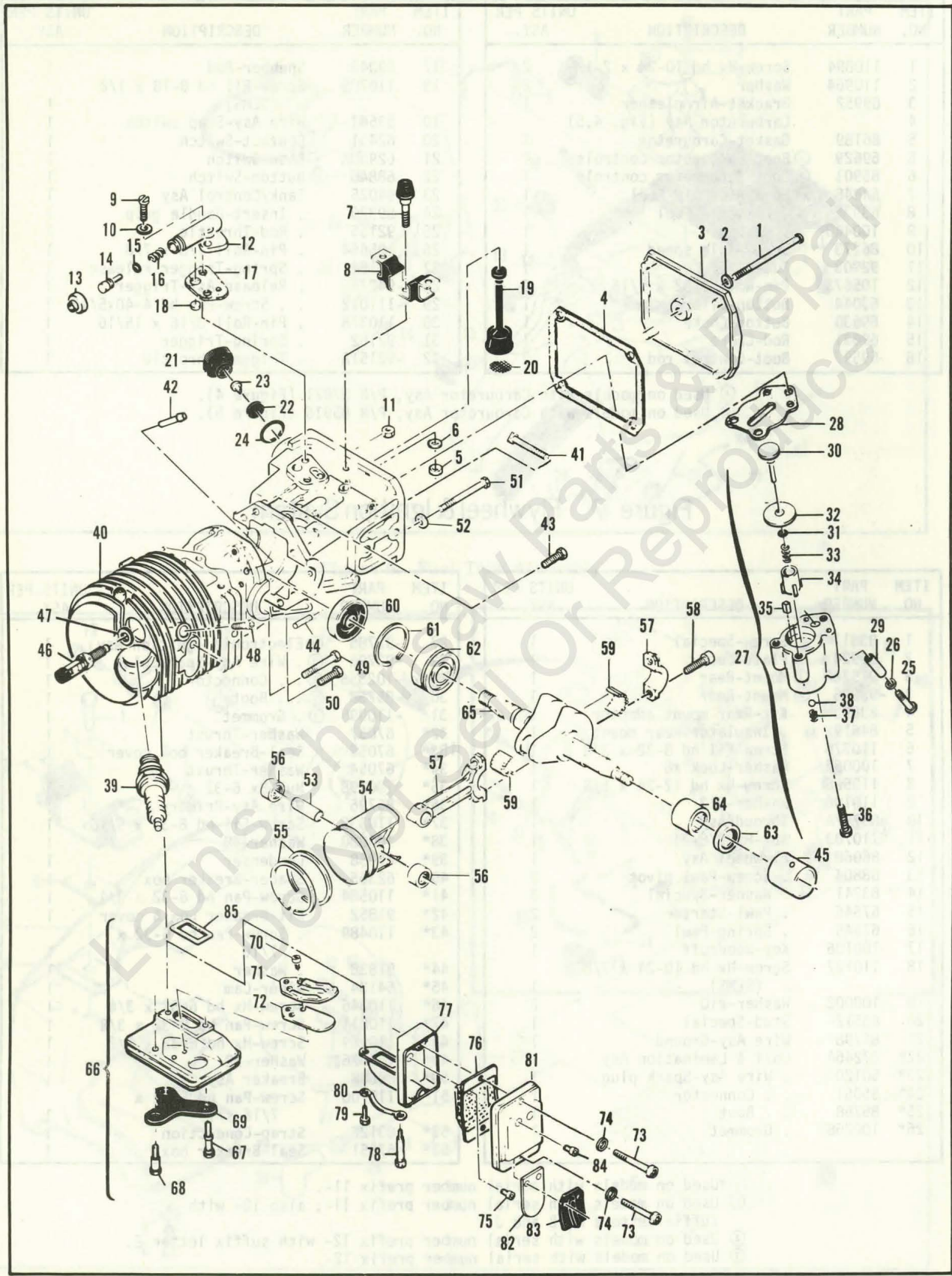

Figure 8. Powerhead & Oiler Assemblies

Figure 8. Powerhead & Oiler Assemblies

ITEM NO.	PART NUMBER	DESCRIPTION	UNITS PER ASY.	ITEM NO.	PART NUMBER	DESCRIPTION	UNITS PER ASY.
1	110291	Screw-Pan hd 10-24 x 2-5/8	1	43	110288	. Screw-Hx hd 8-32 x 3/4	2
2	110921	Washer-Sealing	1	44	110581	Pin-Dowel	1
3	86304	Cover-Oil tank	1	45*	87152	Insert-Bearing	1
4	86306	Gasket-Cover	1	46	-94272	Valve-DSP	1
5	101143	Nut-Hx 1/4-20	1	47	85505	Washer	1
6	102523	Washer-1/4	1	48	110681	Screw-Skt hd 10-24 x 1/4	1
7	69832	Bumper-Front	1	49	110618	Screw-Hx hd 8-32 x 1-3/8	1
8	-91582A	① Mount-Front	1	50	110288	Screw-Hx hd 8-32 x 3/4	1
8	-93926	② Mount-Front	1	51	62105	Screw Asy-Sealing	4
9	110338	Screw-Fil hd 8-32 x 9/16	2	52	62842	. Washer-Sealing	4
10	110613	Washer-#8	2	53	87710	Pin-Piston	1
11	100955	Nut-Hx 8-32	1	54	89783A	Piston Assembly	1
12	84156	Housing-Pump	1	55	-92517	. Ring Set-Piston	1
13	62262	Cap-Housing	1	56	110590	. Bearing	2
14	92902	Plunger-Pump	1	57	85352	Connecting Rod Asy	1
15	105614	"0" Ring	1	58	61627A	. Screw-Special	2
16	66687	Spring-Pump	1	59	63225	. Roller (Set of 20)	1
17	91669	Gasket-Pump	1	60	61618	Seal-Oil	1
18	91668	Valve-Pump	1	61	63464	Ring-Snap	1
19	91672	Hose Asy-Oil	1	62	63429B	Bearing-Ball	1
20	51506	. Screen-Hose	1	63*	110260	Seal-Oil	1
21	87270	Cap Asy-Oil	1	64*	104357	Bearing-Needle	1
22	87269	. Retainer	1	65	87699	Crankshaft	1
23	86402	. Valve-Check	1	66**	68863	Kit-Muffler	1
24	101148	"0" Ring	1	67**	67838	. Screw-Muffler long	2
25	110865	Screw-Hx hd 10-24 x 7/8	1	68**	67837	. Screw-Muffler short	1
26	100003	Washer-Special	1	69**	83993	. Lockplate	1
27	89115B	Pump Asy-Pulse	1	70**	110563	. Screw-Skt hd 8-32 x 1/4	2
28	92818	. Seal-Pulse Pump	1	71**	84780	. Stop-Reed	1
29	91774	. Sleeve-Oil Pump	1	72**	84779	. Reed	1
30	60260A	. Piston Pump	1		93992	Kit-Muffler (E)	1
31	105603	. "0" Ring	1	73	-101563	. Screw-Skt hd 10-24x1-1/4 (A,E)	2
32	86182	. Ring-Piston	1	74	110264	. Washer (A,E)	2
33	60259	. Spring-Piston	1	75	110928	. Screw-Hx hd 10-24 x 1/2 (A,E)	1
34	62227	. Sleeve-Adjustment	1	76	85152	. Baffle (A,E)	1
35	91259	. Pad-Oil pump	1	77	83105	. Body-Muffler (A,E)	1
36	110386	. Screw-Hx hd 8-32 x 1	1	78	68187	. . Screw-Special (A,E)	1
37	92844	. Spring-Outlet valve	1	79	110529	. Screw-Hx hd 10-24x1/2(A,E)	1
38	102809	. Ball-Valve	1	80	67922	. Lockplate (A,E)	1
39	63432	Spark plug (A,J)	1	81	83966	. Cover Asy-Muffler (E)	1
39	93017	Spark plug (B)	1	81	87683	Cover/Valve Asy-Spark Arrester (A)	1
39	-93018	Spark plug (E)	1	82	87682	. Valve-Reed (A)	1
40	92693A	Kit-Cyl/C'case/Bolt Asy	1	83	87286	. Stop-Reed (A)	1
41	62065	. Bolt-Bar mounting	2	84	110472	. Screw Skt hd 8-32x5/16(A)	2
42	69600	. Nipple-Pulse line	1				

*These three items are contained in Needle Insert/Bearing Asy, P/N 87151.

**Used on models with model number suffix letter B and J.

① Used on models with serial number prefix 11-; also 12- with suffix letters A, B and J.

② Used on models with serial number prefix 12-with suffix letter E.

ITEM NO.	DESCRIPTION	UNITS PER ASY.	ITEM NO.	DESCRIPTION	UNITS PER ASY.
1	1
2	2
3	3
4	4
5	5
6	6
7	7
8	8
9	9
10	10
11	11
12	12
13	13
14	14
15	15
16	16
17	17
18	18
19	19
20	20
21	21
22	22
23	23
24	24
25	25
26	26
27	27
28	28
29	29
30	30
31	31
32	32
33	33
34	34
35	35
36	36
37	37
38	38
39	39
40	40
41	41
42	42
43	43
44	44
45	45
46	46
47	47
48	48
49	49
50	50

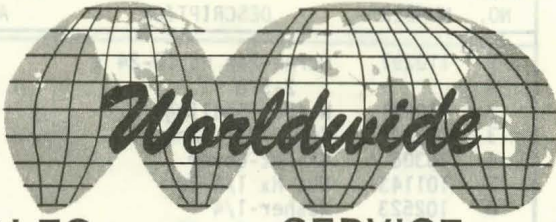
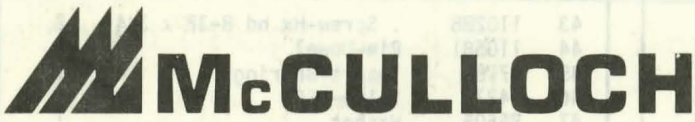

● MANUFACTURING ● SALES ● SERVICE ●

McCULLOCH CORPORATION

P.O. BOX 92180, LOS ANGELES, CALIFORNIA 90009

INTERNATIONAL DIVISIONS:

LOS ANGELES, CALIFORNIA, P.O. BOX 92181

SINGAPORE, GOLDHILL PLAZA, SINGAPORE II

Do Not Sell Or Reproduce Parts or Repair

*These three items are contained in handle insert (V102181)
 **Used on models with model suffix letter E
 †Used on models with serial number prefix 17; also on models with serial number prefix 12 with suffix letter E.
 A, B and J.