

MASTER ILLUSTRATED PARTS LIST

MAC 5-10A Chain Saw

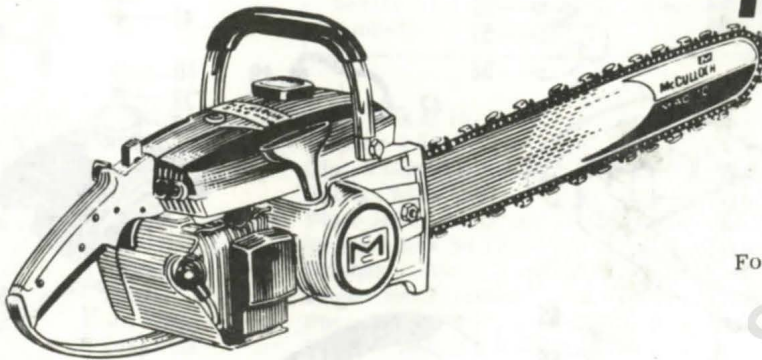

For cancelled and superseded parts lists,
see page 5

April 1971

CONTENTS

The policy of McCulloch Corporation is one of continual improvement in design, manufacturing and engineering advancement wherever possible to assure still finer two-cycle power tools. Hence, specifications, equipment, colors, design and manufacturer's suggested list prices are subject to change without notice and McCulloch Corporation reserves the right to make such changes without prior notification or obligation to backfit or supply backfit components for units previously shipped from the factory.

	Page
Figure 1. General	2
Figure 2. Clutch Guard Assembly	6
Figure 3. Fuel Tank Assembly	6
Figure 4. Carburetor Assembly	8
Figure 5. Carburetor Assembly	10
Figure 6. Powerhead Assembly	12

This Master Illustrated Parts List gives the name, number and interchangeability between engines, of service and replacement parts which were used on or are presently for all MAC 5-10A chain saws manufactured to date.

Information about the List and how to use it will be found on the back cover.
Read the information before you start to use the List.

 **McCULLOCH**

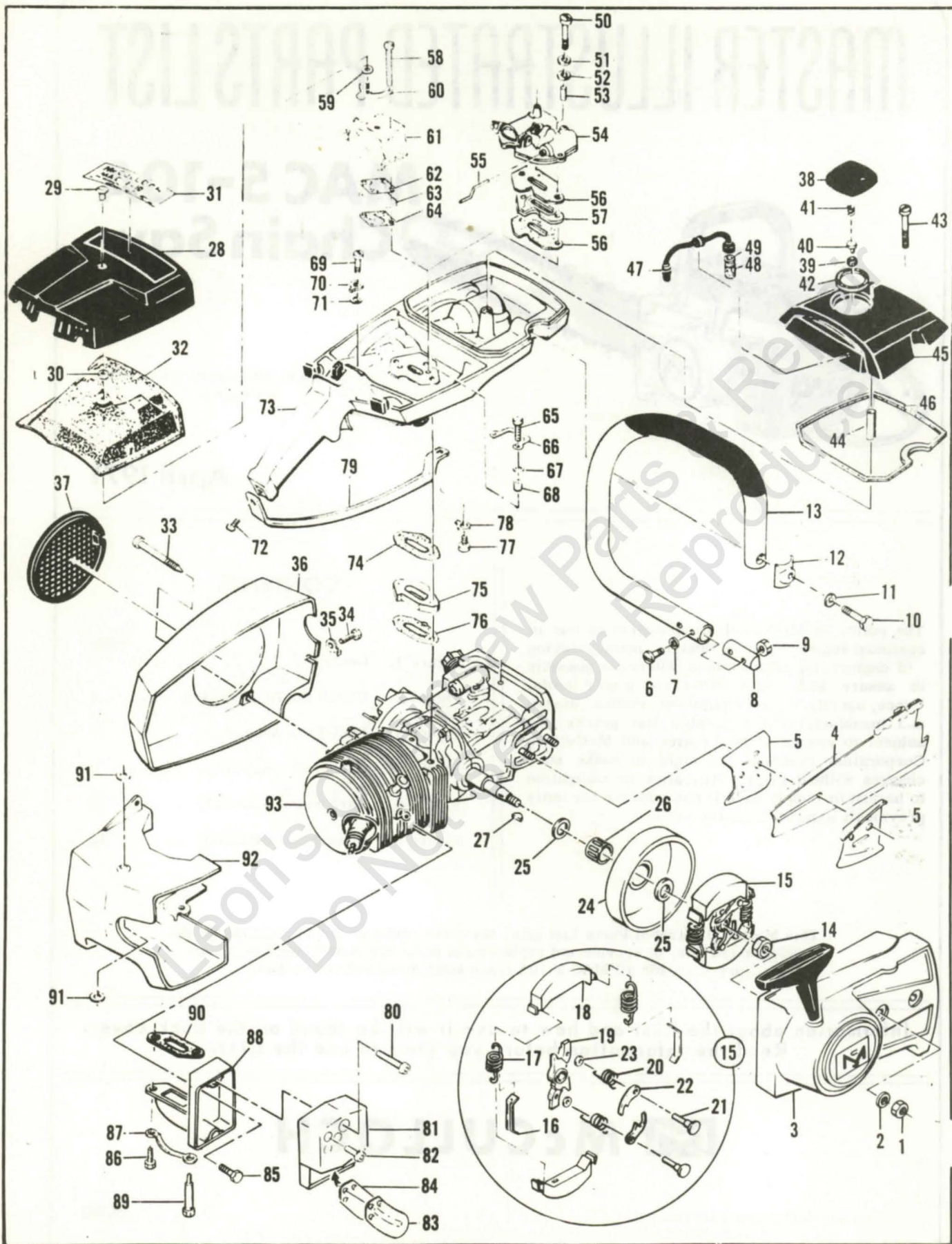

Figure 1. General

FIGURE 1. GENERAL

MAC 5-10A

Item No.	Part Number	Description	Units Per Assy	Usable On Code								
MAC 5-10A Usable On Code												
<table border="1" style="margin: auto; border-collapse: collapse;"> <thead> <tr> <th style="text-align: center;">Letter</th> <th style="text-align: center;">A</th> <th style="text-align: center;">B</th> <th style="text-align: center;">C</th> </tr> </thead> <tbody> <tr> <td style="text-align: center;">Serial Numbers</td> <td style="text-align: center;">Without Prefix</td> <td style="text-align: center;">Prefixed 1-</td> <td style="text-align: center;">Prefixed 10-</td> </tr> </tbody> </table>					Letter	A	B	C	Serial Numbers	Without Prefix	Prefixed 1-	Prefixed 10-
Letter	A	B	C									
Serial Numbers	Without Prefix	Prefixed 1-	Prefixed 10-									
1	110454	Nut - Hex 5/16-24	2	All								
2	100440	Washer - 5/16	2	All								
3		Clutch Guard & Starter Assy (See Figure 2)		All								
4		Bar & Chain Assys		All								
5	64325	Plate - Bar protector	2	All								
6	102761	Screw - Hex hd 10-24 x 7/8	2	All								
7	100352	Washer - #10	2	All								
8	61678	Plug - Nut retainer	1	All								
9	101326	Nut - Hex 10-24	2	All								
10	105187	Screw - Skt hd 1/4-20 x 1-1/8	1	A								
	102130	Screw - Hex hd 1/4-20 x 1-1/2	1	B,C								
11	100004	Washer - 1/4	1	A								
	100153	Lockwasher - 1/4	1	B,C								
12	63484	Clamp	1	B,C								
13	84269	Frame & Grip Assy	1	All								
14	103746	Nut - Hex 3/8-24	1	All								
15	67148	Clutch Assy	1	All								
16	64583	Retainer - Clutch spring	2	All								
17	66384	Spring - Clutch	2	All								
18	67233	Shoe - Clutch	2	All								
19	67149	Rotor Assy - Clutch	1	All								
20	68837	Spring - Pawl	2	All								
21	67112	Rivet - Pawl	2	All								
22	64857	Pawl - Starter	2	All								
23	65473	Washer - Special	2	All								
24	65370	Kit - Sprocket & Drum Assy	1	All								
25	61692	Shim - Sprocket	2	All								
26	110330	Bearing - Sprocket	1	All								
27	103879	Key - Woodruff	1	All								
28	65750	Cover Assy - Air cleaner	1	A,B								
	66597	Cover Assy - Air cleaner	1	C								
29	65720	Nut - Cover	1	A,B								
	66290	Nut - Cover	1	C								
30	66665	Spacer - Nut	1	C								
31	65463	Nameplate	1	A,B								
	67386	Nameplate	1	C								
32	68520	Filter - Air	1	All								
33	62978	Screw - Special	3	All								
34	105348	Screw - Hex hd 10-24 x 1/2 (SEMS)	1	C								
35	110264	Washer - #10	1	C								
36	83521	Kit - Fan housing	1	All								
37	55615	Guard - Flywheel	1	All								
38	68531	Cap Assy - Fuel	1	All								
39	68533	Plug	1	All								
40	63041	Valve	1	All								
41	63040	Spring	1	All								
42	65671	Gasket	1	All								
43	110402	Screw - Oval hd 12-24 x 2-3/8	1	All								
44	69686	Spacer - Cover	1	All								
45	63288	Cover - Fuel tank	1	All								
46	69345	Gasket - Cover	1	All								
47	64848	Hose Assy - Fuel	1	All								
48	63932	Filter - Fuel	1	All								

This list is continued on next page

FIGURE 1. GENERAL (Continued)

Item No.	Part Number	Description	Units Per Assy	Usabl/ On Cod.
49	100440	. Washer	1	All
50	110551	Screw - Hex hd 10-24 x 2-1/8	2	A,B
51	64856	Washer - Special	2	A,B
52	68203	Washer - Special	2	A,B
53	65726	Sleeve - Insulator	2	A,B
54		Carburetor Assy (See Figure 4)		A,B
55	65758	Rod - Primer	1	A,B
56	65739	Gasket - Carburetor	2	A,B
57	66232	Insulator - Carburetor	1	A,B
58	110553	Screw - Hex hd 10-24 x 1-3/8	2	C
59	67062	Seal - Aircleaner	1	C
60	66681	Bracket - Air cleaner cover	1	C
61		Carburetor Assy (See Figure 5)		C
62	68132	Gasket - Carburetor	1	C
63	84078	Insulator - Carburetor	1	C
64	68131	Gasket - Insulator	1	C
65	110553	Screw - Hex hd 10-24 x 1-3/8	2	C
66	68582	Lockplate	1	C
67	100003	Washer - #10	2	C
68	66189	Sleeve	2	C
69	110516	Screw - Hex hd 10-24 x 1-1/8	1	All
70	63475	Lockplate	1	All
71	64856	Washer - Special	1	All
72	110353	Screw - Oval hd 10-24 x 3/8	1	All
73		Fuel Tank Assy (See Figure 3)		All
74	64852	Gasket - Fuel tank	1	A,B
	84082	Gasket - Fuel tank	1	C
75	63258A	Insulator - Fuel tank	1	A,B
	66661	Insulator - Fuel tank	1	C
76	68129	Gasket - Insulator	1	A,B
	84082	Gasket - Insulator	1	C
77	102388	Screw - Hex hd 10-24 x 5/8	1	All
78	69890	Lockplate	1	All
79	85007	Brace - Handle	1	All
	68191	Kit - Spark arrester	1	All
80	104560	. Screw - Skt hd 10-24 x 1-1/2	2	All
81	65532	. Cover & Valve Assy	1	All
82	110472	. . Screw - Skt hd 8-32 x 5/16	2	All
83	84780	. . Stop - Reed	1	All
84	84779	. . Valve - Reed	1	All
85	84776	. Screw - Special	1	All
86	110529	. Screw - Hex hd 10-24 x 1/2	1	All
87	67922	. Lockplate	1	All
88	83106	. Body & Duct Assy	1	All
89	68187	. . Screw - Special	1	All
90	68149	. Gasket - Spark arrester	1	All
91	63993	Insulator - Shroud	2	A,B
	68581	Insulator - Shroud	2	C
92	67910	Shroud	1	All
93		Powerhead Assy (See Figure 6)		All

SERVICE SPECIFICATIONS

Spark Plug Gap -----	0.025 in.
Lamination Gap -----	0.010 to 0.015 in.
Breaker Point Gap -----	0.018 in.
Torque Values	
Flywheel Nut -----	240 to 300 inch-pounds.
Clutch Nut -----	160 to 170 inch-pounds.
Connecting Rod Screws -----	65 to 70 inch-pounds.

Master Illustrated Parts List, P/N 85763 supersedes and cancels all previous lists issued for the MAC 5-10A saw. Discard the following lists:

IPL 65663 and

Parts List Sheet 66101 covering saws having serial numbers without prefix

Parts List Sheet 66516 covering saws having serial numbers prefixed 1-

Parts List Sheet 67405 covering saws having serial numbers prefixed 10-

MAC 5-10A

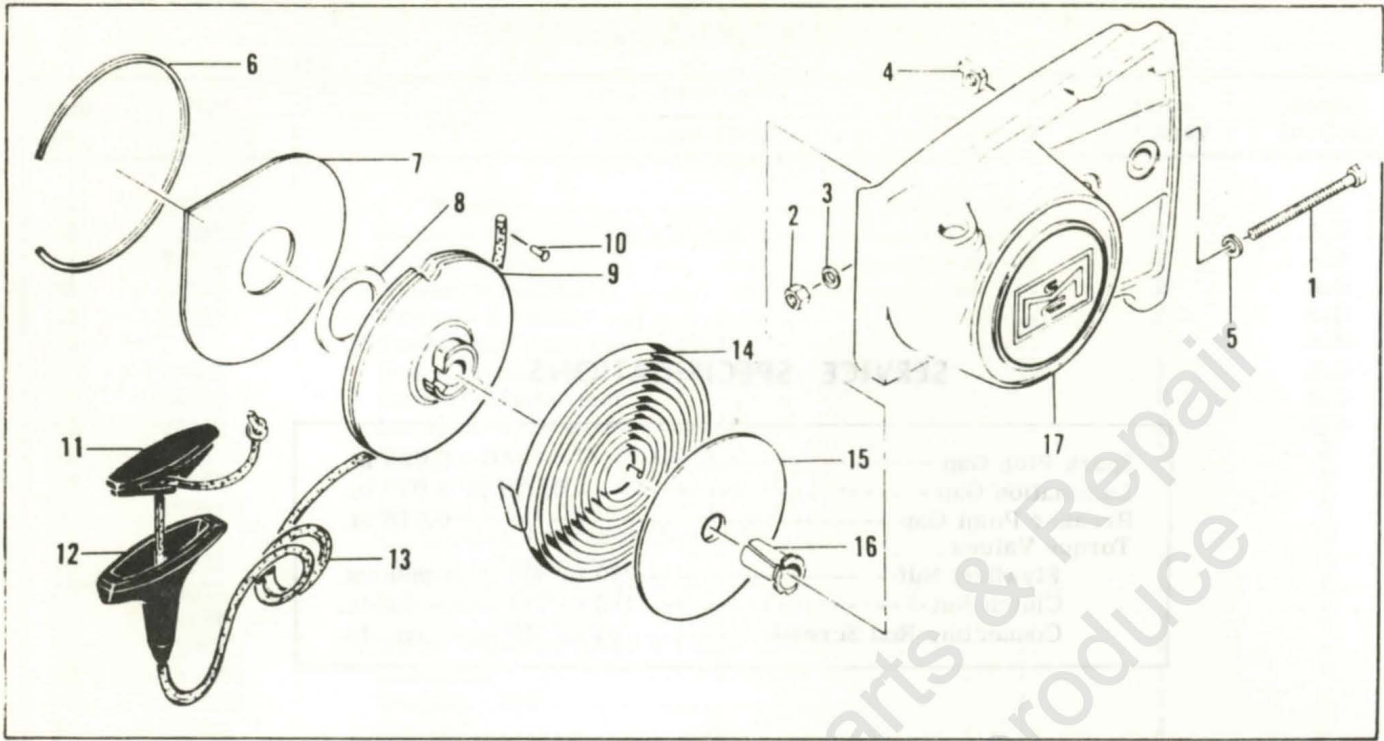

Figure 2. Clutch Guard and Starter Assembly

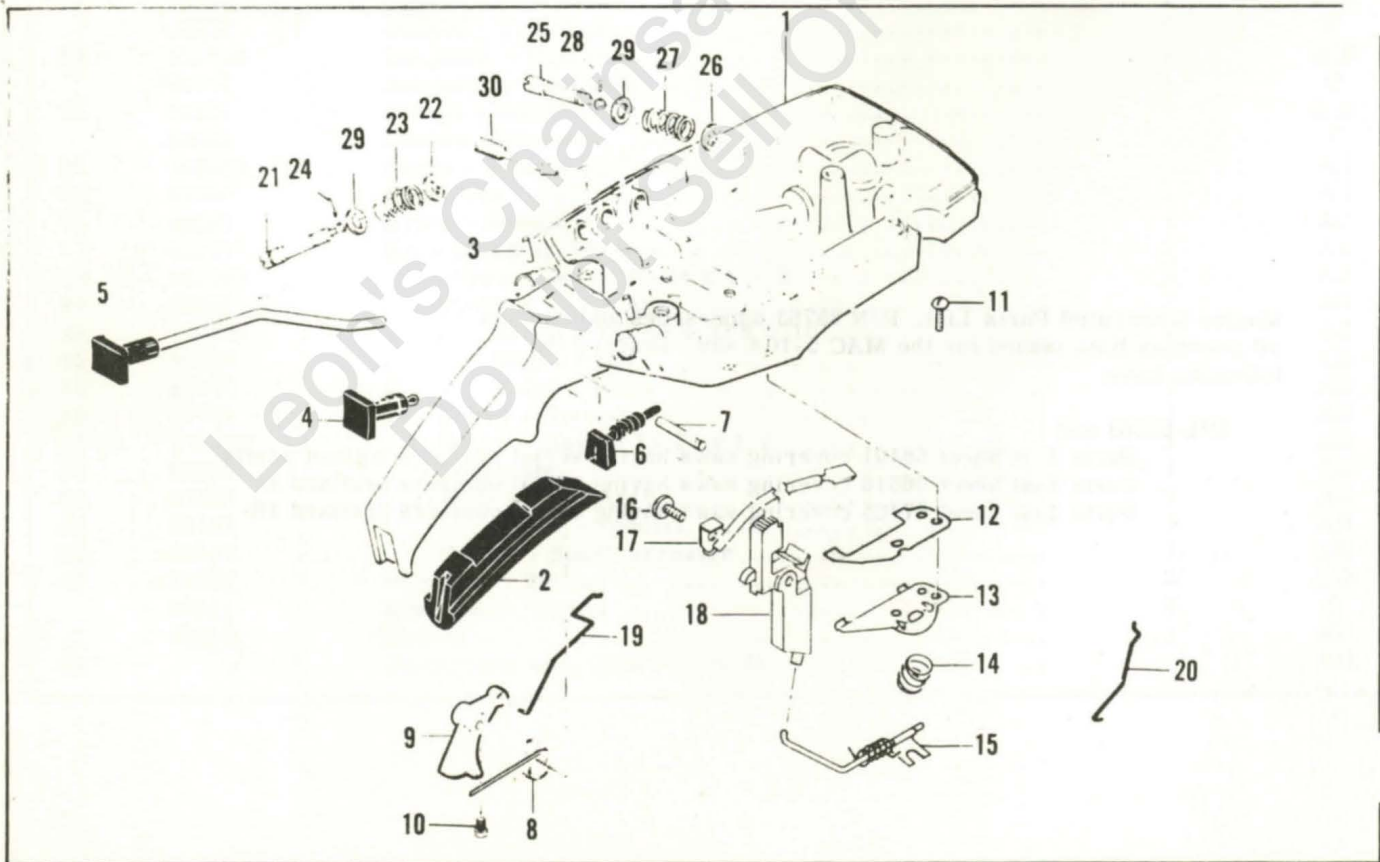

Figure 3. Fuel Tank Assembly

FIGURE 2. CLUTCH GUARD ASSEMBLY

Item No.	Part Number	Description	Units Per Assy	Usable On Code
	83850	Clutch Guard Assy	1	All
1	102144	. Screw - Bar adjusting	1	All
2	102067	. Nut - Hex 10-24	1	All
3	110387	. Washer - Wavey	1	All
4	61705	. Nut - Bar adjusting	1	All
5	110264	. Washer - #10	1	All
6	67205	. Retainer - Shield	1	All
7	63985	. Shield - Dust	1	All
8	63986	. Washer - Thrust	1	All
9	83651	. Drum - Starter	1	All
10	110470	. Rivet - Rope	1	All
11	62191A	. Insert - Handle	1	All
12	62190A	. Handle - Starter	1	All
13	69964	. Rope - Starter	1	All
14	68626	. Spring - Rewind	1	All
15	63987	. Shield - Spring	1	All
16	61635A	. Bushing - Nyliner	1	All
17	83569	. Guard - Clutch	1	All

MAC 5-10A Usable On Code

Letter	A	B	C
Serial Numbers	Without Prefix	Prefixed 1-	Prefixed 10-

FIGURE 3. FUEL TANK ASSEMBLY

Item No.	Part Number	Description	Units Per Assy	Usable On Code
1	66649	Fuel Tank Assy	1	A,B
	84183	Fuel Tank Assy	1	C
2	64872	Grip - Handle	1	All
3	105673	Pin - Roll 3/32 x 9/16	2	All
4	66194	Button - Primer	1	A,B
	68517	Button - Choke	1	C
5	64871	Button & Rod Assy - Oiler	1	All
6	67989	Seal - Throttle rod	1	All
7	110378	Pin - Roll 3/16 x 15 16	1	All
8	65734	Spring - Throttle return	1	All
9	67224	Trigger	1	All
10	110537	Screw - Fil hd 8-36 x 1/2	1	C
11	105249	Screw - Rd hd 8-32 x 3/8 (SEMS)	2	All
12	64621	Shield - Bracket	1	All
13	64721	Bracket - Lever	1	All
14	69687	Spring - Valve	1	All
15	69811	Lever Assy - DSP	1	All
16	110469	Screw - Pan hd 8-32 x 5/16 s t	1	All
17	65873	Wire Assy - Stop switch	1	All
18	67210	Button Assy - Control	1	All
19	66156	Rod - Throttle	1	A,B
	68170	Rod - Throttle	1	C
20	67355	Rod - Choke	1	C
21	68102	Extension Assy - High speed needle	1	C
22	110512	. Ring - Retaining	1	C
23	67363	. Spring	1	C
24	110509	. Pin - Groove	1	C
25	68101	Extension Assy - Idle needle	1	C
26	110512	. Ring - Retaining	1	C
27	67363	. Spring	1	C
28	110509	. Pin - Groove	1	C
29	67292	Washer - Special	2	C
30	67271	Screw - Idle adjustment	1	C

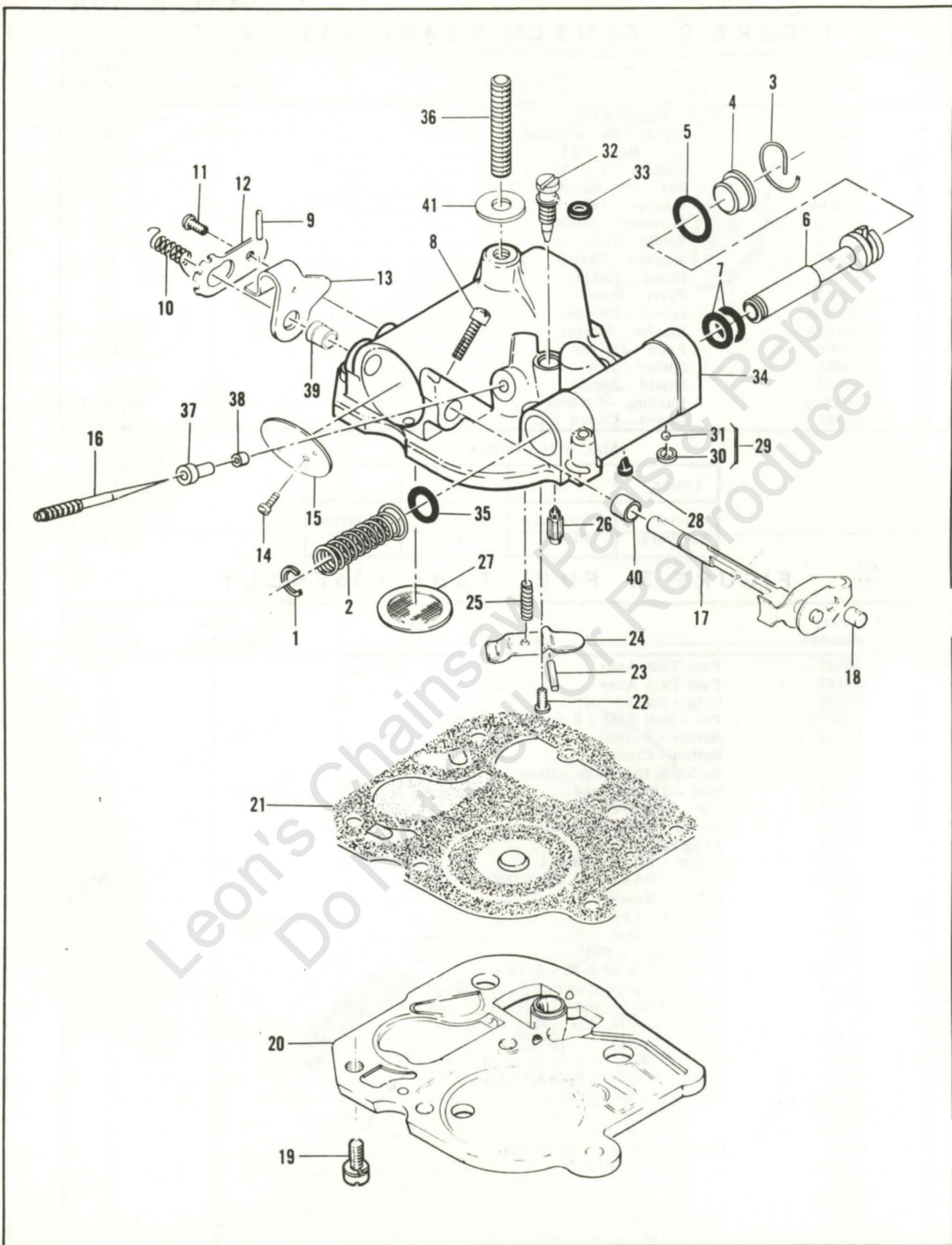

Figure 4. Carburetor Assembly

FIGURE 4. CARBURETOR ASSEMBLY

Item No.	Part Number	Description	Units Per Assy	Usable On Code								
MAC 5-10A Usable On Code												
		<table border="1"> <thead> <tr> <th>Letter</th> <th>A</th> <th>B</th> <th>C</th> </tr> </thead> <tbody> <tr> <td>Serial Numbers</td> <td>Without Prefix</td> <td>Prefixed 1-</td> <td>Prefixed 10-</td> </tr> </tbody> </table>	Letter	A	B	C	Serial Numbers	Without Prefix	Prefixed 1-	Prefixed 10-		
Letter	A	B	C									
Serial Numbers	Without Prefix	Prefixed 1-	Prefixed 10-									
	66511	Carburetor Assy (McCulloch Double Needle)	1	A,B								
1	101289	. Ring - Retaining	1	A,B								
2	65859	. Spring - Plunger	1	A,B								
3	65677	. Retainer - Plug	1	A,B								
4	65617	. Plug - Primer	1	A,B								
5	105617	. "O" Ring	1	A,B								
6	66552	. Plunger - Primer	1	A,B								
7	66551	. "O" Ring	2	A,B								
8	110483	. Screw - Long locking	1	A,B								
9	104245	. Pin - Roll .062 x 1 2	1	A,B								
10	62939A	. Spring - Idle governor	1	A,B								
11	103934	. Screw - Rd hd 6-32 x 1 4 (SEMS)	1	A,B								
12	62938	. Clip - Throttle shaft	1	A,B								
13	62343A	. Lever - Throttle	1	A,B								
14	104814	. Screw - Pan hd 4-40 x 1 4 (SEMS)	1	A,B								
15	62290A	. Plate - Throttle	1	A,B								
16	65431	. Needle - Metering	1	A,B								
17	62291A	. Shaft Assy - Throttle	1	A,B								
18	62975	. Swivel - Needle	1	A,B								
19	110397	. Screw - Pan hd 8-32 x 7 16 (SEMS)	4	A,B								
20	66507	. Plate - Carburetor base	1	A,B								
21	65608	. Diaphragm Assy - Pump	1	A,B								
22	104728	. Screw - Bind hd 6-32 x 1 4	1	A,B								
23	110337	. Pin - Inlet lever	1	A,B								
24	62310	. Lever - Inlet	1	A,B								
25	62923A	. Spring - Inlet lever	1	A,B								
26	63038	. Valve - Inlet needle	1	A,B								
27	55690B	. Seal - Capillary	1	A,B								
28	63041	. Valve - Primer	1	A,B								
29	65868	. Set - Ball and seat	1	A,B								
30	66153	. Seat	1	A,B								
31	61151	. Ball	1	A,B								
32	65445	. Needle - Main fuel	1	A,B								
33	104001	. "O" Ring	1	A,B								
34	66512	. Body Assy - Carburetor	1	A,B								
35	59796	. "O" Ring	1	A,B								
36	65724	. Stud - Carburetor	1	A,B								
37	66158	. Orifice - Air	1	A,B								
38	66569	. Orifice - Fuel	1	A,B								
39	62288A	. Bushing - Throttle shaft	1	A,B								
40	62368	. Bushing - Throttle shaft	1	A,B								
41	67062	. Seal - Carburetor stud	1	A,B								

McCULLOCH DOUBLE NEEDLE CARBURETOR ADJUSTMENT

1. Turn Lo Speed screw counterclockwise until it no longer touches stop and butterfly can be completely closed.
2. Hold finger against closed butterfly and turn Lo Mix needle clockwise until butterfly starts to open. Turn the needle counterclockwise two and one half turns.
3. Hold finger against closed butterfly and turn Lo Speed screw clockwise until butterfly starts to open. Turn the screw clockwise one half turn more.
4. Turn Hi Mix needle clockwise until resistance is felt, then turn the needle counterclockwise two full turns.
5. Turn the Lo Mix needle to obtain smooth rapid acceleration every time without faltering. Check for smooth idle for all positions of the saw and readjust the Lo Mix needle if necessary.
6. Adjust Hi Mix needle for maximum power under load. Turn the needle in for leaner and out for richer mixture. Do not adjust the needle for leaner mixture than necessary to obtain smooth, even running under a cutting load.

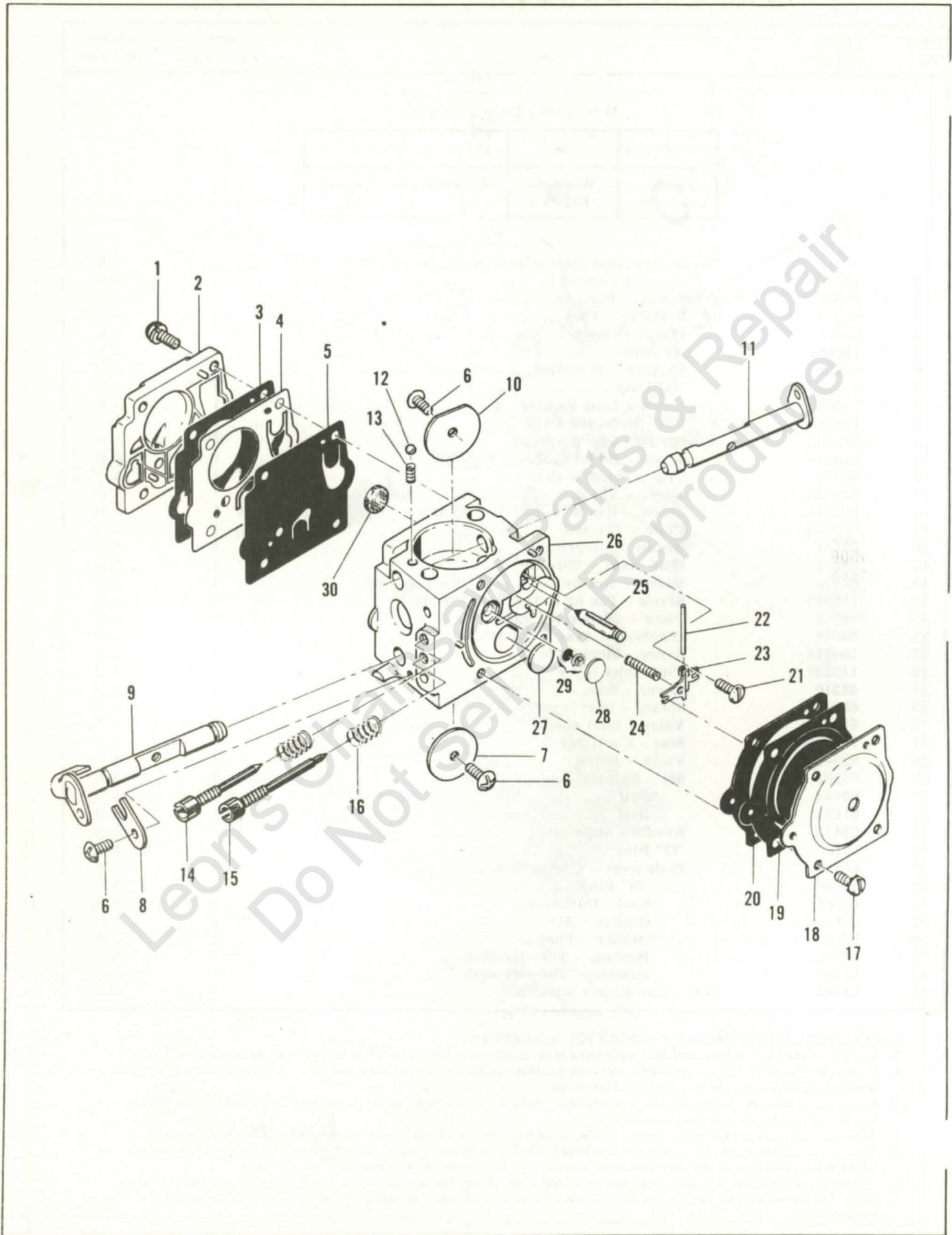

Figure 5. Carburetor Assembly

FIGURE 5. CARBURETOR ASSEMBLY

Item No.	Part Number	Description	Units Per Assy	Usable On Code								
MAC 5-10A Usable On Code												
<table border="1" style="width: 100%; border-collapse: collapse;"> <thead> <tr> <th style="width: 25%;">Letter</th> <th style="width: 25%;">A</th> <th style="width: 25%;">B</th> <th style="width: 25%;">C</th> </tr> </thead> <tbody> <tr> <td>Serial Numbers</td> <td>Without Prefix</td> <td>Prefixed 1-</td> <td>Prefixed 10-</td> </tr> </tbody> </table>					Letter	A	B	C	Serial Numbers	Without Prefix	Prefixed 1-	Prefixed 10-
Letter	A	B	C									
Serial Numbers	Without Prefix	Prefixed 1-	Prefixed 10-									
	67379	Carburetor Assy (McCulloch SDC-2)	1	C								
1	67501	. Screw - Pump cover	4	C								
2	83760	. Cover - Pump	1	C								
3	*67495	. Gasket - Cover	1	C								
4	*67498	. Diaphragm - Check valve	1	C								
5	*83114	. Diaphragm - Fuel pump	1	C								
6	*47690	. Screw - Plate	3	C								
7	67487	. Plate - Throttle	1	C								
8	67489	. Clip - Shaft	1	C								
9	67486	. Shaft Assy - Throttle	1	C								
10	67490	. Plate - Choke	1	C								
11	67488	. Shaft Assy - Choke	1	C								
12	*100302	. Ball - Choke friction	1	C								
13	*67504	. Spring - Choke	1	C								
14	*67506	. Needle - High speed	1	C								
15	*67505	. Needle - Idle	1	C								
16	*67502	. Spring - Needle	2	C								
17	70798	. Screw - Diaphragm cover	4	C								
18	83761	. Cover - Diaphragm	1	C								
19	*67499	. Diaphragm - Metering	1	C								
20	*67496	. Gasket - Diaphragm	1	C								
21	*67500	. Screw - Lever pin	1	C								
22	*67508	. Pin - Lever	1	C								
23	*67509	. Lever - Metering	1	C								
24	*67503	. Spring - Lever	1	C								
25	*67491	. Valve - Needle	1	C								
26	67483	. Body Assy - Carburetor	1	C								
27	*71690	. Plug - 3/8	1	C								
28	*69506	. Plug - 5/16	1	C								
29	83758	. Kit - Valve & Seat Assy		C								
30	*67507	. Screen - Fuel	1	C								
	*67482	Gasket Set										
	67481	Repair Kit										

*Indicates parts included in Repair Kit, P/N 67481

MCCULLOCH SDC-2 CARBURETOR ADJUSTMENT

- Carefully turn both the high speed and idle needles clockwise until resistance is felt, then turn both needles counterclockwise one full turn.
- With engine warmed up, adjust the idle speed screw in or out until the engine idles just below clutch engagement speed.
- Adjust the idle mixture needle in or out (leaner or richer) to obtain smooth, rapid acceleration every time without faltering. If necessary, readjust the idle speed screw.
- Adjust the high speed mixture needle for maximum power under load. Turn the needle in for leaner and out for richer mixture. Do not use any leaner setting than necessary to obtain smooth, even running when cutting wood.

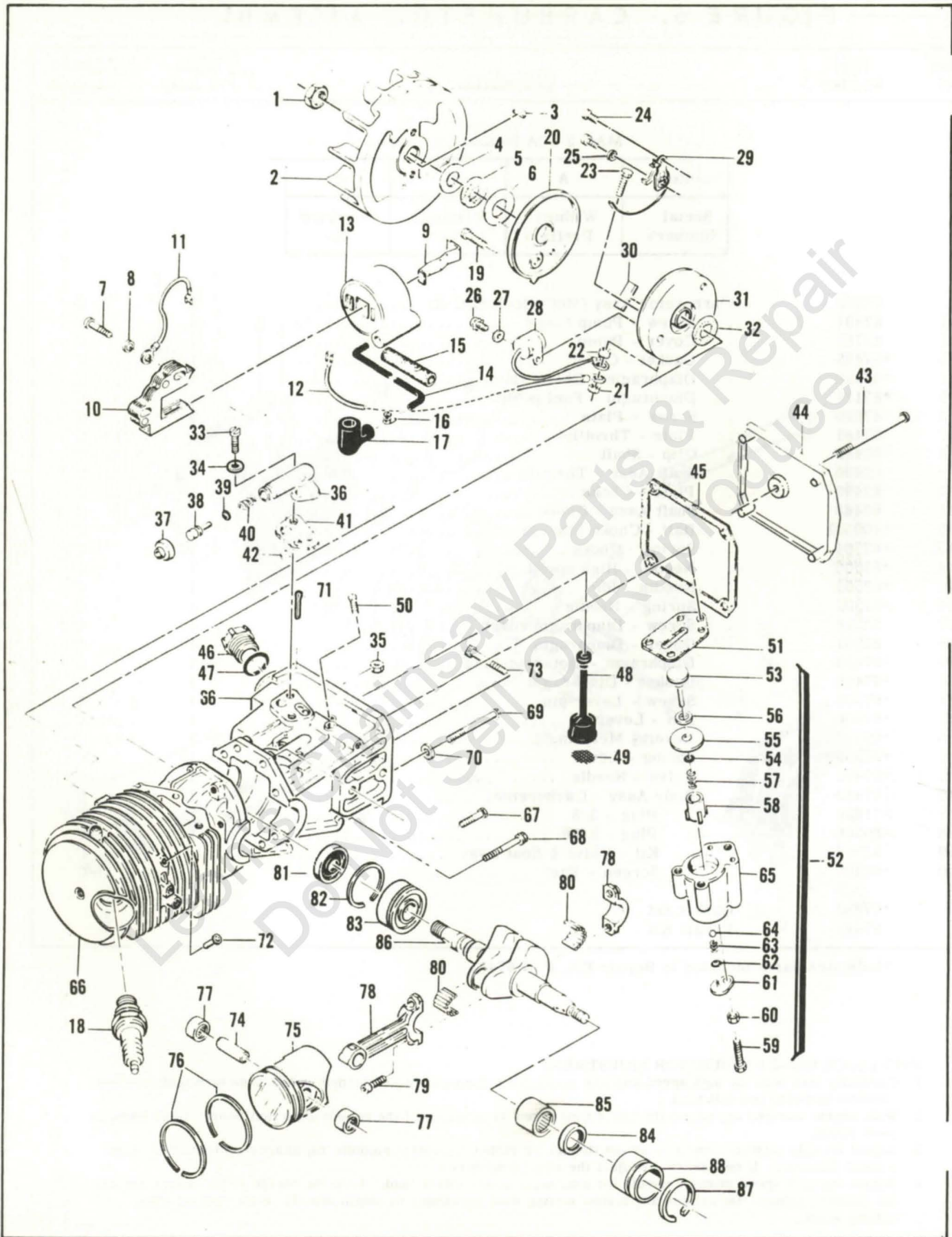

Figure 6. Powerhead Assembly

FIGURE 6. POWERHEAD ASSEMBLY

Item No.	Part Number	Description	Units Per Assy	Usable On Code								
MAC 5-10A Usable On Code												
<table border="1"> <thead> <tr> <th>Letter</th> <th>A</th> <th>B</th> <th>C</th> </tr> </thead> <tbody> <tr> <td>Serial Numbers</td> <td>Without Prefix</td> <td>Prefixed 1-</td> <td>Prefixed 10-</td> </tr> </tbody> </table>					Letter	A	B	C	Serial Numbers	Without Prefix	Prefixed 1-	Prefixed 10-
Letter	A	B	C									
Serial Numbers	Without Prefix	Prefixed 1-	Prefixed 10-									
1	101391	Nut - Hex 3/8-24	1	All								
2	84681	Flywheel Assy	1	All								
3	103879	Key - Woodruff	1	All								
4	67057	Washer - Thrust	1	C								
5	67056	Seal	1	C								
6	67054	Washer - Thrust	1	C								
7	101965	Screw - Fil hd 10-24 x 7/8 (SEMS)	2	All								
8	100003	Washer - #10	2	All								
9	51253	Retainer - Coil	1	All								
10	62741	Lamination Assy	1	All								
11	62819	Wire Assy - Ground	1	All								
12	69344	Wire Assy - Primary	1	All								
13	84972	Coil & Terminal Assy	1	All								
14	69966	Wire Assy - Spark plug	1	All								
15	67127	Sleeve	1	All								
16	62932	Connector	1	All								
17	62926	Boot	1	All								
18	63432	Spark Plug - AC CS42T	1	All								
19	110349	Screw - Rd hd 8-32 x 3/4	1	All								
20	62362	Cover - Breaker box	1	All								
21	100298	Nut - Hex 6-32	1	All								
22	62365	Spacer - Breaker screw	1	All								
23	110346	Screw - Hex hd 6-32 x 3/4	1	All								
24	100934	Screw - Rd hd 8-32 x 3/8	2	All								
25	105976	Washer - #8	1	All								
26	105249	Screw - Rd hd 8-32 x 3/8 (SEMS)	1	All								
27	100080	Washer - #8	1	All								
28	61650	Condenser	1	All								
29	62363	Breaker Assy	1	All								
30	54184	Wiper - Cam	1	All								
31	62361	Box - Breaker	1	All								
32	67051	Seal - Breaker box	1	C								
33	110623	Screw - Fil hd 8-32 x 1/2	2	All								
34	105976	Washer - #8	2	All								
35	100955	Nut - Hex 8-32	1	All								
36	84156	Housing - Pump	1	All								
37	62262	Cap - Housing	1	All								
38	62266	Plunger - Pump	1	All								
39	101056	"O" Ring	1	All								
40	66687	Spring - Plunger	1	All								
41	62230	Gasket - Pump	1	All								
42	62909	Valve - Pump	1	All								
43	110291	Screw - Pan hd 10-24 x 2-5/8	1	All								
44	63072	Cover - Oil tank	1	All								
45	62116	Gasket - Cover	1	All								
46	57129A	Cap - Oil tank	1	All								
47	101148	"O" Ring	1	All								
48	62123B	Hose Assy - Oil	1	All								
49	51506	Screen - Oil	1	All								
50	110333	Screw - Oval hd 8-32 x 1/2	3	All								
51	62274	Gasket - Pulse pump	1	All								
52	83786	Pump Assy - Pulse	1	All								
53	60260A	Piston Assy - Pump	1	All								

FIGURE 6. POWERHEAD ASSEMBLY (Continued)

Item No.	Part Number	Description	Units Per Assy	Usable On Code
54	104001	"O" Ring	1	All
55	60263	Ring - Pump piston	1	All
56	60937	Washer - Teflon	1	All
57	60259	Spring - Piston	1	All
58	62227	Sleeve - Adjustment	1	All
59	110386	Screw - Hex hd 8-32 x 1	1	All
60	100251	Nut - Hex 8-32	1	All
61	63858	Cover - Outlet valve	1	All
62	106104	"O" Ring	1	All
63	62885A	Spring - Outlet valve	1	All
64	102809	Ball - Valve	1	All
65	83787	Body Assy - Pump	1	All
66	67354	Crankcase Assy	1	All
67	110288	Screw Assy	2	All
68	110618	Screw Assy	1	All
69	62105	Screw Assy - Sealing	4	All
70	62842	Washer - Sealing	4	All
71	100010	Pin - Cotter	1	All
72	83137	Valve Assy - DSP	1	All
73	62065	Bolt - Bar mounting	2	All
74	65389	Pin - Piston	1	All
75	69412	Piston Assy	1	All
76	63290	Ring Set - Piston	1	All
77	103085	Bearing - Needle	2	All
78	65401	Connecting Rod Assy	1	All
79	61627A	Screw - Skt hd special	2	All
80	63225	Roller - Needle (set of 20)	1	All
81	61618	Seal - Oil	1	All
82	63464	Ring - Snap	1	All
83	63429B	Bearing - Ball	1	All
84	110260	Seal - Oil	1	All
85	104357	Bearing - Needle	1	All
86	63336	Crankshaft	1	All
87	63699	Ring - Bearing insert	1	All
88	63701	Insert - Bearing	1	All

ACCESSORIES

Part Number	Description
69413	Piston Assy - 0.020 in. oversize
63291	Ring Set - Piston 0.020 in. oversize
103512	Bearing - Needle (2)
69414	Piston Assy - 0.030 in. oversize
63292	Ring Set - Piston 0.030 in. oversize
103512	Bearing - Needle (2)
63341A	Kit - Spike
69058	Kit - Wrap-around frame
69191	Kit - Pressure test adaptor
65712	Guide - Timing
63097	Spark Plug - AC CS 45 T
65778	Spark Plug - AC CS 41 T
62827	Wrench - Combination
63746	Scrench
83434	Owner's Manual
63084	Shop Manual

40:1 TWO-CYCLE MOTOR OIL

Reduces smoke, carbon and engine wear.



- 6 oz. can #78960
- 6-pack #78961
- 16 oz. can #78963
- 6-pack #78964
- 1 qt. bottle #110626

CHAIN, BAR AND SPROCKET OIL

Specially designed for extra lubrication of bars and chains.



- 1 qt. bottle #110631
- Case of 24 #110632

BAR GUARDS

Protect bar and chain from accidental damage.



- A (A) for wide bars #56927
- B (B) narrow bars #64930



- C (C) MAC 10 - 16, 20" #66544
- D (D) PM 6 - 12, 16" #83124

LOCQUIC AND

Primer. Cleans, degreases, and accelerates curing.

- 7-1/2 oz. spray can. #69794



LOCTITE

Sealant, bonding agent

10cc plastic bottle



- #67537

SPRAY PAINT

Black

- 12 oz. can #103503
- Case of 12 #103400



Yellow

- 12 oz. can #102449
- Case of 12 #102464

STARTER ROPE

Solid, braided nylon



100' spool

- #36825

CHAIN SHARPENING TOOLS

The ● shows which tools are used on chains

McCULLOCH FILES



	S-25	SM-57	S-40	S-80	S-90
1 8" round	●				
3 32" round	●	●			
3 16" round		●			
7 32" round			●		
1 4" round				●	
9 32" round					●
8" flat	●	●	●	●	●
6" flat safety	●	●	●	●	●

FILE GUIDE & FILE



- #67750 (1 8" round)
- #60950 (7 32" round)
- (Also holds 3 16" and 1 4" round)

DEPTH GAUGE TOOLS



- #56241 .045-.060"
- #64198 .035-.060"
- #64359 .045-.050"
- #67688 .015-.020"
- #67680 .025-.030"

FILE-N-JOINT

Assures correct filing angle, height.

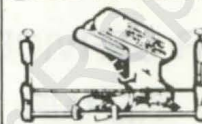

- #61034

"BREAK ALL" CHAIN BREAKER

Required when repairing chain.



- #61753
- Instructions included.

PRESSURE TEST TOOLS

For leakage check of crankcase, fuel system.



- Basic unit #62849

McCULLOCH
CORPORATION



● MANUFACTURING ● SALES ● SERVICE ●

McCULLOCH
CORPORATION

P.O. Box 92180, Los Angeles, CA 90009

Copyright - McCulloch.

FOR SERVICE-RELATED PROBLEMS,
REPAIR OR MAINTENANCE
TAKE YOUR UNIT TO THE NEAREST
AUTHORIZED McCULLOCH SERVICING
DEALER LISTED IN YOUR
TELEPHONE DIRECTORY YELLOW PAGES.

If additional assistance is required, call this toll-free hot-line:
(800) 423-6302

Arizona residents call collect (602) 453-3681