

MASTER ILLUSTRATED PARTS LIST

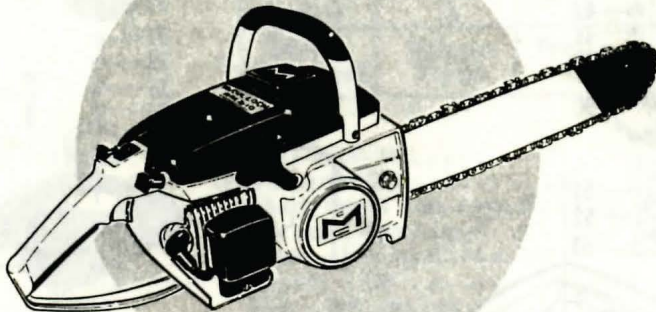

MAC 3-10 Chain Saw

MAY 1970

CONTENTS

The policy of McCulloch Corporation is one of continual improvement in design, manufacturing and engineering advancement wherever possible to assure still finer two-cycle power tools. Hence, specifications, equipment, colors, design and manufacturer's suggested list prices are subject to change without notice and McCulloch Corporation reserves the right to make such changes without prior notification or obligation to backfit or supply backfit components for units previously shipped from the factory.

	Page
Figure 1. Engine Exploded View - General	2
Figure 2. Clutch Guard and Starter Assembly	6
Figure 3. Fuel Tank Assembly	6
Figure 4. Carburetor Assembly	8
Figure 5. Carburetor Assembly	10
Figure 6. Powerhead Assembly	12

This Master Illustrated Parts List gives the name, number and interchangeability between engines, of service and replacement parts which were used on or are presently available for all MAC 3-10 chain saws manufactured to date.

Information about the List and how to use it will be found on the back cover.
Read the information before you start to use the List.

 **McCULLOCH**

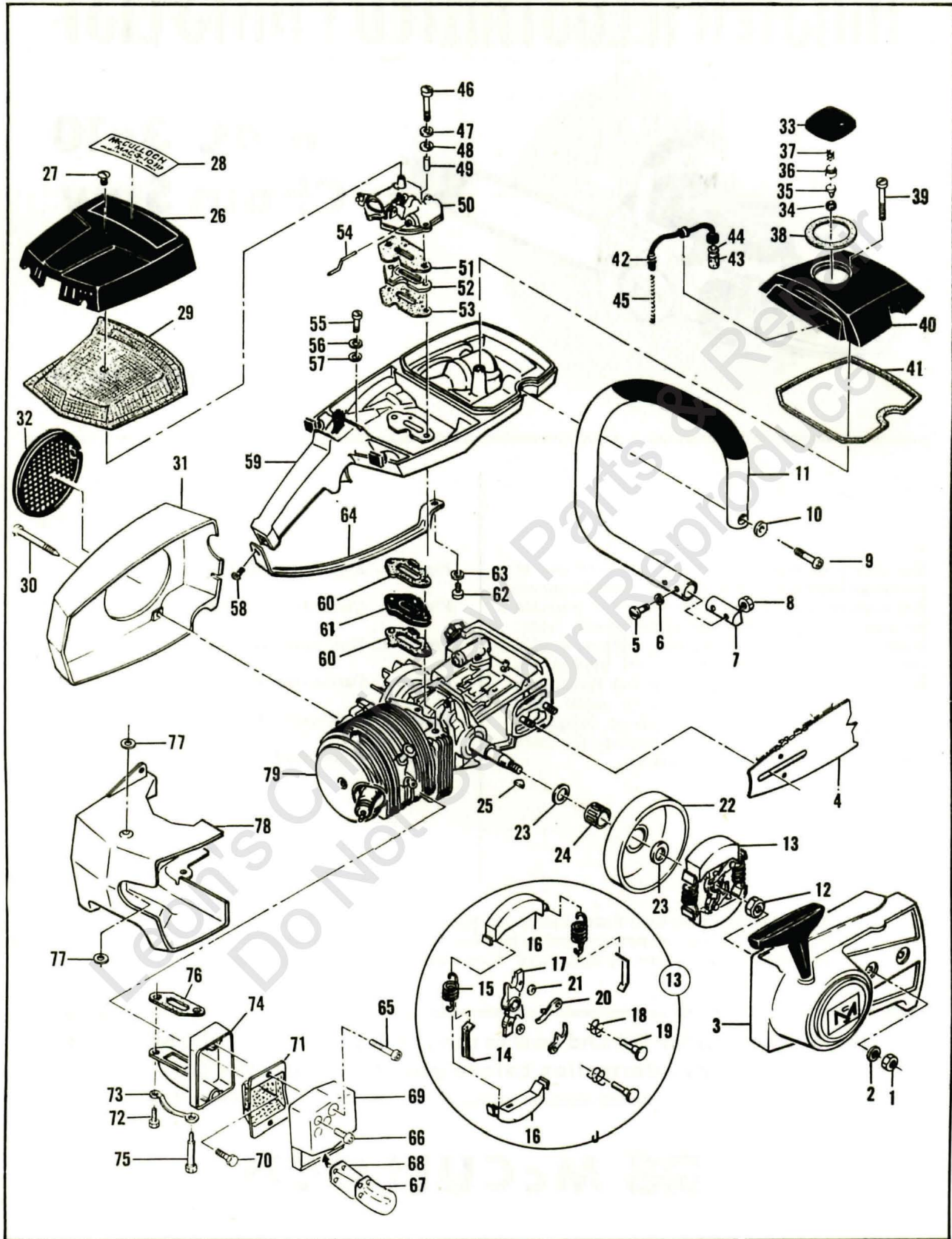

Figure 1. Engine Exploded View - General

FIGURE 1. ENGINE EXPLODED VIEW — GENERAL

Index No.	Part Number	Nomenclature	Units Per Assy	Usable On Code								
MAC 3-10 Usable on Code												
		<table border="1" style="width: 100%; border-collapse: collapse;"> <thead> <tr> <th style="width: 25%;">Letter</th> <th style="width: 25%;">A</th> <th style="width: 25%;">B</th> <th style="width: 25%;">C</th> </tr> </thead> <tbody> <tr> <td>Serial Numbers</td> <td>Without Prefix</td> <td>Prefix 1-</td> <td>Prefix 2-</td> </tr> </tbody> </table>	Letter	A	B	C	Serial Numbers	Without Prefix	Prefix 1-	Prefix 2-		
Letter	A	B	C									
Serial Numbers	Without Prefix	Prefix 1-	Prefix 2-									
1	110454	Nut - 5/16-24	2	All								
2	100440	Washer - 5/16	2	All								
3		Clutch Guard Assy (see Figure 2)		All								
4		Bar and Chain Assy	1	All								
5	102761	Screw - Hex hd 10-24 x 7/8	2	All								
6	100352	Washer - #10	2	All								
7	61678	Plug - Nut retainer	1	All								
8	101326	Nut - Hex 10-24	2	All								
9	105187	Screw - Skt hd 1/4-20 x 1-1/8	1	All								
10	100004	Washer - 1/4	1	All								
11	67372	Frame and Grip Assy	1	All								
12	103746	Nut - Flexloc 3/8-24	1	All								
13	67148	Clutch Assy	1	All								
14	64583	. Retainer - Clutch spring	2	All								
15	66384	. Spring - Clutch	2	All								
16	67233	. Shoe - Clutch	2	All								
17	67149	. Rotor Assy - Clutch	1	All								
18	68837	. Spring - Pawl	2	All								
19	67112	. Rivet - Pawl	2	All								
20	64857	. Pawl - Starter	2	All								
21	65473	. Washer - Special	2	All								
22	65370	Kit - Sprocket and Drum	1	All								
23	61692	. Shim - Sprocket	2	All								
24	110330	Bearing - Sprocket	1	All								
25	103879	Key - Woodruff	1	All								
26	62117	Cover Assy - Air cleaner	1	A								
	65866	Cover Assy - Air cleaner	1	B,C								
27	62434	. Nut - Cover	1	A								
	65813	. Nut - Cover	1	B,C								
28	65459	Nameplate	1	All								
29	62077	Screen - Air cleaner	1	A								
	66774	Screen - Air cleaner	1	B,C								
30	62978	Screw - Special	3	All								
31	83521	Kit - Fan housing	1	All								
32	55615	. Guard - Flywheel	1	All								
33	68531	Fuel Cap Assy	1	All								
34	68533	. Plug	1	All								
35	63041	. Valve	1	All								
36	62316	. Guide	1	All								
37	63040	. Spring	1	All								
38	65671	. Gasket	1	All								
39	110334	Screw - Oval hd 12-24 x 1-3/4	1	All								
40	63656	Cover - Fuel tank	1	All								
41	69345	Gasket - Cover	1	All								
42	64848	Hose Assy - Fuel	1	All								
43	63932	. Filter - Fuel	1	All								
44	100440	. Washer - 5/16	1	All								
45	67944	Spring - Hose	1	All								
46	103355	Screw - Hex hd 10-24 x 1-7/8	2	A								
	103124	Screw - Hex hd 10-24 x 2	2	B,C								
47	64856	Washer - Special	2	All								

This list is continued on next page

FIGURE 1. ENGINE EXPLODED VIEW — GENERAL (CONT)

Index No.	Part Number	Nomenclature	Units Per Assy	Usable On Code
48	68203	Washer - Insulator	2	All
49	62327A	Sleeve - Insulator	2	A
	65726	Sleeve - Insulator	2	B,C
50		Carburetor Assy (see Figure 4)		A
		Carburetor Assy (see Figure 5)		B,C
51	65672	Gasket - Carburetor	1	All
52	65821	Insulator - Carburetor	1	B,C
53	65672	Gasket - Insulator	1	B,C
54	62066A	Rod - Primer	1	A
	65604	Rod - Primer	1	B,C
55	102290	Screw - Hex hd 10-24 x 1-1/8	1	All
56	64856	Washer - #10	1	A,B
	63475	Lockplate	1	C
57	55636	Washer - Insulator	1	All
58	110353	Screw - Oval hd 10-24 x 3/8	1	All
59		Fuel Tank Assy (see Figure 3)		All
60	68130	Gasket - Fuel tank	2	All
61	66659	Insulator - Fuel tank	1	All
62	102289	Screw - Hex hd 10-24 x 3/4	1	All
63	100352	Washer - #10	1	All
64	69838	Brace - Handle	1	All
	68191	Kit - Spark arrester	1	All
65	110473	. Screw - Skt hd 10-24 x 1-5/8	2	All
	65532	. Cover and Valve Assy	1	All
66	110472	. . Screw - Skt hd 8-32 x 5/16	3	All
67	83069	. . Stop - Reed	1	All
68	64785	. . Valve - Reed	1	All
69	*65419	. . Cover Assy	1	All
70	110341	. Screw - Hex hd 10-24 x 1/2	1	All
71	62379B	. Baffle	1	All
72	110529	. Screw - Hex hd 10-24 x 1/2	1	All
73	67922	. Lockplate	1	All
74	83106	. Body and Duct Assy	1	All
75	68187	. . Screw - Special	1	All
76	68149	. Gasket - Spark arrester	1	All
77	62085A	Insulator - Shroud	2	All
78	67377	Shroud	1	All
79		Powerhead Assy (see Figure 6)		All

*Cover Assy, P/N 62380, may be ordered for service replacement and use with Body and Duct Assy, P/N 64601, only.

Master Illustrated Parts List, P/N 84482, supersedes and cancels all previous lists issued for the MAC 3-10 saw. Discard the following lists:

IPL 65327 and

- Parts list sheet 65878 covering saws having serial numbers without prefix.
- Parts list sheet 66108 covering saws having serial numbers prefixed 1-.
- Parts list sheet 66711 covering saws having serial numbers prefixed 2-.

SERVICE SPECIFICATIONS

Spark Plug Gap	-----	0.025 in.
Lamination Gap	-----	0.010 to 0.015 in.
Breaker Point Gap	-----	0.018 in.
Torque Values		
Flywheel Nut	-----	240 to 300 inch-pounds.
Clutch Nut	-----	160 to 170 inch-pounds.
Connecting Rod Screws	-----	65 to 70 inch-pounds.

Leon's Saw Parts & Repair
Do Not Reproduce

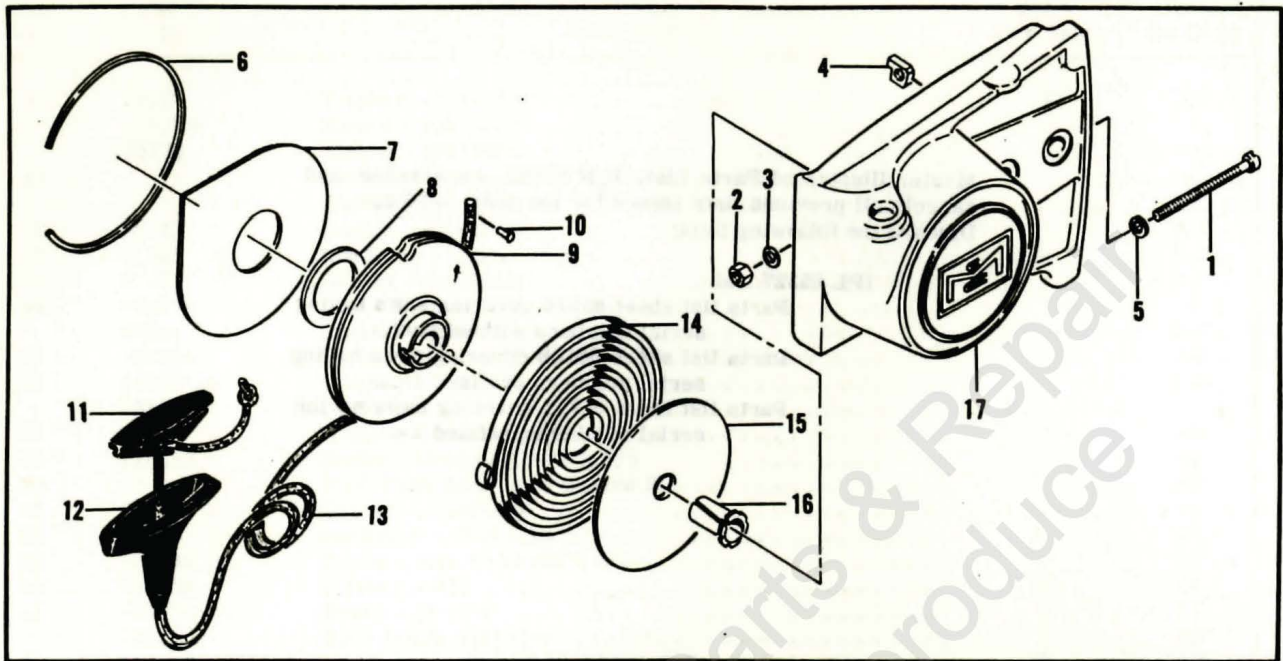

Figure 2. Clutch Guard and Starter Assembly

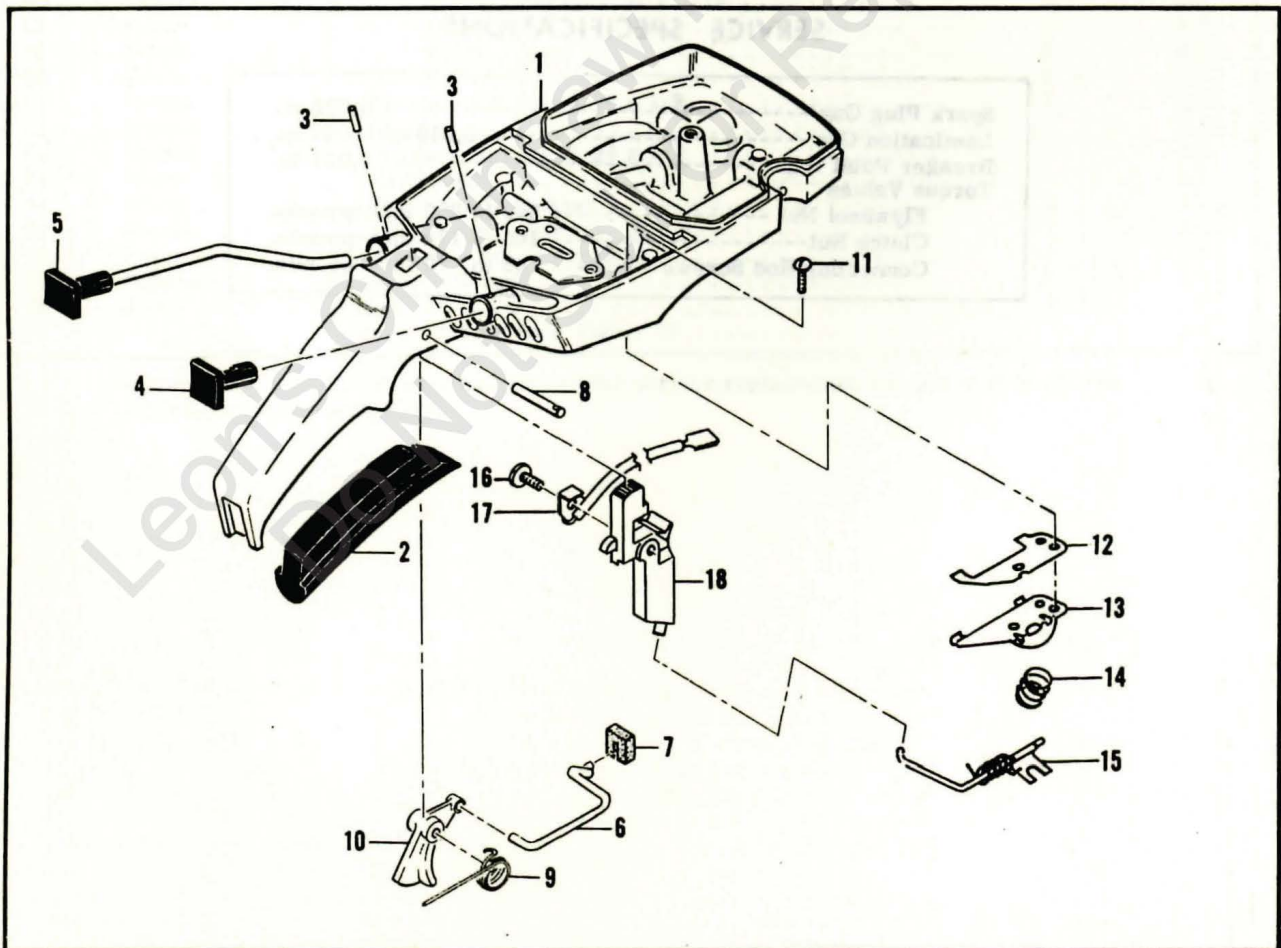

Figure 3. Fuel Tank Assembly

FIGURE 2. CLUTCH GUARD AND STARTER ASSEMBLY

Index No.	Part Number	Nomenclature	Units Per Assy	Usable On Code
	83850	Clutch Guard Assy	1	All
1	102144	. Screw - Bar adjusting	1	All
2	102067	. Nut - Hex 10-24	1	All
3	110387	. Washer - Wave	1	All
4	61705	. Nut - Bar adjusting	1	All
5	101174	. Washer - #10	1	All
6	67205	. Retainer - Shield	1	All
7	63985	. Shield - Dust	1	All
8	63986	. Washer - Thrust	1	All
9	83651	. Drum - Starter	1	All
10	110470	. Rivet - Starter	1	All
11	62191A	. Insert - Handle	1	All
12	62190A	. Handle - Starter	1	All
13	69964	. Rope - Starter	1	All
14	68626	. Spring - Rewind	1	All
15	63987	. Shield - Spring	1	All
16	61635A	. Bushing - Nyliner	1	All
17	67207	. Guard - Clutch	1	All

MAC 3-10 Usable on Code

Letter	A	B	C
Serial Numbers	Without Prefix	Prefix 1-	Prefix 2-

FIGURE 3. FUEL TANK ASSEMBLY

Index No.	Part Number	Nomenclature	Units Per Assy	Usable On Code
1	66648	Fuel Tank Assy	1	All
2	64872	Grip - Handle	1	All
3	105673	Pin - Roll 3/32 x 9/16	2	All
4	66194	Button - Primer	1	All
5	64871	Button and Rod Assy - Oiler	1	All
6	62970C	Rod - Throttle	1	A
	65816	Rod - Throttle	1	B,C
7	67989	Seal - Throttle rod	1	All
8	110378	Pin - Roll 3/16 x 15/16	1	All
9	65734	Spring - Throttle return	1	All
10	67224	Trigger - Throttle	1	All
11	105249	Screw - Rd hd 8-32 x 3/8 (SEMS)	1	All
12	64621	Shield - Bracket	1	All
13	64721	Bracket - Compression release lever	1	All
14	69687	Spring - Compression release valve	1	All
15	69811	Lever - Compression release	1	All
16	110469	Screw - Pan hd 8-32 x 5/16 s/t	1	All
17	65873	Wire Assy - Stop switch	1	All
18	67209	Button - Control	1	All

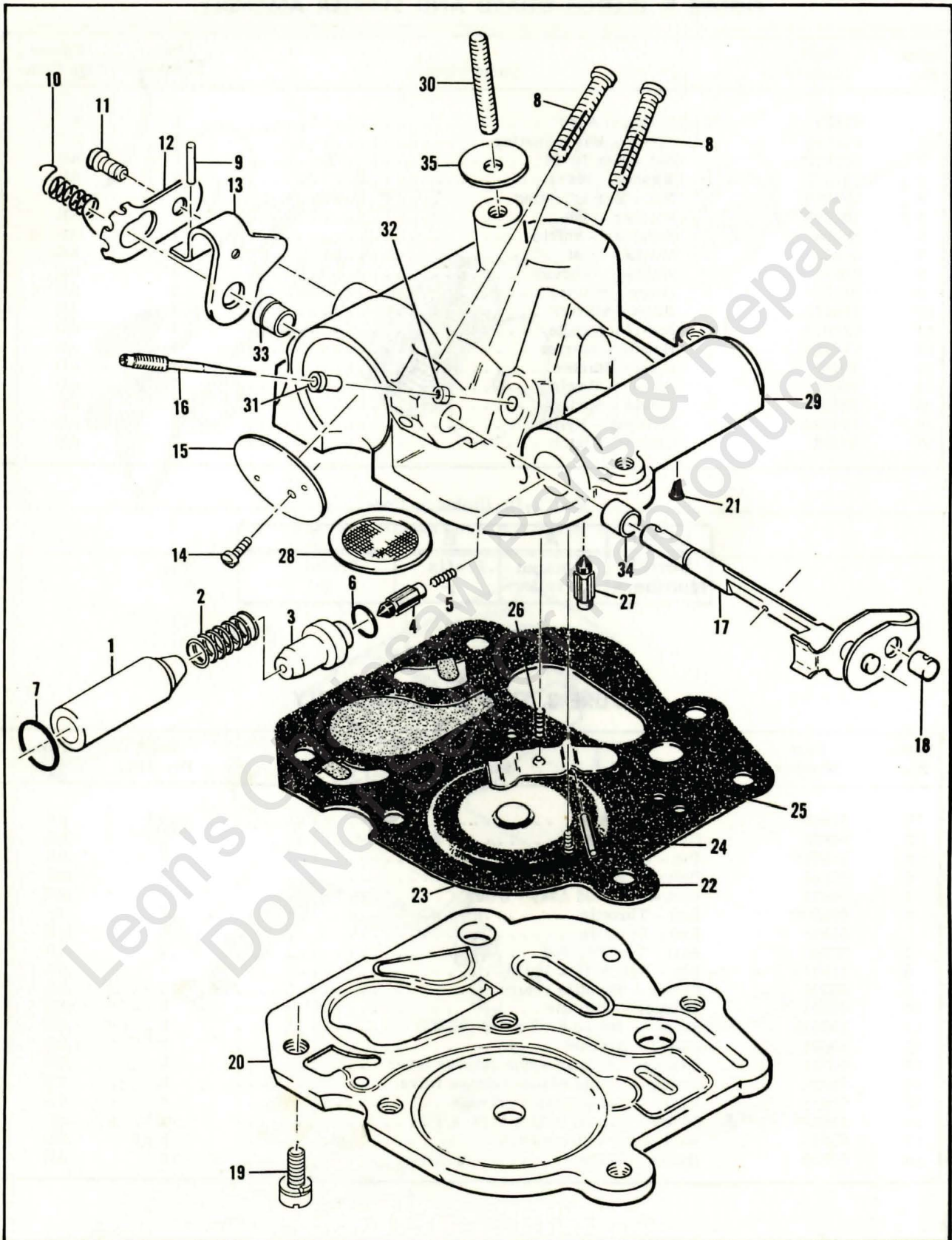

Figure 4. Carburetor Assembly

FIGURE 4. CARBURETOR ASSEMBLY

Index No.	Part Number	Nomenclature	Units Per Assy	Usable On Code								
MAC 3-10. Usable on Code												
		<table border="1" style="width: 100%; border-collapse: collapse;"> <thead> <tr> <th style="width: 25%;">Letter</th> <th style="width: 25%;">A</th> <th style="width: 25%;">B</th> <th style="width: 25%;">C</th> </tr> </thead> <tbody> <tr> <td>Serial Numbers</td> <td>Without Prefix</td> <td>Prefix 1-</td> <td>Prefix 2-</td> </tr> </tbody> </table>	Letter	A	B	C	Serial Numbers	Without Prefix	Prefix 1-	Prefix 2-		
Letter	A	B	C									
Serial Numbers	Without Prefix	Prefix 1-	Prefix 2-									
	*66564	Carburetor Assy (McCulloch Single Needle)	1	A								
1	62308A	. Plunger - Primer	1	A								
2	11086	. Spring - Plunger	1	A								
3	63037	. Seat - Primer valve	1	A								
4	63038	. Valve - Primer needle	1	A								
5	63039	. Spring - Valve	1	A								
6	101056	. "O" Ring	1	A								
7	105606	. "O" Ring	1	A								
8	62971	. Screw - Long locking adjustment	2	A								
9	104245	. Pin - Roll 0.062 x 1/2	1	A								
10	62939A	. Spring - Idle governor	1	A								
11	103934	. Screw - Rd hd 6-32 x 1/4 (SEMS)	1	A								
12	62938	. Clip - Throttle shaft	1	A								
13	62343A	. Lever - Throttle	1	A								
14	104814	. Screw - Pan hd 4-40 x 1/4 (SEMS)	1	A								
15	62290A	. Plate - Throttle	1	A								
16	62976A	. Needle - Metering	1	A								
17	62291A	. Shaft Assy - Throttle	1	A								
18	62975	. Swivel - Needle	1	A								
19	110397	. Screw - Pan hd 8-32 x 7/16 (SEMS)	5	A								
20	65597	. Plate - Carburetor base	1	A								
21	63041	. Valve - Primer	1	A								
22	67357	. Diaphragm Assy - Pump	1	A								
23	104728	. Screw - Bind hd 6-32 x 1/4	1	A								
24	110337	. Pin - Inlet lever	1	A								
25	62310	. Lever - Inlet	1	A								
26	62923A	. Spring - Lever	1	A								
27	63038	. Valve - Inlet needle	1	A								
28	55690B	. Seal - Capillary	1	A								
29	63019B	. Body Assy - Carburetor	1	A								
30	62433B	. Stud - Carburetor	1	A								
31	62295D	. Orifice - Air	1	A								
32	66569	. Orifice - Fuel	1	A								
33	62288A	. Bushing - Throttle shaft	1	A								
34	62368	. Bushing - Throttle shaft	1	A								
35	67062	. Seal - Air cleaner stud	1	A								

*Same as Carburetor Assy P/N 66503 (Figure 5) except includes Stud P/N 62433B and Primer Rod #65851.

MCCULLOCH SINGLE NEEDLE CARBURETOR ADJUSTMENT

1. Turn Lo Speed screw counterclockwise until it no longer touches stop and butterfly can be completely closed.
2. Hold finger against closed butterfly and turn Lo Mix needle clockwise until butterfly starts to open. Turn the needle counterclockwise three turns.
3. Hold finger against closed butterfly and turn Lo Speed screw clockwise until butterfly starts to open. Turn the screw one half turn more.
4. Turn the Lo Mix needle in or out (leaner or richer) to obtain a smooth rapid acceleration. Roll the engine right and left, bar up and bar down. Check for smooth idle in all positions and adjust Lo Mix needle as necessary.
5. Set tension on the idle governor spring so that the engine idles smoothly in all positions and after any change in position. If chain moves after position change, reduce tension.
6. Adjust Hi Mix screw for maximum power under load. Make sure that when trigger is released the engine does not speed up before returning to idle. Turn screw clockwise until engine slows down immediately after trigger release. **DO NOT TOUCH LO MIX NEEDLE. ADJUST FOR HIGH SPEED OPERATION WITH HI MIX SCREW ONLY.**
7. With throttle in wide open position, adjust Hi Mix screw to set butterfly in horizontal position. Now turn screw clockwise until butterfly just starts to close.
8. Set tension on idle governor spring to hold butterfly slightly open.

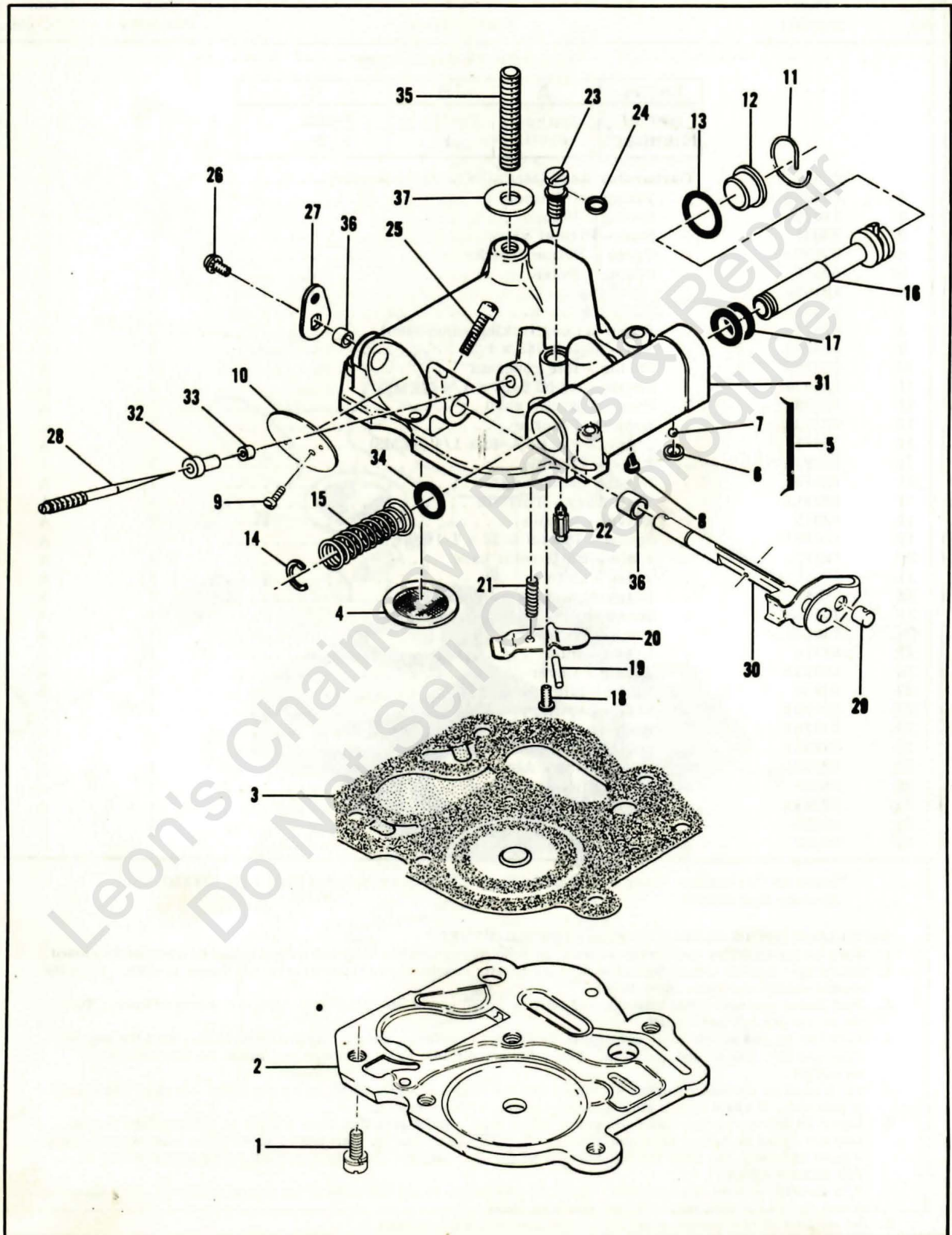

Figure 5. Carburetor

FIGURE 5. CARBURETOR ASSEMBLY

Index No.	Part Number	Nomenclature	Units Per Assy	Usable On Code								
MAC 3-10 Usable on Code												
<table border="1"> <thead> <tr> <th>Letter</th> <th>A</th> <th>B</th> <th>C</th> </tr> </thead> <tbody> <tr> <td>Serial Numbers</td> <td>Without Prefix</td> <td>Prefix 1-</td> <td>Prefix 2-</td> </tr> </tbody> </table>					Letter	A	B	C	Serial Numbers	Without Prefix	Prefix 1-	Prefix 2-
Letter	A	B	C									
Serial Numbers	Without Prefix	Prefix 1-	Prefix 2-									
	66503	Carburetor Assy (McCulloch Double Needle)	1	B,C								
1	110397	. Screw - Pan hd 8-32 x 7/16	5	B,C								
2	65597	. Plate - Carburetor base	1	B,C								
3	67357	. Diaphragm Assy - Pump	1	B,C								
4	55690B	. Seal - Capillary	1	B,C								
5	65868	. Set - Ball and seat	1	B,C								
6	66153	. Seat	1	B,C								
7	61151	. Ball	1	B,C								
8	63041	. Valve - Primer	1	B,C								
9	104814	. Screw - Pan hd 4-40 x 1/4 (SEMS)	1	B,C								
10	62290A	. Plate - Throttle	1	B,C								
11	65677	. Retainer - Primer plug	1	B,C								
12	65617	. Plug - Primer	1	B,C								
13	105617	. "O" Ring	1	B,C								
14	101289	. Ring - Retaining	1	B,C								
15	65859	. Spring - Plunger	1	B,C								
16	66552	. Plunger - Primer	1	B,C								
17	66551	. "O" Ring	2	B,C								
18	104728	. Screw - Bind hd 6-32 x 1/4	1	B,C								
19	110337	. Pin - Inlet lever	1	B,C								
20	62310	. Lever - Inlet	1	B,C								
21	62923A	. Spring - Inlet lever	1	B,C								
22	63038	. Valve - Needle	1	B,C								
23	65445	. Needle - Main fuel	1	B,C								
24	104001	. "O" Ring	1	B,C								
25	110483	. Screw - Idle adjustment	1	B,C								
26	104814	. Screw - Pan hd 4-40 x 1/4 (SEMS)	1	B,C								
27	65430	. Lever - Throttle	1	B,C								
28	65431	. Needle - Metering	1	B,C								
29	62975	. Swivel - Needle	1	B,C								
30	65428	. Shaft Assy - Throttle	1	B,C								
31	66504	. Body Assy - Carburetor	1	B,C								
32	65432	. Orifice - Air	1	B,C								
33	66569	. Orifice - Fuel	1	B,C								
34	59796	. "O" Ring	1	B,C								
35	65724	. Stud - Carburetor	1	B,C								
36	62368	. Bushing - Throttle shaft	2	B,C								
37	67062	Seal - Air cleaner stud	1	B,C								

MCCULLOCH DOUBLE NEEDLE CARBURETOR ADJUSTMENT

1. Turn Lo Speed screw counterclockwise until it no longer touches stop and butterfly can be completely closed.
2. Hold finger against closed butterfly and turn Lo Mix needle clockwise until butterfly starts to open. Turn the needle counterclockwise two and one half turns.
3. Hold finger against closed butterfly and turn Lo Speed screw clockwise until butterfly starts to open. Turn the screw clockwise one half turn more.
4. Turn Hi Mix needle clockwise until resistance is felt, then turn the needle counterclockwise two full turns.
5. Turn the Lo Mix needle to obtain smooth rapid acceleration every time without faltering. Check for smooth idle for all positions of the saw and readjust the Lo Mix needle if necessary.
6. Adjust Hi Mix needle for maximum power under load. Turn the needle in for leaner and out for richer mixture. Do not adjust the needle for leaner mixture than necessary to obtain smooth, even running under a cutting load.

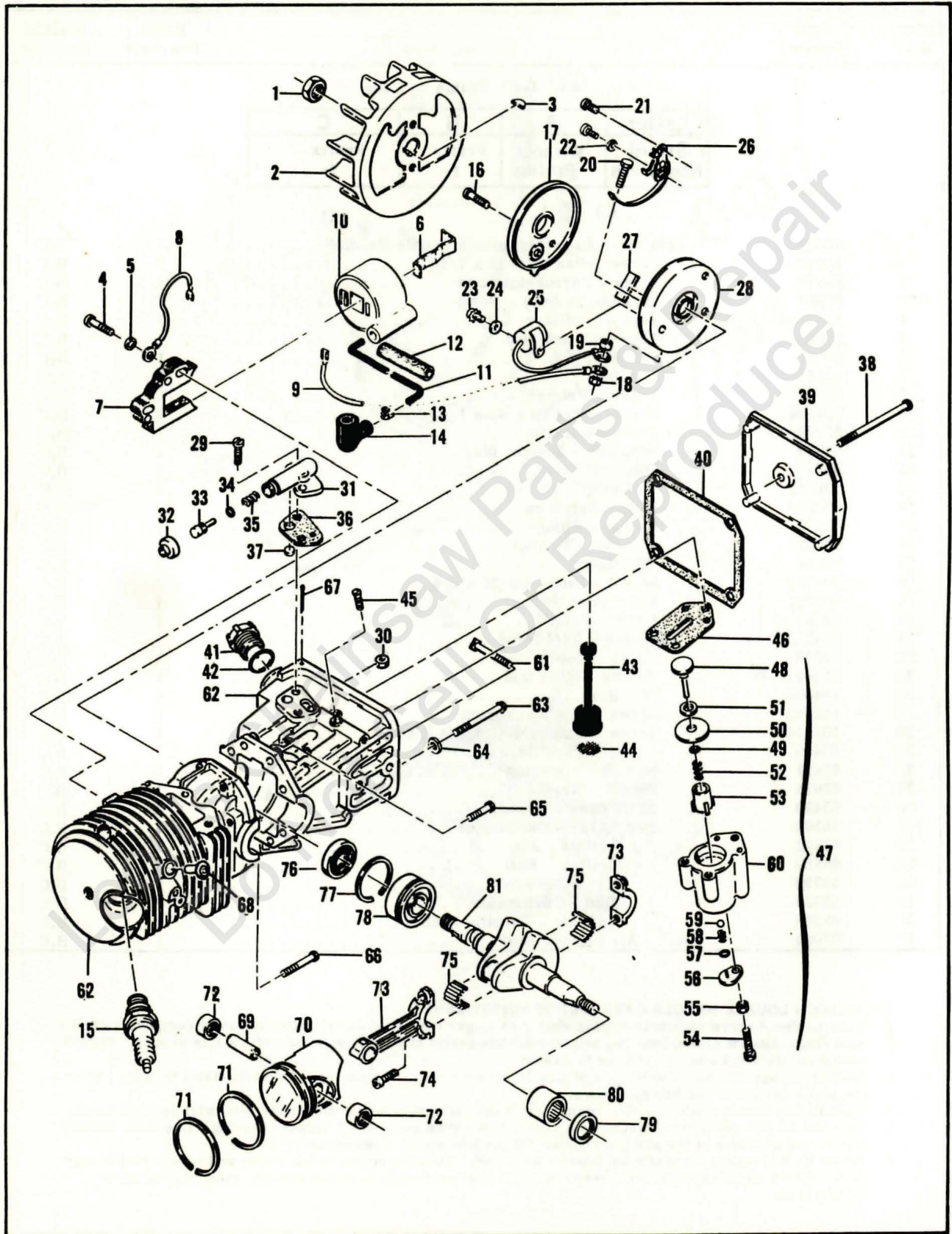

Figure 6. Powerhead Assembly

FIGURE 6. POWERHEAD ASSEMBLY

Index No.	Part Number	Nomenclature	Units Per Assy	Usable On Code								
MAC 3-10 Usable on Code												
<table border="1" style="width: 100%; border-collapse: collapse;"> <thead> <tr> <th style="width: 25%;">Letter</th> <th style="width: 25%;">A</th> <th style="width: 25%;">B</th> <th style="width: 25%;">C</th> </tr> </thead> <tbody> <tr> <td>Serial Numbers</td> <td>Without Prefix</td> <td>Prefix 1-</td> <td>Prefix 2-</td> </tr> </tbody> </table>					Letter	A	B	C	Serial Numbers	Without Prefix	Prefix 1-	Prefix 2-
Letter	A	B	C									
Serial Numbers	Without Prefix	Prefix 1-	Prefix 2-									
1	101391	Nut - Hex 3/8-24	1	All								
2	61737A	Flywheel Assy	1	All								
3	103879	Key - Woodruff	1	All								
4	101965	Screw - Fil hd 10-24 x 7/8 (SEMS)	2	All								
5	100003	Washer - #10	2	All								
6	51253	Retainer - Coil	1	All								
7	68164	Lamination Assy	1	All								
8	62819	Wire Assy - Ground	1	All								
9	69344	Wire Assy - Primary	1	All								
10	69798	Kit - Coil	1	All								
11	69966	. Wire Assy	1	All								
12	67127	. . Sleeve	1	All								
13	62932	. . Connector	1	All								
14	62926	. . Boot	1	All								
15	63097	Spark Plug	1	All								
16	110349	Screw - Rd hd 8-32 x 3/4	1	All								
17	62362	Cover - Breaker box	1	All								
18	100298	Nut - Hex 6-32	1	All								
19	62365	Spacer - Breaker screw	1	All								
20	110346	Screw - Hex hd 6-32 x 3/4	1	All								
21	100934	Screw - Rd hd 8-32 x 3/8	2	All								
22	105976	Washer - #8	1	All								
23	105249	Screw - Rd hd 8-32 x 3/8 (SEMS)	1	All								
24	100080	Washer - #8	1	All								
25	61650	Condenser	1	All								
26	62363	Breaker Assy	1	All								
27	54184	Wiper - Cam	1	All								
28	62361	Box - Breaker	1	All								
29	110623	Screw - Fil hd 8-32 x 1/2	2	All								
30	100955	Nut - Hex 8-32	1	All								
31	62261A	Housing - Oil pump	1	All								
32	62262	Cap - Oil pump	1	All								
33	62266	Plunger - Oil pump	1	All								
34	101056	"O" Ring	1	All								
35	66687	Spring - Oil pump	1	All								
36	62230	Gasket - Oil pump	1	All								
37	62909	Valve - Oil pump	1	All								
38	110291	Screw - Pan hd 10-24 x 2-5/8	1	All								
39	63072	Cover - Oil tank	1	All								
40	62116	Gasket - Cover	1	All								
41	57129A	Cap - Oil tank	1	All								
42	101148	"O" Ring	1	All								
43	62123B	Hose Assy - Oil	1	All								
44	51506	. Screen - Hose	1	All								
45	110333	Screw - Oval hd 8-32 x 1/2	3	All								
46	62274	Gasket - Pulse pump	1	All								
47	83134	Pulse Pump Assy	1	All								
48	60260A	. Piston Assy - Pump	1	All								
49	104159	. "O" Ring	1	All								
50	60263	. Ring - Piston oiler	1	All								
51	60937	. Washer - Teflon	1	All								
52	60259	. Spring-Piston	1	All								
53	62227	. Sleeve - Adjustment	1	All								
54	110386	. Screw - Hex hd 8-32 x 1	1	All								
55	100251	. Nut - Hex 8-32	1	All								

This list is continued on next page

FIGURE 6. POWERHEAD ASSEMBLY (CONTINUED)

Index No.	Part Number	Nomenclature	Units Per Assy	Usable On Code
56	62407	. Cover - Outlet valve	1	All
57	106104	. "O" Ring	1	All
58	62885A	. Spring - Valve	1	All
59	102809	. Ball - Valve	1	All
60	83128	. Body Assy - Pump	1	All
61	62065	Bolt - Bar	2	All
62	67250	Crankcase Assy	1	All
63	62105	. Screw Assy - Sealing	4	All
64	62842	. Washer - Sealing	4	All
65	110288	. Screw - Hex hd 8-32 x 3/4 (SEMS)	3	All
66	110618	. Screw - Hex hd 8-32 x 1-3/8 (SEMS)	1	All
67	100010	. Pin - Cotter 1/16 x 1/2	1	All
68	83166	. Valve - Compression release	1	All
69	61649	Pin - Piston	1	All
70	69212	Piston Assy	1	All
71	62814	. Ring Set - Piston	1	All
72	103512	. Bearing - Needle	2	All
73	65401	Connecting Rod Assy	1	All
74	61627A	. Screw - Skt hd special	2	All
75	63225	. Roller - Needle (set of 20)	1	All
76	65746	Oil Seal	1	All
77	63464	Ring - Snap	1	All
78	63429B	Bearing - Ball	1	All
79	65747	Oil Seal	1	All
80	104357	Bearing - Needle	1	All
81	63336	Crankshaft	1	All

Leon's Chainsaw Parts & Repair
Do Not Sell Or Reproduce

ACCESSORIES

Index No.	Part Number	Nomenclature	Units Per Assy	Usable On Code								
MAC 3-10 Usable on Code												
<table border="1"> <thead> <tr> <th>Letter</th> <th>A</th> <th>B</th> <th>C</th> </tr> </thead> <tbody> <tr> <td>Serial Numbers</td> <td>Without Prefix</td> <td>Prefix 1-</td> <td>Prefix 2-</td> </tr> </tbody> </table>					Letter	A	B	C	Serial Numbers	Without Prefix	Prefix 1-	Prefix 2-
Letter	A	B	C									
Serial Numbers	Without Prefix	Prefix 1-	Prefix 2-									
69210		Piston Assy - 0.020 in. oversize		All								
62813		. Ring Set - Piston 0.020 in. oversize		All								
103512		. Bearing - Needle (2)		All								
69211		Piston Assy - 0.030 in. oversize		All								
62812		. Ring Set - Piston 0.030 in. oversize		All								
103512		. Bearing - Needle (2)		All								
63432		Spark Plug - AC CS 42T		All								
65778		Spark Plug - AC CS 41T		All								
65532		Kit - Reed spark arrester		All								
65325		Baffle - Spark arrester (alternate)		All								
69058		Kit - Wrap-around frame		All								
63341A		Kit - Spike		All								
65712		Guide - Timing		All								
63746		Scrench		All								
62827		Wrench - Screwdriver		B,C								
66285		Manual - Owner's		B,C								
63084		Manual - Shop		All								

Leon's Chainsaw Parts & Repair
Do Not Sell Or Reproduce

The information contained in this Master Illustrated Parts List is based on original Illustrated Parts Lists, Engineering Records and the Master Parts Price List and is accurate to the best of our knowledge.

Each chain saw model is given a code letter. Whenever the code letter appears in the right hand column, the part is used on the engines of the model for which the code letter stands. When a part is used on all models covered in the Master Illustrated Parts List, the word "All" appears in the right-hand column instead of the code letters.

Names of parts have been checked and made to agree with the names given in the Master Parts Price List except in a very few cases where additional nomenclature was required.

The illustrations of the individual parts do not necessarily picture all the differences between parts with the same item number because the illustrations would be too complicated for use if they did. Instead, the illustration shows a representative part for each item number.



McCULLOCH



● MANUFACTURING ● SALES ● SERVICE ●

McCULLOCH CORPORATION

6101 WEST CENTURY BLVD., LOS ANGELES, CALIFORNIA 90045

INTERNATIONAL DIVISIONS:

LOS ANGELES, CALIF., P. O. BOX 45466

HONG KONG, B. C. C.: G. P. O. BOX 879

McCULLOCH OF CANADA LTD.

6338 VISCOUNT ROAD, MALTON, ONTARIO, CANADA

McCULLOCH OF EUROPE, N. V.

ANTOON SPINOYSTRAAT, 5, B-2800 MECHELEN, BELGIUM

McCULLOCH OF AUSTRALIA PTY., LTD.

P.O. BOX 223, SEVEN HILLS, N.S.W. 2147, AUSTRALIA