

GRASS TRIMMER ATTACHMENT

ASSEMBLY A-63252

INSTALLATION

NOTE: Key numbers referred to after name of part in these instructions are from the exploded view drawing of TRIMMER. Refer to your BRUSHCUTTER Owners Manual for tools and procedures required in changing blades.

Remove cotter pin. Lock spindle head from turning. Remove BRUSHCUTTER drive nut and saw blade. Pull spindle head straight off the shaft. (Don't lose the two shaft keys.)

Remove three socket head screws and pull the BRUSHCUTTER blade guard off the lower head, but DON'T SEPARATE THE TWO CASTINGS OF THE LOWER HEAD.

Remove four sets of fastening parts (key numbers 4, 5, and 6) to separate foot (3) from guard (1). Secure the guard (1) to the upper head with the socket head screws previously removed. Position the spindle head so its numbered (58076) side is toward the guard (1), align keyways with keys and slide head into position on shaft.

Be sure to install TRIMMER blade (2) so that the bent ends face toward the guard. Lock spindle head from turning and secure blade in place with BRUSHCUTTER drive nut.

Attach foot (3) to guard (1) with four flat washers (6), lockwashers (5), and screws (4). Before tightening completely, adjust for desired height of cut.

OPERATION

Operator may find it desirable to adjust position of handles and harness clamp (See Owners Manual) for proper weight distribution and unit balance when using TRIMMER attachment.

All safety precautions for use of BRUSHCUTTER apply to use of TRIMMER. All safety precautions applying to use of rotary lawnmowers and electric trimmers also apply to TRIMMER. Do not use TRIMMER without the harness. Shut engine off before you work on lower unit in any way.

Operators should wear safety goggles, leg guards or high top boots, and sturdy clothing for proper protection. The operator should caution all persons to keep a safe distance away from the TRIMMER when it is in operation.

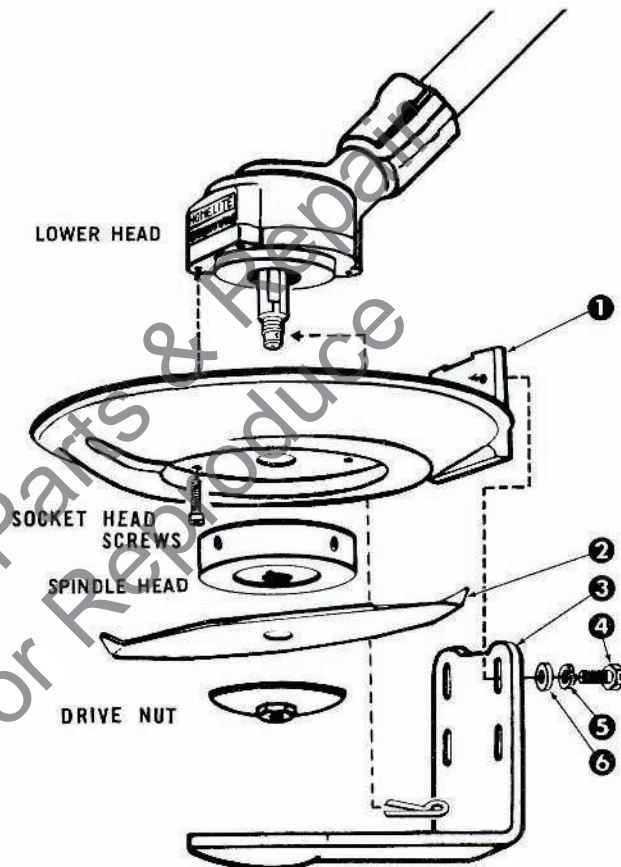

TRIMMER PARTS LIST			
Key	Part No.	Description	Qty.
1	55907-2	GUARD.....	1
2	55909-1	BLADE.....	1
3	55908-2	FOOT.....	1
4	80218-3	SCREW, 1/4 - 20x3/4.....	4
5	83009	WASHER, 1/4" lock.....	4
6	84004-1	WASHER, Flat.....	4

HOMELITE

A **Textron** DIVISION Port Chester, N. Y.