

**HOMELITE
JACOBSEN**

PART NO. 24760 REV. 2
Printed in U.S.A.

ILLUSTRATED PARTS LIST

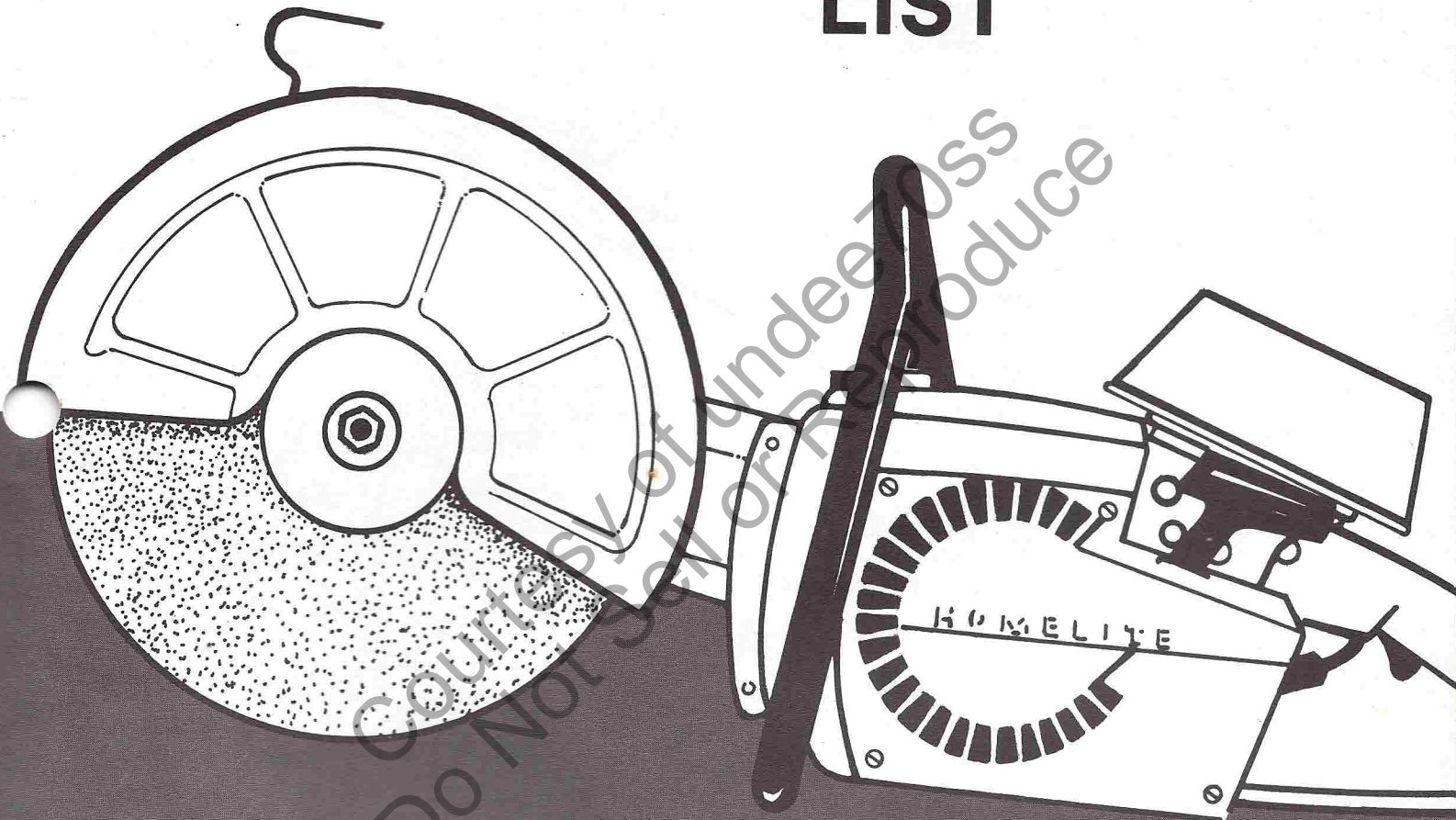

XL98-A

MULTI-PURPOSE SAW

XL98-A

FIGURE 1

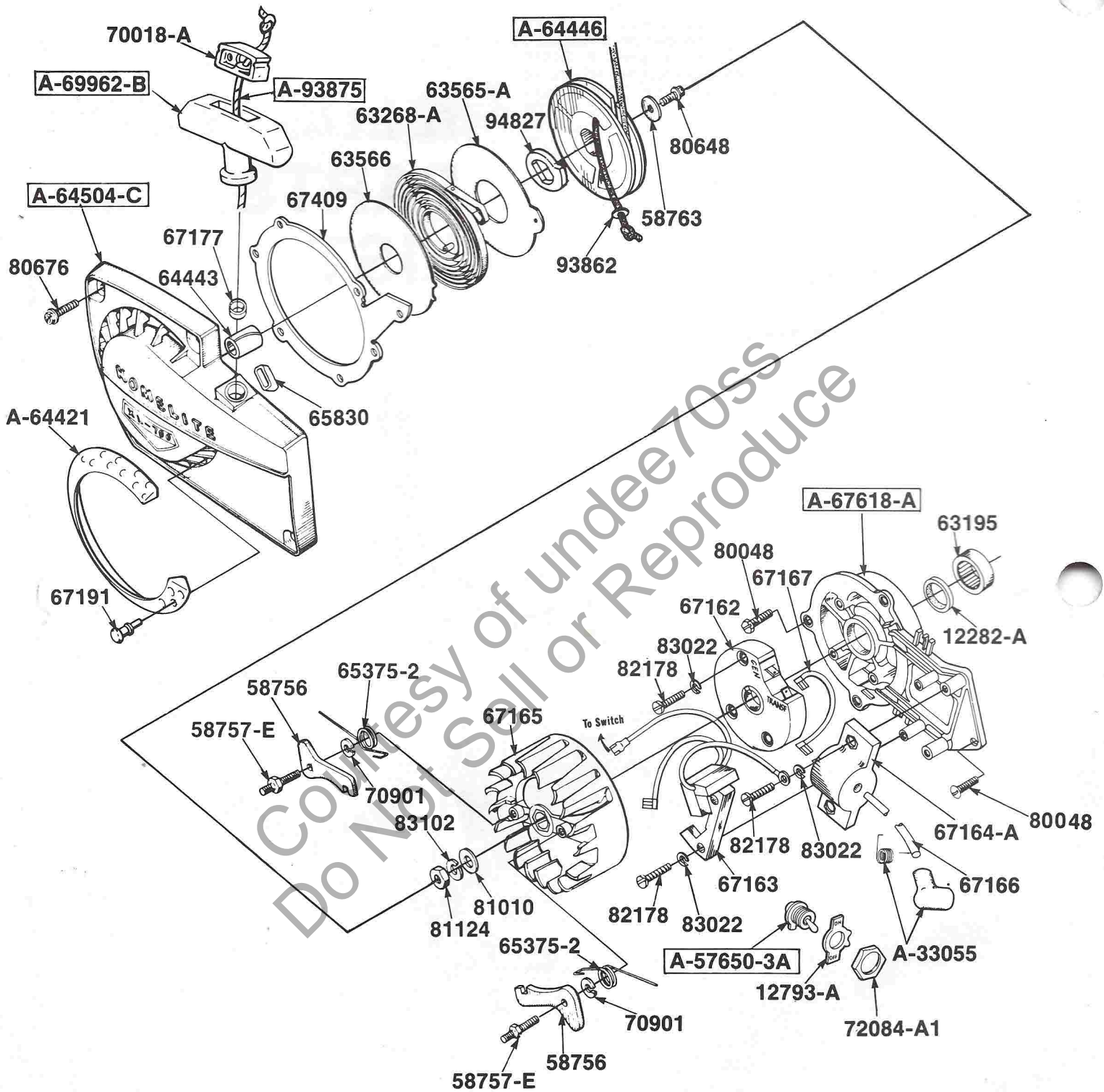

NUMBERS IN BOXES ARE ASSEMBLIES. ASSEMBLY BREAKDOWNS ARE LISTED NUMERICALLY IN THE BACK OF THE BOOK.

2 ALWAYS FURNISH MODEL AND SERIAL NUMBER WHEN ORDERING PARTS.

XL98-A FIGURE 2

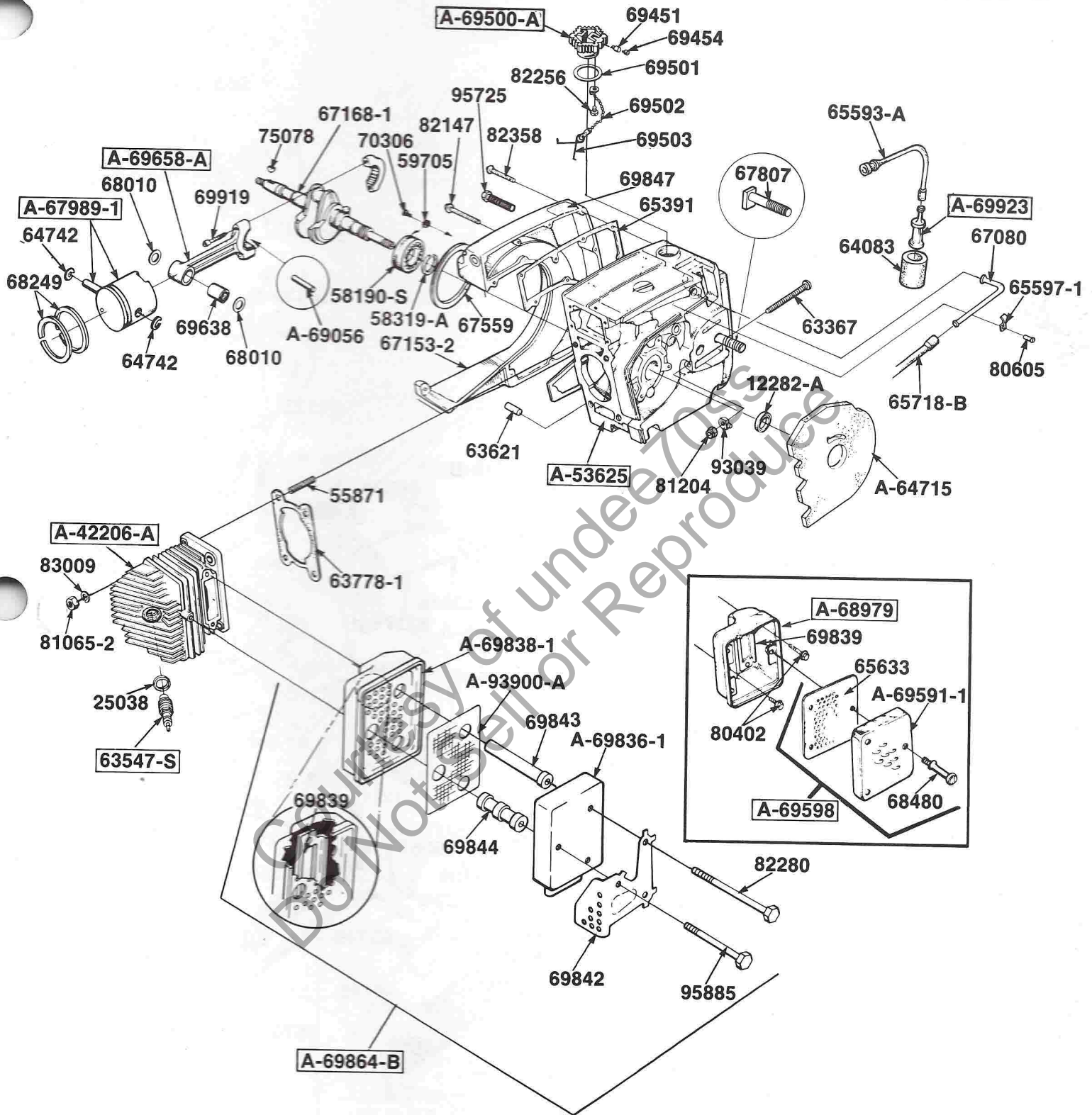

NUMBERS IN BOXES ARE ASSEMBLIES. ASSEMBLY BREAKDOWNS ARE LISTED NUMERICALLY IN THE BACK OF THE BOOK.

ALWAYS FURNISH MODEL AND SERIAL NUMBER WHEN ORDERING PARTS.

XL98-A
FIGURE 3

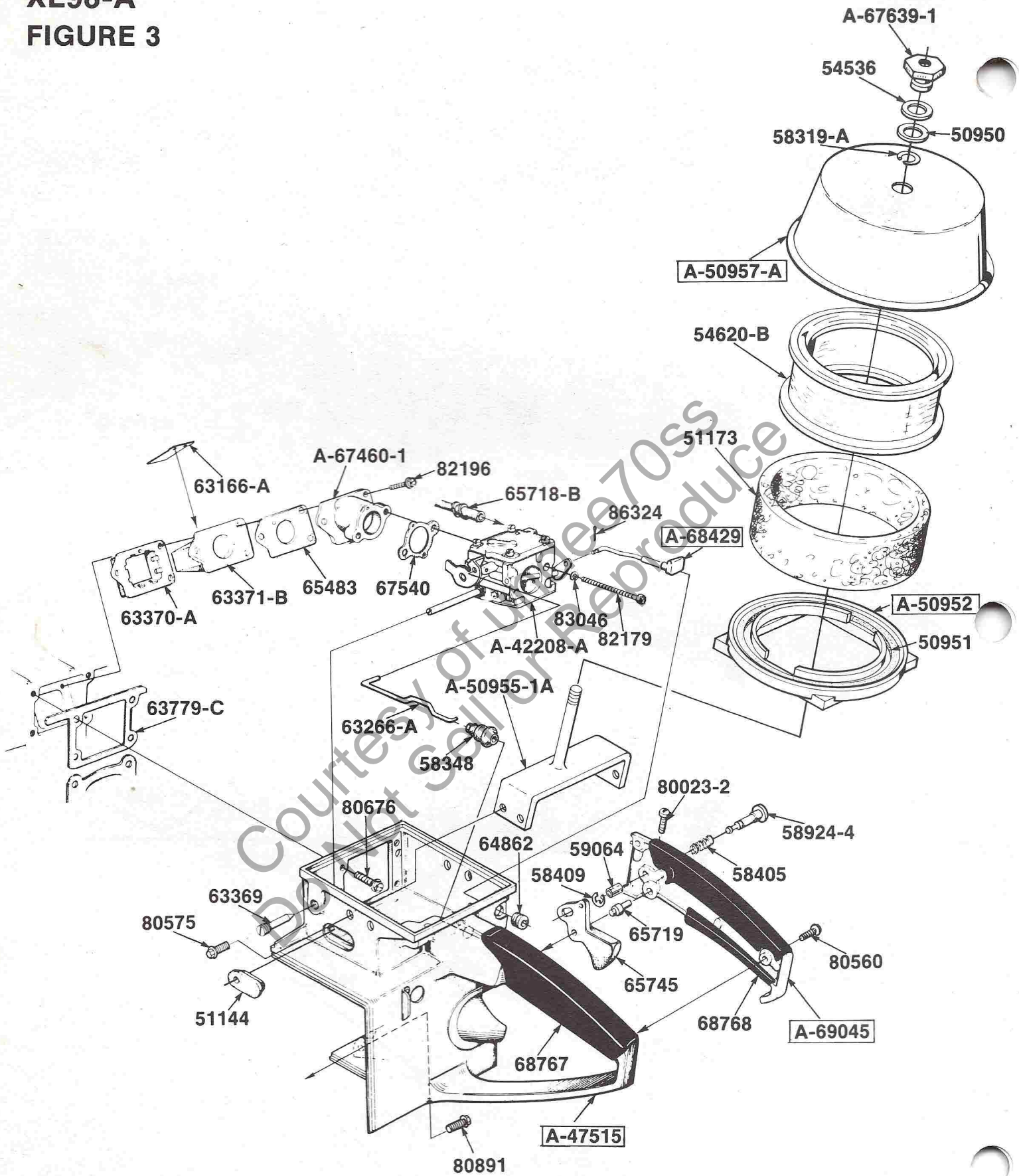

NUMBERS IN BOXES ARE ASSEMBLIES. ASSEMBLY BREAKDOWNS ARE LISTED NUMERICALLY IN THE BACK OF THE BOOK.

ALWAYS FURNISH MODEL AND SERIAL NUMBER WHEN ORDERING PARTS.

XL98-A FIGURE 4

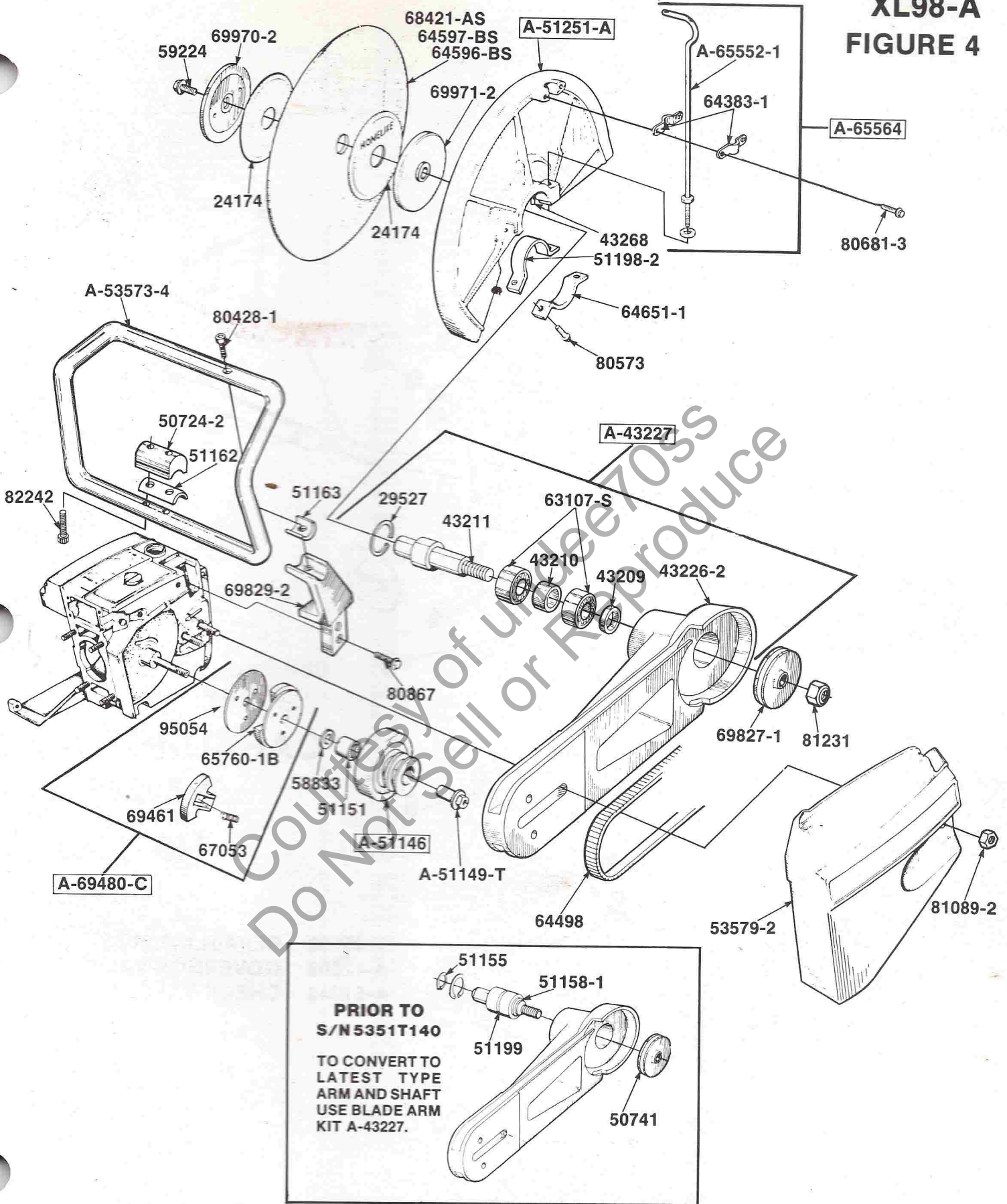

NUMBERS IN BOXES ARE ASSEMBLIES. ASSEMBLY BREAKDOWNS ARE LISTED NUMERICALLY IN THE BACK OF THE BOOK.
 ALWAYS FURNISH MODEL AND SERIAL NUMBER WHEN ORDERING PARTS.

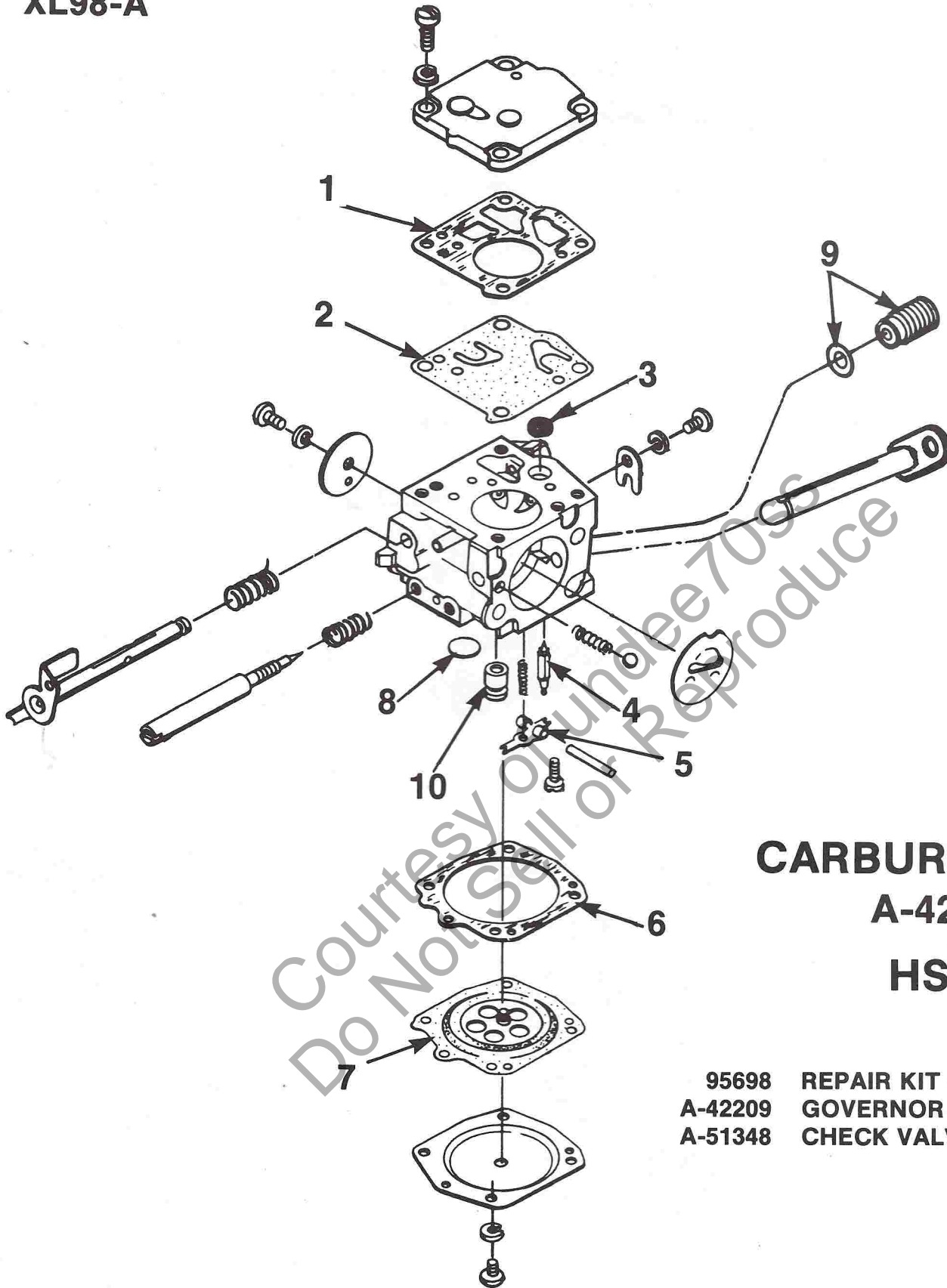

**CARBURETOR
A-42208-A
HS-135A**

- 95698 REPAIR KIT (1-8)
- A-42209 GOVERNOR VALVE (9)
- A-51348 CHECK VALVE (10)

NUMBERS IN BOXES ARE ASSEMBLIES. ASSEMBLY BREAKDOWNS ARE LISTED NUMERICALLY IN THE BACK OF THE BOOK.

NUMERICAL LISTING

PART NO.	DESCRIPTION	QTY.	PART NO.	DESCRIPTION	QTY.	PART NO.	DESCRIPTION	QTY.
12282-A	SEAL- Shaft	1	58763	WASHER- Retaining	1	69461	SHOE- Clutch	3
12793-A	PLATE- Indicating	1	58833	WASHER- Thrust (inner)	1	A-69480-C	CLUTCH	1
*22820-3	COLLAR- Bearing installation	1	58924-4	PIN- Trigger latch	1		Includes:	
*22828	PLIERS- For snap ring	1	59224	BUSHING- Latch	1	65760-1B	PLATE- Clutch	1
*23136-2	SLEEVE- Bearing and shaft installation	1	59224	BOLT- Blade	1	67053	SPRING- Clutch	1
*23420	PLUG- Bearing installation	2	59705	WASHER- Lock	1	69461	SHOE- Clutch	3
*23528	WRENCH- Hex	1	63107-S	BEARING- Ball	1	95054	COVER- Clutch	3
*23759	SLEEVE- Seal protecting	4	63166-A	REED- Valve	1	A-69500-A	CAP- Fuel filler	1
*23846-1	ANVIL- Crankshaft installation	1	63195	BEARING- Roller	1		Includes:	
*A-23934	WRENCH- Spanner	1	63266-A	ROD- Throttle	1	69451	VALVE- Check (Duckbill)	1
*23955	PLUG- Bearing installation	1	63268-A	SPRING- Rewind	1	69454	FILTER- Check (Duckbill)	1
*23956	PLUG- Bearing & seal installation	1	63367	SCREW- Guide bar adjusting	1	69501	GASKET- Fuel filler cap	1
*23957	PLUG- Seal installation	1	63369	SCREW- Idle adjustment	1	69502	CHAIN- Bead	1
*A-23962	JACKSCREW- Bearing remover	1	63370-A	RETAINER- Reed valve	1	69503	RETAINER- Filler cap	1
*23968	ANVIL- Bearing installation	1	63371-B	SEAT- Reed valve	1	82256	SCREW- Pan hd. #6-1/4	1
*23972	SLEEVE- Seal installation	1	*A-63540-D	ARRESTOR- Spark	1	69501	GASKET- Fuel filler cap	1
*24006-1	PLATE- Crankshaft aligning	1	63547-S	SPARK PLUG	1	69502	CHAIN- Bead	1
24174	SPACER- Blotter	1		Includes:		69503	RETAINER- Filler cap	1
*A-24290	PULLER- Magneto rotor	1	25038	GASKET	1	69503	CAP- Muffler	1
*24302	PLUG- Seal installation	1	63565-A	SHEILD- Spring (Outer)	1	A-69591-1	CAP- Muffler & baffle	1
*24306	SHIM- Plastic	1	63566	SHIELD- Spring (Inner)	1	A-69598	Includes:	
*A-24570	JACKSCREW	1	63621	PIN- Dowel	1	65633	BAFFLE- Muffler	1
*24823	SEALANT- 50 oz. Tubes	1	63778-1	GASKET- Cylinder	1	68480	SCREW- Shoulder	1
*24982-01	BIT- Driver-torx (.250 shank)	1	63779-C	GASKET- Throttle handle	1	A-69591-1	CAP- Muffler	3
*24982-02	BIT- Driver-torx (.312 shank)	1	64083	FILTER- Fuel	1	69638	BEARING- Needle	1
25038	GASKET	2	64383-1	CLAMP	1	A-69658-A	ROD- Connecting	1
25039	RING- Retaining	1	A-64421	KIT- Fan housing screen	1		Includes:	
29527	TERMINAL- High tension lead	1	64443	BUSHING- Starter post (Nylon)	1	69919	SCREW- Cap hex sock. hd.	1
A-33055	CYLINDER	1	A-64445	PULLEY	1		8-32 x 1/2	2
A-42206-A	Includes:			Includes:		69638	BEARING- Needle	1
63778-1	GASKET- Cylinder	1	94827	LOCK- Spring	1	69827-1	PULLEY- Driven	1
A-42208-A	CARBURETOR- HS-135A	1	64488	BELT- Drive	1	69829-2	BRACKET- Handle bar	1
A-42209	VALVE- Governor	1	A-64504-C	HOUSING- Starter	1	A-69836-1	CAP- Muffler	1
43209	SPACER- Pulley	1		Includes:		A-69838-1	BODY- Muffler	1
43210	SPACER- Inner	1	A-64421	SCREEN- Fan housing	1	69839	PLATE- Muffler body	1
43211	SHAFT- Blade	1	64443	BUSHING	1	69842	SHIELD- Muffler	1
43226-2	ARM- Blade	1	65830	BUSHING- Starter post	1	69843	SUPPORT- Muffler (Long)	1
A-43227	KIT- Blade arm	1	67177	BUSHING- Starting rope	1	69844	SUPPORT- Muffler (Short)	1
	Includes:		67191	STUD- Drive	1	69847	LABEL- Warning	1
29527	RING- Retaining	1	*54595-S	BLADE- Saw	1	A-69864-B	MUFFLER (Complete)	1
43209	SPACER- Pulley	1	*54596-BS	WHEEL- Resinoid (Masonry & Concrete)	1		Includes:	
43210	SPACER- Inner	1	*54597-BS	WHEEL- Resinoid	1	A-69836-1	CAP- Muffler	1
43211	SHAFT- Blade	1	64851-1	CLAMP	1	A-69838-1	BODY- Muffler	1
43226-2	ARM- Blade	1	*54598	GOGGLES- Safety	1	69839	PLATE- Muffler body	1
63107-S	BEARING- Ball	1	*54599	CAN- Fuel safety	1	69842	SHIELD- Muffler	1
43268	PIN- Spirol	1	A-64715	SHIELD- Sawdust	2	69843	SUPPORT- Muffler (Long)	2
*A-47306	KIT- Emergency	1	64742	RING- Piston pin retaining	1	69844	SUPPORT- Muffler (Short)	1
A-47515	HANDLE- Throttle	2	64862	GROMMET	1	82280	SCREW- Hex hd. cap 1/4-20 x 3"	2
	Includes:		65375-2	SPRING- Starter pawl	1	A-99900-A	ARRESTOR- Spark	1
12793-A	PLATE- Indicating	1	65391	GASKET- Fuel tank	1	95885	SCREW- Cap hex hd.	1
*A-50561	KIT- Wet cutting	1	65483	GASKET- Reed valve seat	1	69919	SCREW- Cap hex soc. hd.	1
50724-2	SPACER- Handle bar	1	A-85552-1	BOLT- Hook	1		8-32 x 1/2 (Connecting rod)	2
50741	PULLEY- Driver (Note #1)	1	A-85564	KIT- Hook bolt & clamps	1	A-69923	FILTER- Fuel	1
50950	WASHER	1		Includes:			Includes:	
50951	GASKET- Air filter	2	64383-1	CLAMP	1	64083	FILTER- Fuel	1
A-50952	RING AIR FILTER MTG. & GASKET	2	A-85552-1	BOLT- Hook	1	A-69962-B	GRIP- Starter (w/insert)	1
	Includes:		65593-A	LINE- Valve	1		Includes:	
50951	GASKET- Air filter	1	65597-1	CLAMP- Fuel line	1	70018-A	INSERT- Rope retaining	1
A-50955-1A	BRACKET- Cover mounting	1	65633	BAFFLE- Muffler	1	69970-2	WASHER- Outer	1
A-50957-A	COVER- Air filter	1	65718-B	LINE- Fuel	1	69971-2	WASHER- Inner	1
	Includes:		65719	PIN- Trigger latch	1	70018-A	INSERT- Rope retaining	1
50951	GASKET- Air filter	1	65745	TRIGGER- Throttle	1	70306	SCREW- Torx 10-32	2
51144	GROMMET- (LO)	1	65790-1B	PLATE- Back clutch	1	70801	WASHER- Lock	2
A-51146	PULLEY- Bearing & drum	1	65830	BUSHING- Rewind spring	1	72084-A1	NUT- Toggle switch	1
	Includes:		67053	SPRING- Clutch	1	75078	KEY- Woodruff	1
51151	BEARING- Needle	1	67060	CONNECTOR- Fuel line	1	80023-2	SCREW- Fil hd. (8-32 x 5/8)	1
A-51149-T	RACE- Inner flanged	1	67153-2	COVER- Fuel tank	1	80048	SCREW- 1/4-20 x 5/8	3
51151	BEARING- Needle	1	67162	MODULE- Ignition	1	80402	SCREW- Hex cap 1/4-20 x 5/8	1
51155	RING- Retaining (Note #1)	1	67169	COIL & CORE GENERATOR	1	80428-1	SCREW- Soc hd. 1/4-20 x 1	3
51158-1	SHAFT- Blade w/bearing	1	67244	COIL- Transformer "CD"	1	80560	SCREW- 8-32 x 1/2	2
51162	SPACER- Shock mount	1	67256	ROTOR- Magneto	1	80573	SCREW- Hex, Spinlock	1
51163	BRACKET- Shock mount	1	67267	LEAD- High tension	1		1/4-20 x 13/16	4
51173	FILTER- Element air	1	67267	LEAD- Transformer	1	80575	SCREW- 8-32 x 1/4 Pan hd.	1
51198-2	SLEEVE- Blade guard	1	67268-1	CRANKSHAFT	1	80605	SCREW- Pan hd. 8-32 x 5/16	1
51199	RING- Retaining (Note #1)	1	67273	BUSHING- Starting rope	1	80648	SCREW- 10-32 x 1/2	1
A-51251-A	GUARD BLADE & SLEEVE	1	67293	STUD- Drive	1	80676	SCREW- 12-24 x 5/8	1
	Includes:		67298	RING- Air Flow (Note #1)	1	80681-3	SCREW- Hex, Spinlock	8
43268	PIN- Spirol	1	A-67460-1	MANIFOLD- Intake	1		1/4-20 x 1/2	2
51198-2	SLEEVE- Blade guard	1	67540	GASKET- Carburetor (Inlet) flange	1	80867	SCREW- Hex hd. 12-24 x 3/4	2
A-51348	VALVE- Check	1	67559	"O" RING- Crankcase	1	80891	SCREW- Hex hd. 12-24 x 7/8	1
A-53573-4	HANDLE BAR	1	A-67561-A	PLATE- Back (Magneto)	1	81065-2	NUT- Hex 1/4-28	1
53579-2	COVER- Drivecase	1		Includes:		81089-2	NUT- 3/8-16, 5/16 steel	4
A-53625	CRANKCASE	1	12282-A	SEAL- Shaft	1	81124	NUT- Hex 3/8-24	2
	Includes:		63195	BEARING- Roller	1	81204	NUT- Reversible lock (1/4-20)	1
12282-A	SEAL- Shaft	1	A-67638-1	NUT- Cover mounting	1	81231	NUT- Elastic Stop 7/16-14	1
55871	STUD- Cylinder	1	67807	BOLT- Guide bar	4	82147	SCREW- Fil hd. 8-32 x 1 3/4	1
63621	PIN- Dowel	1	A-67985-1	PISTON & PIN	1	82178	SCREW- Pan hd. 8-32 x 3/4	1
A-64715	SHIELD- Sawdust	1		Includes:		82179	SCREW- Hex hd. 10-32 x 1 7/8	5
65391	GASKET- Fuel tank	2	64742	RING- Piston Pin retaining	1	82196	SCREW- Pan hd. 8-32 x 1 1/8	2
67153-2	COVER- Fuel tank	2	68249	PISTON RING	1	82242	SCREW- Soc hd. cap	3
67807	BOLT- Guide bar	2	68010	WASHER- Thrust (piston)	1		1/4-20 x 1 7/8 Nylock	2
82358	SCREW- Tap fil hd. 8-32 x .625	2	68249	PISTON RING	6	82256	SCREW- Pan hd. #6 x 1/4	2
82147	SCREW- Tap fil hd. 8-32 x 1 3/4	1	*58421-AS	WHEEL- Resinoid	1	82280	SCREW- Hex hd. cap 1/4-20 x 3"	1
95725	SCREW- Tap fil hd. 8-32 x 2 3/16	1	A-68429	ROD- Choke	8	82358	SCREW- Tap fil hd. 8-32 x .625	2
54536	WASHER- Air filter element	1		Includes:		83009	WASHER- Lock 1/4	6
54620-B	FILTER ELEMENT- Air	1	64862	GROMMET	1	83022	WASHER- Lock #8	4
55871	STUD	3	68480	SCREW- Shoulder	1	83046	WASHER- Lock 3/8	7
*57084-1	ROPE- Starting (250 ft.) #5	1	68767	GRIP- Throttle handle	4	83102	WASHER- Flat 3/8	1
A-57650-3A	SWITCH- Toggle	1	68768	GRIP- Throttle handle cover	1	84010	PIN- Cotter	1
	Includes:		A-68979	BODY- Muffler	1	86324	PIN- Guide bar adjusting	1
72084-A1	NUT- Toggle switch	1		Includes:		93039	WASHER- Flat (Nylon)	1
58190-S	BEARING- Ball	1	69839	PLATE- Muffler body	1	93862	ROPE- Starter 48" long	1
58319-A	RING- Retaining	1	A-69045	COVER- Throttle handle	2	A-93875	250 ft. reel, #5 Nylon	1
58348	BOOT- Throttle rod	1		Includes:		93862	WASHER- Flat	1
58405	SPRING- Lock throttle	1	59064	BUSHING- Latch	1	*A-93900-A	ARRESTOR- Spark	1
58409	RING- Retaining	1	A-69056	BEARING- Needle (28)	1	94827	LOCK- Spring	1
58756	PAWL- Starter	1	69451	VALVE- Check (Duckbill)	1	95054	COVER- Clutch	1
58757-E	STUD- Pawl	1	69454	FILTER- Filler cap	2	95698	KIT- Repair	1
						95725	SCREW- Tap fil. hd.	1
							8-32 x 2 3/16	8
						95885	SCREW- Cap hex hd.	1

***ACCESSORIES AND TOOLS**

NUMBERS IN BOXES ARE ASSEMBLIES. ASSEMBLY BREAKDOWNS ARE LISTED NUMERICALLY IN THE BACK OF THE BOOK. ALWAYS FURNISH MODEL AND SERIAL NUMBER WHEN ORDERING PARTS.

ACCESSORIES

KIT- Emergency
WHEEL- Masonry
WHEEL- Metal
WHEEL- Resinoid
BLADE- Saw
REEL- Starter rope (250 ft.) #5
KIT- Wet cutting
Arrestor- Spark
Arrestor- Spark (Do not use with A-69864-B)

A-47306
64596-BS
64597-BS
68421-AS
64595-S
57084-1
A-50561
A-93900-A
A-63540-D

TOOLS

SEALANT	24823
ANVIL- Bearing installation	23968
ANVIL- Crankshaft installation	23846-1
COLLAR- Bearing installation	22820-3
JACKSCREW ASSEMBLY	A-24570
JACKSCREW- Bearing remover (back plate)	A-23962
PLATE- Crankshaft aligning	24006-1
PLIERS- Retaining ring (piston pin)	22828
PLUG- Bearing installation	23420
PLUG- Bearing and seal installation (back plate)	23956
PLUG- Bearing installation (connecting rod)	23955
PLUG- Seal installation (crankcase)	23957
PLUG- Seal installation	24302
PULLER- Magneto rotor	A-24290
SHIM- Plastic (black)	24306
SLEEVE- Bearing & shaft installation	23136-2
SLEEVE- Seal installation (crankcase only)	23972
SLEEVE- Seal protecting (crankcase)	23759
SPANNER WRENCH ASSEMBLY	A-23934
WRENCH- Socket screw (connecting rod)	23528
BIT- Torx driver	24982-01 or 24982-02

HOMELITE®

CONSTRUCTION & INDUSTRIAL EQUIPMENT

14401 Carowinds Blvd. • P.O. Box 7047 • Charlotte North Carolina 28217

HOMELITE **TEXTRON**

Homelite Division of Textron Inc.