

HOMELITE

XL

Chain Saws



XL AUTOMATIC

GEAR DRIVE

XL AUTOMATIC

DIRECT DRIVE

**SUPER
XL**

PARTS LIST

Leon's Chainsaw Parts & Repair
Do Not Sell or Reproduce

HOMELITE XL CHAIN SAWS

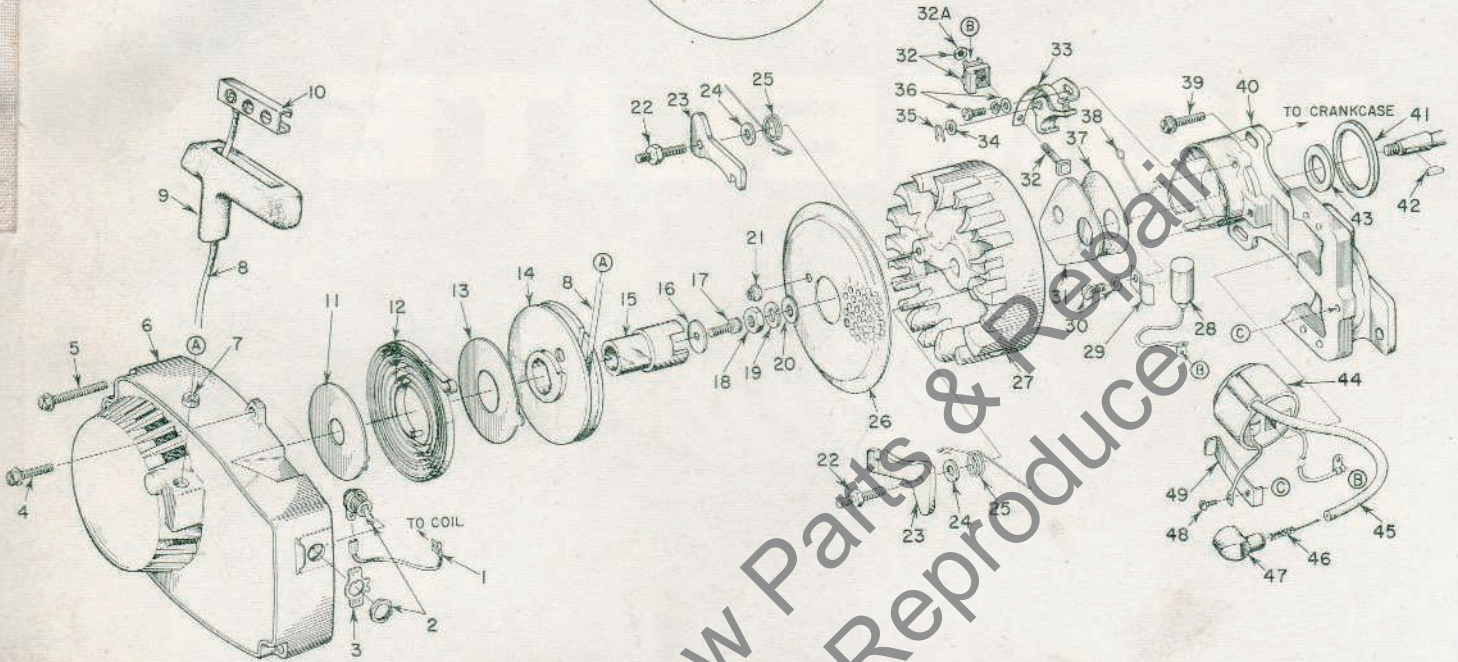
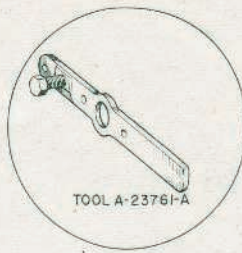

FIGURE 1

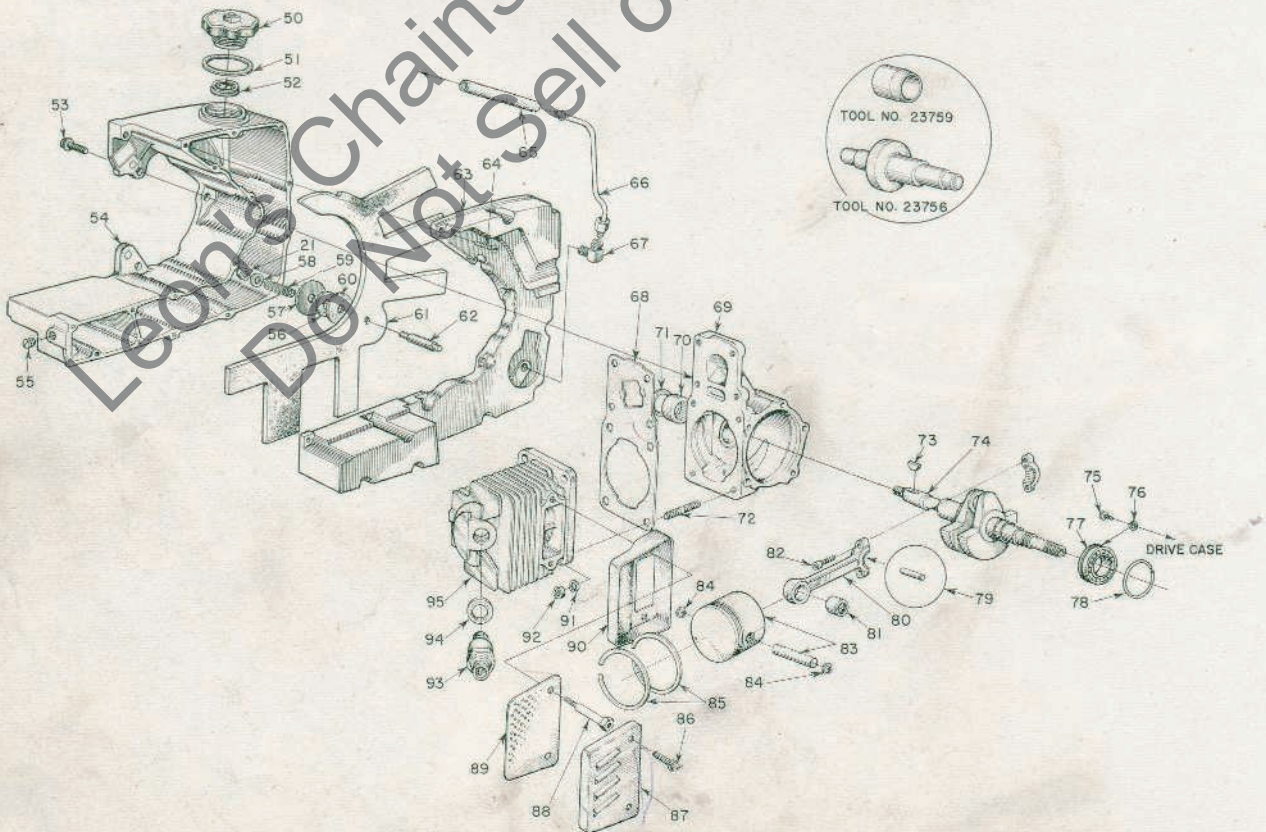

FIGURE 2

ALWAYS FURNISH MODEL AND SERIAL NUMBER WHEN ORDERING PARTS.

HOMELITE XL CHAIN SAWS

Parts used in each model are indicated by an asterisk (*) in the corresponding model column; a dagger (†) indicates an optional part available from your dealer.

No.	Description	Part No.	Automatic		Dir. Super XL	Qty.
			Direct XL	Gear XL		
1	LEAD - ground w/term.	A-59031	*	*	*	1
2	SWITCH - w/nut	A-57650-3	*	*	*	1
3	PLATE - "ON - OFF"	72085-A	*	*	*	1
4	SCREW - hex, 12-24 x 5/8	80676	*	*	*	1
5	SCREW - hex, 12-24 x 1 11/16	58963	*	*	*	3
6	FAN HOUSING	A-59824	*	*	*	1
7	Includes: BUSHING - rope	59313	*	*	*	1
8	ROPE - starter	58806	*	*	*	1
9	GRIP - rope	58915	*	*	*	1
10	INSERT	58847	*	*	*	1
11	SHIELD - spring (inner)	59638-A	*	*	*	1
12	SPRING - recoil	58764	*	*	*	1
13	SHIELD - spring (outer)	59639-A	*	*	*	1
14	PULLEY - starter	58759-A	*	*	*	1
15	CUP - starter	58760	*	*	*	1
16	WASHER - retaining	58763	*	*	*	1
17	SCREW - socket, 10-32 x 1/2	80492	*	*	*	1
18	NUT -hex, 5/16-24	81117	*	*	*	1
19	WASHER - lock, 5/16	83002	*	*	*	1
20	WASHER - flat, 5/16	84056	*	*	*	1
21	NUT - lock, 10-32	81109	*	*	*	3
22	STUD - shoulder	58757	*	*	*	2
23	FINGER - starter	58756	*	*	*	2
24	WASHER	58851	*	*	*	2
25	SPRING - starter finger	58758	*	*	*	2
26	SCREEN - starter	58765	*	*	*	1
27	ROTOR - magneto	58809	*	*	*	1
		59857	*	*	*	1
28	CONDENSER	58817	*	*	*	1
	w/clamp	59862	*	*	*	1
29	CLAMP - condenser	59622	*	*	*	1
30	SCREW GROUP - condenser		*	*	*	1
		3026	*	*	*	1
		57750	*	*	*	1
31	COVER - breaker box	58811	*	*	*	1
		58864	*	*	*	1
32	TERMINAL BLOCK GROUP		*	*	*	1
		A-58934	*	*	*	1
32A	NUT (only) - terminal	55982	*	*	*	1
33	POINT SET - w/felt	A-58944	*	*	*	1
34	Includes: WASHER - point		*	*	*	1
		28028	*	*	*	1
35	CLIP - post	28008	*	*	*	1
33	POINT SET w/felt and terminal block	A-59861	*	*	*	1
36	SCREW GROUP - points		*	*	*	1
		70421	*	*	*	1
		57749	*	*	*	1
37	GASKET - cover	58810	*	*	*	1
		59865	*	*	*	1
38	SPRING - cover (clip)	76413	*	*	*	1
		59866	*	*	*	1
39	SCREW - hex, 12-24 x 9/16	80899	*	*	*	3
40	PLATE & CORE	58875-A	*	*	*	1
		59859	*	*	*	1
41	GASKET	59538	*	*	*	1
42	KEY - rotor	75078	*	*	*	1
43	SEAL - felt	59760	*	*	*	1
44	COIL	58874	*	*	*	1
		59860	*	*	*	1

No.	Description	Part No.	Automatic		Dir. Super XL	Qty.
			Direct XL	Gear XL		
45	LEAD - hi-tension	58966	*	*	*	1
46	SPRING - contact	58919	*	*	*	1
47	BOOT - spark plug	58918	*	*	*	1
48	SCREW - coil clip	58872	*	*	*	1
		55977	*	*	*	1
49	CLIP - coil retaining	58873	*	*	*	1
		59863	*	*	*	1
50	CAP - fuel filter	A-59956	*	*	*	1
51	Includes: GASKET	58957	*	*	*	1
52	VALVE	80865	*	*	*	1
53	SCREW - hex, 12-24 x 3/4	80867	*	*	*	3
54	TANK - fuel	58732	*	*	*	1
55	PLUG - pipe, 1/16-27	59571	*	*	*	1
56	GASKET	58865	*	*	*	1
57	WASHER - wick	58866	*	*	*	1
58	WASHER - flat, #10	84003-1	*	*	*	1
59	SPRING - compression	58867	*	*	*	1
60	WASHER - felt	59457	*	*	*	1
61	WICK - fuel pick-up	58862	*	*	*	1
62	STUD - wick	58519	*	*	*	1
63	COVER - tank	59693	*	*	*	1
64	SCREW - rd., #6 x 1/2	80513	*	*	*	16
65	LINE - fuel, flexible	59828	*	*	*	1
66	LINE - fuel, formed	A-59814	*	*	*	1
67	ELBOW - fuel line	58995	*	*	*	1
68	GASKET	59771	*	*	*	1
69	CRANKCASE	A-58799	*	*	*	1
70	Includes: BEARING	58956	*	*	*	1
71	SEAL	58688-A	*	*	*	1
72	STUD	55871	*	*	*	4
73	KEY - rotor	75078	*	*	*	1
74	CRANKSHAFT	59272	*	*	*	1
75	SCREW - bearing retaining	59704	*	*	*	2
76	WASHER - lock	59705	*	*	*	2
77	BEARING - ball	58190-S	*	*	*	1
78	RING - retaining	59319-A	*	*	*	1
79	ROLLERS - set (23)	A-58864	*	*	*	1
80	CONNECTING ROD	A-58769	*	*	*	1
81	Includes: BEARING	58724	*	*	*	1
82	SCREW - socket, 8-36 x 1/2	80889	*	*	*	2
83	PISTON & PIN	A-59468	*	*	*	1
84	Includes: RING - retaining	75120	*	*	*	2
85	PISTON RING	59436	*	*	*	2
86	SCREW - hex, 10-32 x 9/16	80825	*	*	*	2
87	CAP - muffler	59051	*	*	*	1
88	STUD	59891	*	*	*	2
89	BAFFLE	59050	*	*	*	1
90	BODY - muffler	A-59895	*	*	*	1
91	WASHER - lock, 1/4	83009	*	*	*	4
92	NUT - 1/4-28	81065-2	*	*	*	4
93	SPARK PLUG	58917-S	*	*	*	1
	optional - platinum	59558-S	†	†	†	1
94	Include: GASKET	25038	*	*	*	1
95	CYLINDER	58706-A1	*	*	*	1

HOMELITE XL CHAIN SAWS

Parts used in each model are indicated by an asterisk (*) in the corresponding model column; a dagger (†) indicates an optional part available from your dealer.

No.	Description	Part No.	Automatic		Dir. Super XL	Qty.
			Direct XL	Gear XL		
1	GASKET - spacer	59274	*	*	*	2
2	SPACER	59718	*	*	*	1
3	SEAT - reed valve	59677	*	*	*	1
4	VALVE - reed	59725-A	*	*	*	4
5	SPRING - valve	59679	*	*	*	4
6	SCREW - pan, 4-40 x 1/8	80918	*	*	*	8
7	LINE - fuel (flexible)	59828	*	*	*	1
8	GASKET - carburetor	59722	*	*	*	1
9	CARBURETOR - See Note	A-58767-B	*	*	*	1
10	HOUSING & HANDLE	A-59931	*	*	*	1
11	Includes: GASKET (not shown) COTTER PIN	58884 86301	*	*	*	1
12	COTTER PIN	86324	*	*	*	1
13	PLATE - instruction	59024	*	*	*	1
14	COVER - air filter	58773	*	*	*	1
15	NUT - cover	A-58882	*	*	*	1
16	RING - retaining	58319-A	*	*	*	1
17	FILTER ELEMENT	58774-1	*	*	*	1
18	GASKET - mounting stud	58392-1	*	*	*	1
19	BRACKET - mounting	A-59822	*	*	*	1
20	ROD - choke	A-59826	*	*	*	1
21	ROD - throttle	59763	*	*	*	1
22	SCREW - hex, 12-24 x 7/8	80891	*	*	*	5
23	SCREW - idle. See Note	59916	*	*	*	1
24	BOOT - throttle rod	58348	*	*	*	1
25	WASHER - lock, #10	83046	*	*	*	2
26	SCREW - hex, 10-32 x 2 11/16	80921	*	*	*	2
27	PIN - throttle lock	58924	*	*	*	1
28	SPRING - lock	58405	*	*	*	1
29	COVER - handle Includes: BUSHING - pin	A-59213 59064	*	*	*	1
30	SCREW - pan, 8-32 x 1/2	80560	*	*	*	2
31	RING - retaining	58409	*	*	*	1
32	THROTTLE - trigger	58859	*	*	*	1
33	GROMMET	58362	*	*	*	1
34	BUTTON	57289-1	*	*	*	1
35	VALVE - check "IN"	A-59818	*	*	*	1
36	VALVE - check "OUT", 90°	A-59011	*	*	*	1
37	GROMMET	59770	*	*	*	1
38	PLUG	59798	*	*	*	1
39	GASKET	59799	*	*	*	1
40	SPRING - plunger	59293	*	*	*	1

No.	Description	Part No.	Automatic		Dir. Super XL	Qty.
			Direct XL	Gear XL		
41	"O" RING - plunger shaft	59074	†	†	*	1
42	PLUNGER - oil pump	A-57834-8	†	†	*	1
43	Includes: "O" RING - plunger	74388	†	†	*	1
44	TUBE - oil line	59325	*	*	*	1
45	"O" RING	59765	*	*	*	2
46	LINE - oil	59674	*	*	*	1
47	FILTER - oil	A-58828	*	*	*	1
48	SCREW - rd, #6 x 1/2	80513	*	*	*	9
49	COVER - oil reservoir	59649	*	*	*	1
50	GASKET - cover	59710	*	*	*	1
51	"O" RING	58785	*	*	*	1
52	LINE - oil (discharge)	A-59806	*	*	*	1
53	CAP - filler	A-56590-1	*	*	*	1
54	Includes: GASKET	56607	*	*	*	1
55	DRIVECASE - A. O. Models Super XL	A-59930 A-59951	*	*	*	1
56	Includes: STUD - guide bar	58764-A	*	*	*	2
57	INSERT - threaded	59896	*	*	*	2
58	SEAL	58308	*	*	*	1
59	COTTER PIN	86301	*	*	*	1
60	PLUG - expansion	59930	*	*	*	1
61	SCREW - pin, 1/4-20 x 2	80684	*	*	*	1
62	PIN - bar adjusting	58783	*	*	*	1
63	NUT - lock, 1/4-20	83108	*	*	*	1
64	SCREW - hex, 12-24 x 1	80864	*	*	*	1
65	SCREW - cam	59737	*	*	*	1
66	GASKET	59736	*	*	*	1
67	"O" RING	90872	*	*	*	2
68	SEAL - felt	59926	*	*	*	1
69	GEAR - worm	59675	*	*	*	1
70	SCREW - pan, 6-32 x 3/4	80920	*	*	*	3
71	HOUSING - oil pump	A-59810	*	*	*	1
72	PLUNGER & GEAR	59689	*	*	*	1
73	BEARING - flanged	59719	*	*	*	1
74	SCREW - pan, 4-40 x 1/4	80919	*	*	*	2
75	SPACER	59848	*	*	*	1
76	SCREW - hex, 12-24 x 9/16	80899	*	*	*	4
77	FILTER - oil	A-59009	*	*	*	1
78	CONNECTOR	59937	*	*	*	1
79	FILTER - oil w/connector	A-59804	*	*	*	1
80	LINE - oil (intake)	A-59819	*	*	*	1
81	Includes: GROMMET	59794	*	*	*	1

NOTE: Service replacement carburetor #A-58767-B supplied with idle stop screw and spring (used in units with internal adjustment); remove these parts, use external adjustment screw (Index #23).

Refer to Carburetor Parts List #23766-B.
Use Repair Parts Kit #58972, Gasket Set #58971.

SPECIAL TOOLS (available on order)

Part No.	Description
22808	COMBINATION WRENCH
22828	PLIERS - piston snap ring
23528	WRENCH - socket screw (conn. rod)
#23756	BEARING ASSEMBLY AND DISASSEMBLY - conn. rod
#23757	BEARING ASSEMBLY AND DISASSEMBLY - drive and crank cases
23819	PLUG - needle bearing (sprocket)
-----	BEARING PULLER - clutch drum (#A-78 Snap-On or equivalent)
#23758	SEAL ASSEMBLY - drive and crank cases
#23759	SLEEVE - crankshaft assembly
#23760	BEARING ASSEMBLY AND DISASSEMBLY - sprocket drum
#A-23761-A	REMOVER AND LOCKING BRACKET - rotor
A-23696	REMOVER - threaded spider
#23773	BEARING ASSEMBLY - clutch drum

Part No.	Description
23800	TOOL - seal assembly (crank and drive cases)
A-23858	TOOL - crankcase to drive case assembly
23844	SLEEVE - crankcase assembly
23843	SLEEVE - drivecase assembly
23845	PLUG - drivecase assembly
23846	ANVIL - crankshaft installation
23136	BODY - jackscrew
A-23137	JACKSCREW
22820-1	COLLAR - bearing
A-23850	SLEEVE - crankshaft installation
A-23841	WRENCH - insert (guide bar stud)
	GEAR DRIVE MODELS
23665	PLIERS - planetary snap ring
23772	BEARING ASSEMBLY & DISASSEMBLY - planetary follower
A-23792	SPROCKET HOLDER

PAINT

23318	SPRAY CAN - blue
22771	SPRAY CAN - red
23343	SPRAY CAN - green
23560	SPRAY CAN - white

HOMELITE XL CHAIN SAWS

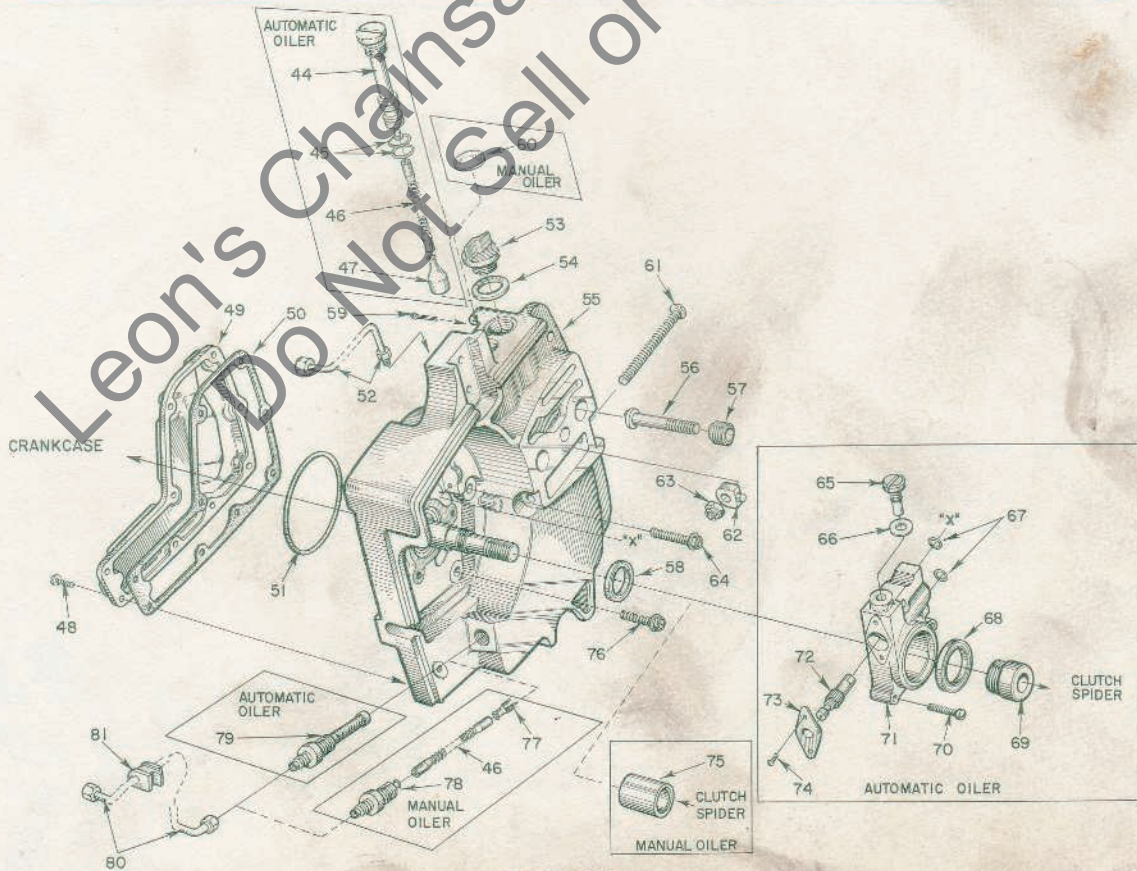
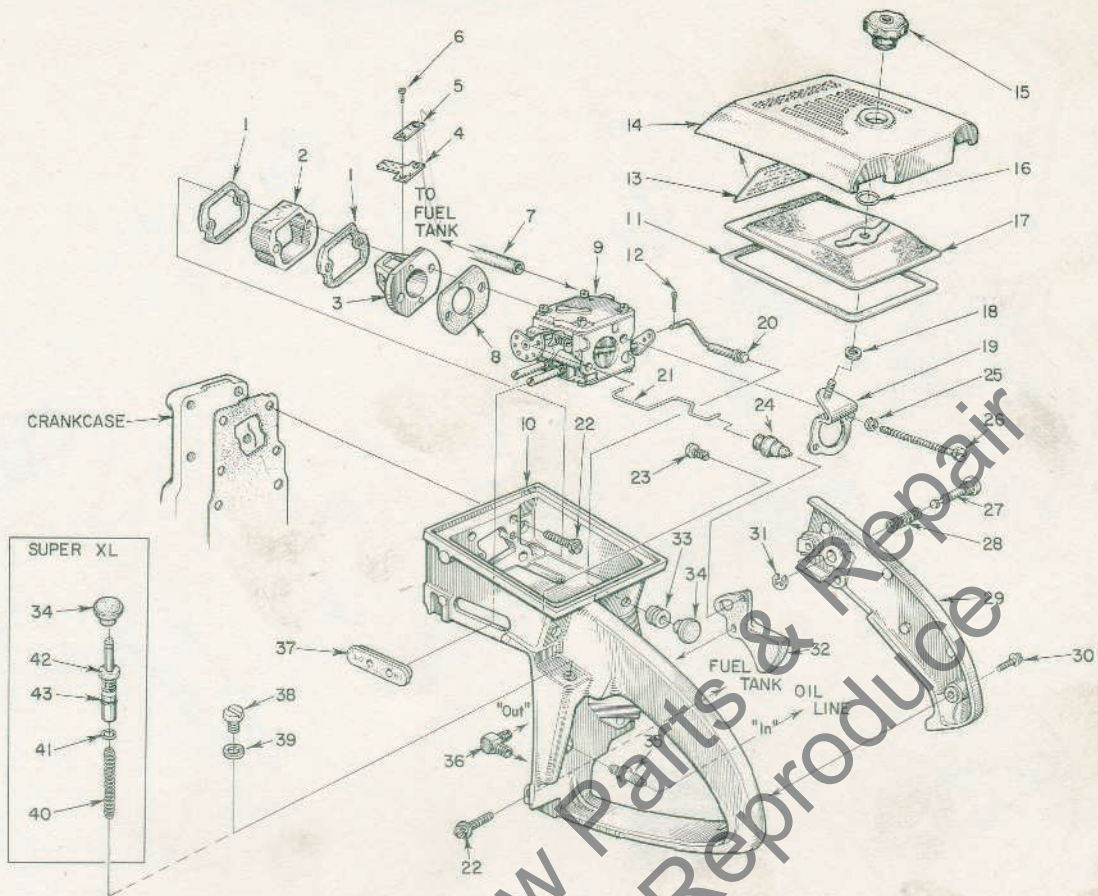

ALWAYS FURNISH MODEL AND SERIAL NUMBER WHEN ORDERING PARTS.

HOMELITE XL CHAIN SAWS

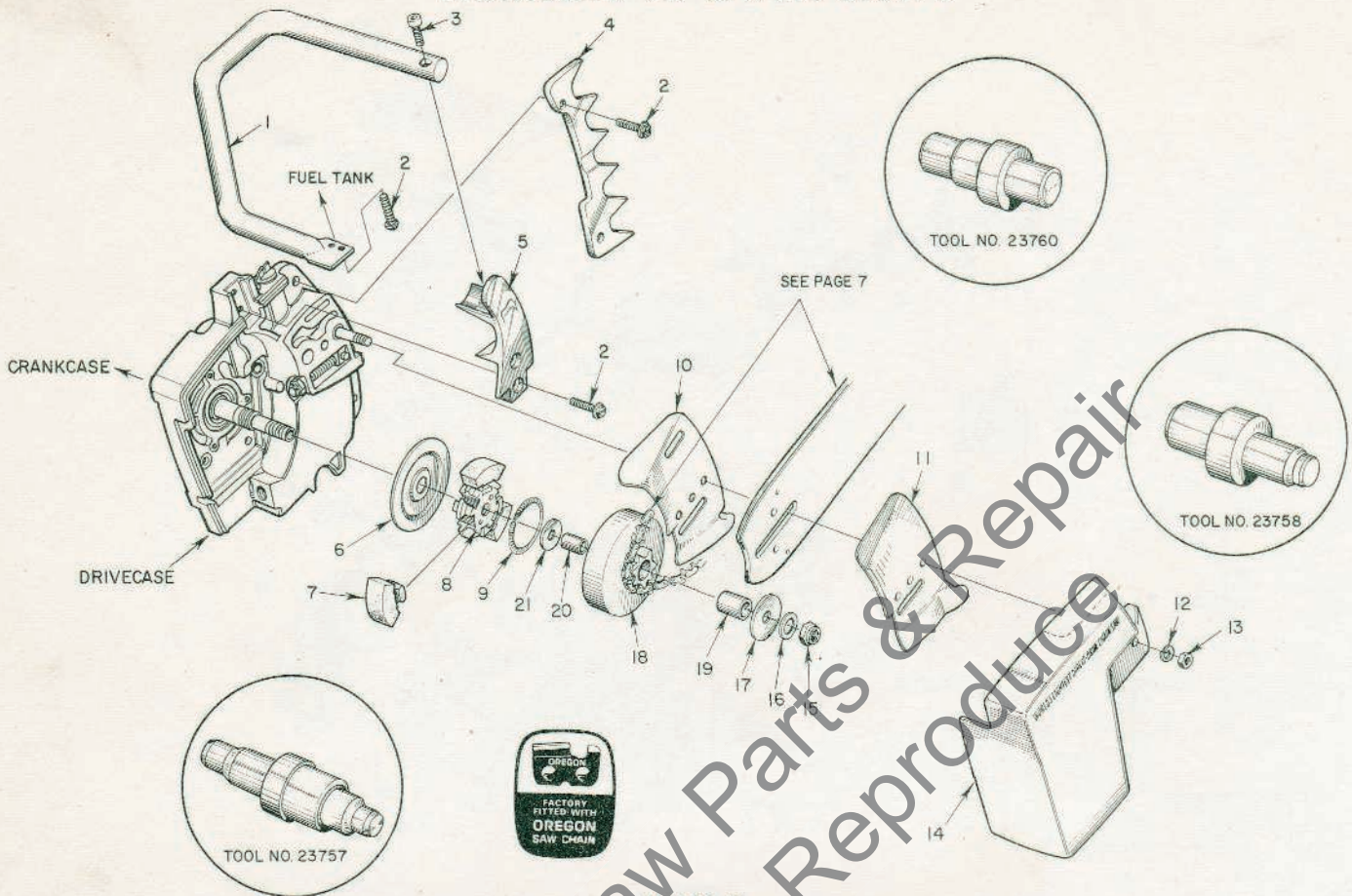

FIGURE 5

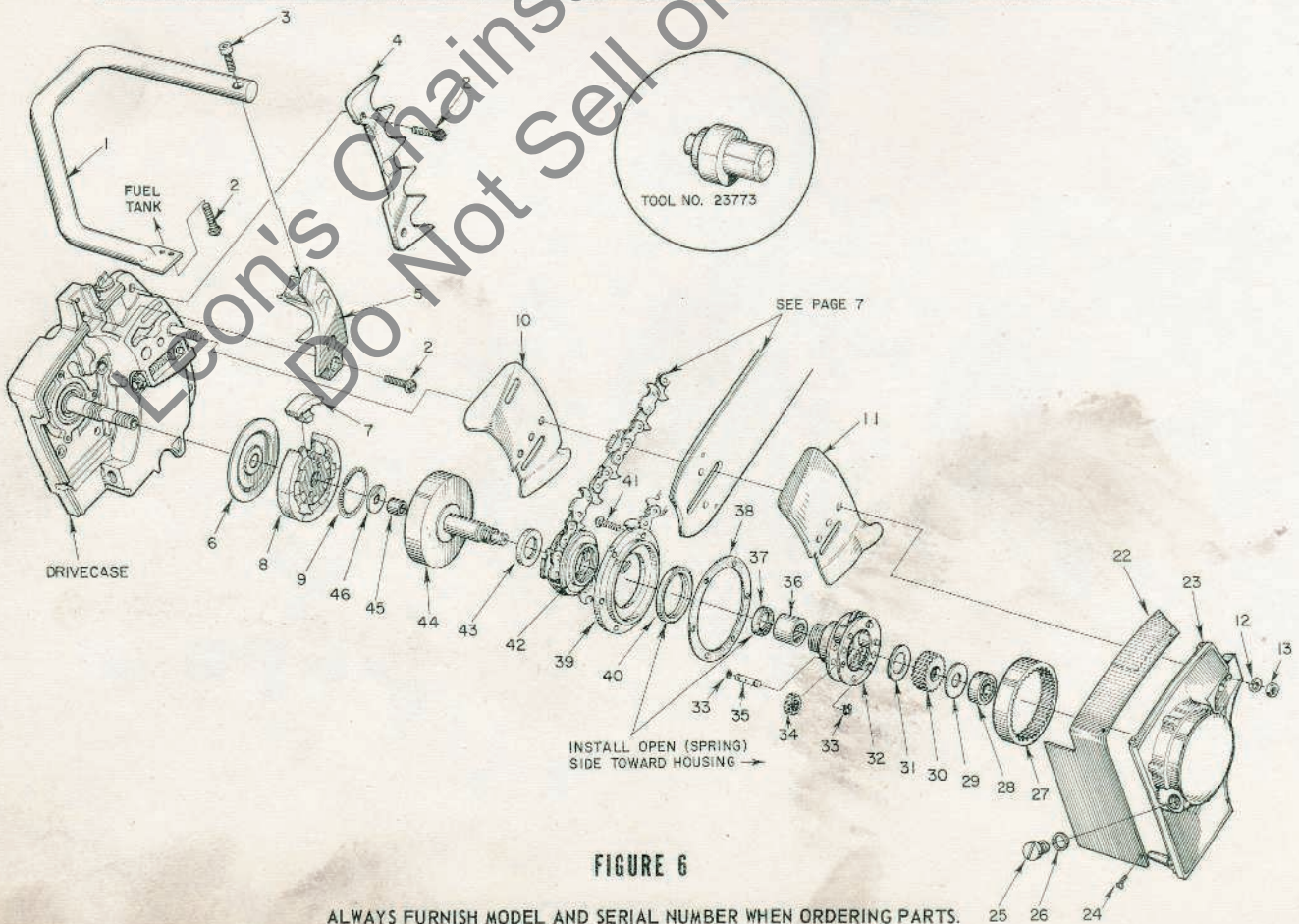

FIGURE 6

ALWAYS FURNISH MODEL AND SERIAL NUMBER WHEN ORDERING PARTS.

HOMELITE XL CHAIN SAWS

Parts used in each model are indicated by an asterisk (*) in the corresponding model column; a dagger (†) indicates an optional part available from your dealer.

No.	Description	Part No.	Automatic Direct Gear		Dir. Super XL	Qty.
			XL	XL		
1	HANDLE BAR	A-59790	*	*	*	1
2	SCREW - hex, 12-24 x 3/4	80867	*	*	*	6
3	SCREW - socket	80428	*	*	*	1
4	BUMPER PLATE	58961	†	*	†	1
5	BRACKET - handle bar	59651	*	*	*	1
6	COVER - clutch	58751	*	*	*	1
7	SHOE - clutch	58928	*	*	*	3 6
8	SPIDER - clutch	58927-1	*	*	*	1
9	SPRING - clutch	55123-C	*	*	*	2
10	PLATE - inner guide bar	58781	*	*	*	1
11	PLATE - outer guide bar	58782	*	*	*	1
12	WASHER - lock, 5/16	83002	*	*	*	2
13	NUT - hex, 5/16 - 18	81196	*	*	*	2
Index Nos. 14 thru 21 apply to DIRECT DRIVE MODELS						
14	COVER - drive case	58750-2	*	*	*	1
15	NUT - lock, 3/8-24	81192	*	*	*	1
16	WASHER - flat, 3/8	84010-1	*	*	*	1
17	WASHER - thrust (outer)	58926	*	*	*	1
18	SPROCKET & DRUM - Sec NOTE					
	standard - 7 tooth, 3/8" pitch	A-59552	*	*	*	1
	optional - 7 tooth, .404 pitch	A-59555	†	†	†	1
19	Includes: BEARING - needle	72311	*	*	*	1
20	RACE - inner	55584	*	*	*	1
21	WASHER - thrust (inner)	58833	*	*	*	1
Index Nos. 22 thru 46 apply to GEAR DRIVE MODELS						

No.	Description	Part No.	Automatic Direct Gear		Dir. Super XL	Qty.
			XL	XL		
22	CHAIN GUARD	59071		*		1
23	HOUSING - gear w/pins	A-59078		*		
24	SCREW - pan 110-32 x 3/8	80579		*		3
25	CAP - filler	58482		*		1
26	GASKET	58107		*		1
27	GEAR - ring	58107		*		1
28	BEARING - ball	58120-S		*		1
29	WASHER - thrust	58118-A		*		as/Req.
30	GEAR - sun	58109-1A		*		1
31	WASHER - thrust	59081		*		1
32	FOLLOWER - planetary	A-59083		*		1
33	RING - retaining	24270		*		6
34	GEAR - planet w/bearing	A-59062		*		3
35	SHAFT - gear	58953-A		*		3
36	BEARING - needle	58952		*		1
37	SCREW - pan	56134-1		*		1
38	GASKET - housing	58947		*		1
39	COVER - housing	A-59085		*		1
40	Includes: SEAL	58126		*		1
41	SCREW - pan, 6-32 x 1/2	80630		*		6
42	SPROCKET - Sec NOTE					
	standard - 7 tooth, 3/8" pitch	A-59021		*		1
	optional - 8 tooth, .404 pitch	A-59297		†		1
43	WASHER - thrust	58949		*		1
44	SHAFT & DRUM - clutch	A-58955		*		1
45	BEARING - needle	58951		*		1
46	WASHER - thrust (phenolic)	59219		*		1

NOTE: Standard 3/8" pitch sprockets used with 3/8" pitch chain, optional .404 pitch sprockets require .404 pitch chain; see below.

GUIDE BARS - .050 gauge						.050 gauge CHAIN 3/8" pitch		
Hard Track Part No.	Size	Perma-Hard Tip Part No.	Size	7 Roller Nose Part No.	Size	Part No.	Loop	Links
HT-1250	12"	GW-1250	12"			72D48E	12"	48
		GW-1650	16"	RN-1650	16"	72D59E	16"	59
		GW-2050	20"	RN-2050	20"	72D69E	20"	69
		GW-2450	24"	RN-2450	24"	72D81E	24"	81
† #A-59925 - Roller Guide & Rivet Kit - includes three #59344 rivets.								
						.063 gauge CHAIN .404 pitch		
						52AC373E	14"	73
						(14" Bow Guide)		

ACCESSORIES (available on order)

- #A-52971-A BOW GUIDE - includes #59194 CHAIN GUARD, #59324 SPUR with parts listed below. Use #72D81E CHAIN.
- #A-52972-A UTILITY GUIDE - includes #59103 CHAIN GUARD, #59343 SPUR with parts listed below. Use #72D69E CHAIN.
- #A-52994-A CLEARING GUIDE - includes #59103 CHAIN GUARD, #59343 SPUR with parts listed below. Use #72D81E CHAIN.
- #A-53024-A BOW GUIDE, 14", .063 - includes #59194 CHAIN GUARD, #59324 SPUR with parts listed below. Use #52AC373E CHAIN.

GUIDE ATTACHMENT PARTS:

#75729	SPACER - spur	1
#80546	SCREW - hex hd., 5/16-24 x 1-1/4	2
#81112	NUT - hex 5/16	2
#80676	SCREW - hex hd., 12-24 x 5/8	2
#83056	WASHER - lock, #12	2
#81068	NUT - hex #12	2

**You'll
SPEED WORK
and make
MORE MONEY
with...**

HOMELITE

SELF-PRIMING PUMPS



DEPENDABLE GENERATORS



POWERFUL ONE-MAN CHAIN SAWS



ONE-MAN CONCRETE VIBRATORS



ELECTRIC BUILDER'S HAMMERS



Printed in United States of America

Part. No. 23840

HOMELITE

A **Textron** DIVISION

PORT CHESTER, N. Y.

Illustrated in **INSPECTIVE** and
prepared by PURNELL COMPANY, INC.
Boston, Mass.