

PRICE .25

June 1964

# HOMELITE

## Chain Saws

Leon's Chainsaw Parts & Repair  
Do Not Sell or Reproduce

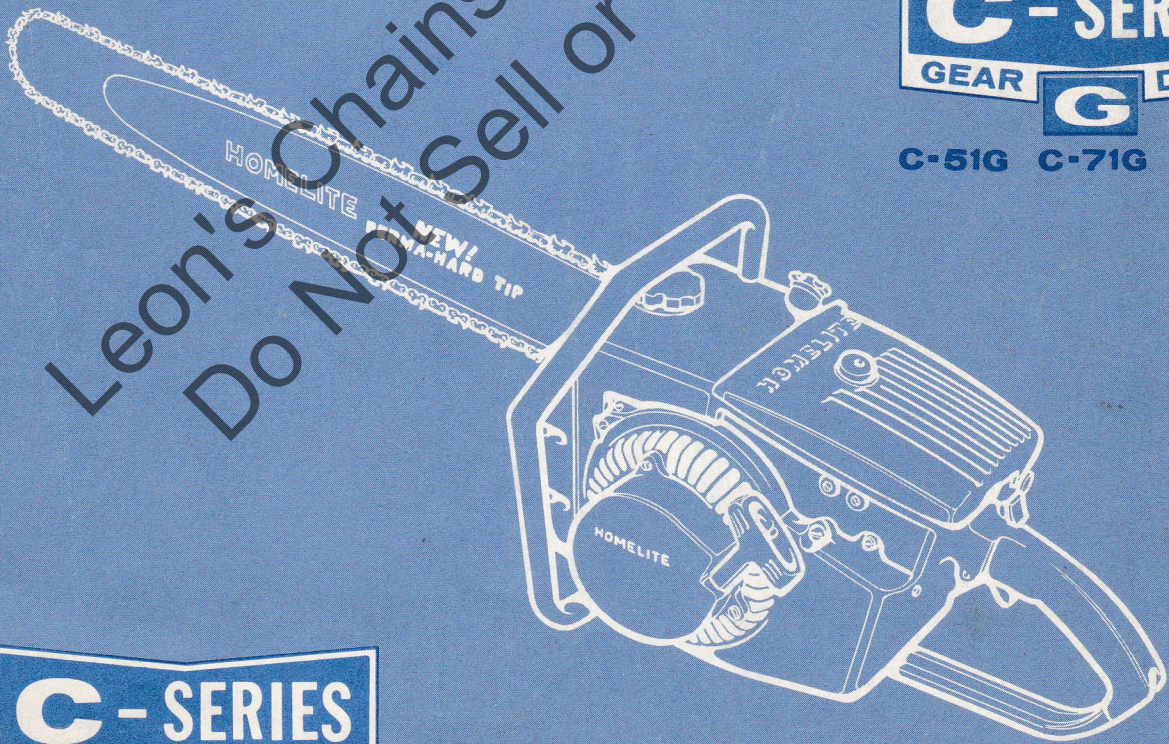

C-51G C-71G C-91G



C-51 C-71 C-91

PARTS LIST

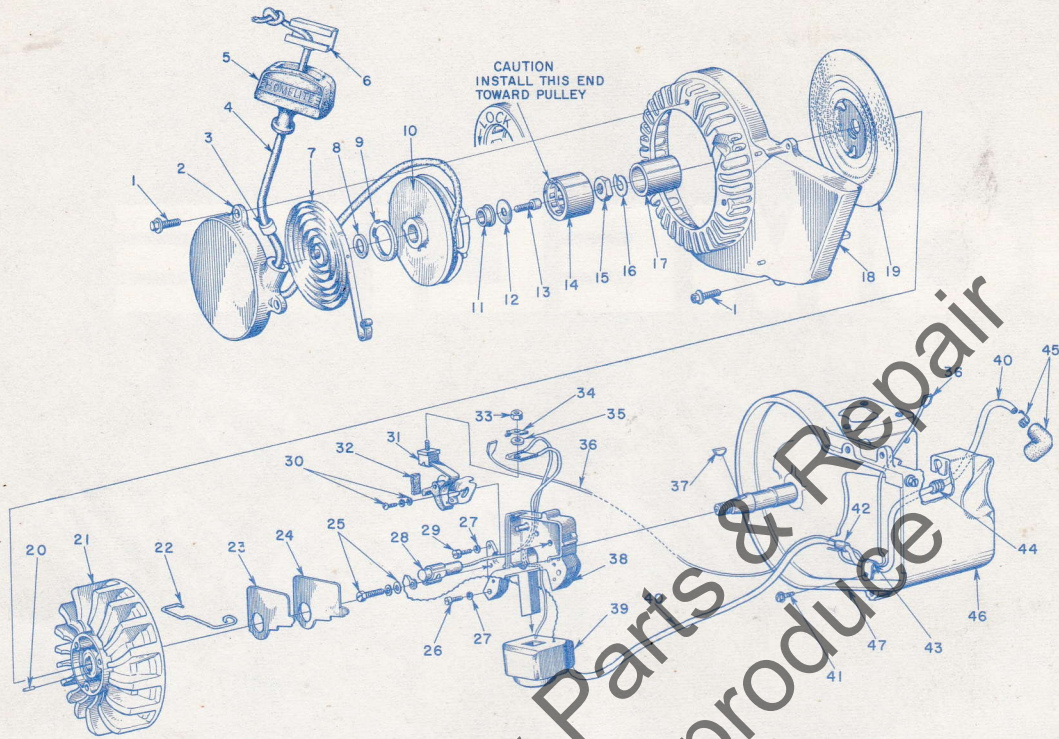

FIGURE 1



FIGURE 2

ALWAYS FURNISH MODEL AND SERIAL NUMBER WHEN ORDERING PARTS.



# HOMELITE CHAIN SAWS



Parts used in each model are indicated by an asterisk (\*) in the corresponding model column; a dagger (†) indicates an optional part available from your dealer. Parts indicated in #51, #71, or #91 columns fit C-51, C-71, C-91 DIRECT (convertible) DRIVE MODELS and C-51G, C-71G, C-91G GEAR (planetary) DRIVE MODELS unless otherwise noted. Service replacement parts are normally painted RED.

No.	Description	Part No.	51	71	91	Qty.
1	SCREW - hex hd., 12-24 x 3/4	80867	*	*	*	13
2	COVER - starter	A-59494-1	*	*	*	1
3	Includes: BUSHING - rope	59313	*	*	*	1
4	ROPE - starter	55898	*	*	*	1
5	GRIP - rope	55937	*	*	*	1
6	INSERT - rope retaining	58517	*	*	*	1
7	SPRING - rewind	58428-A	*	*	*	1
8	WASHER - thrust	58412	*	*	*	1
9	LOCK - spring rewind	58009	*	*	*	1
10	PULLEY - starter	A-59495	*	*	*	1
11	Includes: BUSHING	58007	*	*	*	1
12	WASHER - thrust	58413	*	*	*	1
13	SCREW - socket hd., 10-32 x 3/8	80878	*	*	*	1
14	BEARING - overrunning	58480	*	*	*	1
15	NUT - hex, 7/16-20	81191	*	*	*	1
16	WASHER - lock, 7/16	83019	*	*	*	1
17	RACE - inner	58268	*	*	*	1
18	HOUSING - fan	59094-1	*	*	*	1
19	SCREEN - rotary	58011	*	*	*	1
20	PIN - dowel	58429	*	*	*	1
21	ROTOR	57568-B	*	*	*	1
22	CLAMP - dust cover	55980	*	*	*	1
23	COVER - dust	55979	*	*	*	1
24	GASKET - dust cover	55978-2	*	*	*	1
25	SCREW GROUP - condenser	57750	*	*	*	1
26	SCREW - fil. hd., 10-24 x 7/8	80660	*	*	*	2
27	WASHER - lock, #10	83046	*	*	*	3
28	CONDENSER - w/terminal	55987	*	*	*	1
29	SCREW - fil. hd., 10-24 x 1/2	80595	*	*	*	1
30	SCREW GROUP - point	57749	*	*	*	1
31	POINT SET	A-58165	*	*	*	1
32	Includes: WICK	55984	*	*	*	1
33	NUT - terminal	55982	*	*	*	1
34	TAB - ground	57733	*	*	*	1
35	WASHER - terminal	55983	*	*	*	1
36	LEAD - ground w/terminals	A-58321	*	*	*	1
37	KEY - rotor	58078	*	*	*	1
38	BOX - breaker w/core	57744	*	*	*	1
39	COIL - w/ground terminal	55986-A	*	*	*	1
40	LEAD - high tension	58382	*	*	*	1
41	SCREW - hex hd., 10-24 x 3/8	80868	*	*	*	3
42	SLEEVE	55290	*	*	*	1
43	CLAMP - lead	56014	*	*	*	1
44	GROMMET	60929	*	*	*	1
45	TERMINAL - spark plug	A-55373-A	*	*	*	1
46	CYLINDER SHELL	A-58906-1	*	*	*	1

No.	Description	Part No.	51	71	91	Qty.
47	CRANKCASE	A-58317-A1	*	*	*	1
48	Includes: STUD	55871	*	*	*	4
49	SEAL	58308	*	*	*	1
50	FITTING - fuel outlet	58364	*	*	*	1
51	TANK - fuel	58172-A1	*	*	*	1
52	CAP - tank	A-58368-A	*	*	*	1
53	Includes: VALVE - relief	56865	*	*	*	1
54	GASKET	58957	*	*	*	1
55	SCREW - rd. hd., #6 x 1/2	80513	*	*	*	15
56	COVER - tank	58173-1	*	*	*	1
57	LINE - oil (flexible)	55805	*	*	*	1
58	FILTER ASSEMBLY	A-59251	*	*	*	1
59	Includes: FILTER	59253	*	*	*	1
60	RING - retaining	58319-A	*	*	*	1
61	BEARING - ball	58190-S	*	*	*	1
62	WASHER - lock	83061	*	*	*	2
63	SCREW - bearing retainer	19238-3	*	*	*	2
64	CRANKSHAFT	59269	*	*	*	1
		59270		*	*	1
65	ROLLERS - set of 27	AA-55280	*	*	*	1
66	"O" RING	58329	*	*	*	1
67	CONNECTING ROD	AA-55195-B	*	*	*	1
68	Includes: SCREW	80805	*	*	*	2
69	BEARING - needle	59351	*	*	*	1
70	PISTON & PIN	A-58328	*	*	*	1
		A-58653		*	*	1
		A-58674		*	*	1
71	Includes: RING - retaining	55095	*	*	*	2
72	RING - piston	55038	*	*	*	2
		55537		*	*	2
73	EXCHANGER - heat Optional - See Note 1	59279		†	†	1
74	SCREW-hex hd., 12-24 x 3/8	80837	†	*	*	2
75	CAP - muffler	58425-A	†	*	*	1
76	STUD - muffler	59337	†	*	*	2
77	BAFFLE - muffler	58423-A	†	*	*	1
78	BODY - muffler	A-58419	†	*	*	1
79	MUFFLER - See Note 2	58184-A	*	*	*	1
80	DEFLECTOR - air See Note 1	58639	†	*	*	1
81	SPARK PLUG	40190-S	*	*	*	1
82	Includes: GASKET	25038	*	*	*	1
83	CYLINDER - 2" bore	58174-A	*	*	*	1
	2-1/16" bore	58174-A1		*	*	1
84	NUT - hex, 1/4-28	81065-2	*	*	*	4
85	WASHER - lock, 1/4	83009	*	*	*	4
86	GASKET - cylinder	58292	*	*	*	1

NOTE 1: When HEAT EXCHANGER is installed remove AIR DEFLECTOR.  
NOTE 2: "C-51" MUFFLER can be replaced with parts shown for other models.



# HOMELITE CHAIN SAWS



Parts used in each model are indicated by an asterisk (\*) in the corresponding model column; a dagger (†) indicates an optional part available from your dealer. Parts indicated in #51, #71, or #91 columns fit C-51, C-71, C-91 DIRECT (convertible) DRIVE MODELS and C-51G, C-71G, C-91G GEAR (planetary) DRIVE MODELS unless otherwise noted. Service replacement parts are normally painted RED.

No.	Description	Part No.	51	71	91	Qty.
1	COVER - air filter	59230-1	*	*	*	1
2	NUT - cover	A-59229	*	*	*	1
3	RING - retaining	58319-A	*	*	*	1
4	ELEMENT - air filter	58188	*	*	*	1
5	GASKET - filter	58350	*	*	*	1
6	SCREW - hex hd., 12-24 x 1-1/2	80868	*	*	*	4
6A	SCREW - hex hd., 1/4-20 x 1-1/2	80882			*	2
7	GASKET - stud	58392	*	*	*	1
8	ELBOW - reed w/#9, #10	A-59490	*	*	*	1
8A	ELBOW - w/out #9, #10	58183-B			*	1
9	STUD - cover	58361	*	*	*	1
10	STUD - carburetor	27464	*	*	*	2
11	FILLER BLOCK	58933	*	*	*	1
12	GASKET - elbow	58344	*	*	*	1
12A	GASKET - elbow	55946			*	1
13	GASKET - carburetor	55553-3	*	*	*	1
14	ADAPTER - reed	55932			*	1
15	REED	55941-1			*	4
16	PLATE - reed	55942			*	4
17	SCREW - pan hd., 4-40 x 3/16	80658			*	8
18	SCREW - hex hd., 12-24 x 1	80864	*	*	*	1
19	LINE - fuel	55680	*	*	*	1
20	WASHER - lock, 1/4	83009	*	*	*	4
21	NUT - hex, 1/4-20	81013	*	*	*	2
22	COTTER PIN - 1/32 x 1/2	86324	*	*	*	1
23	ROD - choke	A-58354	*	*	*	1
24	CARBURETOR - See NOTE 1	A-58360-A	*	*	*	1
25	ROD - throttle	59338	*	*	*	1
26	BOOT - rod	58348	*	*	*	1
27	DEFLECTOR - carburetor	58837	†	*	*	1
28	SCREW - pan hd., 10-32 x 1/2	80625	†	*	*	2
29	SPRING - idle adjusting screw	59319	*	*	*	1
30	SCREW - idle adjusting (external)	59310	*	*	*	1
31	HANDLE - throttle, See NOTE 2	A-59496-1	*	*	*	1
32	Includes: STOP - rod	58930	*	*	*	1
33	BUSHING - rod	58929	*	*	*	2
34	BUSHING - lock pin	59064	*	*	*	1
35	SCREW PLUG	71505	*	*	*	1
36	GROMMET	58662	*	*	*	3
37	BUTTON - rod	57289	*	*	*	1
38	TRIGGER - throttle	58181-A	*	*	*	1
39	SHAFT - trigger	58353	*	*	*	1
40	SPRING - throttle	58352-A	*	*	*	1
41	PIN - throttle lock	58404	*	*	*	1
42	SPRING - lock	58405	*	*	*	1
43	RING - retaining	58409	*	*	*	1
44	BUTTON - oil rod	58357	*	*	*	1
45	ROD - oil pump	58356-A	*	*	*	1
46	COTTER PIN - 1/16 x 1/2	86301	*	*	*	1
47	SWITCH - toggle w/nut	A-57650-3	*	*	*	1
48	PLATE - "ON-OFF"	72085-A	*	*	*	1
49	GASKET - spacer	58343	*	*	*	2
50	SPACER	58391	*	*	*	1
51	SCREW - hex hd., 12-24 x 3/4	80867	*	*	*	8
52	BRACE - throttle handle	58185-1	*	*	*	1
53	BUMPER - spiked	58396	†	†	*	1
54	NUT - hex, 1/4-20	81053	†	*	*	2
55	RESERVOIR - oil	A-58341	*	*	*	1

No.	Description	Part No.	51	71	91	Qty.
56	FILTER - oil	A-58828	*	*	*	1
57	LINE - oil filter	58340-B	*	*	*	1
58	GASKET - reservoir	58342	*	*	*	1
59	SPRING - plunger	59293	*	*	*	1
60	CONNECTOR - oil pump	58337-A	*	*	*	1
61	PLUNGER - oil pump	A-58334-8	*	*	*	1
62	Includes: "O" RING	74338	*	*	*	1
63	DRIVECASE	A-59493-1	*	*	*	1
64	Includes: SEAL	56256	*	*	*	1
65	BEARING - needle	74251	*	*	*	1
66	BOLT - guide bar	58334	*	*	*	2
67	CAP - oil filler, See NOTE 3 w/Bow Guide	A-58390-A	*	*	*	1
		A-56580-1	†	†	†	1
68	Includes: GASKET	56697	*	*	*	1
69	CAP - check valve	56339	*	*	*	2
70	GASKET	56338	*	*	*	2
71	SPRING - check valve	59022	*	*	*	2
72	BALL - check	25527	*	*	*	2
73	SCREW - flat hd., 1/4-20 x 3/4	80053	*	*	*	2
74	SCREW - rd. hd., #6 x 3/4	80790	*	*	*	5
75	HANDLE BAR - flush cut	A-58650	*	*	*	1
	Optional: Wrap around	A-58398	†	†	†	1
76	WASHER - lock, 5/16	83003	*	*	*	3
77	SCREW - hex, 5/16, 18 x 1-1/2	80087	*	*	*	3
78	COVER - clutch	56101-A	*	*	*	1
79	SPRING - clutch	55123-C	*	*	*	2
80	SHOULDER - clutch	55076-1A	*	*	*	3
				*	*	6
81	SPIDER - clutch	58546-1	*	*	*	1
82	WASHER - thrust	55660-1	*	*	*	1
83	PLATE - guide bar (inner)	56871-A	*	*	*	1
84	PLATE - guide bar (outer)	56872-A	*	*	*	1
NOTE: Parts listed below used in C-51, C-71, C-91 DIRECT DRIVE MODELS - See Page 6 for parts used in Gear Drive Models.						
85	RACE - inner	55661	*	*	*	1
86	SPROCKET & DRUM - See NOTE 4					
	Open type - 7 tooth, .404 pitch	A-57344	*	*	*	1
	6 tooth, 1/2" pitch	A56019	†	†	†	1
	7 tooth, 7/16" pitch	A-56377	†	†	†	1
87	Includes: BEARING - needle	55664	*	*	*	1
86A	SPROCKET & DRUM - See NOTE 4					
	Rim Type - 7 tooth, 7/16" pitch	A-57363-A	†	†	†	1
87A	Includes: BEARING - needle	77403	†	†	†	1
88	WASHER - thrust	55163-1	*	*	*	1
89	WASHER - flat, 3/8	84010	*	*	*	1
90	NUT - hex 3/8-24	81192	*	*	*	1
91	COVER - drive case	A-58378-1	*	*	*	1
	Optional	A-58683	†	†	†	1
92	Includes: NUT - 5/16-18	81123	*	*	*	1
93	PIN - adjusting	55613	*	*	*	1
94	SCREW - pin	80617	*	*	*	1
95	WASHER - lock, 3/8	83018	*	*	*	2
96	NUT - hex, 3/8-16	81089-2	*	*	*	2
97	PLANETARY DRIVE KIT - See NOTE 5					
	.404 pitch	A-58544-A	†	†	†	1
	for BOW GUIDE - .404 pitch	A-58544-A1	†	†	†	1
	1/2" pitch	A-58556-A	†	†	†	1
	for BOW GUIDE - 1/2" pitch	A-58556-A1	†	†	†	1

NOTE 1: Service replacement carburetor #A-58360-A supplied with idle stop screw and spring which must be removed when external idle adjusting screw (#30) is used. Refer to Carburetor Parts List #23692-A (1R6648M) for repair parts.

NOTE 2: Service replacement handle #A-59496-1 supplied with screw plug (#35). Remove to install external idle adjusting screw (#30).

NOTE 3: BOW GUIDE requires #A-56580-1 CAP.

NOTE 4: Check type and number of teeth on sprocket before ordering.

NOTE 5: Refer to page 6 (Fig. 5) for replacement parts.

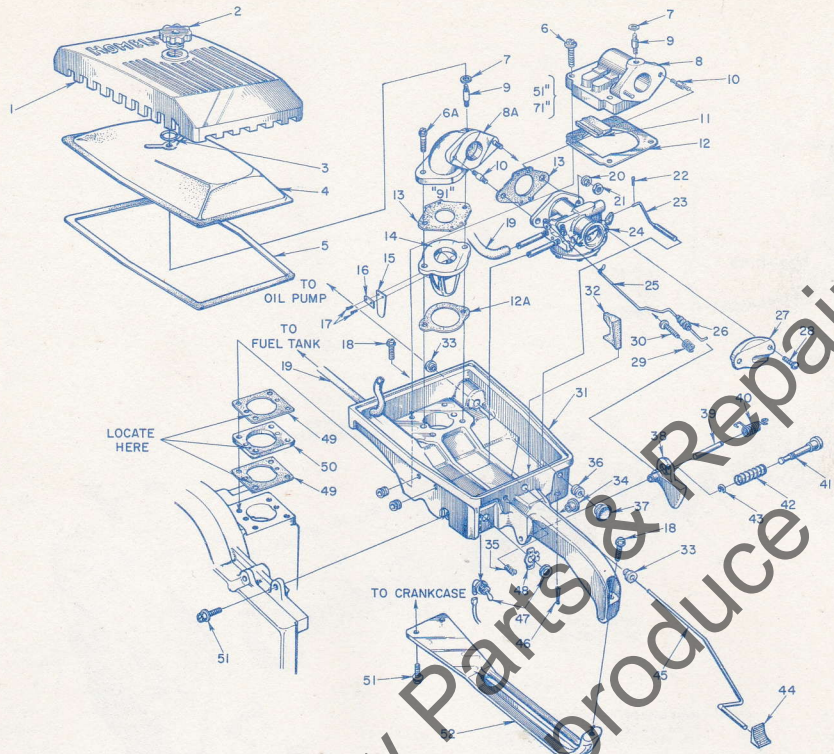
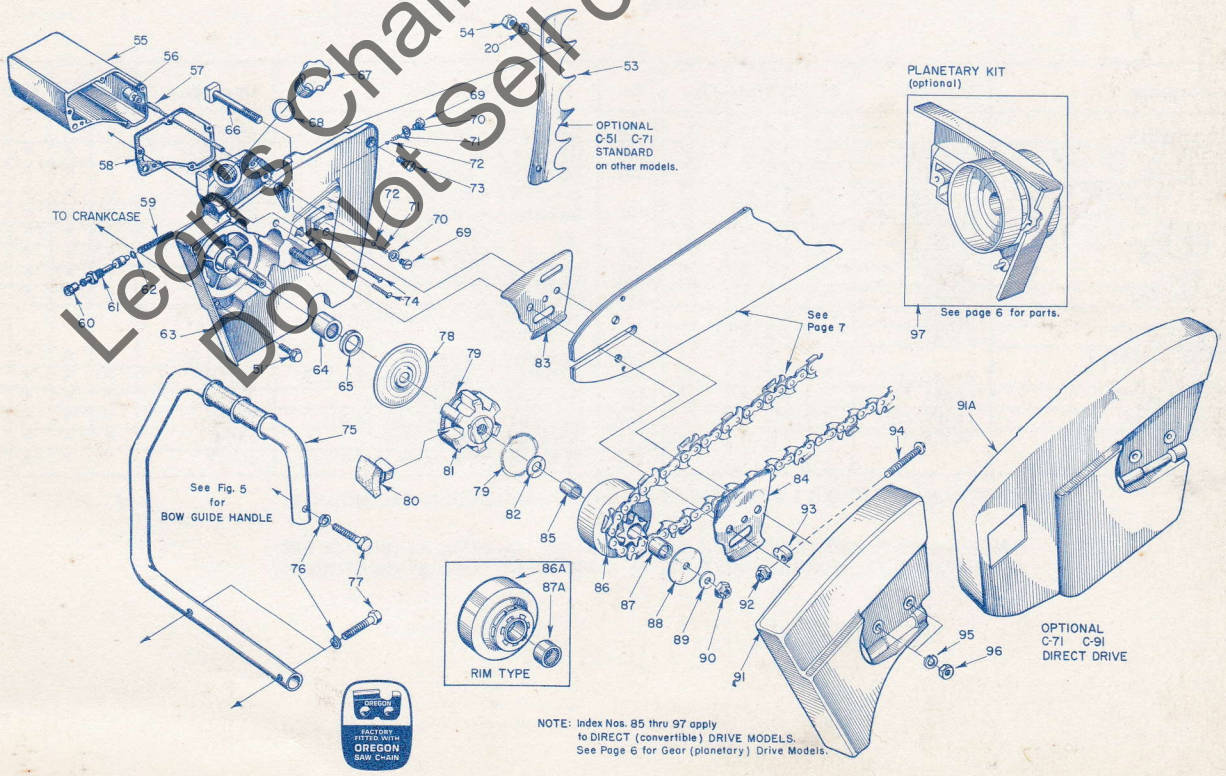

FIGURE 3



NOTE: Index Nos. 85 thru 97 apply to DIRECT (convertible) DRIVE MODELS. See Page 6 for Gear (planetary) Drive Models.

FIGURE 4

ALWAYS FURNISH MODEL AND SERIAL NUMBER WHEN ORDERING PARTS.

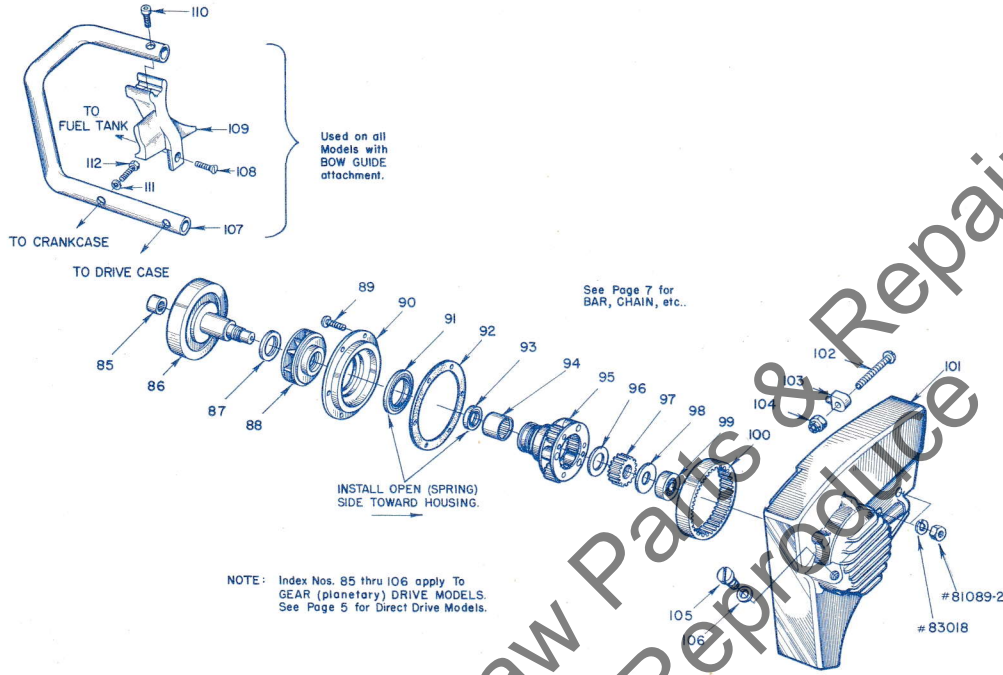

NOTE: Index Nos. 85 thru 106 apply To GEAR (planetary) DRIVE MODELS. See Page 5 for Direct Drive Models.

FIGURE 5

No.	Description	Part No.	51	71	91	Qty.	No.	Description	Part No.	51	71	91	Qty.
85	BEARING - needle	58550	*	*	*	1	99	BEARING - ball	58120-S	*	*	*	1
86	SHAFT & DRUM - See Note	A-58128	*	*	*	1	100	GEAR - ring	58107	*	*	*	1
87	WASHER - thrust	58588	*	*	*	1	101	HOUSING - gear w/pins	A-58568	*	*	*	1
88	SPROCKET - 404 pitch, 8 tooth	A-58469-A*	*	*	✓	1		HOUSING - for bowguide	A-58568-1	*	*	*	1
	1/2" pitch, 7 tooth	A-58468-A*	*	*	*	1	102	Includes: SCREW - 5/16-18 x 2	80617	*	*	*	1
89	SCREW - pan hd., 6/32 x 1/2	80630	*	*	*	6	103	PIN - adjusting	55613	*	*	*	1
90	COVER - housing	A-58122	*	*	*	1	104	NUT - 5/16-18	81123	*	*	*	1
91	Includes: SEAL	58126	*	*	*	1	105	CAP - oil filler	58482	*	*	*	1
92	GASKET - housing	58124	*	*	*	1	106	GASKET	55107	*	*	*	1
93	SEAL	58123	*	*	*	1		Required for ALL models with BOW GUIDE					
94	BEARING - needle	58133	*	*	*	1	107	HANDLE - flush cut	A-58719	*	*	*	1
95	PLANETARY GEARS & FOLLOWER	A-58119-A	*	*	*	1	108	SCREW - socket 5/16-18 x 7/8	80886	*	*	*	1
96	WASHER - thrust	59081	*	*	*	1	109	BRACKET - handle	58685	*	*	*	1
97	GEAR - sun (drive)	58109-1A	*	*	*	1	110	SCREW - socket 5/16-18 x 1	80308	*	*	*	1
98	WASHER - thrust	58118-A	*	*	*	1 or 2	111	WASHER - lock, 5/16	83003	*	*	*	2
							112	SCREW - hex, 5/16-18 x 1-1/2	80087	*	*	*	2

NOTE: Six (6) CLUTCH SHOES #55076-1A required for GEAR DRIVE MODELS.

\* In .404 pitch PLANETARY DRIVE KIT #A-58544-A, #A-58544-A1 (BOW GUIDE)  
 ≠ In 1/2" pitch PLANETARY DRIVE KIT #A-58556-A, #A-58556-A1 (BOW GUIDE)



# HOMELITE CHAIN SAWS



Guide Bars and Chain available at your HOMELITE Dealer, he can help you select the attachments best suited to your needs.

GUIDE BAR (.063 gauge)		CHAIN (.063 gauge)					
Size	Part No.	.404 pitch 52AC	.404 pitch Micro-Bit	7/16" pitch 62AC	7/16" pitch Micro-Bit	1/2" pitch 10AC	1/2" pitch Micro-Bit
<b>GUIDE BAR - Hard Track</b>							
14" - 16"	HT-1416	A-52744	A-52884	A-52498	A-52855	A-51910	A-52863
17" - 19"	HT-1719	A-52290	A-52885	A-51535	A-52639	A-51927	A-52560
<b>GUIDE BAR - Roller Nose</b>							
17" - 19"	RN-1719	A-52290	A-52885	A-51535	A-52639	A-51927	A-52560
21" - 23"	RN-2123	A-52291	A-52886	A-51536	A-52640	AA-73340	A-52395
<b>GUIDE BAR - Perma-Hard Tip</b>							
14" - 16"	GW-1416-A	A-52744	A-52884	A-52498	A-52855	A-51910	A-52863
17" - 19"	GW-1719-A	A-52290	A-52885	A-51535	A-52639	A-51927	A-52560
21" - 23"	GW-2123-A	A-52291	A-52886	A-51536	A-52640	AA-73340	A-52395
25" - 28"	GW-2528-A	A-52120	A-52887	A-51537	A-52641	AA-73342	A-52397
30" - 33"	GW-3033-A	A-52328	A-52888	A-51540	A-52642	AA-73344	A-52399
<b>BOW GUIDE - Standard</b>							
14"	A-58734	A-52291	A-52886	A-51536	A-52640	AA-73340	A-52395
16"	A-56485-B	A-52671	A-52918	A-51850	A-53050	A-51972	A-52505
<b>UTILITY GUIDE</b>							
	A-57905-B	A-52291	A-52886	A-51536	A-52640	AA-73340	A-52395

## TOOLS

Part No.	Description
22808	COMBINATION WRENCH
23737	WRENCH - guide bar (Req'd. w/#A-58398 HANDLE)
A-23809	PLUG - needle bearing (conn. rod)
23528	WRENCH - socket screw (conn. rod)
23228	PLIERS - snap ring (piston)
AA-22560	REMOVER - rotor
23136	BODY - assembly
22920-2	ADAPTER - main bearing
A-23672	JACKSCREW
23670	PLATE - shaft aligning
23233-1	PLUG - seal assembly
23671	PLUG - drive case seal
23693	SLEEVE - shaft (drive case)
23391-2	TOOL - drive case bearing
23139	TOOL - clutch drum bearing
A-23696	REMOVER - spider, sun gear
23678	TOOL - starter bearing
A-23679	REMOVER - starter bearing
A-23713	TOOL - sprocket holder
23725-A	PLUG - planetary bearing
23726-A	PLUG - bearing (planet drum)
-	BEARING PULLER - clutch drum (#A-78 Snap-On or equivalent)

## PAINT

23318	SPRAY CAN - blue
23771	SPRAY CAN - red
23343	SPRAY CAN - green

REPLACEMENT DECAL #23742 composed of "DIRECT DRIVE", "GEAR DRIVE", "STARTING INSTRUCTIONS" and two "HOMELITE" (letters 1/2" and 1/4" high).

**You'll  
SPEED WORK  
and make  
MORE MONEY  
with...**

# HOMELITE

**SELF-PRIMING PUMPS**



**DEPENDABLE GENERATORS**



**POWERFUL ONE-MAN CHAIN SAWS**



**ONE-MAN CONCRETE VIBRATORS**



**ELECTRIC BUILDER'S HAMMERS**

*Leon's Chainsaw Parts & Repair  
Do Not Sell or Reproduce*



Printed in United States of America

Part No. 23808

66420M

# HOMELITE

A **Textron** DIVISION

**PORT CHESTER, N. Y.**

Illustrated in **VISPECTIVE** and  
prepared by PURNELL COMPANY, INC.  
Boston, Mass.