

PRICE .25

December 1964

HOMELITE

Chain Saws

GEAR DRIVE

9-26, 900G, 909G, 990G and 995G

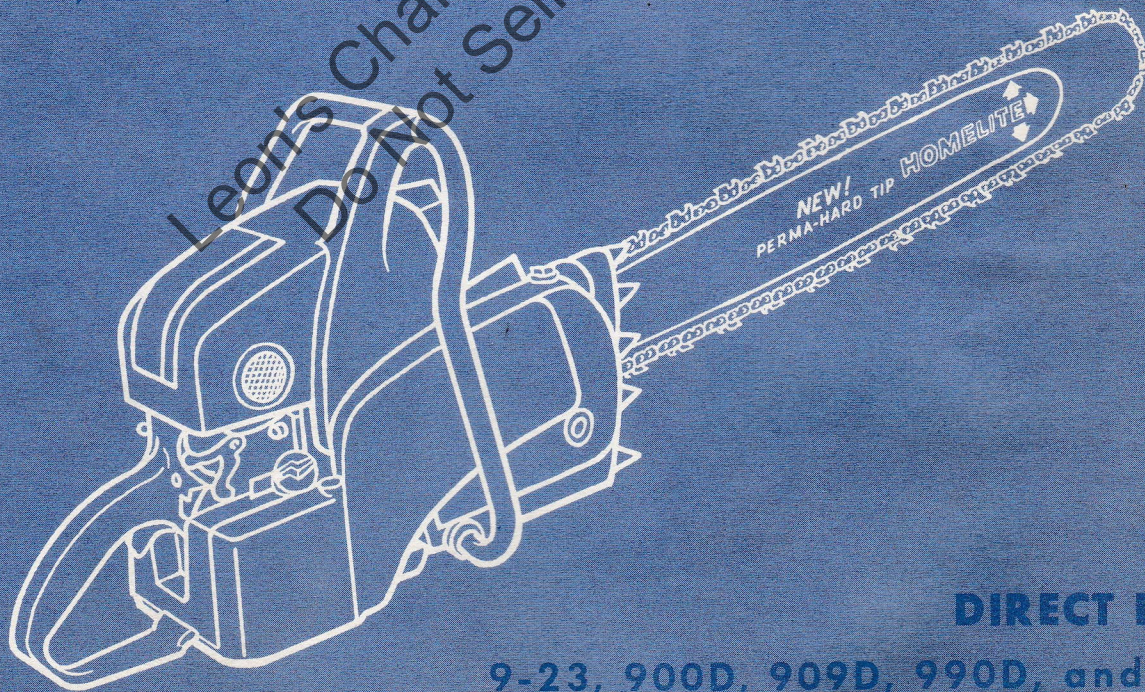

DIRECT DRIVE

9-23, 900D, 909D, 990D, and 995D

PARTS LIST

HOMELITE CHAIN SAWS

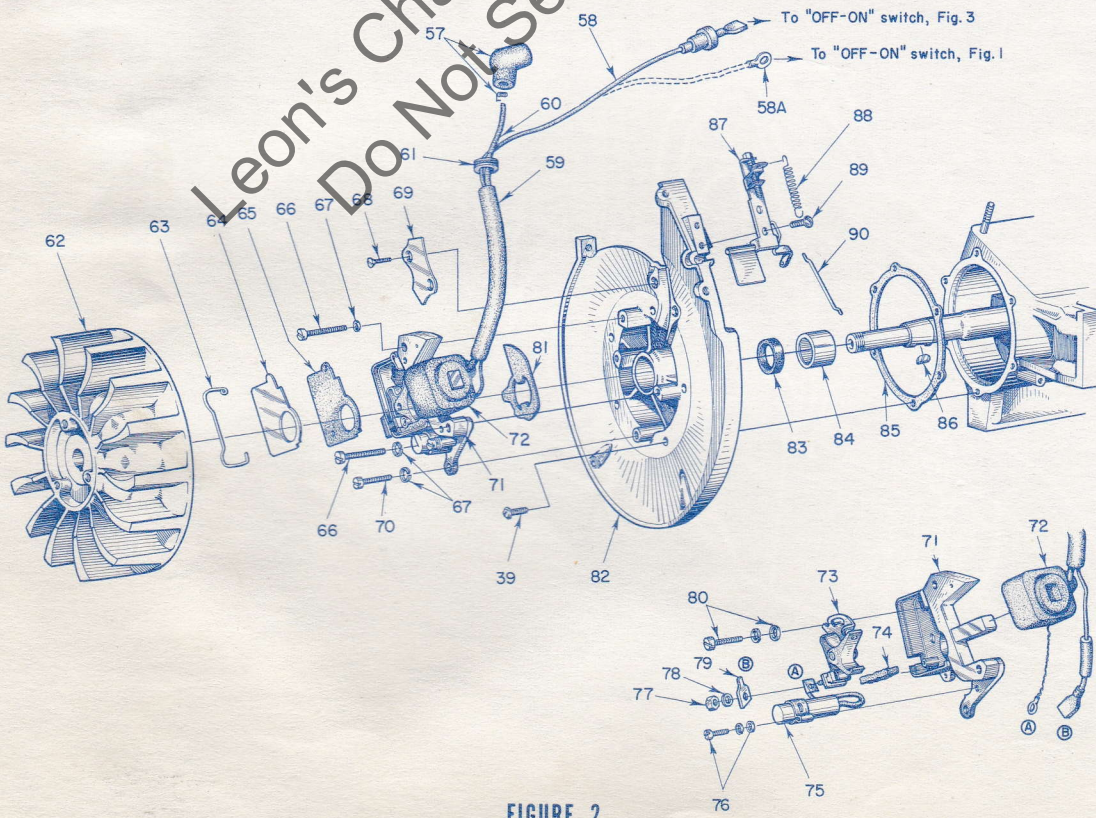
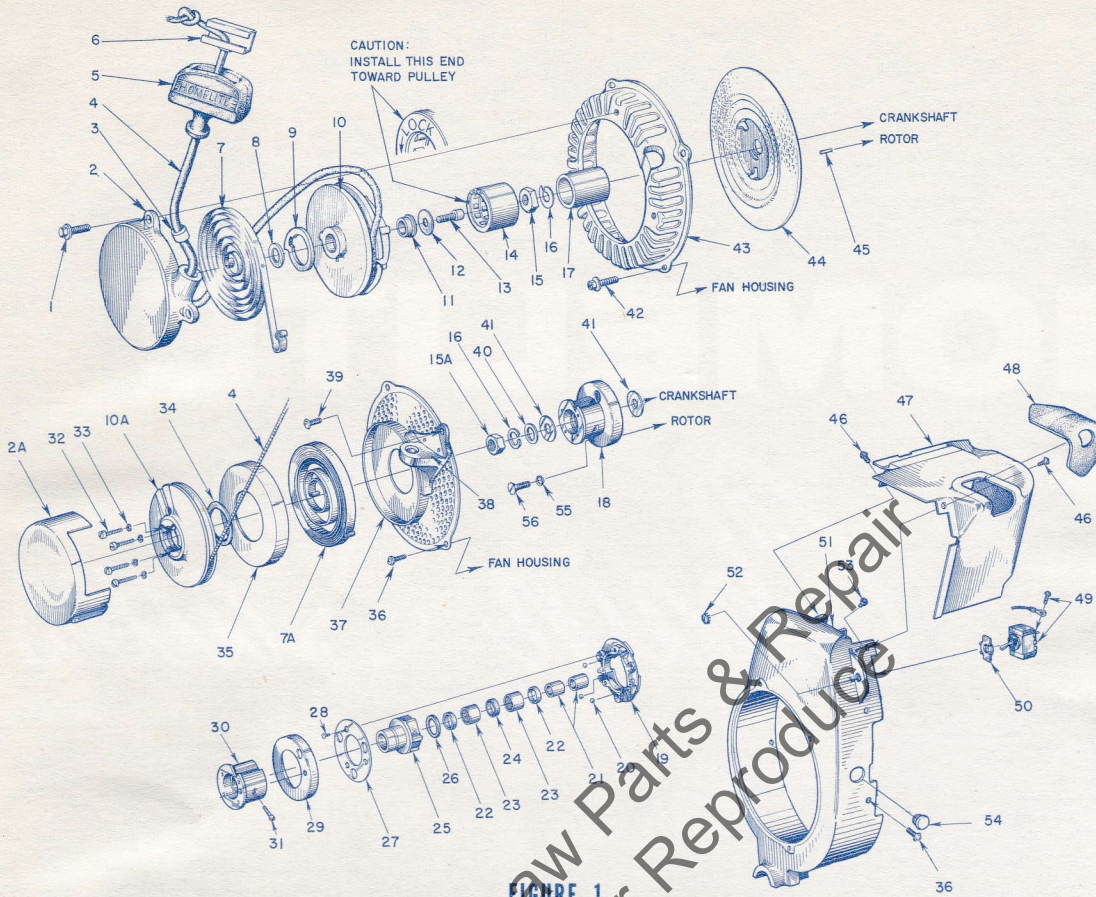

ALWAYS FURNISH MODEL AND SERIAL NUMBER WHEN ORDERING PARTS.

HOMELITE CHAIN SAWS

Parts used in each model are indicated by an asterisk (*) in the corresponding model column.
A dagger (†) denotes a service replacement part that may require adaptation for use in early models; refer to NOTES, circled numerals, on page 10.

| No. | Description | Part No. | 9 -23 -26 | 900 D G | 909 D G | 990 D G | 995 D G | Qty. |
|-----|-----------------------------|------------|-----------------|---------------|---------------|---------------|---------------|------|
| 1 | SCREW - hex, 12-24 x 3/4 | 80867 | | | | | * 3 | |
| 2 | COVER - starter | A-59494-1 | | | | | * 1 | |
| 3 | Includes: BUSHING | 59313 | | | | | * 1 | |
| 2A | COVER - pulley | AA-73234-1 | * | * | * | * | * 1 | |
| 4 | ROPE - starter | 55898 | * | * | * | * | * 1 | |
| 5 | GRIP - rope | 55937 | * | * | * | * | * 1 | |
| 6 | INSERT - rope retaining | 58517 | † | † | † | † | * 1 | |
| 7 | SPRING - rewind | 58428-A | | | | | * 1 | |
| 7A | | 56497 | * | * | * | * | * 1 | |
| 8 | WASHER - thrust | 58412 | | | | | * 1 | |
| 9 | LOCK - spring rewind | 58009 | | | | | * 1 | |
| 10 | PULLEY - starter | A-59495 | | | | | * 1 | |
| 11 | Includes: BUSHING | 58007 | | | | | | |
| 10A | PULLEY | 55597-2 | * | * | * | * | * 1 | |
| 12 | WASHER - thrust | 58413 | | | | | * 1 | |
| 13 | SCREW - socket, 10-32 x 3/8 | 80878 | | | | | * 1 | |
| 14 | BEARING - overrunning | 58480 | | | | | * 1 | |
| 15 | NUT - 7/16-20 | 81191 | | | | | * 1 | |
| 15A | jam 7/16-20 | 81110 | * | * | * | * | * 1 | |
| 16 | WASHER - lock, 7/16 | 83019 | * | * | * | * | * 1 | |
| 17 | RACE - inner | 58268 | | | | | * 1 | |
| 18 | BALL DRIVE - #19 thru #31 | A-56899 | † | * | * | * | * 1 | |
| 19 | Includes: PLATE - ball | 71463-C | * | * | * | * | * 1 | |
| 20 | BALL | 30355-1 | * | * | * | * | * 3 | |
| 21 | RACE - inner | 74221 | * | * | * | * | * 2 | |
| 22 | RATCHET & BEARING | AA-72306-1 | * | * | * | * | * 1 | |
| 22 | Includes: SEAL | 71597 | * | * | * | * | * 2 | |
| 23 | BEARING - needle | 71596 | * | * | * | * | * 2 | |
| 24 | WICK - felt | 71595 | * | * | * | * | * 1 | |
| 25 | RATCHET | AA-73549 | * | * | * | * | * 1 | |
| 26 | Includes: WASHER - fibre | 73525 | * | * | * | * | * 1 | |
| 27 | RETAINER - ball | 71570-B | * | * | * | * | * 1 | |
| 28 | SCREW - flat, 5-40 x 5/16 | 80464 | * | * | * | * | * 3 | |
| 29 | CUP - sealing | 56896 | * | * | * | * | * 1 | |
| 30 | HUB - ratchet w/pin | A-57098 | † | * | * | * | * 1 | |
| 31 | Includes: SCREW - hub | 72295-A | * | * | * | * | * 1 | |
| 32 | SCREW - fil., 6-32 x 3/4 | 80475 | * | * | * | * | * 4 | |
| 33 | WASHER - lock, #6 | 83004 | * | * | * | * | * 4 | |
| 34 | SHIM - pulley | 71588 | * | * | * | * | * 1+ | |
| 35 | COVER - spring | 71603 | * | * | * | * | * 1 | |
| 36 | SCREW - pan, 10-32 x 3/8 | 80579 | * | * | * | * | * 8 | |
| 37 | SCREEN & BRACKET | A-56302 | * | * | * | * | * 1 | |
| 38 | Includes: BRACKET w/bush'g. | A-56304 | * | * | * | * | * 1 | |
| 39 | SCREW - pan, 10-32 x 9/16 | 80576 | * | * | * | * | * 7 | |
| 40 | WASHER - flat, alum. 7/16 | 84055 | * | * | * | * | * 1 | |
| 41 | WASHER - thrust | 55652 | * | * | * | * | * 2 | |
| 42 | SCREW - pan, 10-32 x 3/4 | 80583 | | | | | * 4 | |
| 43 | RING - mounting | 58048-A | | | | | * 1 | |
| 44 | SCREEN - rotary | 58003 | | | | | * 1 | |
| 45 | PIN - dowel, race - rotor | 58429 | | | | | * 1 | |

| No. | Description | Part No. | 9 -23 -26 | 900 D G | 909 D G | 990 D G | 995 D G | Qty. |
|-----|----------------------------------|-----------|-----------------|---------------|---------------|---------------|---------------|------|
| 46 | SCREW - pan, 8-32 x 3/8 | 80577 | * | * | * | * | * 2 | |
| 47 | SHIELD - cylinder | A-57155 | † | * | * | * | * 1 | |
| 48 | Includes: COVER - plug | 56873-A | † | * | * | * | * 1 | |
| 49 | SWITCH - toggle | A-57650-2 | † | † | | | | 1 |
| | Also Fig. 3 | | | | | | | |
| 50 | PLATE - "On-Off" | 72085-A | * | * | | | | 1 |
| 51 | HOUSING - fan (shroud) | A-56912 | † | * | * | * | * 1 | |
| 52 | Includes: PLUG - button | 55681 | | | * | * | * 1 | |
| 53 | BUMPER | 56298 | * | * | * | * | * 2 | |
| 54 | PLUG - button | 56913 | * | * | * | * | * 1 | |
| 55 | WASHER - lock, 1/4 | 83074 | * | * | * | * | * 3 | |
| 56 | SCREW - Pan, 1/4-20 x 5/8 | 80173 | * | * | * | * | * 3 | |
| 57 | TERMINAL - spark plug | A-55373-A | * | * | * | * | * 1 | |
| 58 | LEAD - ground w/term., cover | A-57720 | | | * | * | * 1 | |
| 58A | ground w/term. | 56900 | * | * | * | * | * 1 | |
| 59 | SLEEVE - insulating | 56294-A | * | * | * | * | * 1 | |
| 60 | LEAD - high tension | 55235-A | * | * | * | * | * 1 | |
| 61 | GROMMET | 71671 | * | * | * | * | * 1 | |
| 62 | ROTOR | 56276-B | † | † | † | † | * 1 | |
| 63 | CLIP - cover clamp | 55980 | * | * | * | * | * 1 | |
| 64 | COVER - dust | 55979 | * | * | * | * | * 1 | |
| 65 | GASKET - cover | 55978-2 | * | * | * | * | * 1 | |
| 66 | SCREW - fil., 10-24 x 7/8 | 80660 | * | * | * | * | * 2 | |
| 67 | WASHER - lock, #10 | 83046 | * | * | * | * | * 3 | |
| 68 | SCREW - flat, 6-32 x 5/16 | 80598 | * | * | * | * | * 2 | |
| 69 | CLAMP - lead | 56250 | * | * | * | * | * 1 | |
| 70 | SCREW - fil., 10-24 x 1/2 | 80595 | * | * | * | * | * 1 | |
| 71 | BOX - breaker w/core | 57744 | † | † | * | * | * 1 | |
| 72 | COIL - w/terminal | 55986-A | † | † | † | * | * 1 | |
| 73 | POINTS - set w/pivot pin & #74 | A-58165 | † | † | * | * | * 1 | |
| | | A-55971 | * | * | | | | 1 |
| 74 | WIPER - felt | 55984 | * | * | * | * | * 1 | |
| 75 | CONDENSER - w/lead, term. | 55987 | * | * | * | * | * 1 | |
| 76 | SCREW GROUP - condenser | 57750 | † | † | * | * | * 1 | |
| 77 | NUT - terminal | 55982 | * | * | * | * | * 1 | |
| 78 | WASHER - terminal | 55983 | * | * | * | * | * 1 | |
| 79 | TAB - ground | 57733 | | | | * | * 1 | |
| 80 | SCREW GROUP - points | 57749 | † | † | * | * | * 1 | |
| 81 | SEAL - felt | 56292-A | † | † | * | * | * 1 | |
| 82 | PLATE - back | A-57845 | † | † | * | * | * 1 | |
| 83 | Includes: SEAL | 56134 | * | * | * | * | * 1 | |
| 84 | BEARING - needle | 56255 | * | * | * | * | * 1 | |
| 85 | GASKET - back plate | 56278 | * | * | * | * | * 1 | |
| 86 | KEY - rotor | 75078 | * | * | * | * | * 1 | |
| 87 | GOVERNOR ASSEMBLY | A-56272 | * | * | * | * | * 1 | |
| 88 | SPRING - governor | 58058 | † | † | † | * | * 1 | |
| 89 | SCREW - pan, 8-32 x 5/16 | 80629 | * | * | * | * | * 2 | |
| 90 | ROD - governor to throttle lever | 56246 | * | * | * | * | * 1 | |

HOMELITE CHAIN SAWS

Parts used in each model are indicated by an asterisk (*) in the corresponding model column. A dagger (†) denotes a service replacement part that may require adaptation for use in early models; refer to NOTES, circled numerals, on page 10.

No.

| No. | Description | Part No. | 9 -23 -26 | 900 D G | 909 D G | 990 D G | 995 D G | Qty. |
|-----|--|------------------|-----------------|---------------|---------------|---------------|---------------|--------|
| 1 | HOLDER - air filter (adapter) Includes: PLATE - (not shown) ⑧ | A-57714 | | | * | * | * | 1 |
| 1A | HOLDER - air filter (case) | A-56347 | * | * | | | | 1 |
| 2 | SCREW - flat, 10-32 x 5/8 | 80035 | | | * | * | * | 2 |
| 2A | NUT - wing | 81129 | * | * | | | | 2 |
| 3 | FILTER ELEMENT | 57599-A | | | * | * | * | 1 |
| 3A | optional (not shown) ⑧ | 56526-C 57176 | * | * | | | | 1 1 |
| 4 | CAP - filter | A-57727 | | | * | * | * | 1 |
| 4A | w/#5 | A-56351 | * | * | | | | 1 |
| 5 | GASKET - part of #4A | 56352 | * | * | | | | 1 |
| 6 | SHROUD - cylinder w/#7 ⑨ | A-57156 | † | * | * | * | * | 1 |
| 7 | BUMPER - rubber | 56298 | * | * | * | * | * | 4 |
| 8 | NUT - mounting w/insert | A-56521 | * | * | * | * | * | 1 |
| 9 | PLUG - button | 74099-1 | * | * | * | * | * | 2 |
| 10 | RING - snap | 56522 | * | * | * | * | * | 1 |
| 11 | BRACKET - air filter | A-57793 | | | * | * | * | 1 |
| 12 | GASKET | 56280 | * | * | * | * | * | 1 |
| 13 | NUT - lock, 10-32 | 81109 | | | * | * | * | 2 |
| 14 | SCREW - hex, 1/4-20 x 13/16 | 80573 | * | * | * | * | * | 10 |
| 15 | LEAD - ground | A-57720 | | | * | * | * | 1 |
| 16 | SHAFT & LEVER - oiler | A-56358 | * | * | * | * | * | 1 |
| 17 | COVER - grip | A-56345 | * | * | * | * | * | 1 |
| 18 | Includes: LOCK - throttle | AA-55282 | * | * | * | * | * | 1 |
| 19 | Includes: SPRING | 72970 | * | * | * | * | * | 1 |
| 20 | SCREW - pan, 8-32 x 1/2 | 80560 | * | * | * | * | * | 1 |
| 21 | TRIGGER - throttle | A-56343 | * | * | * | * | * | 1 |
| 22 | SPRING - trigger | 55045-A | * | * | * | * | * | 1 |
| 23 | HANDLE - throttle w/bushings ⑨ | A-57724 | † | † | * | * | * | 1 |
| 24 | SWITCH - toggle | A-57716 | | | * | * | * | 1 |
| 25 | Includes: PLATE - "on-off" | 55879 | | | * | * | * | 1 |
| 26 | SCREW - pan, 10-32 x 1 | 80624 | * | * | * | * | * | 2 |
| 27 | LEVER - choke | 56241 | * | * | * | * | * | 1 |
| 28 | SCREW - lever | 56242 | * | * | * | * | * | 1 |
| 29 | LEVER - oiler | 56227 | * | * | * | * | * | 1 |
| 30 | SCREW - pan, 10-32 x 1/2 | 80625 | * | * | * | * | * | 2 |
| 31 | ARM - throttle | 56105 | * | * | * | * | * | 1 |
| 32 | SCREW - set (cup point) | 80353 | * | * | * | * | * | 2 |
| 33 | HANDLE BAR ⑩ | A-57868 | † | † | * | * | * | 1 |
| 34 | BRACKET - handle bar (plate) | A-56360 | * | * | * | * | * | 1 |
| 35 | SCREW - socket, 5/16-18 x 1-1/8 ⑩ | 80671 | * | * | * | * | * | 3 |
| 36 | WASHER - flat, 5/16-18 | 56628 | * | * | * | * | * | 2 |
| 37 | CUSHION - handle bar | 56281 | * | * | * | * | * | 2 |

| No. | Description | Part No. | 9 -23 -26 | 900 D G | 909 D G | 990 D G | 995 D G | Qty. |
|-----|--------------------------------|------------|-----------------|---------------|---------------|---------------|---------------|------|
| 38 | CLAMP - handle bar | 56282-A | * | * | * | * | * | 2 |
| 39 | SCREW - hex, 12-24 x 5/8 | 80676 | * | * | * | * | * | 4 |
| 40 | WASHER - fiber ⑪ | 25304 | † | † | * | * | * | 2 |
| 41 | SCREW - fil., 1/4-20 x 1-1/8 ⑪ | 80161 | † | † | * | * | * | 2 |
| 41A | STUD ⑪ | 55945 | * | * | * | * | * | 2 |
| 42 | GASKET - spacer | 56279 | * | * | * | * | * | 1 |
| 43 | SPACER - reed adapter ⑪ | 56075-1B | † | † | † | † | † | 1 |
| 44 | GASKET - reed adapter | 55946 | * | * | * | * | * | 1 |
| 45 | REED | 55941-1 | * | * | * | * | * | 4 |
| 46 | SCREW - pan, 4-40 x 3/16 | 80658 | * | * | * | * | * | 8 |
| 47 | PLATE - reed | 55942 | * | * | * | * | * | 4 |
| 48 | SEAT - reed adapter ⑪ | 55932-2 | † | * | * | * | * | 1 |
| 49 | GASKET - carburetor | 55553-1 | * | * | * | * | * | 1 |
| 50 | WASHER - lock, 1/4 | 83009 | * | * | * | * | * | 2 |
| 51 | NUT - 1/4-20 | 81013-1 | * | * | * | * | * | 2 |
| 52 | CARBURETOR ⑫ | A-57806 | † | † | † | † | † | 1 |
| 53 | "O" RING ⑫ | 57938 | † | † | † | † | † | 1 |
| 54 | SCREW - pan, 10-32 x 1-1/16 ⑪ | 80743 | † | * | * | * | * | 4 |
| | pan, 10-32 x 3/4 ⑪ | 80583 | * | * | * | * | * | 4 |
| 55 | LINE - fuel ⑫ | 55680 | † | † | * | * | * | 1 |
| 56 | SPRING - fuel line ⑫ | 57915 | † | † | * | * | * | 1 |
| 57 | SCREW - pan, 8-32 x 5/16 | 80605 | * | * | * | * | * | 4 |
| 58 | FITTING - fuel outlet | A-56650 | * | * | * | * | * | 1 |
| 59 | GASKET - fitting | 56333 | * | * | * | * | * | 1 |
| 60 | LINE - flexible sleeve | 55805 | * | * | * | * | * | 1 |
| 61 | BUTTON & ROD - pump | 71764 | * | * | * | * | * | 1 |
| 62 | PLUNGER - pump | A-74406 | * | * | * | * | * | 1 |
| 63 | Includes: "O" RING | 74388 | * | * | * | * | * | 1 |
| 64 | SPRING - plunger | 71762 | * | * | * | * | * | 1 |
| 65 | CAP - oil filler | A-56330 | * | * | * | * | * | 1 |
| 66 | Includes: GASKET | 72280 | * | * | * | * | * | 1 |
| 67 | CAP - check valve | AA-55167 | * | * | * | * | * | 1 |
| 68 | GASKET | 55107 | * | * | * | * | * | 1 |
| 69 | SPRING - check valve | 55288-A | * | * | * | * | * | 1 |
| 70 | BALL - check 5/32 | 25527 | * | * | * | * | * | 1 |
| 71 | SEAT - check valve | 55109-A | * | * | * | * | * | 1 |
| 72 | GASKET | 55110 | * | * | * | * | * | 1 |
| 73 | LINE - oil filter | 56262 | * | * | * | * | * | 1 |
| 74 | FILTER - oil | AA-55259-A | * | * | * | * | * | 1 |
| 75 | VALVE - check | A-55824 | * | * | * | * | * | 1 |
| 76 | CAP - filler ⑬ | A-56907 | † | * | * | * | * | 1 |
| 77 | Includes: VALVE - relief ⑬ | 56865 | † | * | * | * | * | 1 |
| 78 | GASKET | 56335 | * | * | * | * | * | 1 |
| 79 | TANK - fuel | A-56328 | * | * | * | * | * | 1 |
| 80 | FILTER ASSEMBLY ⑬ | A-59251 | † | † | † | † | † | 1 |
| 81 | Includes: FILTER - element ⑬ | 59253 | † | † | † | † | † | 1 |

TOOLS

| Part No. | Description |
|----------|------------------------------------|
| 22808 | COMBINATION WRENCH |
| A-22224 | KEY - torque wrench (ball drive) |
| 22221 | WRENCH - socket screw (ball drive) |
| A-23679 | REMOVER - overrunning bearing |
| 23678 | PLUG - overrunning bearing |
| A-22560 | PULLER - rotor |
| 23391 | PLUG - backplate bearing & seal |
| 23233 | PLUG - backplate seal (in) |
| A-23131 | PULLER - clutch spider (keyway) |
| A-23696 | WRENCH - clutch spider (threaded) |
| 23420 | PLUG - clutch drum bearing |
| 23389 | PLUG - sprocket bearing & seal |

| Part No. | Description |
|----------|-----------------------------------|
| 23390 | SLEEVE - sprocket seal |
| 22726 | PLIERS - sprocket shaft snap ring |
| A-23137 | JACKSCREW - crankshaft & bearing |
| 23373 | COLLAR - crankshaft & bearing |
| 23136 | SLEEVE - crankshaft |
| 23382 | SPACER - crankshaft |
| 23383 | PLATE - shaft aligning |
| 23384 | PLUG - crankcase seal |
| 23422 | SLEEVE - crankcase seal |
| 22126 | WRENCH - socket screw (rod) |
| 23372 | PLUG - piston pin bearing |
| 22828 | PLIERS - piston snap ring |

HOMELITE CHAIN SAWS

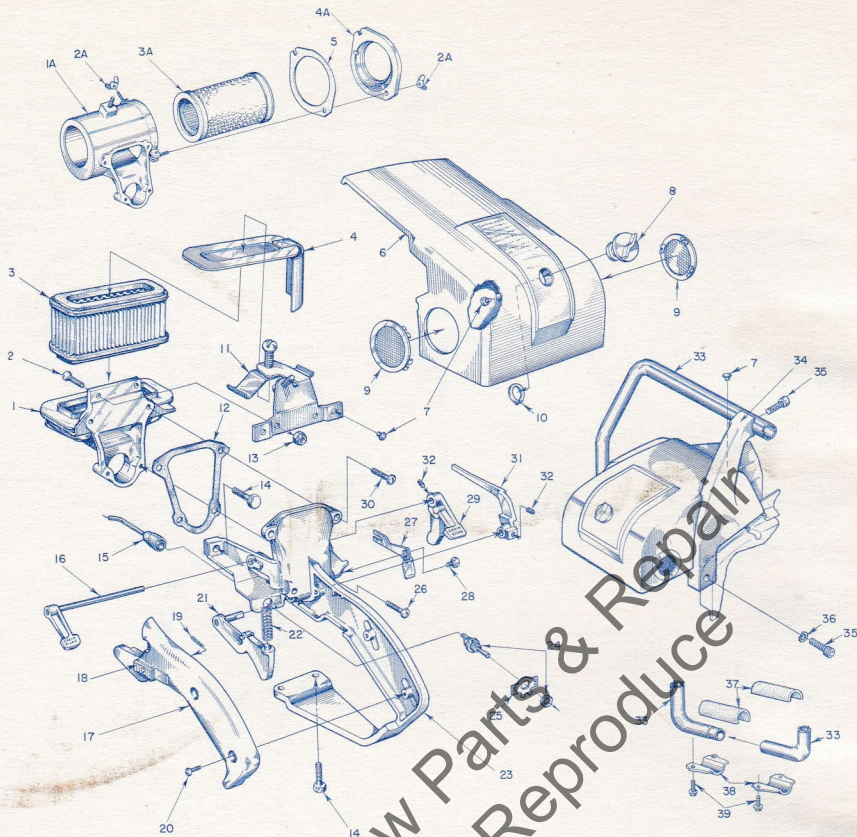

FIGURE 3

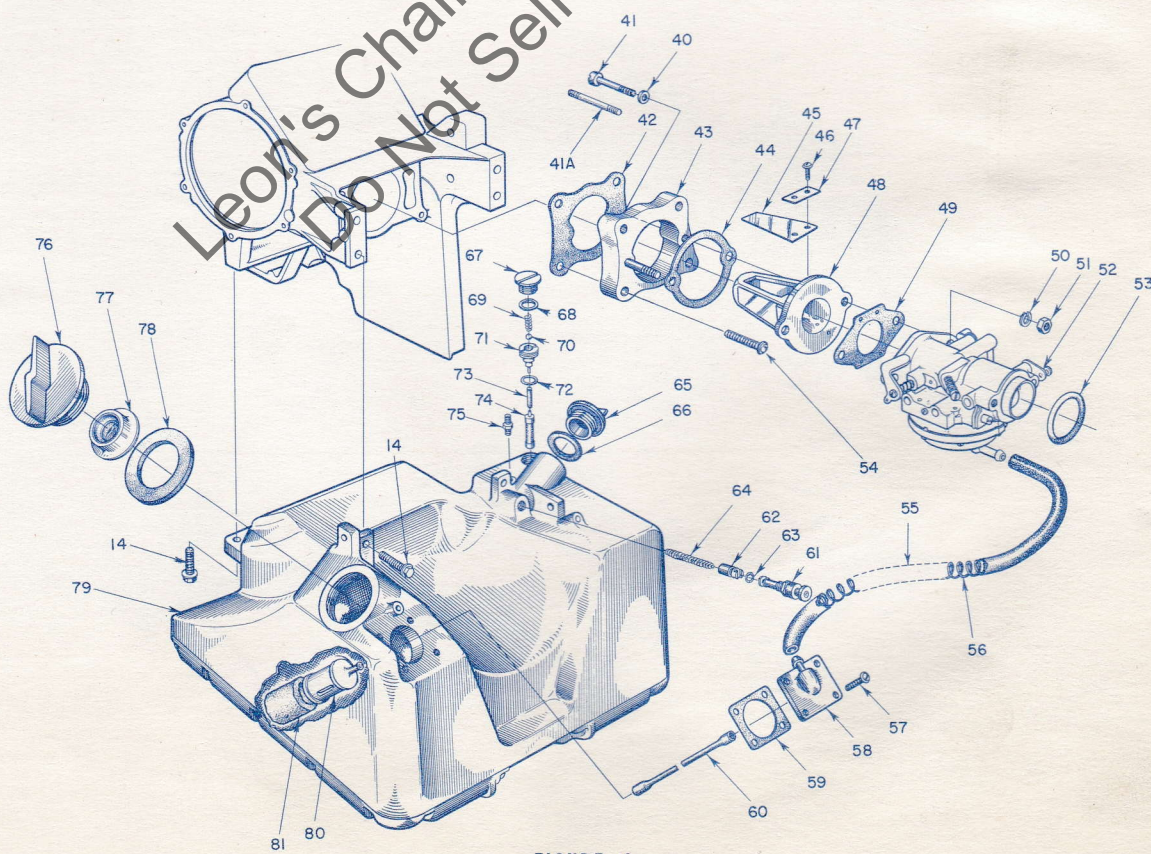

FIGURE 4

ALWAYS FURNISH MODEL AND SERIAL NUMBER WHEN ORDERING PARTS.

HOMELITE CHAIN SAWS

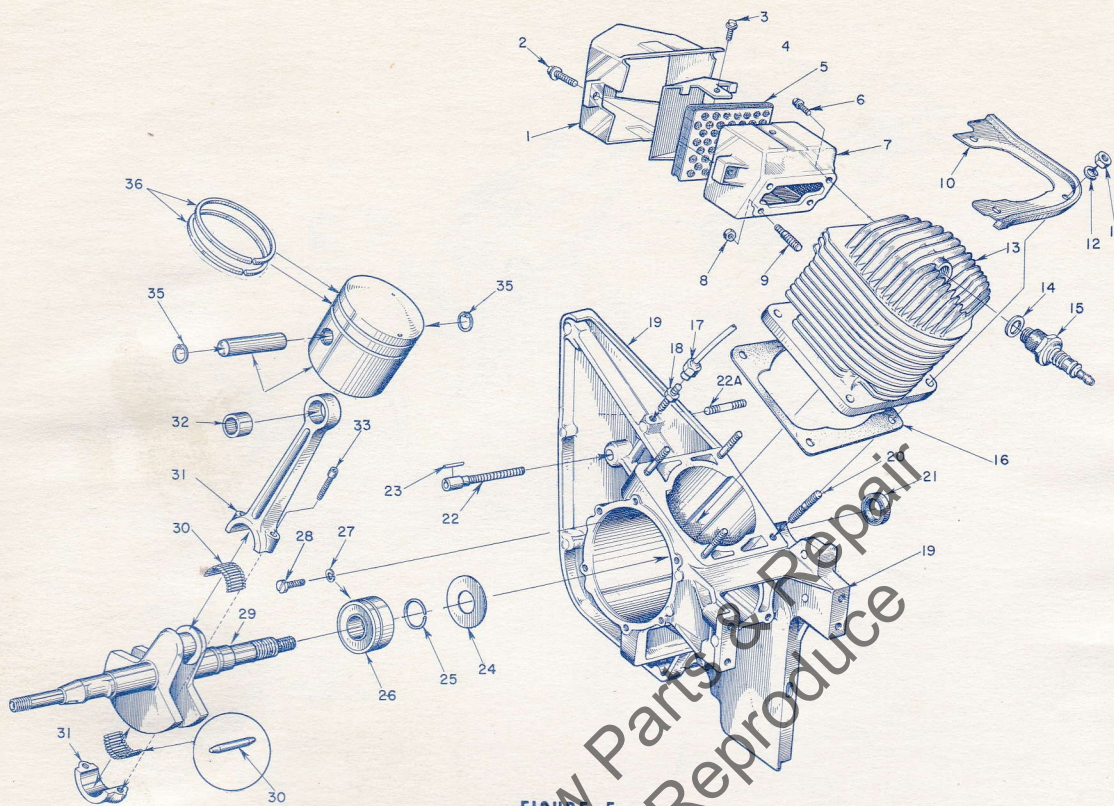

FIGURE 5
Direct Drive

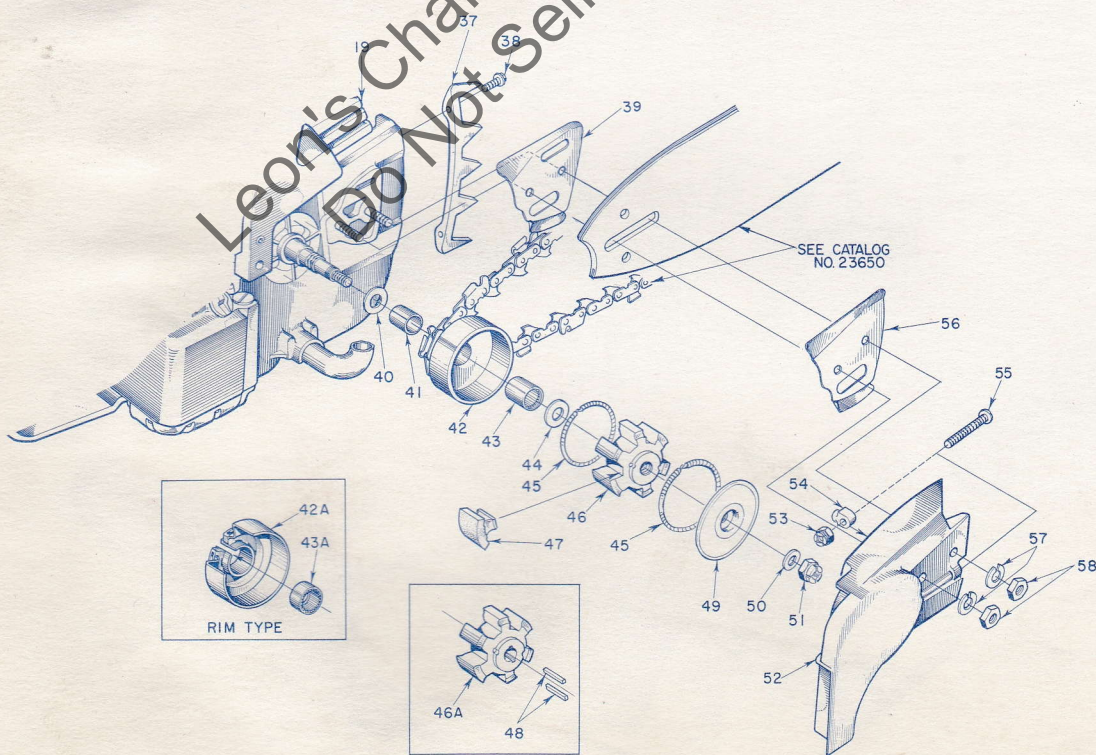

FIGURE 6
Direct Drive

ALWAYS FURNISH MODEL AND SERIAL NUMBER WHEN ORDERING PARTS.

HOMELITE CHAIN SAWS

Parts used in each model are indicated by an asterisk (*) in the corresponding model column. A dagger (†) denotes a service replacement part that may require adaptation for use in early models; refer to NOTES, circled numerals, on page 10.

DIRECT DRIVE MODELS
See pages 8 and 9 for Gear Drive Models

| No. | Description | Part No. | 9 -23 | 900 D | 909 D | 990 D | 995 D | Qty. |
|-----|--|--------------|----------|----------|----------|----------|----------|------|
| 1 | DAMPER - heat | 14 A-59463 | / | / | / | / | * | 1 |
| 2 | SCREW - hex, 1/4-20 x 11/16 | 80677 | / | / | * | * | * | 2 |
| 3 | CAP - exhaust | 14 57369 | / | / | * | * | * | 1 |
| 4 | SCREW - hex, 10-32 x 9/16 | 80825 | / | / | * | * | * | 2 |
| 5 | ELEMENT - muffler | A-57598 | / | / | * | * | * | 1 |
| 6 | SCREW - hex, 12-24 x 11/16 | 80751 | / | / | * | * | * | 2 |
| 7 | BODY - muffler | 56794 | / | / | * | * | * | 1 |
| 8 | NUT - lock, 1/4-20 | 14 81108 | / | / | * | * | * | 2 |
| 9 | STUD | 57349 | / | / | * | * | * | 2 |
| 10 | SHIELD - saw dust | 15 A-56914-B | / | * | * | * | * | 1 |
| 11 | NUT - 5/16-24 1/4-20 | 16 25412 | / | / | * | * | * | 4 |
| 12 | WASHER - lock, 5/16 1/4 | 16 83042 | / | / | * | * | * | 4 |
| 13 | CYLINDER - 2-5/16 bore 2-3/16 bore | 16 A-58289 | / | / | / | / | * | 1 |
| 14 | SPARK PLUG | A-56832 | * | * | * | * | * | 1 |
| 15 | Includes: GASKET | 25038 | * | * | * | * | * | 1 |
| 16 | GASKET - cylinder 2-5/16 I. D. 2-3/16 I. D. | 16 56875-A | / | * | * | * | * | 1 |
| 17 | LINE - oil | A-56336 | * | * | * | * | * | 1 |
| 18 | FITTING - tube | 31733-1 | * | * | * | * | * | 1 |
| 19 | CRANKCASE - service | 16 A-57089-A | / | * | * | * | * | 1 |
| 20 | Includes: STUD - 5/16-18 1/4-28 | 16 72787 | / | / | / | / | * | 4 |
| 21 | SEAL | 56256 | * | * | * | * | * | 1 |
| 22 | BOLT - bar | 16 57175 | / | / | / | / | * | 2 |
| 22A | STUD - bar | 16 55623 | * | * | * | * | * | 2 |
| 23 | PIN - bolt | 16 41738 | / | / | * | * | * | 2 |
| 24 | GASKET - crankcase | 56258 | * | * | * | * | * | 1 |
| 25 | RING - retaining | 56259 | * | * | * | * | * | 1 |
| 26 | BEARING - main | 56261-S | * | * | * | * | * | 1 |
| 27 | WASHER - lock, 1/4 | 83061 | * | * | * | * | * | 2 |
| 28 | SCREW - bearing | 19335-A | * | * | * | * | * | 2 |
| 29 | CRANK SHAFT - threaded threaded keyway keyway | 17 56650 | / | / | / | / | * | 1 |
| | | 56897 | / | / | / | / | * | 1 |
| | | discont'd | | | * | * | * | 1 |
| | | 56050-B | * | * | * | * | * | 1 |
| 30 | BEARING - set 31 needles | AA-72200 | * | * | * | * | * | 1 |
| 31 | ROD - connecting | 17 A-58262-A | / | / | / | * | * | 1 |

| No. | Description | Part No. | 9 -23 | 900 D | 909 D | 990 D | 995 D | Qty. |
|-----|---|--------------|----------|----------|----------|----------|----------|------|
| 32 | Includes: BEARING - pin | 71167 | * | * | * | * | * | 1 |
| 33 | SCREW - socket | 17 58095 | * | * | * | * | * | 2 |
| 34 | PISTON & PIN - 2-5/16 bore 2-3/16 bore | 18 A-57090 | * | * | * | * | * | 1 |
| | | A-56647 | * | * | * | * | * | 1 |
| 35 | Includes: RING - retaining | 56290 | * | * | * | * | * | 2 |
| 36 | PISTON RING - 2-5/16 bore 2-3/16 bore | 56828 | * | * | * | * | * | 2 |
| | | 56291 | * | * | * | * | * | 2 |
| 37 | BUMPER - spiked | NOTE 1 55632 | * | * | * | * | * | 1 |
| 38 | SCREW - hex, 1/4-20 x 1-3/16 | 80573 | * | * | * | * | * | 2 |
| 39 | PLATE - guide bar (inner) | 19 56871-A | / | * | * | * | * | 1 |
| 40 | WASHER - thrust (inner) | 56236 | * | * | * | * | * | 1 |
| 41 | RACE - inner | 56231 | * | * | * | * | * | 1 |
| 42 | SPROCKET & DRUM - NOTE 2 OPEN type - 7 tooth, 1/2 pitch | A-56615 | * | * | * | * | * | 1 |
| 43 | Includes: BEARING | A-56299 | / | / | / | / | / | 1 |
| 42A | SPROCKET & DRUM - NOTE 2 RIM type - 7 tooth, 7/16 pitch | 56230 | * | * | * | * | * | 1 |
| 44 | Includes: BEARING | A-57364-A | / | / | / | / | / | 1 |
| 44A | Includes: BEARING | A-57341 | / | / | / | / | / | 1 |
| 44 | WASHER - thrust (outer) | 77442 | * | * | * | * | * | 1 |
| 45 | SPRING - clutch | 56132 | * | * | * | * | * | 2 |
| 46 | SHOE - clutch | 20 55123-C | * | * | * | * | * | 2 |
| 47 | SPIDER - clutch (threaded) (Keyway) | 20 55076-1A | * | * | * | * | * | 6 |
| 47A | KEY - spider | 20 58546-2 | / | / | / | / | * | 1 |
| 48 | COVER - clutch | 20 55075-3A | * | * | * | * | * | 1 |
| 49 | WASHER - clutch | 55225-1A | * | * | * | * | * | 2 |
| 50 | NUT - lock, 3/8-24 | 20 56238-A | / | * | * | * | * | 1 |
| 51 | COVER - drive case | 21 81192 | * | * | * | * | * | 1 |
| 52 | Includes: NUT - lock, 3/16-18 PIN - guide bar | 81123 | * | * | * | * | * | 1 |
| 53 | SCREW - rd., 5/16-18 x 2 | 55613 | * | * | * | * | * | 1 |
| 54 | PLATE - guide bar (outer) | 80617 | * | * | * | * | * | 1 |
| 55 | WASHER - lock, 3/8 | 19 56872-B | / | * | * | * | * | 1 |
| 56 | NUT - hex, 3/8-16 | 83018 | * | * | * | * | * | 2 |
| 57 | | 81089-2 | * | * | * | * | * | 2 |

NOTE 1: Spiked Bumper #55632 supplied with some models and is an available accessory for other models.

NOTE 2: The OPEN type, 7 tooth, 1/2 pitch SPROCKET & DRUM is standard, check type and number of teeth on sprocket before ordering replacement.

HOMELITE CHAIN SAWS

Parts used in each model are indicated by an asterisk (*) in the corresponding model column. A dagger (†) denotes a service replacement part that may require adaptation for use in early models: refer to NOTES, circled numerals, on page 10.

GEAR DRIVE MODELS

See pages 6 and 7 for Direct Drive Models

| No. | Description | Part No. | 9 26 | 900 G | 909 G | 990 G | 995 G | Qty. |
|-----|---|--------------------------------------|---------|----------|----------|----------|-------------|------------------|
| 1 | DAMPER - heat | A-59463 | / | / | / | / | * | 1 |
| 2 | SCREW - hex, 1/4-20 x 11/16 | 80677 | / | / | * | * | * | 2 |
| 3 | CAP - exhaust | 57369 | / | / | * | * | * | 1 |
| 4 | SCREW - hex, 10-32 x 9/16 | 80825 | / | / | * | * | * | 2 |
| 5 | ELEMENT - muffler | A-57598 | / | / | * | * | * | 1 |
| 6 | SCREW - hex, 12-24 x 11/16 | 80751 | / | / | * | * | * | 2 |
| 7 | BODY - muffler | 56794 | / | / | * | * | * | 1 |
| 8 | NUT - lock, 1/4-20 | 81108 | / | / | * | * | * | 2 |
| 9 | STUD | 57349 | / | / | * | * | * | 2 |
| 10 | SHIELD - saw dust | A-56914-B | / | * | * | * | * | 1 |
| 11 | NUT - 5/16-24 1/4-20 | 25412 81065-2 | / | / | / | * | * | 4 4 |
| 12 | WASHER - lock, 5/16 1/4 | 83042 83009 | / | / | / | * | * | 4 4 |
| 13 | CYLINDER - 2-5/16 bore 2-3/16 bore | A-58289 A-56832 | / | / | / | / | * | 1 1 |
| 14 | SPARK PLUG | 72858-2S | * | * | * | * | * | 1 |
| 15 | Includes: GASKET | 25038 | * | * | * | * | * | 1 |
| 16 | GASKET - cylinder 2-5/16 I. D. 2-3/16 I. D. | 56875-A 56277 | / | * | * | * | * | 1 1 |
| 17 | CRANKCASE - service | A-57846-A | / | / | / | * | * | 1 |
| 18 | Includes: SEAL | 56256 | * | * | * | * | * | 2 |
| 19 | STUD - 5/16-18 1/4-28 | 72787 55871 | / | / | / | * | * | 4 4 |
| 20 | PIN - bolt | 41738 | / | / | * | * | * | 2 |
| 21 | BOLT - bar | 57175 | / | / | * | * | * | 2 |
| 21A | STUD - 2-1/8 long 1-19/32 long | 57030 55606 | / | * | | | | 2 2 |
| 22 | PLUG - vent line | 57588 | / | / | * | * | * | 1 |
| 23 | PISTON RING - 2-5/16 bore 2-3/16 bore | 56828 56291 | / | * | * | * | * | 2 2 |
| 24 | PISTON & PIN - 2-5/16 bore 2-3/16 bore | A-57090 A-56647 | / | * | * | * | * | 1 1 |
| 25 | Includes: RING - retaining | 56290 | * | * | * | * | * | 2 |
| 26 | ROD - connecting | A-58262-A | / | / | / | * | * | 1 |
| 27 | Includes: SCREW - socket | 58095 | * | * | * | * | * | 1 |
| 28 | BEARING - pin | 71167 | * | * | * | * | * | 1 |
| 29 | BEARING - set 31 needles | AA-72206 | * | * | * | * | * | 1 |
| 30 | CRANKSHAFT - threaded (NOTE 3) threaded Keyway | 59650 58897 discon. 56056-B | § / | / | / | / | † † † | 1 1 1 1 |
| 31 | SCREW - bearing | 19238-A | * | * | * | * | * | 2 |
| 32 | WASHER - lock, 1/4 | 83061 | * | * | * | * | * | 2 |
| 33 | BEARING - main | 56261-S | * | * | * | * | * | 1 |
| 34 | RING - retaining | 56259 | * | * | * | * | * | 1 |
| 35 | GASKET - crankcase | 56258 | * | * | * | * | * | 1 |
| 36 | NUT - hex, 3/8-16 | 81089-2 | * | * | * | * | * | 2 |
| 37 | WASHER - lock | 83018 | * | * | * | * | * | 2 |
| 38 | PLATE - guide bar adjusting Includes: PLATE (only) | A-55591 55551-B | * | * | * | * | * | 1 1 |
| 39 | SCREW - rd. 5/16-18 x 2 | 80617 | * | * | * | * | * | 1 |
| 40 | NUT - lock, 5/16-18 | 81123 | * | * | * | * | * | 1 |
| 41 | PIN - adjusting | 55552 | * | * | * | * | * | 1 |
| 42 | PLATE - guide bar (outer) | 56957-A | / | * | * | * | * | 1 |
| 43 | PLATE - guide bar (inner) | 56956 | / | * | * | * | * | 1 |
| 44 | SCREW | 80573 | * | * | * | * | * | 2 |

| No. | Description | Part No. | 9 26 | 900 G | 909 G | 990 G | 995 G | Qty. |
|-----|--|--|---------|----------|----------|----------|----------|------------------|
| 45 | BUMPER - spiked | NOTE1 55103 | * | * | * | * | * | 1 |
| 46 | LINE - oil | A-56578 | * | * | * | * | * | 1 |
| 47 | FITTING - tube | 31733-1 | * | * | * | * | * | 2 |
| 48 | NUT - lock, 1/2-20 | 81101 | * | * | * | * | * | 1 |
| 49 | SPACER - sprocket (outer) | 73254-A | * | * | * | * | * | 1 |
| 50 | FLANGE - sprocket (outer) | 73253 | * | * | * | * | * | 1 |
| 51 | SPROCKET - NOTE 2 8 tooth, 1/2 pitch 7 tooth, 9/16 pitch | 73252-1 73860-1 | / | / | / | * | * | 1 |
| 52 | KEY - sprocket | 73215-A | * | * | * | * | * | 1 |
| 53 | FLANGE - sprocket (inner) | 73771 | * | * | * | * | * | 1 |
| 54 | SPACER - sprocket (inner) | 56593 | * | * | * | * | * | 1 |
| 55 | CAP - oil filler | A-56580 | * | * | * | * | * | 1 |
| 56 | Includes: GASKET | 56607 | * | * | * | * | * | 1 |
| 57 | BEARING - ball (double) | 56219-S | * | * | * | * | * | 1 |
| 58 | RING - retaining | 28922 | * | * | * | * | * | 3 |
| 59 | GEAR - driven NOTE 3 standard, 71 tooth, 2.84:1 ratio optional, 75 tooth, 3.57:1 ratio | A-56586-A A-56588-A | * | * | * | * | * | 1 1 |
| 60 | LINE - vent | A-56606 | * | * | * | * | * | 1 |
| 61 | SHAFT - sprocket | 56585 | * | * | * | * | * | 1 |
| 62 | SCREW - socket 1/2-28 x 1/2 | 80659 | * | * | * | * | * | 4 |
| 63 | BEARING - ball | 72328-S | * | * | * | * | * | 2 |
| 64 | NUT - stud 1/2-20 | 57768-A | / | / | / | * | * | 1 |
| 65 | GEAR - idler | 57769 | / | / | * | * | * | 1 |
| 65A | w/cage | A-56581-A | * | * | * | * | * | 1 |
| 66 | SCREW - gear cage | 80581 | * | * | * | * | * | 2 |
| 67 | GASKET - gear case cover | 56576 | * | * | * | * | * | 1 |
| 68 | SCREW - pan, 10-32 x 3/4 | 80583 | * | * | * | * | * | 11 |
| 69 | COVER - drive case | A-56699 | * | * | * | * | * | 1 |
| 70 | Includes: "O" RING | 55100 | * | * | * | * | * | 1 |
| 71 | WINDOW | 55099-1 | * | * | * | * | * | 1 |
| 72 | PLATE - window | 55098 | * | * | * | * | * | 1 |
| 73 | SCREW - tap, 6-32 x 3/8 | 80548 | * | * | * | * | * | 3 |
| 74 | NUT - lock, 3/8-24 | 81192 | * | * | * | * | * | 1 |
| 75 | WASHER - clutch | 55036 | * | * | * | * | * | 1 |
| 76 | COVER - clutch, wide narrow | 58023 55126-A | / | / | / | * | * | 1 1 |
| 77 | SPRING - clutch | 55123-C | * | * | * | * | * | 2 |
| 78 | SPIDER - clutch (threaded) wide (keyway) narrow (keyway) | 58547-1 58027 55075-3A | / | / | / | * | * | 1 1 1 |
| 78A | | | | | | | | |
| 79 | SHOE - clutch 3/4 wide narrow | A-58028 A-55692-A | / | / | / | * | * | 6 6 |
| 80 | KEY - clutch spider | 55225-1A | * | * | * | * | * | 2 |
| 81 | WASHER - thrust | 56132 | * | * | * | * | * | 2 |
| 82 | GEAR & DRUM - drive NOTE 3 25 tooth, 2.84:1 ratio (wide) 21 tooth, 3.57:1 ratio (wide) 25 tooth, 2.84:1 ratio (narrow) 21 tooth, 3.57:1 ratio (narrow) | A-58031 A-58030 A-56574 A-56587-A | §† | | | * | * | 1 1 1 1 |
| 83 | BEARING - sleeve (bronze) | 56603 | * | * | * | * | * | 1 |
| 84 | STUD - pivot (idler gear) 1/2-20 | 57770-A | / | / | / | * | * | 1 |

NOTE 1: BUMPER #55103 supplied with some models and is an available accessory for other Gear Drive Models.

NOTE 2: Check pitch and number of teeth on sprocket before ordering replacement.

NOTE 3: Symbols - "§", "†", or "•" - Select correct crankshaft (note symbol), then determine whether unit is equipped with wide (3/4 shoe), or narrow clutch parts; all parts with matching crank shaft symbol will constitute an assembly.

EXAMPLE - Model 9-26 with Crankshaft (w/keyway) #56056-B (†•) and using narrow Clutch Shoe #A-55692-A (•) requires Cover #55126-A (•), Spring #55123-C (§†•), Spider #55075-3A (•), Key #55225-1A (†•), and either Gear & Drum #A-56574 (•) for 2.84:1 ratio or #A-56587-A (•) for 3.57:1 ratio.

GEAR RATIO - Check number of teeth on Driven or Drive gears, and width of clutch shoe before ordering replacements. Location of idler gear above (3.57:1), or below (2.84:1) the crankshaft also identifies gear ratio.

HOMELITE CHAIN SAWS

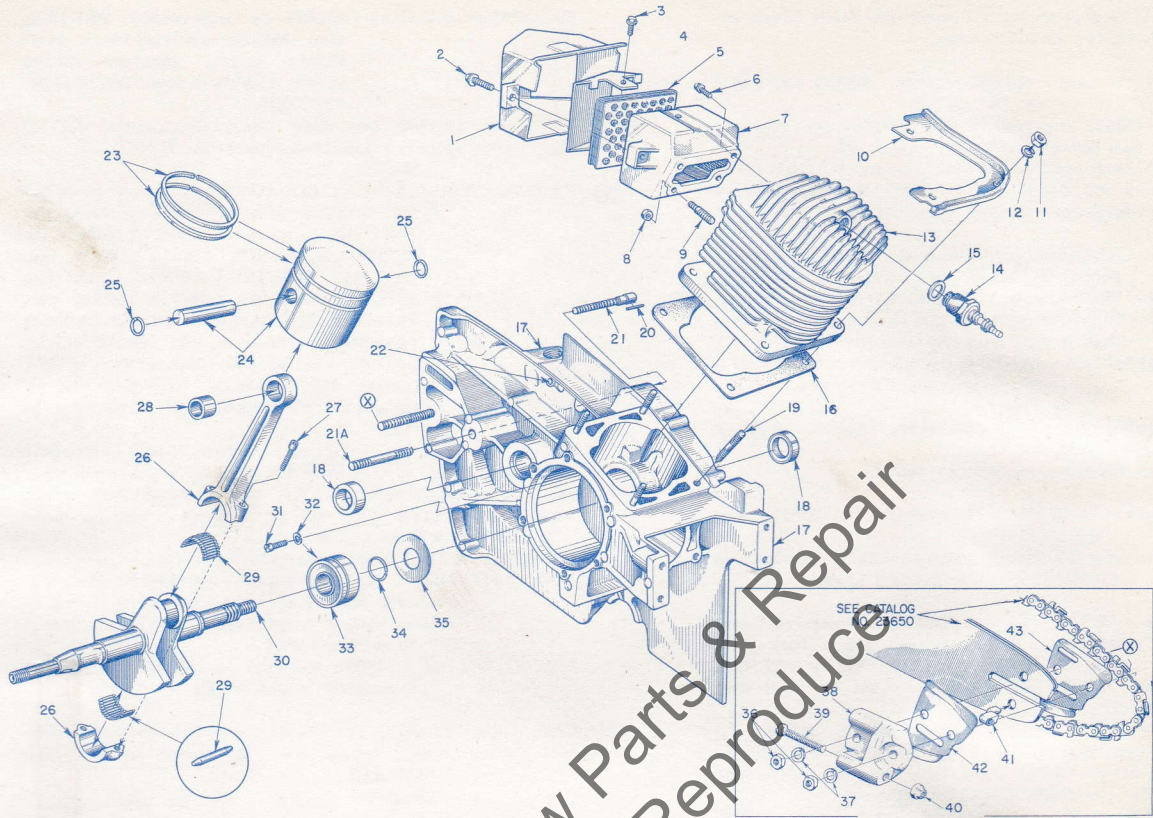

FIGURE 5A
Gear Drive

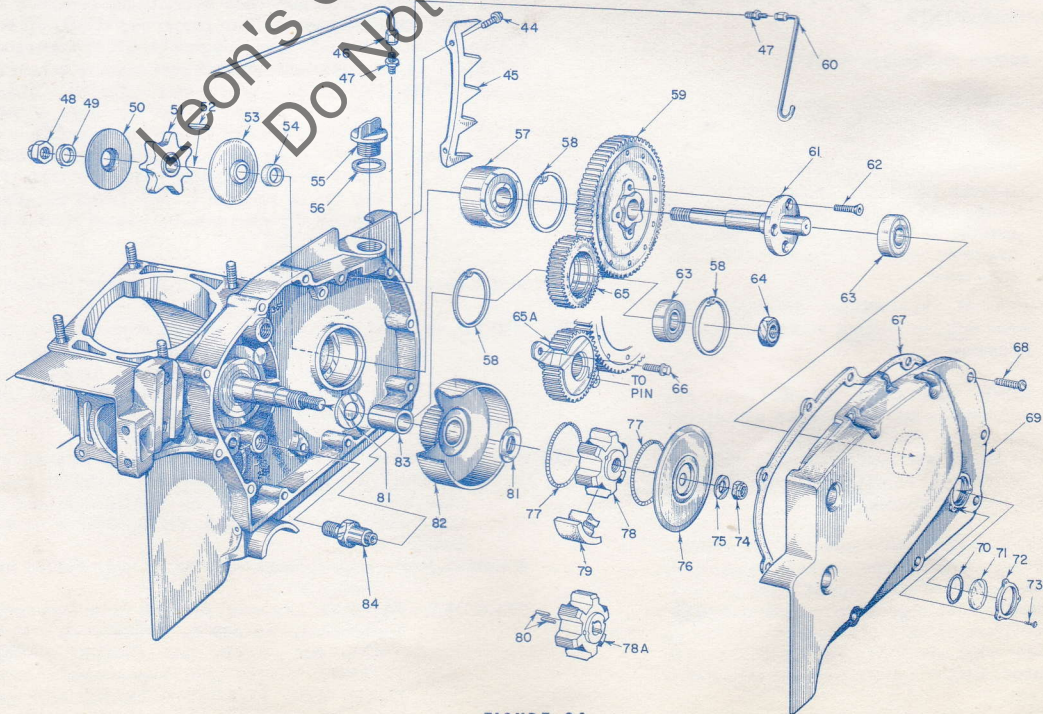

FIGURE 6A
Gear Drive

ALWAYS FURNISH MODEL AND SERIAL NUMBER WHEN ORDERING PARTS.

NOTES

- 1 INSERT - #58517 supersedes assembly #A-56081 which included two #80619 screws.
- 2 BEARING, overrunning - #58480 requires #58429 dowel pin, in 995 models.
PIN, dowel - #58429 required in "995" starter, do not use in Ball Drive Starter. See ROTOR 2.
ROTOR - #56276-B supersedes #56276-A and #56276 has hole added for dowel pin in "995" starter; requires #55986-A Coil. See PIN 2, COIL 6.
- 3 BALL DRIVE - #A-56899, improved with sealing cup, supersedes #A-56493; see CUP and HUB 3.
CUP, sealing - #56896 requires shorter #A-57098 Hub w/pin.
HUB, ratchet - #A-57098 (w/spirol pin) shorter to accommodate sealing cup; with cup supersedes #A-56519.
SCREEN & BRACKET - #A-56302 includes two rivets (#85073) retaining bracket to screen.
- 4 SHIELD, cylinder - #A-57155 supersedes #A-56337 (without cover).
COVER, plug - #56873-A supersedes #56339.
- 5 SWITCH, toggle - #A-57650-2 supersedes #A-55877; see HOUSING 5.
HOUSING, fan - #A-56912 supersedes #A-56297, includes hole for switch position in early models.
- 6 BOX, breaker - #57744 (w/out pivot pin hole) replaces #56293 (w/hole); remove pin in back plate (early models), install #A-58165 POINT SET.
COIL - #55986-A supersedes #55986, must be used with #56276-B ROTOR.
POINTS - #A-58165 (w/pivot pin) supersedes #A-57745, must be used with #A-57845 back plate. See PLATE 6.
#A-55971 (w/out pivot pin) used in early back plate (#A-56648-A) which is discontinued.
SCREW GROUP - #57750 supersedes #55988 screw, #83060 lockwasher, and #84048 flatwasher. #57749 supersedes #55985 screw, #83060 lockwasher, and #84048 flatwasher.
- SEAL, felt - #56292-A supersedes #56292.
PLATE, back - #A-57845 (without point pivot pin) replaces #A-56648-A plate (with pivot pin) which is discontinued, recessed on crankcase side to clear new crankshafts. See POINTS 6, CRANKSHAFT 17.
- 7 SPRING, governor - #58058 supersedes #56747.
- 8 PLATE, filter holder - #57754 available separately, cement to holder with Homelite cement #22788.
FILTER ELEMENT - #57599-A (polyester) supersedes #57599 (paper). #56526"-C" supersedes "-B", "-A", and #A-57032 assembly with gasket. #57176 (fiber glass) optional, available until present stock is exhausted.
- 9 HANDLE, throttle - #A-57724 supersedes #A-56342, fits saws with or without "OFF-ON" switch in handle.
- 10 HANDLE BAR - #A-57868 supersedes #A-56267-A, has enlarged holes for new screws with larger head diameter. See SCREW 11.
SCREW - #80671 now has larger head (15/32"), requires 31/64" counterbored holes in handle bar and bracket. See HANDLE BAR 10.
- 11 WASHER, fiber - #25304 required with spacer screw #80161.
SCREW, spacer - #80161 (with #25304 washer) required in new spacer without tapped holes and with thicker outer edge; see STUD, SPACER 11.
#80743 required in new spacer with thicker outer edge, see SPACER 11. #80583 used in spacer with thin outer edge and tapped stud holes.
STUD, spacer - #55945 used in early spacers #56075 and #56075-1A with tapped holes.

SPACER, reed adapter - #56075-1B supersedes #56075-2, also #56075 and #56075-1A (with tapped holes); requires #80161 screw instead of stud. See SCREW, STUD 11.
REED - #55941-1 (stainless steel) supersedes #55941.
SEAT, reed adapter - #55932-2 supersedes #55932.

- 12 CARBURETOR - #A-57806 (HL-119A) service replacement for original (discontinued) carburetors; refer to Carburetor Sheet #23589, use #57920 Repair Kit, #57919 Gasket Set. #A-58562 (HL-150A) discontinued; use #57920 Repair Kit, #57919 Gasket Set. #A-57429 (HL-62AX) discontinued, includes #A-57012 carburetor and #56630 spring (extra); use #56649 Repair Kit, #57919 Gasket Set. #A-56308 (HL-62A) discontinued; use #56649 Repair Kit, #77342 Gasket Set.

NOTE: All saws with governors require #56630 carburetor throttle friction spring. Any saw without a governor must use #58569 (supersedes #75750) carburetor throttle return spring. HOMELITE does not recommend operating these powerful saws without a governor.

"O" RING - #57938 supersedes #56313 gasket.
LINE, fuel - #55680 (3-1/4") supersedes #56326 (3-7/8"). On early models position tank outlet fitting as shown, install longer fuel line. Spring insert #57915 recommended.
SPRING, fuel line - #57915 inserted in fuel line is recommended. See LINE 12.

- 13 CAP, reed - #A-56307 supersedes #A-56334 (discontinued), reed valves are not interchangeable. See VALVE 13.
VALVE, reed - #56865 required in #A-56907 CAP. #A-55301-C required in #A-56334 CAP.
FILTER ASSEMBLY - #A-59251 supersedes #A-56200, filter elements are not interchangeable. See FILTER 13.
FILTER, element - #59253 used in #A-59251 assembly. #74374 (with #56196 bumper) used in #A-56200 assembly.

- 14 Muffler parts, as illustrated and listed, include an approved spark arrester - recommended service replacements for all models. Discontinued muffler parts: cap #56691-A, body #56164-A, shield #56582-A, and adapter #A-57133 (supersedes #56163-B) will be supplied until present stock is exhausted.
DAMPER, heat - #A-59463 supersedes #56795, directs exhaust toward guide bar side of saw, includes muffler shield. See CAP 14.
CAP, exhaust - #57369 used on all models with #56794 BODY (muffler). Note position of CAP (Fig. 5 & 5A) in relation to new DAMPER. Early damper directed exhaust toward starter side of saw.

NUT - #81108 replaces #81065-2 nut, and #83009 lockwasher.

- 15 SHIELD, saw dust - #A-56914-B (5/16" stud holes) supersedes #A-56914-A; includes notch to clear rib on reinforced cylinder; also supersedes #A-56914 with 1/4" stud holes.

- 16 NUT - #25412 used on larger (5/16") studs supplied with #A-57089-A CRANKCASE (service). Original crankcase supplied with 1/4" studs. See CRANKCASE and CYLINDER 13. SHIELD 15. #81065-2 used on 1/4" studs.

WASHER, lock - #83042 used with 5/16" nut. #83009 used with 1/4" nut.

CYLINDER - #A-58289 (chrome) 2-5/16" bore supersedes #A-58306-1, #A-58306, #A-56874"-B", "-A", "-AT". See STUD and CRANKCASE 13. #A-56832, 2-3/16" bore, supersedes #55918 - NOTE: When #A-57089-B CRANKCASE (service) is installed - larger (2-5/16") CYLINDER, PISTON & PIN, PISTON RINGS, and GASKET may be installed in place of small bore parts.

NOTES

- GASKET - #56875-A (5/16" stud holes) supersedes #56875.
- CRANKCASE - #A-57089-A supersedes #A-57089 and #A-56651 for Direct Drive Models. See CYLINDER, STUD (cylinder & bar), NUT, and BOLT **16**. #A-57846-A (see STUD **24**) supersedes #A-57846 (see STUD **24**) #A-57091 (w/idler PIN), and #A-56652 (w/idler PIN) for Gear Drive Models. See CYLINDER, STUD (cylinder & bar) and BOLT **16**, and GEAR (idler), BEARING, NUT, and STUD (pivot, idler gear) **24**.
- STUD, cylinder - #72787 (5/16") fits #A-57089-A and #A-57846-A CRANKCASES, requires 11/32" cylinder flange holes. Use 5/16" nut. #55871 (1/4") fits early CRANKCASES. Use 1/4" nut.
- BOLT, bar - #57175, with #41738 pin, used in #A-57089-B or #A-57089-A crankcase in Direct Drive Models, and #A-57846-A or #A-57846 crankcase in Gear Drive Models. See STUD (bar) **16**.
- STUD, bar - #55623 used in Direct Drive Crankcase with tapped bar stud holes. See BOLT (bar) **16**. #57030 (2-1/8" long) used in Gear Drive Crankcase #A-57091, measure before ordering. #55606 (1-19/32" long) used in Gear Drive Crankcase #A-56652, measure before ordering.
- PIN, bolt - #41738 required with #57175 BOLT, prevents turning.
- PLUG, vent line - #57588 used in #A-57846-A and #A-57846 Gear Drive Crankcases only, reduces vent line hole.
- 17** CRANKSHAFT - #59650 (for threaded spider) required with new "995" type starter, do not use with Ball Drive Starter. #58897 (for threaded spider) supersedes discontinued #57543-A (for keyed spider) in models with Ball Drive Starter and #A-57845 Back Plate, requires correct threaded spider. See PLATE **19**, SPIDER **20**. #56056-B (for keyed spider) required only when saw includes early type Back Plate. With new #A-57845 Back Plate installed, #58897 crankshaft, and correct threaded spider may be used. See PLATE **19**, SPIDER **20**.
- ROD, connecting - #A-58262-A supersedes #A-58262, and #A-56287.
- SCREW, socket - #58095 supersedes #80806 and #80492.
- 18** PISTON & PIN - #A-57090 (2-5/16") requires #56828 Piston Rings. #56647 (2-6/16") requires #56291 Piston Rings.
- 19** PLATE, guide bar (inner) - #56871-A supersedes #56871 and #55666 on Direct Drive Models. #56956 supersedes #55128 shim (discontinued) on Gear Drive Models.
- PLATE, guide bar (outer) - #56872-B supersedes #56872-A, #56872, and #55667 on Direct Drive Models. #56957-A supersedes #56957 on Gear Drive Models.
- 20** SPRING, clutch - #55123-C supersedes #55123-B in all models.
- SHOE, clutch - #55076-1A (5/8") supersedes #55076-1 in Direct Drive saws. #58028 (3/4") requires wide mating parts in Gear Drive saws; match symbols on page 8. #A-55692-A (5/8") requires narrow mating parts in Gear Drive saws; match symbols on page 8.
- SPIDER, clutch - #58546-2 (5/8") used with threaded crankshafts in Direct Drive Saws. #55075-3A (5/8") used with Keyway crankshafts in all saws but requires mating narrow parts in Gear Drive models; match symbols on page 8. #58547-1 (3/4") used with threaded crankshaft and mating wide parts in Gear Drive saws, match symbols on page 8. #58027 (3/4") used with keyway crankshaft and mating wide parts in Gear Drive saws, match symbols on page 8.
- KEY, spider - #55225-1A used in all saws with keyway crankshafts and spiders, match symbols on page 8.
- COVER, clutch - #56238-A supersedes #56238 in Direct Drive saws. #58023 uses wide mating parts in Gear Drive saws, match symbols on page 8. #55126-A uses narrow mating parts in Gear Drive Saws, match symbols on page 8.
- NUT - #81192 supersedes #81116.
- 21** COVER, drive case - #A-56870-1 supersedes #A-56365 in Direct Drive saws.
- 22** SPROCKET - #73860-1 supersedes #73860 in Gear Drive saws.
- KEY, sprocket - #73215-A supersedes #73215 in Gear Drive saws.
- 23** RING, retaining - #28922 used in all Gear Drive models. New idler gear, bearing, and driven gear assembly requires 3; idler gear with cage assembly requires 1.
- BEARING, ball - #72328-S used in all Gear Drive models. New idler gear, bearing, and driven gear assembly requires 2; idler gear with cage, and driven gear assembly requires 1. See GEAR **23**.
- 24** NUT, stud (idler gear) - #57768-A (1/2-20) required with #57770-A STUD (idler gear) in Gear Drive Crankcase #A-57846-A. #57768 (3/8-24) used with #57770 (discontinued) STUD in Gear Drive Crankcase #A-57846 (discontinued).
- GEAR, idler - #57769 required in #A-57846-A, and #A-57846 (discontinued) Crankcases; mounts on STUD. Cannot be used in discontinued crankcases with 2 idler gear pivot pins. See BEARING **23**.
- NUT, STUD **24**. #A-56581-A (w/cage) required in discontinued crankcases #A-57091 and #A-56652 with 2 idler gear pivot pins. See SCREW **24**.
- SCREW - #80583 required with #A-56581-A Idler Gear w/cage, secures gear cage to crankcase #A-57091 or #A-56652 only. See GEAR **24**.
- STUD, pivot (idler gear) - #57770-A requires #57768-A NUT, supersedes #57770 (discontinued); see NUT **24**. Position above crankshaft for 3.57:1 ratio saw, and below crankshaft for 2.84:1 ratio saw.

MODEL IDENTIFICATION

Direct Drive Models

9-23 From Serial No. 909875
 900D From Serial No. 1055202
 909D From Serial No. 1185248
 990D From Serial No. 1298706
 995D From Serial No. 1717691

Gear Drive Models

9-26 From Serial No. 910411
 900G From Serial No. 1056327
 909G From Serial No. 1185048
 990G From Serial No. 1298138
 995G From Serial No. 1720551

DECAL

#23742 (universal replacement) composed of "DIRECT DRIVE", "GEAR DRIVE", "STARTING INSTRUCTIONS", and two "HOMELITE" (letters 1/4" and 1/2" high).

**You'll
SPEED WORK
and make
MORE MONEY
with...**

HOMELITE

*Leon's Chainsaw Parts & Repair
Do Not Sell or Reproduce*

SELF-PRIMING PUMPS



DEPENDABLE GENERATORS



POWERFUL ONE-MAN CHAIN SAWS



ONE-MAN CONCRETE VIBRATORS



ELECTRIC BUILDER'S HAMMERS



Printed in United States of America.

Part No. 23823

Supersedes: 23369, 23371, 23461,
23554, 23556, 23637, 23639.

126410M

HOMELITE

A **textron** DIVISION

PORT CHESTER, N. Y.

Illustrated in **INSPECTIVE** and
prepared by **PURNELL COMPANY, INC.**
Boston, Mass.