

HOMELITE MODEL 110 CHAINSAW DOUBLE INSULATED TYPE 1

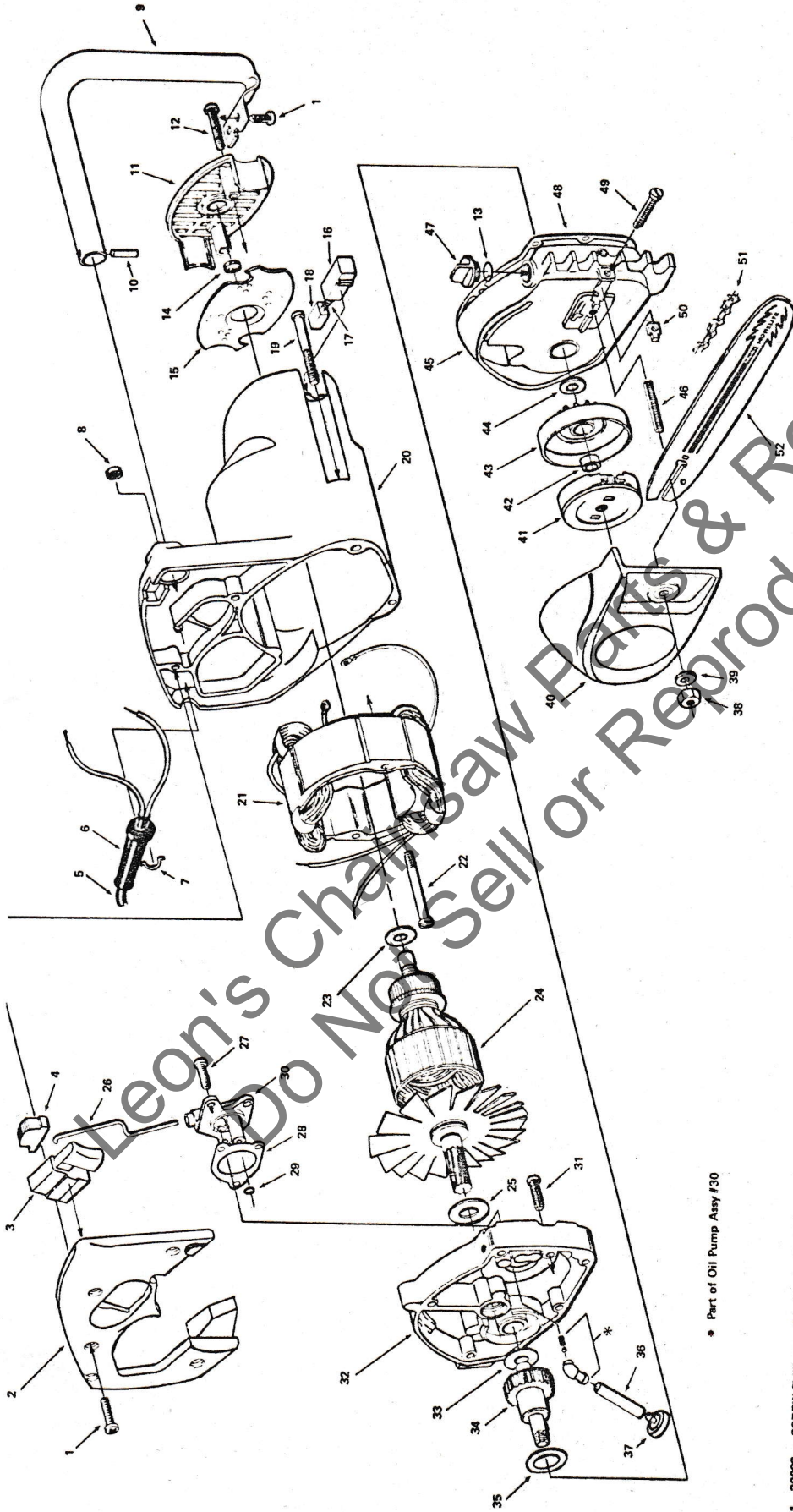

• Part of Oil Pump Assy #30

1	20093	SCREW-Phillips pan hd., Taprite 10-24 x 2-1/2	8	20094	SCREW-Phillips pan hd., HI-LO 11-16 x 5/8	
2	20101	COVER-handle	1	23	20102	WASHER-Bakelite .311 I.D. x 5/8 O.D. x .117 thick
3	20098	SWITCH	1	24	20070	ARMATURE & FAN (115 V.)
4	20074	BUTTON-oiler	1	25	20058	WASHER-Bakelite .511 I.D. x 7/8 O.D. x .062
5	20096	CORD & FLUG	1	26	20075	ROD-oil pump
6	20063	GUARD-cord	1	27	20062	SCREW-Phillips fil. hd., Taprite, 10-24 x 3/8
7	20051	CLAMP-cord	1	28	20083	GASKET-oil pump
8	20100	BUTTON-switch latch-off	1	29	20054	"O" RING
9	20088	HANDLEBAR	1	30	20079	OIL PUMP ASSEMBLY
10	20089	PIN-handlebar	1	31	20061	SCREW-Phillips fil. hd., Taprite, 10-24 x 7/8
11	20072	COVER-end	1	32	20076	PLATE-bearing
12	20069	SCREW-Phillips fil. hd., Taprite, 10-24 x 7/8	2	33	20053	GEAR & SPINDLE ASSEMBLY
13	20104	GASKET (Part of # 47)	1	34	20090	WASHER-flat .380 I.D. x 7/8 O.D. x .032 thick
14	20060	WICK-felt	1	35	20055	WASHER-flat, .004" thick
15	20087	RADIATOR	1	35	20056	WASHER-flat, .010" thick
16	20084	HOLDER-brush	2	35	20057	WASHER-flat, .015" thick
17	20085	SPRING-brush	2	36	20081	TUBE-oil pick-up
18	20086	BRUSH	2	37	20080	FILTER ASSEMBLY-oil
19	20092	SCREW-Phillips pan hd., Taprite, 10-24 x 2-1/2	3	38	20052	NUT-hex, 1/4-20
20	20099	HOUSING-motor	1	39	20050	WASHER-flat
21	20071	COIL-field	1	40	20073	COVER-clutch
41	20091	CLUTCH	1	41	20091	CLUTCH
42	20086	BEARING-clutch	1	42	20086	BEARING-clutch
43	20068	SPROCKET & DRUM ASSEMBLY (1/4 pitch-8 tooth)	1	43	20068	SPROCKET & DRUM ASSEMBLY (1/4 pitch-8 tooth)
44	20067	WASHER	1	44	20067	WASHER
45	A-20077	HOUSING-gear	1	45	A-20077	HOUSING-gear
46	20078	STUD (Part of No. 45)	1	46	20078	STUD (Part of No. 45)
47	20097	CAP-oil w/Gasket #13	1	47	20097	CAP-oil w/Gasket #13
48	20082	GASKET-gear housing	1	48	20082	GASKET-gear housing
49	20103	SCREW-guide bar adjusting	1	49	20103	SCREW-guide bar adjusting
50	20065	NUT-guide bar adjusting	1	50	20065	NUT-guide bar adjusting
51	25C50.69	CHAIN-12" loop, 1/4" Pitch, .060" Ga., 69 DL	1	51	25C50.69	CHAIN-12" loop, 1/4" Pitch, .060" Ga., 69 DL
52	GW2504	GUIDE BAR-12"	1	52	GW2504	GUIDE BAR-12"

HOMELITE

A **Textron** DIVISION, PORT CHESTER, N.Y. 10573
 PRINTED IN U.S.A.
 PART NO. 24681
 Z/LC-95000-1