

# HOMELITE®

## TECHNICAL SERVICE

# BULLETIN

DEALER INFORMATION, TECHNICAL  
ADVICE AND PRODUCT INFORMATION  
CAN BE OBTAINED AT THIS NUMBER:

**1-800-242-4672**

NO. 191-001

**SUBJECT:** THROTTLE CABLE

**AFFECTS:** 250 CHAIN SAW

### IMPORTANT MESSAGE, PLEASE READ!

The throttle cable assembly on the subject saws with serial numbers starting with "HL" were built with a throttle cable with a yellow outer sleeve #(00997-A)

We have replaced this cable assembly with # (00997-B). This assembly has a white nylon outer sleeve and the cable is now soldered 3/4" farther down than it was on the old cable.

With this bulletin we are requesting that on units in stock you change all of the throttle cables with yellow sleeves over to the cable with the white sleeve #(00997-B) before the units are sold.

Submit the work on the regular warranty claim. The failure code is FF13 and the time is .2 of an hour. The old cable and sleeve is to be included in the envelope with the warranty claim. Without the old cable assembly included the warranty will not be accepted.

If you have more than one unit in stock, fill out your first claim completely. Attach an additional claim to the original with your dealer number and the unit serial number for each additional unit. We will fill in additional information as needed. Again, I remind you the old cable assembly is to accompany the claim when submitted.

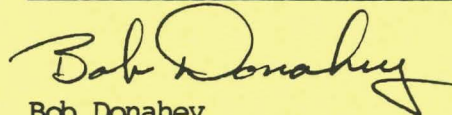

Bob Donahey  
Field Quality Manager

DATE 2/91

# HOMELITE®

## TECHNICAL SERVICE

# BULLETIN

DEALER INFORMATION, TECHNICAL  
ADVICE AND PRODUCT INFORMATION  
CAN BE OBTAINED AT THIS NUMBER:

**1-800-242-4672**

NO. 191-002

**SUBJECT:** CARBURETORS

**AFFECTS:** SXL-925 - XL98C

The carburetor on the SXL-925 (UT 10415C) and the XL98C (UT05045) has been changed. They are now being built with the Walbro WJ carburetor. When replacing the carburetor or you need parts refer to the following:

SXL-925

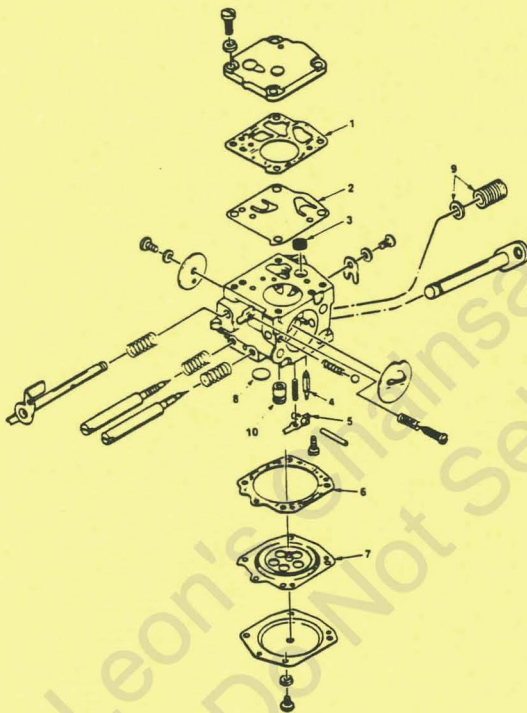

A 01708 Carburetor Kit (WJ 27)  
includes:  
67540 Gasket  
69751 Grommet  
01701 Repair Kit  
01702 Gasket/Diaphragm Kit  
01704 Governor Valve  
97942 Inlet Needle

*Bob Donahey*  
Bob Donahey  
Field Quality  
Assurance Manager

XL 98C

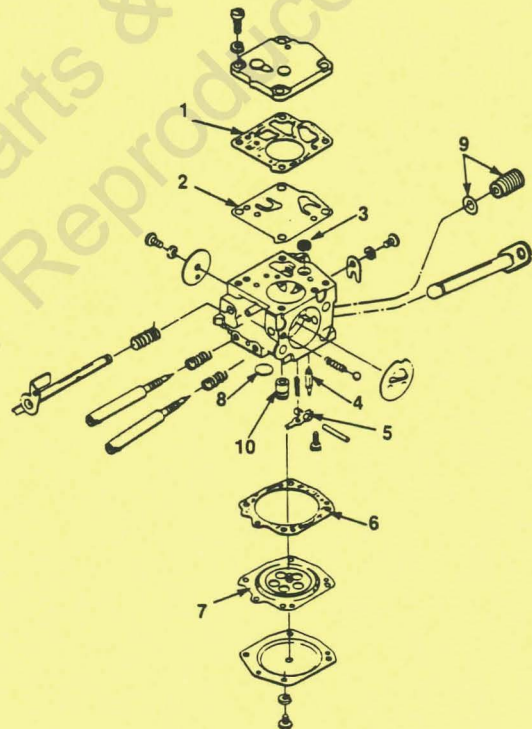

A 01694 Carburetor Kit (WJ 26)  
includes:  
67540 Gasket  
69751 Grommet  
01701 Repair Kit  
01702 Gasket/Diaphragm Kit  
01703 Governor Valve  
97942 Inlet Needle

DATE 3/91

# HOMELITE®

## TECHNICAL SERVICE

# BULLETIN

DEALER INFORMATION, TECHNICAL  
ADVICE AND PRODUCT INFORMATION  
CAN BE OBTAINED AT THIS NUMBER:

**1-800-242-4672**

NO. 191-003

## SUBJECT: SAFETY ALERT

AFFECTS: HT-17, HT-21

THE FUEL CAP ON ALL HT-17 AND HT-21 HEDGE TRIMMERS MUST BE CHANGED ON ALL UNITS IN STOCK AND ON ANY UNITS BROUGHT TO YOU FOR SERVICE.

---

*THIS CHANGE IS BEING MADE BECAUSE THE RUBBER GASKET IN THE OLD FUEL CAP MAY NOT SEAL WITH ALL FUEL MIXES, CAUSING THE FUEL TO LEAK POSSIBLY CREATING A FIRE HAZARD!*

---

THE GASKET IN THE NEW FUEL CAP (NEW FUEL CAP PART NUMBER A-00099-A) IS NOW CORK INSTEAD OF RUBBER.

**ORDER KIT PART NUMBER A-03974 FOR THIS MODIFICATION.**

HEDGE TRIMMERS BUILT AFTER JUNE 1991, STARTING WITH SERIAL NUMBER HM1600001, WILL HAVE THE NEW FUEL CAP AND WILL NOT HAVE TO BE CHANGED.

LISTED BELOW ARE THE JOB CODE, FAIL CODE AND FLAT RATE FOR THE FUEL CAP REPLACEMENT.

JOB CODE: JV40  
FAIL CODE: JV400  
FLAT RATE: 0.1 HR.

RETURN THE OLD CAPS WITH WARRANTY FORM FOR PROPER CREDIT

THANK YOU FOR YOUR COOPERATION.

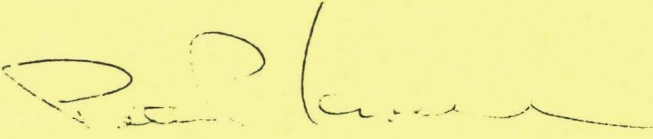

PETER P. KNOELL  
FIELD SERVICE MANAGER

DATE 6/91

# HOMELITE<sup>®</sup>

## TECHNICAL SERVICE BULLETIN

DEALER INFORMATION, TECHNICAL  
ADVICE AND PRODUCT INFORMATION  
CAN BE OBTAINED AT THIS NUMBER:

**1-800-242-4672**

NO. 191-004

**SUBJECT:** SPOOL RETAINER

**AFFECTS:** ST285BC

When installing the Stringhead Assembly on the above unit, Spool Retainer #02781 must be used. This unit does not use an adapter shaft; the shaft is in the retainer. When Parts List #17968C was produced, this part number was left out.

Bob Donahey

A-98231-A

98848 SPRING-Compression

A-02598-A

SPOOL & STRING

A-02781

RETAINER

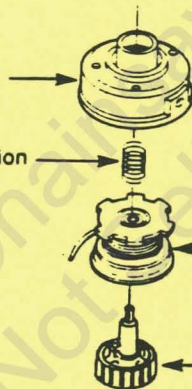

DATE 6/91

**TECHNICAL SERVICE BULLETIN**

**SUBJECT:** Homelite Corrections HBC Parts List, Part Number 18586

1. The assembly for the driveshaft housing shows an incorrect part number listed. The number listed is used on the ST-145 through ST-175BC. The correct Part Number is A-03182-A including:

98923-1 - Decal  
02985 - Decal, Warning

The Clamp 98853 is not included in this assembly and must be ordered separately.

2. The Throttle Assembly for the HBC30B does not show the fastening parts.

(1) Screw 4M 88183  
(2) Nut 4M 81417  
(3) Screw Thd Forming 82528  
(4) Lock Washer 83086

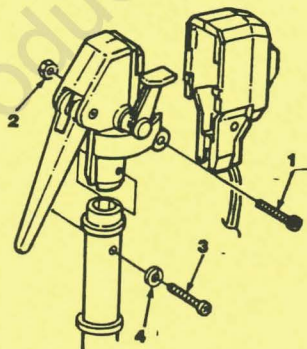

3. Blade Kit A03261 includes the parts shown:

Tri Arc 8" Blade 98717-B  
Flange Washer 00436-07  
Lock Nut 00436-08

Also not shown:

Harness 94470-B  
Blade Guard 96847-2  
Hanger A94442

4. HBC 30/30BC Item 13  
Gear Head Item 17  
Use Part Number A00436  
Gear Head for ST285 A98859

A handwritten signature in black ink, appearing to read "Peter P. Knoell".

Peter P. Knoell  
Field Service Manager

# HOMELITE®

## TECHNICAL SERVICE BULLETIN

DEALER INFORMATION, TECHNICAL  
ADVICE AND PRODUCT INFORMATION  
CAN BE OBTAINED AT THIS NUMBER:

**1-800-242-4672**

NO. 291-002

**SUBJECT:**

1. RESISTANCE VALUES FOR ROTORS & STATORS
2. CORRECTION TO TSB 290-008

**AFFECTS:**

<u>MODEL</u>	<u>UT NUMBER</u>
HL-2500	03697
HL-4400	03698
HL-5500	03699
EH-2500	03700
EH-4400	03701
EH-5500	03702
HLE-4400	03703
HLE-5500	03704
EHE-4400	03705
EHE-5500	03706
HRL-4400-HD	03751

1. (SEE LIST) RESISTANCE VALUES AND PART NUMBER
2. THE PART NUMBER LISTED ON TECHNICAL SERVICE BULLETIN 290-008 FOR ITEM #8 LEAD SHOULD BE A-42818. A-42918 IS INCORRECT.

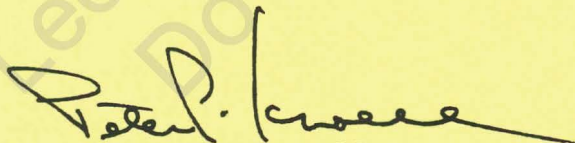

Peter P. Knoell  
Field Quality Manager  
Construction Equipment

DATE 2/91

EH/HL GENERATORS

<u>Model</u>	<u>ROTOR</u>		<u>STATOR</u>		
	<u>Part Number</u>	<u>Resistance</u>	<u>Part Number</u>	<u>Resistance</u>	
HL/HLE 2500	A02428S	43.8	A02431S	.458 1.091	Main Quad
4400 4400HD	A02429S	61.1	A02432S	.313 .888	Main Quad
5500	A02430S	71.8	A02433S	.228 .843	Main Quad
EH/EHE 2500	A02800S	46.7	A02797S	.389 1.177	Main Quad
4400 HRL4400HD	A02799S	67.0	A02796S	.278 .999	Main Quad
5500	A02798S	76.0	A02795S	.208 .973	Main Quad

All Resistance +/-6% Measured at 25OC/77OF  
Brushes - All Models P/N A03035

# HOMELITE®

## TECHNICAL SERVICE

# BULLETIN

DEALER INFORMATION, TECHNICAL  
ADVICE AND PRODUCT INFORMATION  
CAN BE OBTAINED AT THIS NUMBER:

**1-800-242-4672**

NO. 291-004

**SUBJECT:** CHANGE TO PLUNGER SEAL REPAIR KITS

**AFFECTS:**

The Plunger Seal Kits, Part Numbers A01519-07 and A01520-05, have been changed.

The old kits contained per cylinders:

- 2 cups
- 1 cup Support Ring
- 1 O-Ring

The new kits will contain per cylinder:

- A. 1 High Pressure U-Cut
- B. 1 Teflon Support Ring
- C. 1 Low Pressure Seal
- D. 1 O-Ring

Install the new parts as follows:

- A.
  1. Install cup with groove facing down into the cylinder head.
  2. Install the Teflon support ring over cup.
  3. Insert the low pressure glide seal into the cup retainer (E) (not included with Kit, see Parts List). Install the low pressure glide seal and seal retainer over the ceramic plunger and against the body.
  4. Finally, install the O-Ring over the seal retainer.
- B. Turn the crankshaft so plungers are even, then install the cylinder head onto the crankcase body with the valve outlet plug-up.
- C. Torque cap screws to 100-115 inch/pounds.

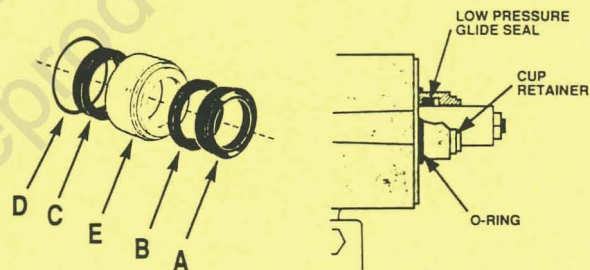

*Peter P. Knoell*  
Peter P. Knoell  
Field Service Manager

DATE 6/91



# HOMELITE®

## TECHNICAL SERVICE

# BULLETIN

DEALER INFORMATION, TECHNICAL  
ADVICE AND PRODUCT INFORMATION  
CAN BE OBTAINED AT THIS NUMBER:

**1-800-242-4672**

NO. 291-005

**SUBJECT:** CHANGES TO PRESSURE WASHERS

**AFFECTS:** UT01802, UT01803, UT01804, UT01805,  
UT01807, UT01808, UT01809

1. HIGH PRESSURE MODEL CHANGE:

HYPRO has changed high pressure pump models from 8000 series to 2000 series. Listed below are the models with the old (8000 series) and the new (2000 series) pump models. The pump model can be determined by the decal on top of the pump.

HWP MODEL	OLD MODEL	NEW MODEL
1000E	8600	2200
1200B	8600	2200
1500R	8600	2200
2000B	8700EHP	2300
2000R	8700EHP	2300
3000B	8800	2400

Some parts are not interchangeable between the old and new models. Attached are the parts lists for all high pressure pumps along with the model usage.

2. NOZZLE CHANGES:

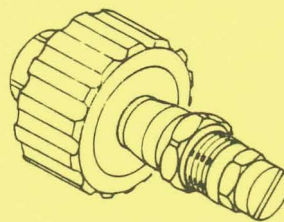

The roll over nozzle holder (49918) has been replaced with a high-low valve (03711) as standard on all 1000PSI thru 2000PSI pressure washers. A single high pressure nozzle is used with this valve. The following list is the HPW model, UT number, nozzle size and part number of the nozzle.

DATE 8/91

MODEL	UT #	NOZZLE SIZE	PART NUMBER
HPW 1000E*	01802	4.5	49920
HPW 1200B*	01803	3.5	02474
HPW 1500R*	01808	3.5	02474
HPW 2000R	01804	6.0	49933
HPW 2000B	01805	6.0	49933

\*NOTE: These nozzles can only be used on HPW models with a 03037 chemical injector. These injectors are marked with a "2" on the injector body.

OPERATION: Turn high-low knob clockwise for high pressure or counter-clockwise for low pressure (to use chemical injector).

3. All HPW models will be shipped with oil in the pump crankcase. A nonvented plug will be installed in place of the dipstick. Before operating the pressure washer:
  - A. The shipping plug must be removed and replaced with the dipstick (attached to the pump).
  - B. The oil level, in the pump, should be checked and should be within the notched portion of the dipstick. Add enough 30 weight oil to bring to the proper level. DO NOT OVERFILL.
  - C. The gear box on the HPW 3000B must be checked for proper oil level. Fill with 90 weight gear oil. See Operators Manual for instruction.
  - D. The engine must be filled with oil to proper level before starting. Consult Engine Manual for instruction.
  
4. To assure sufficient water supply, HPW 3000B pressure washers require a supply hose of 5/8 inch inside diameter or larger. Smaller ID hoses are to restrictive.

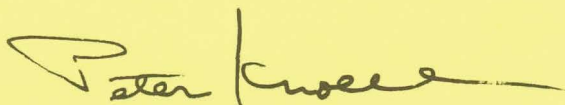

Pete Knoell  
 Field Quality  
 Assurance Mgr.

# HPW2000B HPW2000R

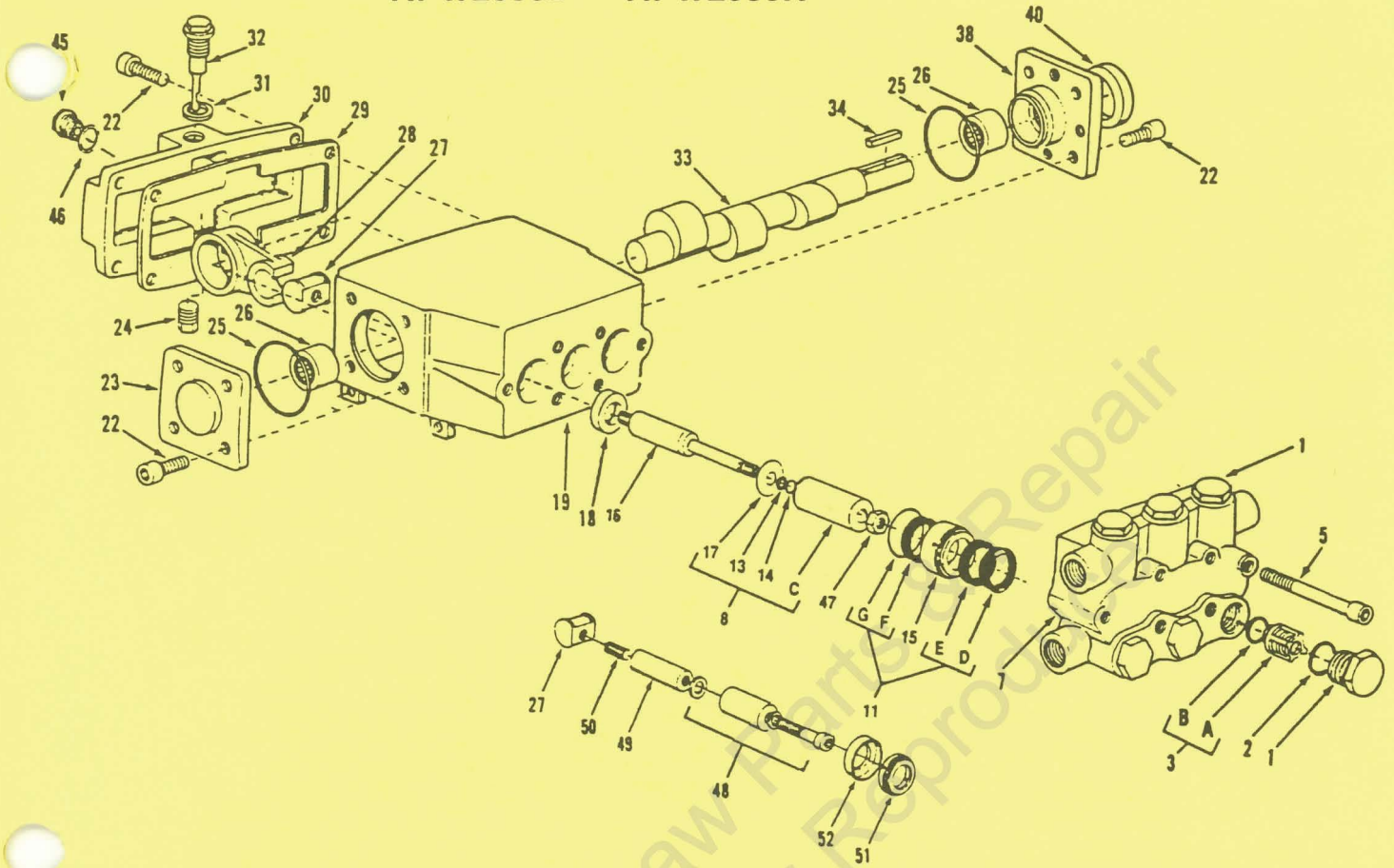

# HPW3000B

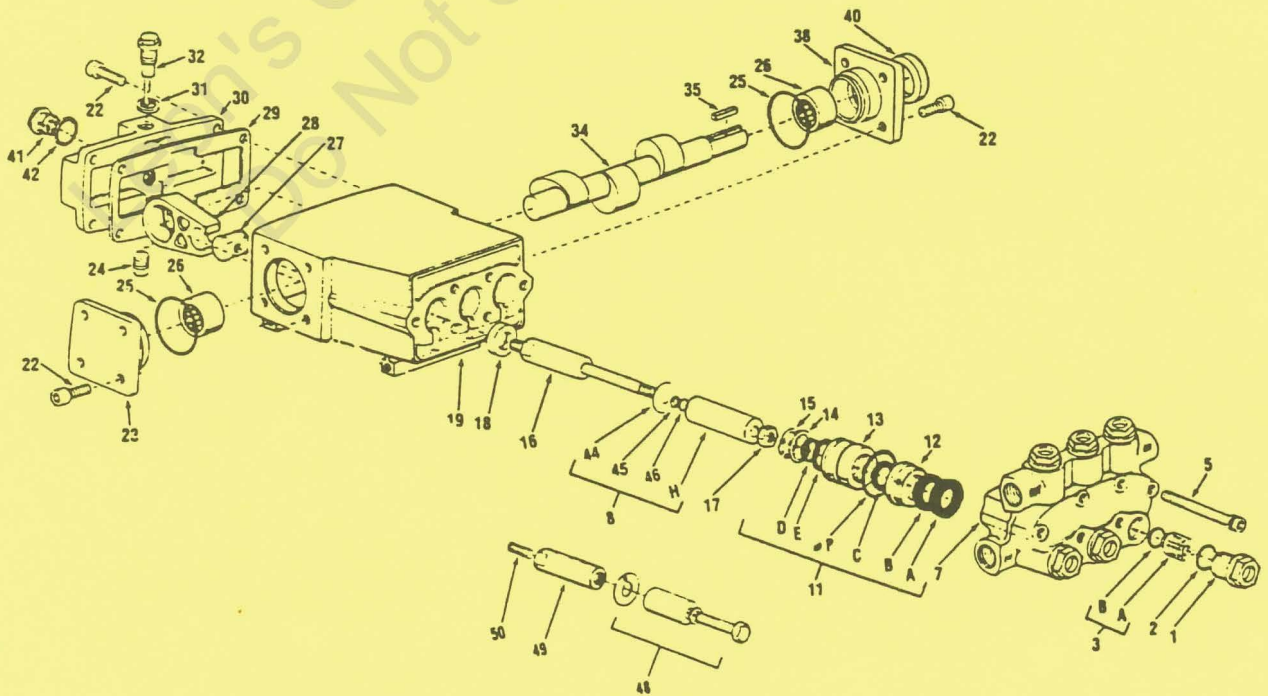

HPW1000E

HPW1200B

HPW1500R

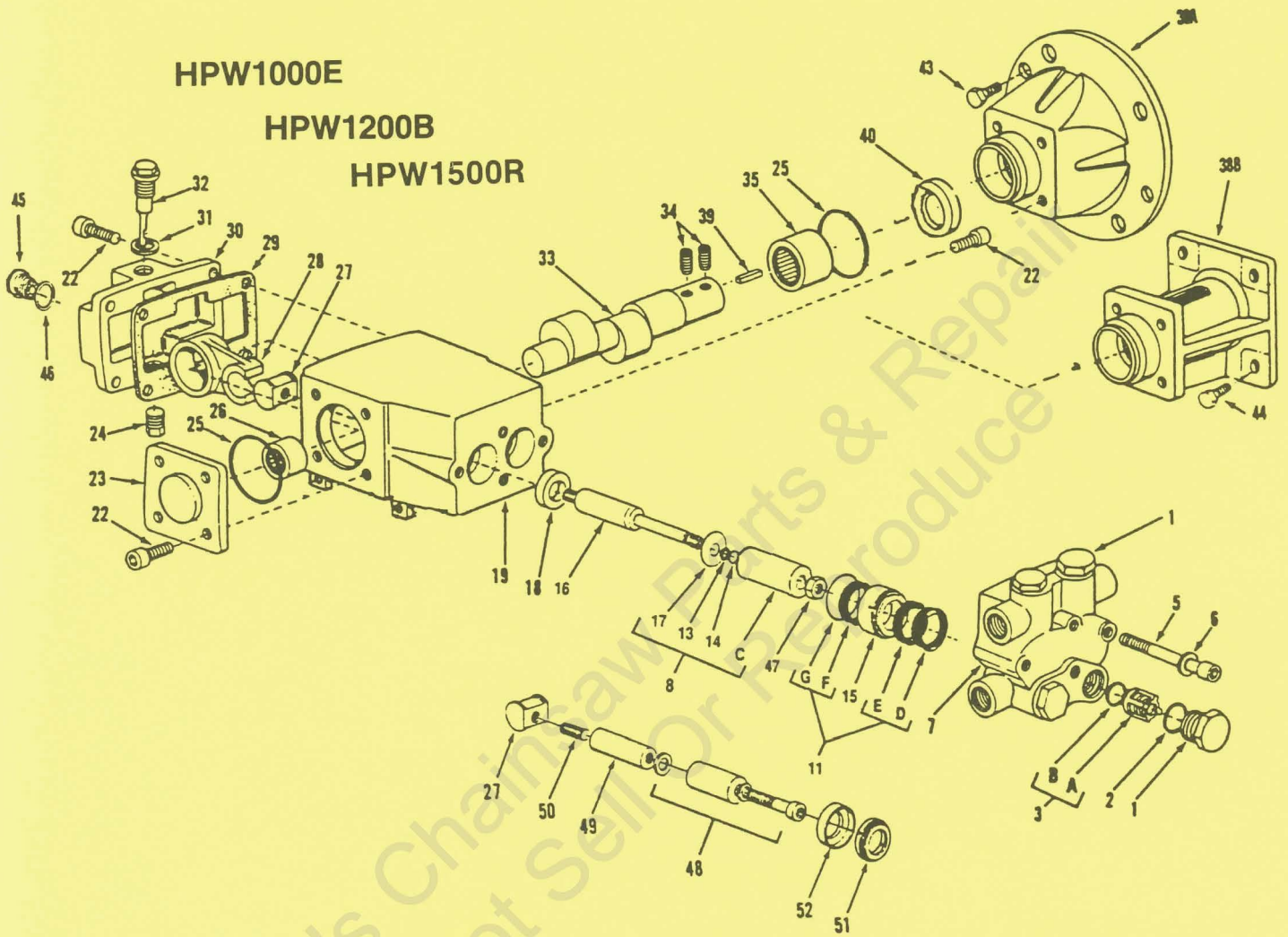

HPW PUMP PARTS LIST

REF	QTY	PART #	DESCRIPTION	PUMP MODEL
			HPW2000B/2000R	
1	6	01519-01	VALVE CAP	2300/8750
2	6	01519-02	O-RING	2300/8750
3	1 SET	A01520-01	VALVE KIT	2300/8750
5	6	01519-04	CAP SCREW	2300/8750
7	1	01520-29	HEAD	2300/8750
8	3 SETS	A01520-30	PLUNGER KIT	2300 ONLY
11	1 SET	A01520-05	PLUNGER SEAL KIT	2300/8750
13	3	01520-31	BACK-UP SEAL	2300 ONLY
14	3	01520-32	O-RING	2300 ONLY
15	3	01520-33	CUP, RETAINER	2300/8750
16	3	01520-34	PLUNGER, LOWER	2300 ONLY
17	3	01520-35	SLINGER	2300 ONLY
18	3	01519-12	OIL SEAL	2300/8750
19	1	01520-36	CRANKCASE	2300/8750
22	12	01519-14	CAP SCREW	2300/8750
23	1	01520-37	END PLATE	2300/8750
24	1	01519-16	DRAIN PLUG	2300/8750
25	2	01519-17	O RING	2300/8750
26	2	01519-18	ROLLER BEARING	2300/8750
27	3	01520-38	WRIST PIN	2300 ONLY
28	3	01519-20	CONNECTING ROD	2300/8750
29	1	01520-10	GASKET	2300/8750
30	1	01520-39	COVER	2300/8750
31	1	01519-23	GASKET	2300/8750
32	1	01520-13	DIPSTICK	2300/8750
33	1	01520-14	CRANKSHAFT	2300/8750
34	1	01520-15	KEY	2300/8750
38	1	01520-40	END COVER	2300/8750
40	1	01520-18	SHAFT SEAL	2300/8750
45	1	01520-19	SIGHT GLASS	2300/8750
46	1	01520-20	GASKET	2300/8750
47	3	01520-41	RETAINING NUT	2300 ONLY
48	3	A01520-03	PLUNGER KIT	8750 ONLY
49	3	01519-10	LOWER PLUNGER	8750 ONLY
50	3	01519-11	STUD	8750 ONLY
51	3	01520-06	CUP, SPACER	8750 ONLY
52	3	01520-07	CUP, RETAINER	8750 ONLY

HPW PUMP PARTS LIST

REF	QTY	PART #	DESCRIPTION	PUMP MODEL
			HPW3000B	
1	6	01565-01	VALVE CAP	2400/8800
2	6	01565-02	O RING	2400/8800
3	1 SET	01565-03	VALVE KIT	2400/8800
5	6	01565-04	HEAD BOLT	2400/8800
7	1	01520-43	HEAD	2400/8800
8	3 SETS	A01520-44	PLUNGER KIT	2400 ONLY
11	1 SET	01565-07	SEAL KIT	2400/8800
12	3	01565-08	RETAINER RING	2400/8800
13	3	01565-09	SEAL	2400/8800
14	3	01565-10	BACKUP RING	2400/8800
15	3	01565-11	SNAP RING	2400/8800
16	3	01520-45	LOWER PLUNGER GUIDES	2400 ONLY
17	3	01520-41	RETAINING NUT	2400 ONLY
18	3	01565-14	OIL SEAL	2400/8800
19	1	01520-47	BODY	2400/8800
22	12	01565-16	BOLT	2400/8800
23	1	01520-48	END COVER	2400/8800
24	1	01519-16	PLUG	2400/8800
25	1	01565-18	O RING	2400/8800
26	2	01565-19	BEARINGS	2400/8800
27	3	01565-20	WRIST PIN	2400/8800
28	3	01565-21	CONNECTING ROD	2400/8800
29	1	01565-22	END COVER GASKET	2400/8800
30	1	01520-50	END COVER	2400/8800
31	1	01519-23	GASKET	2400/8800
32	1	01565-25	OIL DIPSTICK ASS'Y	2400/8800
34	1	01565-26	CRANKSHAFT	2400/8800
35	1	01565-27	KEY	2400/8800
38	1	01520-50	END COVER	2400/8800
40	1	01565-29	SEAL	2400/8800
41	1	01520-19	OIL SIGHT GLASS	2400/8800
42	1	01520-20	GASKET	2400/8800
44	3	01520-51	SLINGER	2400/8800
45	3	01520-31	BACKUP SEAL	2400/8800
46	3	01520-32	O RING	2400/8800
48	3	01565-06	PLUNGER KIT	8800 ONLY
49	3	01565-12	LOWER PLUNGER	8800 ONLY
50	3	01565-13	STUD	8800 ONLY

HPW PUMP PARTS LIST

HPW1000E/1200B/1500R				
REF	QTY	PART #	DESCRIPTION	PUMP MODEL
1	4	01519-01	VALVE CAP	2200/8600
2	4	01519-02	O RING	2200/8600
3	1 SET	A01519-03	VALVE KIT	2200/8600
5	4	01519-04	CAP SCREW	2200/8600
7	1	01520-54	HEAD	2200/8600
8	2 SETS	A01520-55	PLUNGER KIT	2200 ONLY
11	1 SET	A01519-07	PLUNGER SEAL KIT	2200/8600
13	2	01520-31	BACKUP SEAL	2200 ONLY
14	2	01520-32	O RING	2200 ONLY
15	2	01520-58	RETAINER, CUP	2200/8600
16	2	01520-34	PLUNGER LOWER	2200 ONLY
17	2	01520-35	SLINGER	2200 ONLY
18	2	01519-12	OIL SEAL	2200/8600
19	1	01520-61	CRANKCASE	2200/8600
22	12	01519-14	CAP SCREW	2200/8600
23	1	01520-37	PLATE, END	2200/8600
24	1	01519-16	DRAIN PLUG	2200/8600
25	1	01519-17	O RING	2200/8600
26	1	01519-18	ROLLER BEARING	2200/8600
27	2	01520-38	WRIST PIN	2200 ONLY
28	2	01519-20	CONNECTING ROD	2200/8600
29	1	01519-21	GASKET	2200/8600
30	1	01520-64	COVER	2200/8600
31	1	01519-23	GASKET	2200/8600
32	1	01519-34	DIPSTICK	2200/8600
33	1	01519-24	CRANKSHAFT	2200/8600
34	2	01519-25	SET SCREW	2200/8600
35	1	01519-26	BEARING	2200/8600
38A	1	01519-28	C FLANGE 1000E	2200/8600
38B	1	01519-29	END COVER 1200B/1500R	2200/8600
39	1	01519-30	KEY	2200/8600
40	1	01519-31	SEAL	2200/8600
43	4	01519-32	BOLT	2200/8600
44	4	01519-33	BOLT	2200/8600
45	1	01520-19	SIGHT GLASS	2200/8600
46	1	01520-20	GASKET	2200/8600
47	2	01520-41	RETAINING NUT	2200 ONLY
48	2	A01519-06	PLUNGER KIT	8600 ONLY
49	2	01519-10	LOWER PLUNGER	8600 ONLY
50	2	01519-11	STUD	8600 ONLY
51	2	01519-08	CUP, SPACER	8600 ONLY
52	2	01519-09	CUP, RETAINER	8600 ONLY

# HOMELITE®

## TECHNICAL SERVICE

# BULLETIN

DEALER INFORMATION, TECHNICAL  
ADVICE AND PRODUCT INFORMATION  
CAN BE OBTAINED AT THIS NUMBER:

**1-800-242-4672**

NO. 291-006

**SUBJECT:** CHANGES TO BP250 CONTROL HANDLES

**AFFECTS:** UT 08017A BP250

BP250 Blowers manufactured after 7/17/91 beginning with Serial Number HM1980001, will have a new control handle. Some parts used on earlier units will not fit the new handle.

Listed are the new part numbers and the items affected:

PART NUMBER	ITEM
03922	Handle, Control Right
03923	Handle, Control Left
94452-B	Trigger, (Color Change, Red instead of Black)
A03924	Electrical Lead and Terminal
02497	Switch, Rocker (Replaces Toggle Switch)

These parts can only be used on BP250 Blowers with Serial Numbers HM1980001 or higher. For Back Pack Blowers made previously use the part numbers listed in Parts List Number 18421.



Peter P. Knoell  
Field Quality Mgr.  
Construction Products

DATE 8/91